

Concrete (RC) - Column Schedule		
Column Ref	Dimensions	
	Depth	Width
C1	300	300
C2	300	400
C3	300	500
C4	300	600
C5	350	600
C6	450	700
C8	600	600
C9	700	700
C10	300	425
C11	500	425



Project
BEDFORD PASSAGE DEVELOPMENT

UK & IRELAND
 Client
MIDDLESEX ANNEXE LLP

Consultant
AECOM
 Aldgate Tower
 2 Leman Street
 London E1 8FA
 United Kingdom
 Tel +44 (0) 20 7061 7000
 www.aecom.com

- Notes**
- Do not scale from this drawing. Work to figured dimensions only.
 - This drawing is to be read in conjunction with:
 - AECOM Structural Specifications
 - Design reports
 - Survey and Interpretative Reports
 - Project Specifications and Performance Specifications
 - Health and Safety Hazard Register
 - Relevant drawings and documentation issued by the architect, engineers and specialists.
 - Basement Sequencing Drawings
 - Movements and Tolerances Report
 - All dimensions are in mm except levels which are in metres and relate to [ordance datum].
 - Any discrepancies shall be referred to the Designer before work commences.

Legend:

- Top of Structural Slabs Shown Thus: SSL = 12.000
- Columns:
- Columns Under:
- Direction of Span in Slab:
- Step in Slab:
- Beam Sizes shown on plan thus 900x600 indicated as the following:
- Beams to be centred on columns unless noted otherwise as thus:
- As-Built site coordinates of contractor's steel king post piles (installed in 2020) used for temporary works. All king post steels to be cut down to below formation level unless noted otherwise:

Issue/Revision

Rev.	Date	Description	Dm/Chk/Apr
T3	23.10.20	ISSUED FOR TENDER	RH/KSF/DW
T2	03.07.20	STAGE 4 REDESIGN	RH/C/DW
T1	19.06.20	STAGE 4 (PCSA STAGE 1 DESIGN REVIEW)	RH/C/DW

Purpose Of Issue
 STAGE 4 TENDER

Project Number
 60516144

Sheet Title
 New Build
 General Arrangement
 Basement B2

Sheet Number
 MHA-ACM-00-B2-DR-SE-01000

Scale: 1 : 100@A1 **Rev:** T3

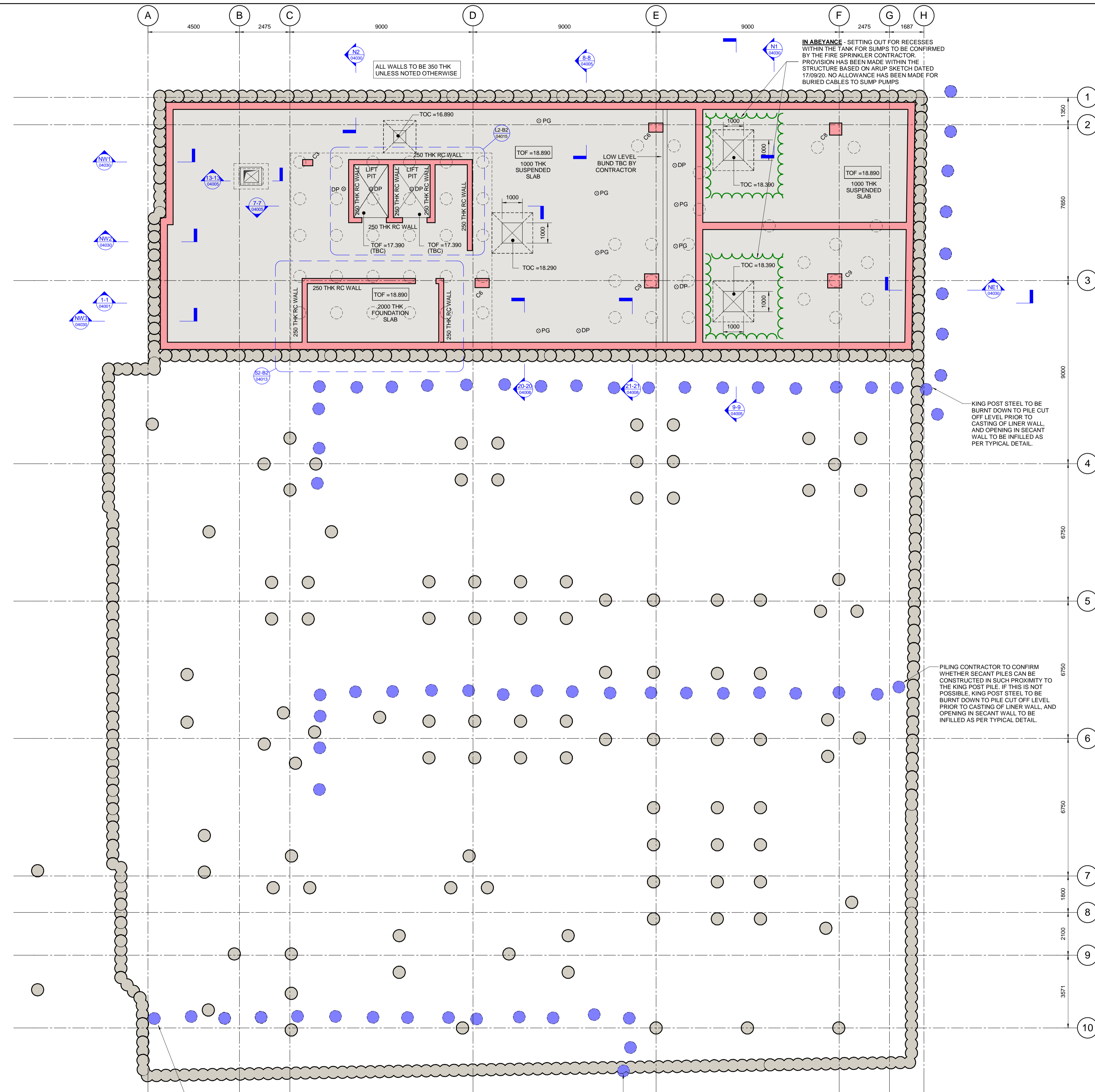

PILING CONTRACTOR TO CONFIRM WHETHER SECANT PILES CAN BE CONSTRUCTED IN SUCH PROXIMITY TO THE KING POST PILE. IF THIS IS NOT POSSIBLE, KING POST STEEL TO BE BURNT DOWN TO PILE CUT OFF LEVEL PRIOR TO CASTING OF LINER WALL, AND OPENING IN SECANT WALL TO BE INFILLED AS PER TYPICAL DETAIL.

Basement B2 Plan
 1 : 100

KING POST STEEL TO BE BURNT DOWN TO PILE CUT OFF LEVEL PRIOR TO CASTING OF LINER WALL AND OPENING IN SECANT WALL TO BE INFILLED AS PER TYPICAL DETAIL.

This drawing has been prepared for the use of AECOM's client. It may not be used, modified, reproduced or relied upon by third parties, except as agreed by AECOM or as required by law. AECOM accepts no responsibility, and denies any liability whatsoever, to any party that uses or relies on this drawing without AECOM's express written consent. Do not scale this document. All measurements must be obtained from this scaled dimensions.