



3G / 4G Antenna ID	Existing 3G Bearing
A2	320°
B2	080°
C2	240°

NOTES:  
1. ALL DIMENSIONS IN MM UNLESS OTHERWISE NOTED.

Master	MBNL / EE / H3G	Project	Purpose of Issue	Issue
M008	MBNL	T&A STRATEGIC	Planning	H
Date:		31/03/2021		
Drawn:		T. Monk		
Checked:		T. Monk		
Approved:		S.D. Gilroy		
Revision / Upgrade Description: Triage Completed And Approved				
M007	MBNL	T&A STRATEGIC	Planning	G
Date:		02/02/2022		
Drawn:		T. Monk		
Checked:		T. Monk		
Approved:		S.D. Gilroy		
Revision / Upgrade Description: Sector B Antenna Heights and RRU number Corrected. Proposed 300Ø dish added				
M006	MBNL	T&A STRATEGIC	Planning	F
Date:		26/11/2020		
Drawn:		T. Monk		
Checked:		T. Monk		
Approved:		S.D. Gilroy		
Revision / Upgrade Description: Sector B config changed- sector A and C antenna frame revised				
M005	MBNL	T&A STRATEGIC	Planning	E
Date:		06/11/2020		
Drawn:		T. Monk		
Checked:		T. Monk		
Approved:		S.D. Gilroy		
Revision / Upgrade Description: ICNIRP Zones Revised, Triage Completed And Approved				
M004	MBNL	T&A STRATEGIC	Planning	D
Date:		28/10/2020		
Drawn:		T. Monk		
Checked:		T. Monk		
Approved:		S.D. Gilroy		
Revision / Upgrade Description: Antenna Schedule Corrected, ICNIRP Zones Revised, Triage Re-submitted				

 Hutchison 3G UK Limited Star House, 20 Grenfell Road Maidenhead, SL6 1EH Tel: 01628 765 000 Fax: 01628 765 001	 Hatfield Business Park Hatfield Hertfordshire AL10 9BW Tel: 01707 315000 Fax: 01707 319001
---	--

**MBNL** Mobile Broadband Network Limited  
Sixth Floor, Thames Tower, Station Road, Reading, RG1 1LX

Design Consultant & Principal Contractor:



Site Name: **1-24 RIVERSIDE (TTP33350)**

Site ID: **1464546**

Address:  
**1-24 RIVERSIDE  
BIRKENHEAD STREET  
BLOOMSBURY CAMDEN  
LONDON  
WC1H 8BH**

Title: **100 EXISTING SITE PLAN**

Project: **T&A STRATEGIC**

Purpose of Issue: **PLANNING**

EE Cell ID: <b>66366</b>	MBNL Cell ID: <b>CMN185</b>	3UK Cell ID: <b>N0474</b>
-----------------------------	--------------------------------	------------------------------

Master Drawing No: **1464546\_CMN185\_66366\_N0474\_M008** Issue: **H**

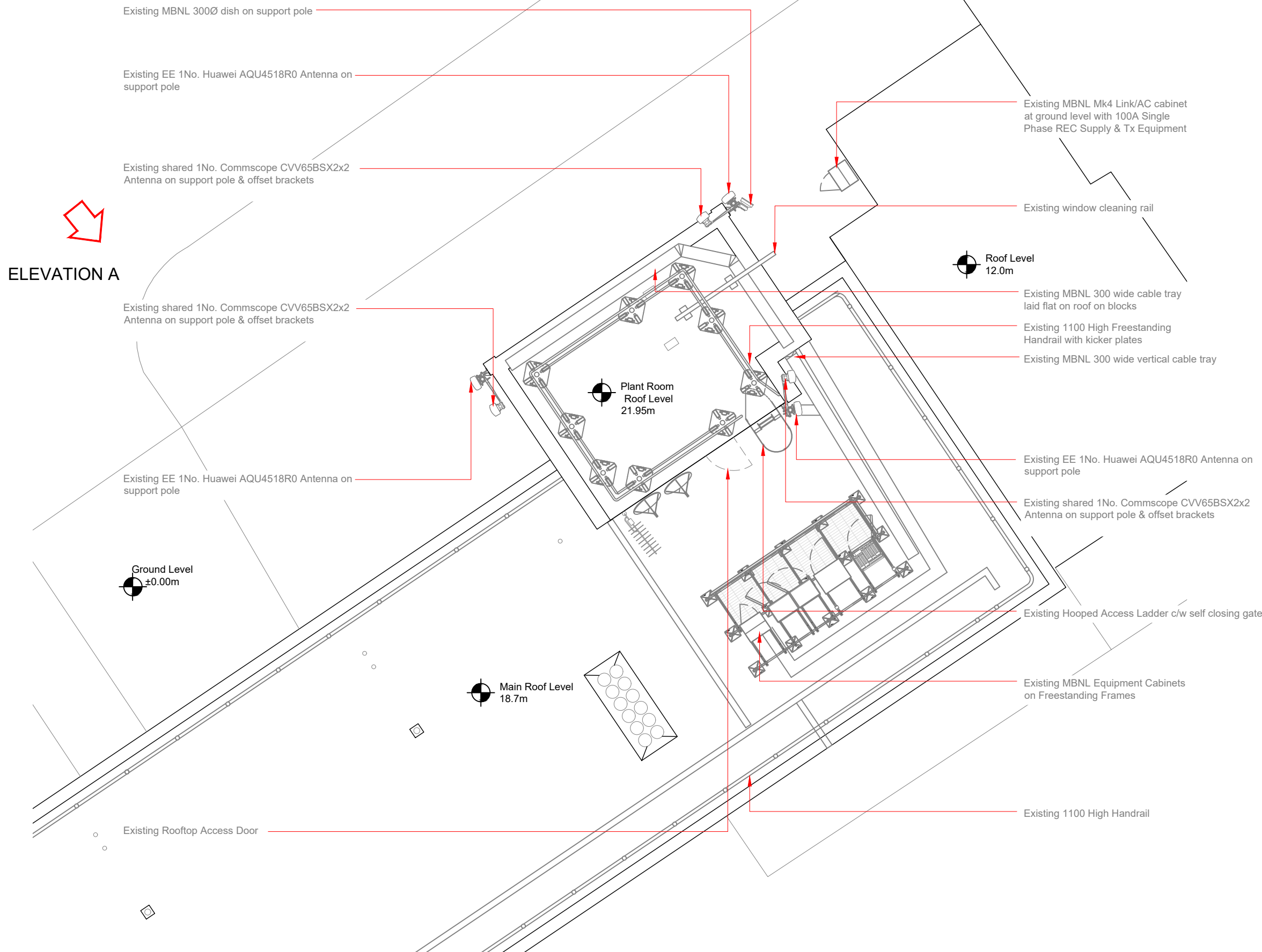

EXISTING SITE PLAN

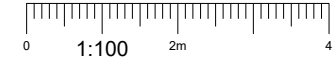

100mm  
50mm  
10mm