

KEY	
	SITE BOUNDARY.
	PROPOSED LEVELS.
	EXISTING LEVELS.
	FORMATION LEVELS (SUB BASE).
	SURFACE WATER SEWER.
	FOUL WATER SEWER.
	COMBINED WATER SEWER.
	SURFACE WATER MANHOLE.
	FOUL WATER MANHOLE.
	COMBINED WATER MANHOLE.
	SW 2250 INSPECTION CHAMBER 600mm DEEP.
	FW 2250 INSPECTION CHAMBER 600mm DEEP.
	PIPE TO BE ENCASED IN CONCRETE.
	RISING MAIN.
	EXISTING FOUL WATER SEWER.
	EXISTING SURFACE WATER SEWER.
	EXISTING COMBINED WATER SEWER.
	EXISTING SEWERS & MANHOLES TO BE ABANDONED TO BE BROKEN OUT TO BEDBASE LEVEL AND VOID BACKFILLED WITH GRANULAR MATERIAL, COMPACTED IN LAYERS NOT EXCEEDING 250mm.
	ROOT PROTECTION ZONE.
	RAIN WATER PIPE, SOIL PIPE, SOIL & VENT PIPE, STUB STACK & WASTE PIPE CONNECTIONS.
	CHANNEL DRAIN (ACO CHANNEL OR SIMILAR APPROVED).
	THRESHOLD DRAIN (REPURCH OR SIMILAR APPROVED).
	YARD GULLY.
	NONE RETURN VALVE.
	INLET AND OUTLET BOX.
	RODDING EYE.
	LINED POROUS PAVING REFER TO DETAILS SHEET.

DESIGN NOTE		
	EXISTING SITE	PROPOSED SITE
TOTAL SITE AREA (m <sup>2</sup> )	1422	1422
IMPERMEABLE AREA (m <sup>2</sup> )	638	802
PERMEABLE AREA (m <sup>2</sup> )	784	620
PEAK RATE RUN OFF (l/s)	17	0
NUMBER OF UNITS	1	0
GREENFIELD RUN-OFF (l/s)	0	0
BROWNFIELD RUN-OFF (l/s)	17	0
RESTRICTED SURFACE WATER PEAK DISCHARGE RATE (l/s)	0	0
ATTENUATION FOR 100% + 40% REQUIRED (m <sup>3</sup> )	0	74

EXISTING SURFACE WATER DISCHARGE AS AGREED IN THE FRA REPORT REF: 193219/FRA

MAINTENANCE SCHEDULE		
PRODUCT	REQUIRED ACTION	RECOMMENDED FREQUENCY
CHANNEL DRAINS, YARD & PAVED GULLIES	INSPECT GRILLIES & INVERTS, ARE FREE OF LEAVES & DETRITUS - REMOVE AS REQUIRED	EVERY 6 MONTHS AND AFTER AUTUMN LEAF FALL
POROUS PAVING	JETTING OR BRUSHING TO UNBLOCK BLOCKED PORES, KEEP JOINTS AND VOIDS CLEAR - AS REQUIRED	EVERY 6 MONTHS AND AFTER AUTUMN LEAF FALL
ROAD GULLIES	REMOVE SILT & DETRITUS	EVERY 6 MONTHS AND AFTER AUTUMN LEAF FALL
CATCHPITS	REMOVE SILT & DETRITUS	EVERY 6 MONTHS AND AFTER AUTUMN LEAF FALL
INTERCEPTOR	CHECK SILT & OIL LEVELS - EMPTY AS REQUIRED, CHECK ALARM SYSTEMS ARE WORKING CORRECTLY	EVERY 6 MONTHS AND AFTER AUTUMN LEAF FALL
ATTENUATION TANK	CHECK FOR SILT BUILD-UP & DETRITUS - REMOVE AS REQUIRED IN ACCORDANCE WITH MANUFACTURER'S INSTRUCTIONS	MONTHLY FOR 3 MONTHS THEN EVERY 6 MONTHS ALSO AFTER A MAJOR STORM EVENT
HYDROBRAKE CHAMBER	INSPECT HYDROBRAKE AND ITS FUNCTIONALITY, REMOVE DETRITUS AS REQUIRED IN ACCORDANCE WITH MANUFACTURER'S INSTRUCTIONS	MONTHLY FOR 3 MONTHS THEN EVERY 6 MONTHS ALSO AFTER A MAJOR STORM EVENT

MANHOLE NOTES	
1.	BD = BACKDROP MANHOLE
2.	HB = HYDROBRAKE MANHOLE (SEE HYDROBRAKE SCHEDULE)
3.	CP = CATCHPIT MANHOLE
4.	RE = RODDING EYE
5.	RC = IN-SITU RC MANHOLE (CAST INTEGRAL WITH OF SLAB)
6.	CATCHPIT INVERT LEVELS REFER TO OUTGOING PIPE - FOR SUMP LEVEL DEDUCT 300mm (TYPE 3 or 4 MH) OR 600mm (TYPE 5 MH)
7.	COVER LEVELS ARE INDICATIVE ONLY - ACTUAL COVER LEVELS & INCLINATION SHALL MATCH THE FINISHED GROUND LEVEL
8.	EXISTING MANHOLE COVERS SHALL BE RAISED / LOWERED & INCLINATION ADJUSTED TO SUIT THE FINISHED GROUND LEVEL
9.	LEVELS SHOWN IN BOLD ITALICS ARE ASSUMED/INTERPOLATED - TO BE CONFIRMED BY SITE SURVEY
10.	WHERE REQUIRED EXISTING MANHOLE BENCHING SHALL BE BROKEN OUT & REFORMED TO SUIT NEW CONNECTIONS
11.	EXISTING MANHOLE COVERS SHALL BE RAISED / LOWERED & INCLINATION ADJUSTED TO SUIT THE FINISHED GROUND LEVEL
12.	SUITABLE TO ACCEPT FLOOR FINISHES (HOLE GREEN USAGE OR SIMILAR APPROVED).

CDM NOTES:	
1.	THE ATTENTION OF THE CLIENT, PRINCIPAL DESIGNER, PRINCIPAL CONTRACTOR, DESIGNERS AND CONTRACTORS IS DRAWN TO THE FOLLOWING POTENTIAL RISKS IN CONJUNCTION WITH THE PROPOSED ON-SITE AND OFF-SITE WORKS AS DESIGNED FOR THIS PROJECT:
2.	WORKS IN THE VICINITY OF LIVE SERVICES INCLUDING GAS, ELECTRICITY AND BT WILL BE NECESSARY AND THE ADVICE OF ALL STATUTORY SERVICE COMPANIES MUST BE SOUGHT BEFORE ANY WORKS COMMENCE
3.	WORKS WITHIN AND ADJUTING THE EXISTING HIGHWAY WILL ENTAIL TRAFFIC HAZARDS AND ALL APPROPRIATE SAFETY MEASURES INCLUDING BARRIERS, SIGNS AND LIGHTING MUST BE UNDERTAKEN TO THE APPROVAL OF THE LOCAL AUTHORITY, THE HIGHWAY AUTHORITY AND THE POLICE DEPARTMENT
4.	HAZARDOUS MATERIALS INCLUDING CEMENT AND BITUMINOUS MATERIALS ARE SPECIFIED AND THE MANUFACTURER'S ADVICE ON SAFE HANDLING PROCEDURES MUST BE OBTAINED AND MADE CLEAR TO ALL OPERATIVES
5.	THE CONTRACTOR WILL BE RESPONSIBLE FOR LOCATING ALL EXISTING SERVICES WITHIN THE VICINITY OF THE WORKS AND DUG AND ENSURE THESE ARE PROTECTED THROUGHOUT THE DURATION OF THE WORKS. ALL UTILITY PLANT SHOULD BE CLEARLY MARKED ON THE GROUND, PRIOR TO COMMENCEMENT OF THE WORKS.
6.	ALL PIPEWORK, SILT TRAPS, CATCHPITS, TRAPPED GULLIES, ATTENUATION TANKS AND PUMP CHAMBERS TO BE REGULARLY INSPECTED EVERY THREE MONTHS AND CLEARED OUT ON A REGULAR FREQUENCY FOR THE FIRST NINE MONTHS AFTER THIS PERIOD THE FREQUENCY CAN BE REDUCED TO EVERY SIX MONTHS. PUMP SETS TO BE INSPECTED AND MAINTAINED IN ACCORDANCE WITH THE RECOMMENDATIONS OF THE MANUFACTURER/PUMP PROVIDER
7.	POOR SURFACES TO BE REGULARLY SWEEPED THREE TIMES A YEAR TO REMOVE THE SILT, GREASE TRAPS/INTERCEPTORS ARE TO BE INSPECTED/EMPTYED AT LEAST ONCE A MONTH AND PREFERABLY, EVERY TWO WEEKS.

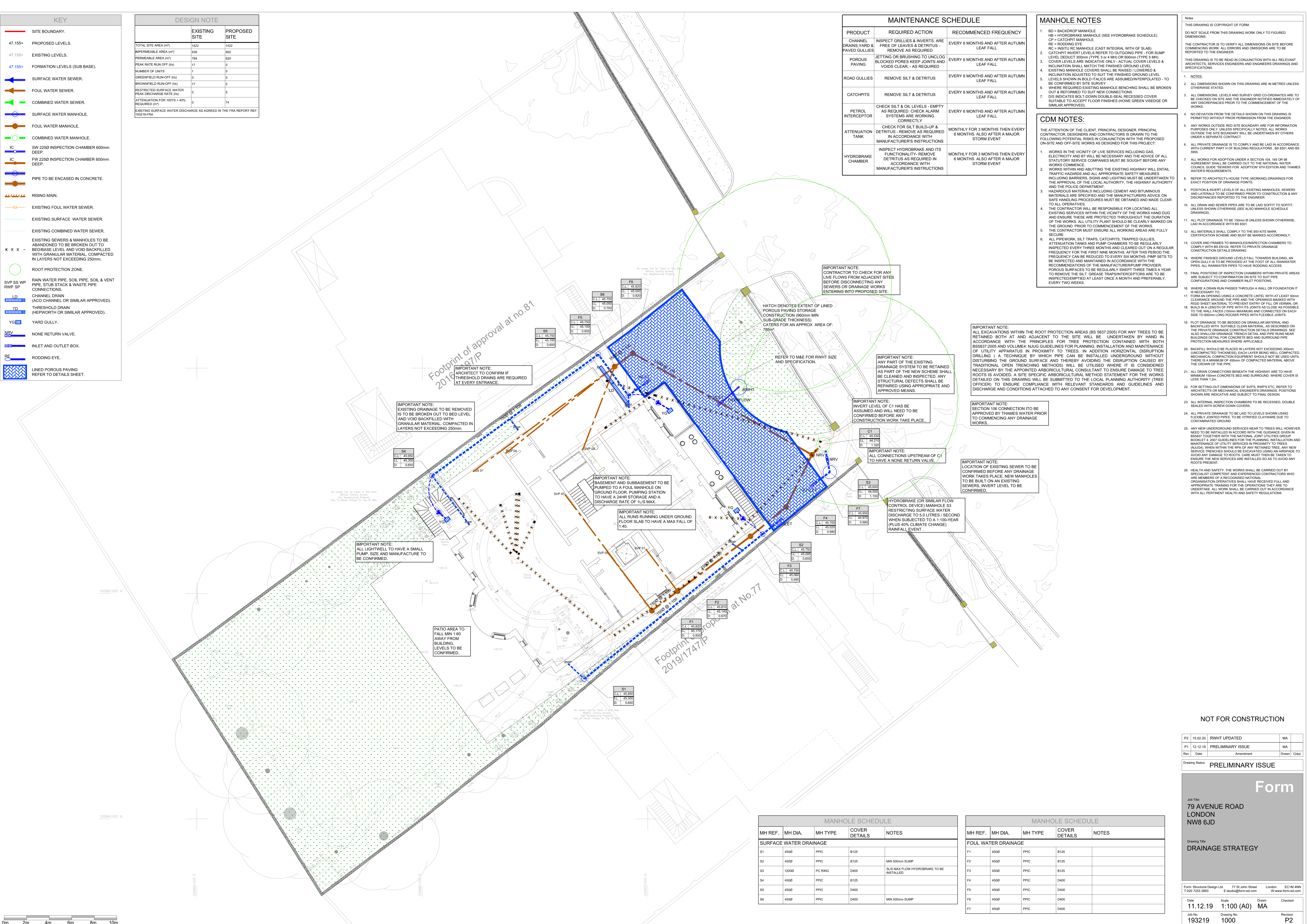

MANHOLE SCHEDULE	
MH REF.	MH DIA.
SURFACE WATER DRAINAGE	
S1	4500
S2	4500
S3	1200D
S4	4500
S5	4500
S6	4500

MANHOLE SCHEDULE	
MH REF.	MH DIA.
FOUL WATER DRAINAGE	
F1	4500
F2	4500
F3	4500
F4	4500
F5	4500
F6	4500
F7	4500
F8	4500

NOT FOR CONSTRUCTION			
Rev.	Date	Amendment	Drawn / Chkd
P2	15.02.20	RHWIT UPDATED	MA
P1	12.12.19	PRELIMINARY ISSUE	MA

**PRELIMINARY ISSUE**

# Form

Job Title  
**79 AVENUE ROAD LONDON NW8 6JD**

Drawing Title  
**DRAINAGE STRATEGY**

Date	Scale	Drawn	Checked
11.12.19	1:100 (A0)	MA	
Job No.	Drawing No.	Revision	
193219	1000	P2	

MH REF.	MH DIA.	MH TYPE	COVER DETAILS	NOTES
SURFACE WATER DRAINAGE				
S1	4500	PPC	B125	
S2	4500	PPC	B125	MIN 500mm SLUMP
S3	1200D	PC RING	D400	SLS MAX FLOW HYDROBRAKE TO BE INSTALLED
S4	4500	PPC	B125	
S5	4500	PPC	D400	
S6	4500	PPC	D400	MIN 500mm SLUMP

MH REF.	MH DIA.	MH TYPE	COVER DETAILS	NOTES
FOUL WATER DRAINAGE				
F1	4500	PPC	B125	
F2	4500	PPC	B125	
F3	4500	PPC	B125	
F4	4500	PPC	D400	
F5	4500	PPC	D400	
F6	4500	PPC	D400	
F7	4500	PPC	D400	

