

All existing (timber/ aluminium, steel) windows to be replaced in painted timber double glazed casement windows to match proportions and profile of existing windows covered in a separate planning application

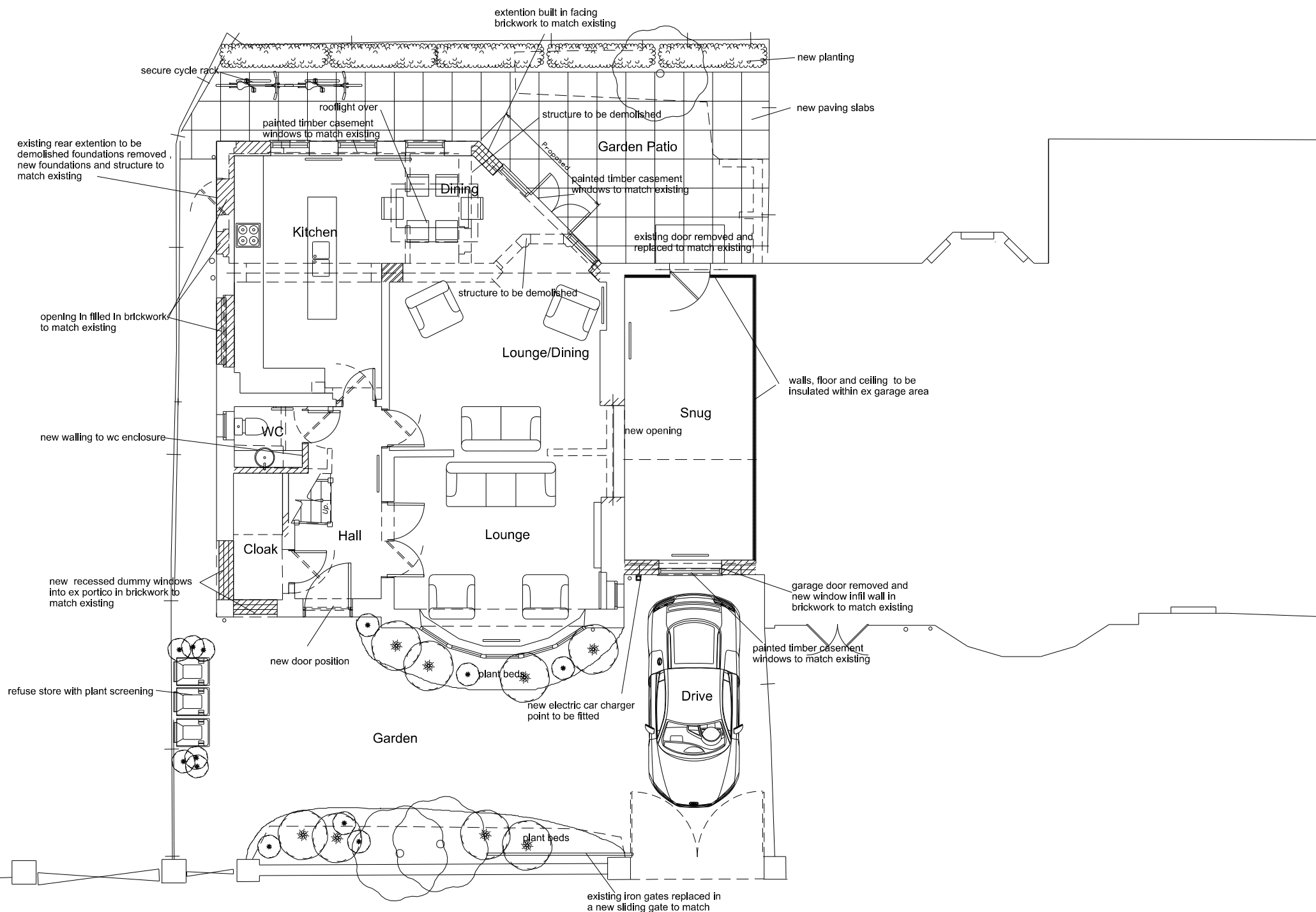

Proposed Ground Floor Plan

Revision

Project Title

20 Rosslyn Hill
London NW3 1PD

Drawing Title

Proposed Ground Floor Plan

Client

Peter Haagensen

Scale

1:100@A3

Date

Jan 2021

Drg. No.

0547_00_EX002

Notes

All dimensions must be checked and NEO Architects are to be informed of any discrepancies prior to construction. This drawing and any of the details therein remain the copyright of NEO Architects.

NEO Architects
105a Park Road
New Barnet
Barnet
EN4 9QR

Phone +44 (0) 20 3304 0480
Mobile 07802 237666

michael@neoarchitects.co.uk