

- Construction based on the following:
- 6" concrete slab
 - 50mm insulation with 50mm screed
 - Perimetre engineering brick
 - 8X2 softwood studs forming the structure
 - 70mm insulation between studs and 80mm externally
 - Tivek or similar membrane
 - Seared larch cladding
 - Internall insulation clad in Larch slats
 - Felt roof laid to falls
 - Sedum roof finish
 - Floor TBD

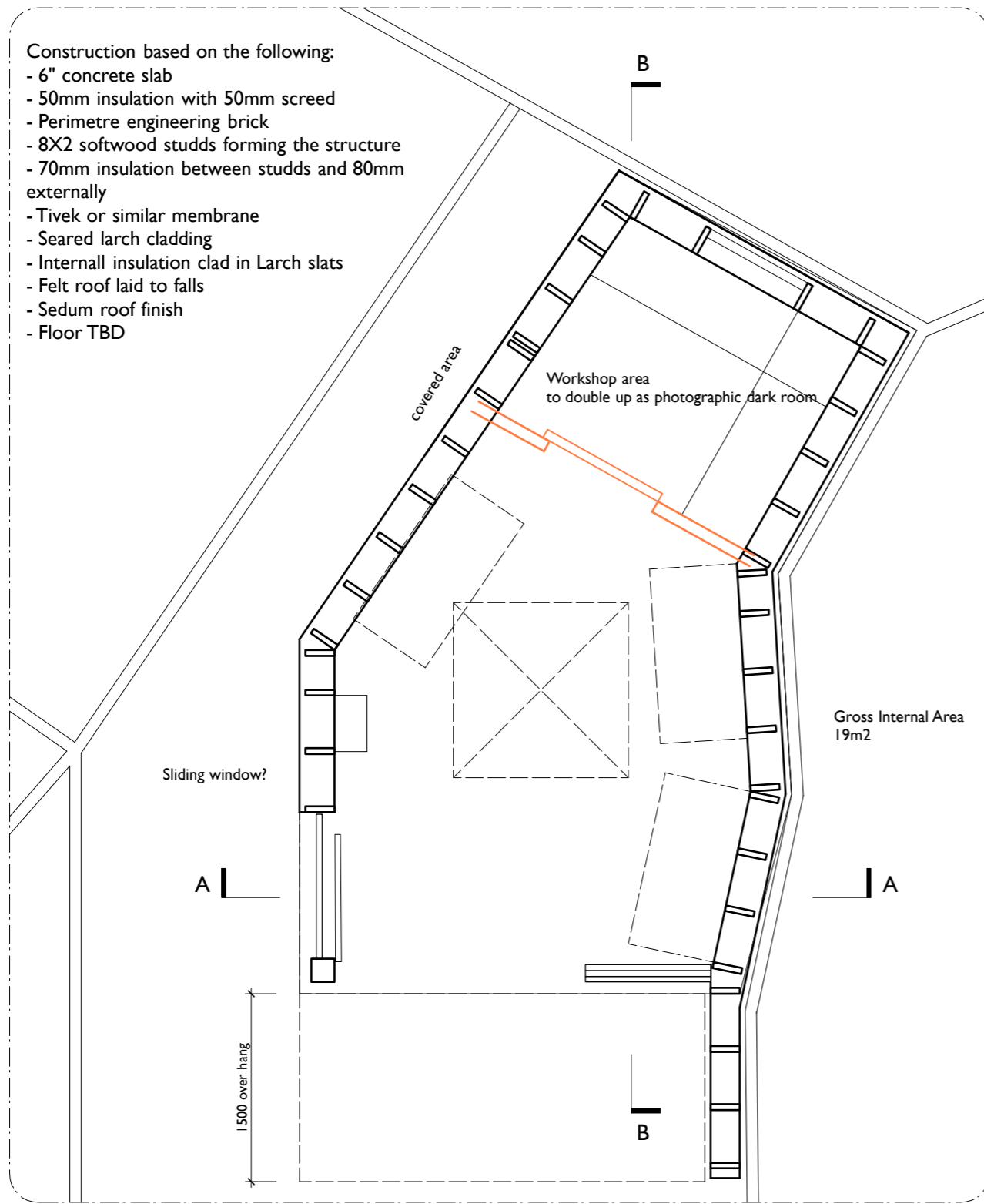

Ground Floor Plan

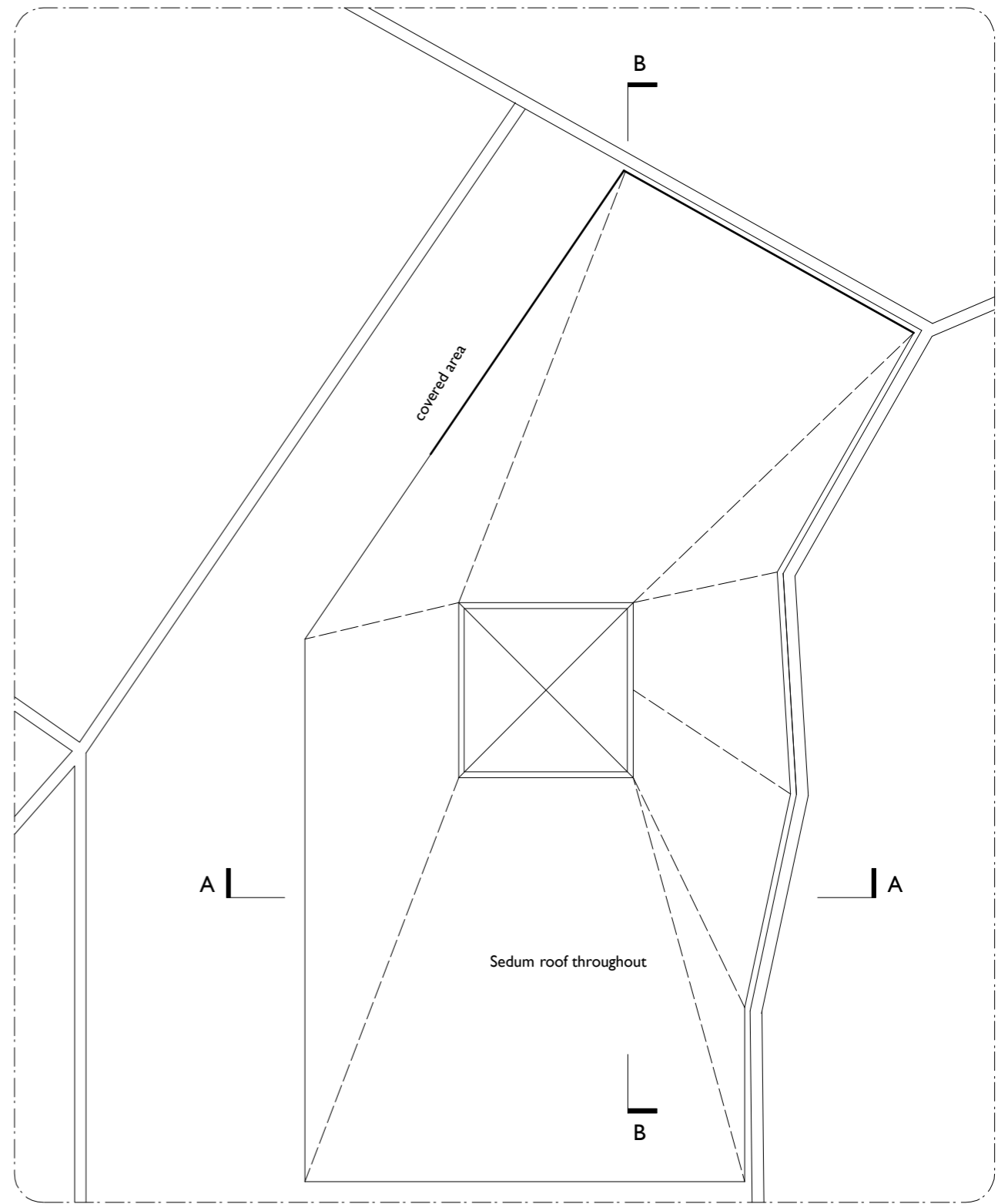

Roof Plan

MARTINS CAMISULI Unit I, 2A Oakford Road, London NW5 1AH Tel 020 7267 86 22

JOB TITLE: 16A Ospringe road London

DRWG TITLE: Proposed Garden Structure

DRWG NO: MC/207(02)_02

SCALE: 1:50 @ A3

DATE: Feb 2021

REVISION: A 290421 General update following planners comments

**ALL DIMENSIONS INDICATED ON THIS DRAWING ARE SUBJECT TO ALTERATIONS ONCE ON SITE.
CONFIRM ALL DIMENSION ON SITE PRIOR TO ORDERING AND CONSTRUCTION**

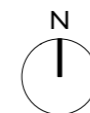

Scale bar

