

DG1

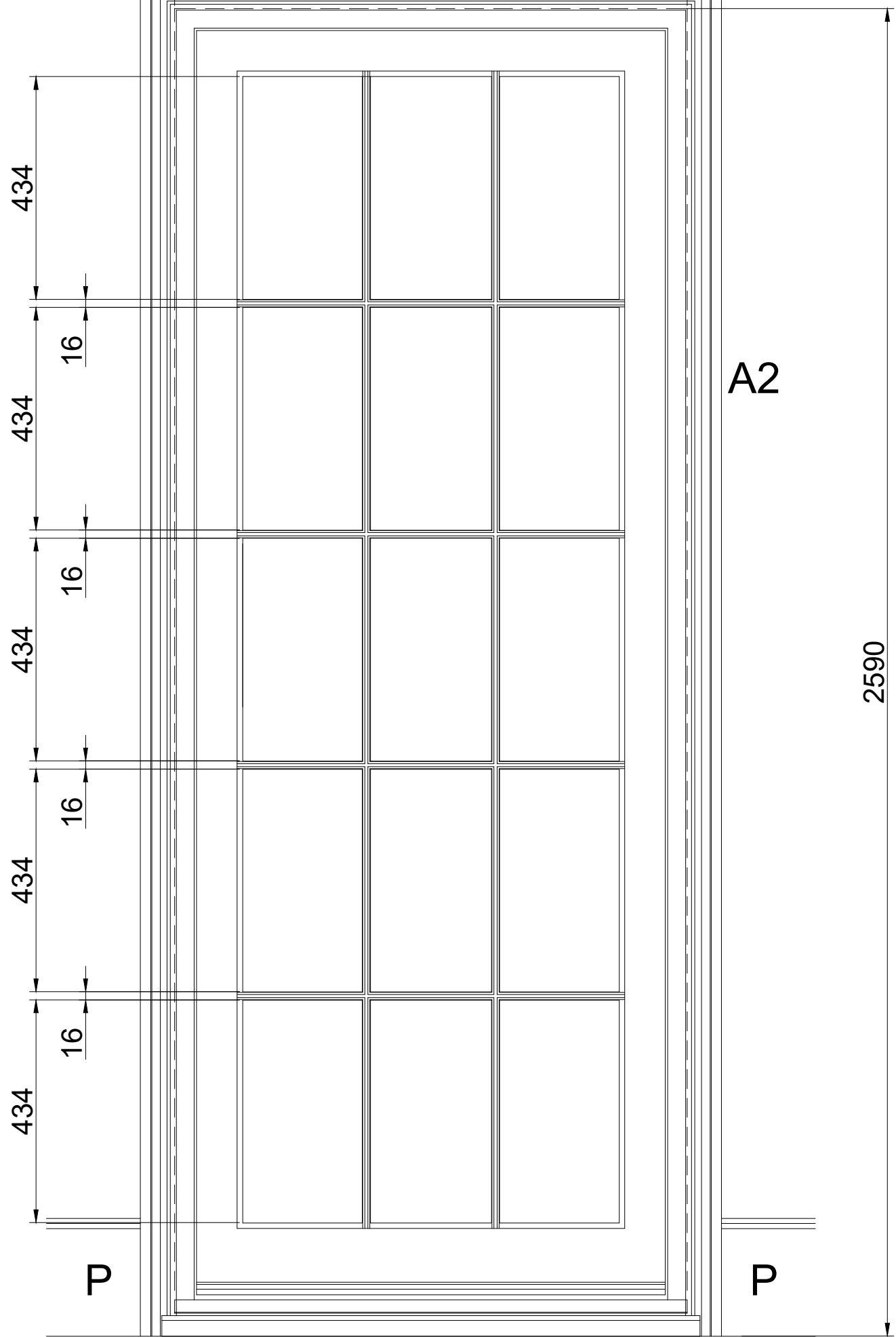

External Ground Floor Door 1:10

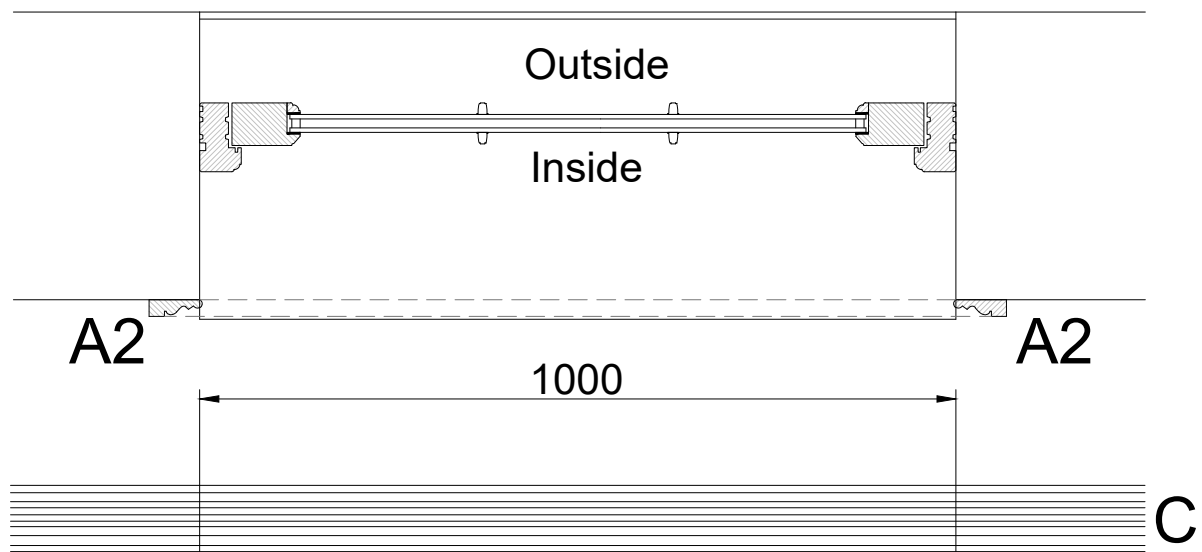
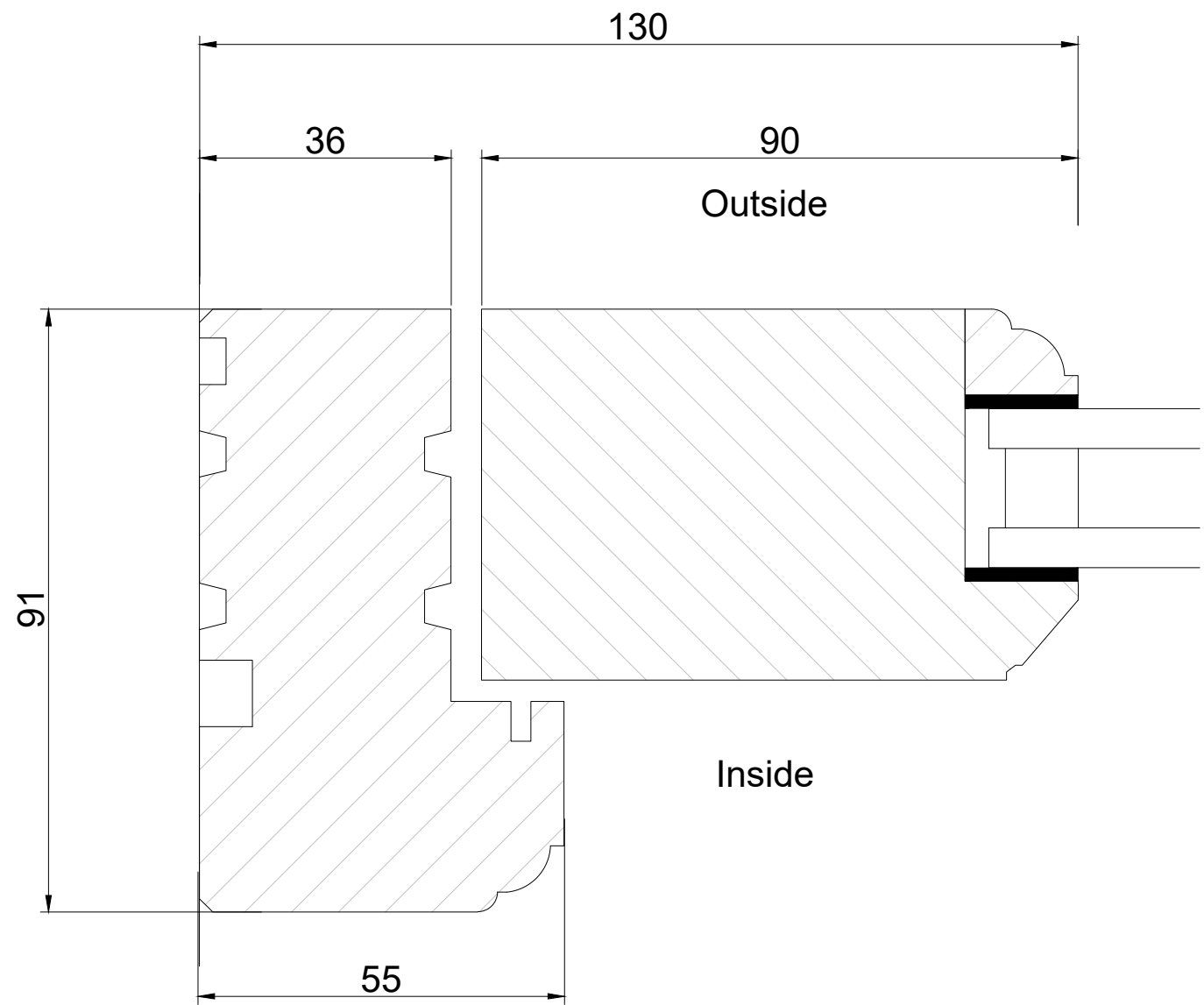
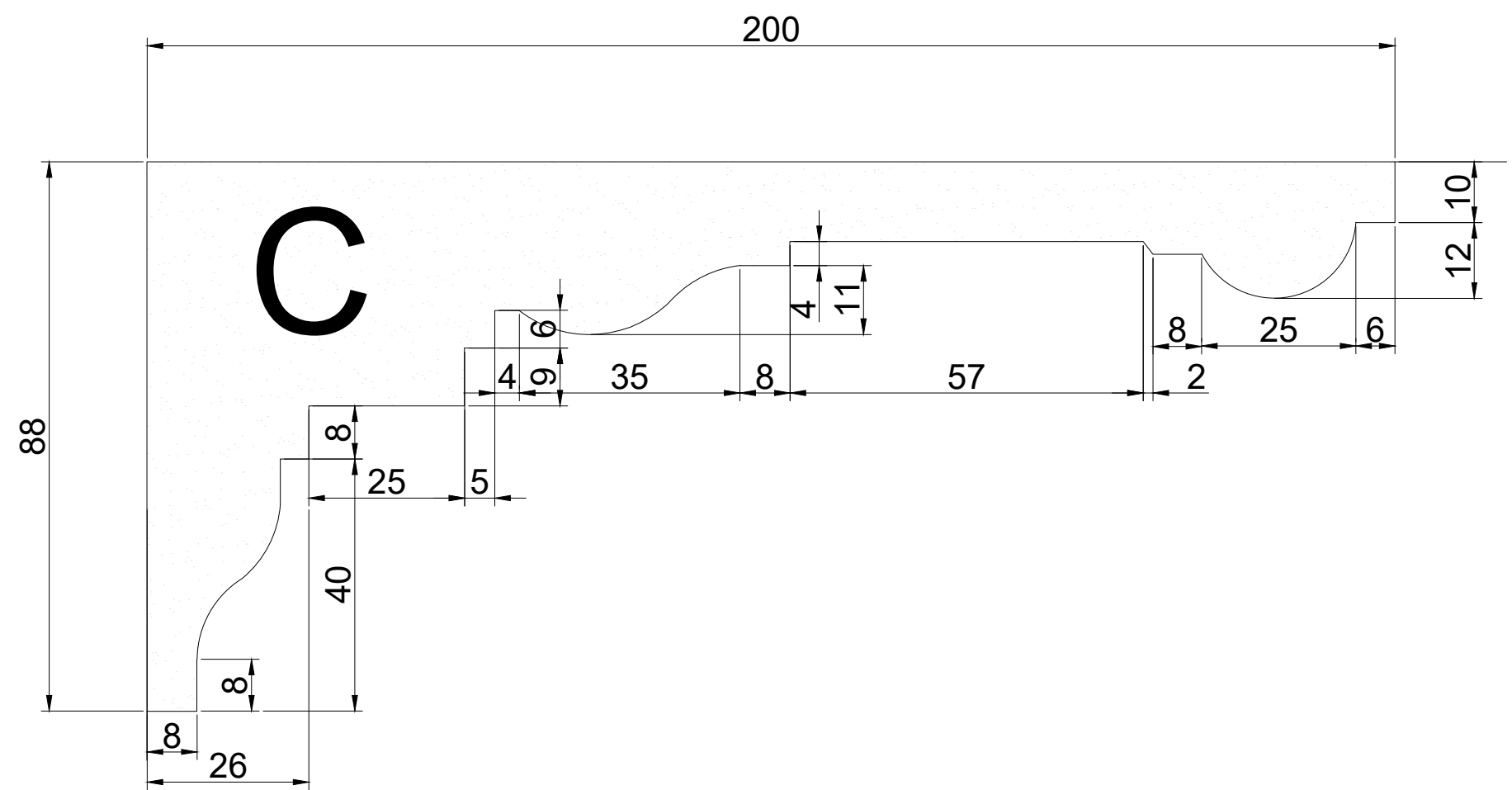
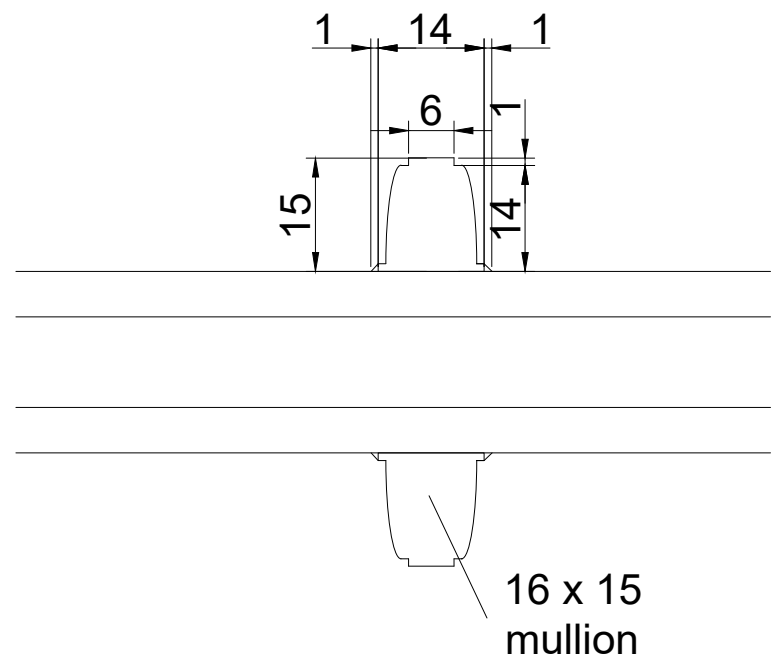

Cornice Details 1:1

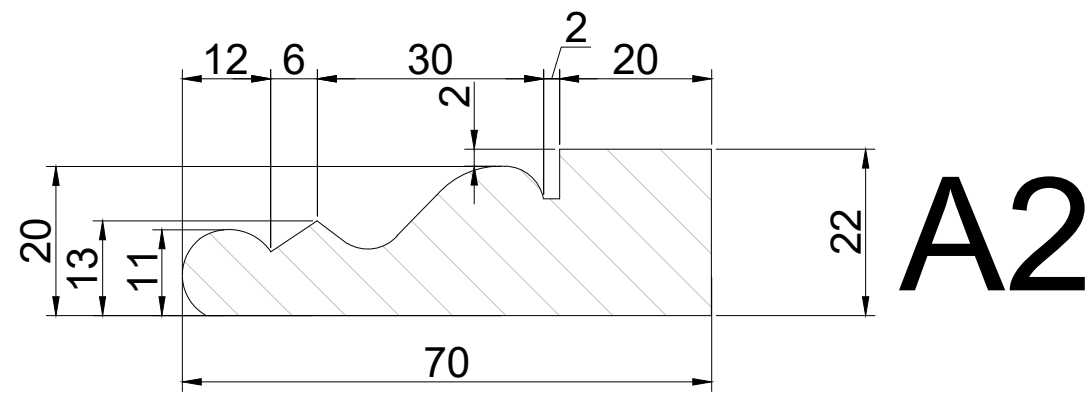

Architrave A2 Details 1:1

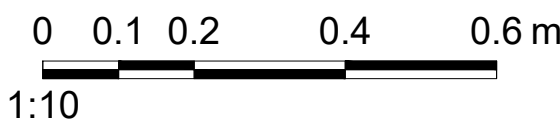

- General Notes
- 1) This drawing is to be read in conjunction with all relevant architects and subcontractors drawings
 - 2) All steel beams and columns are to be grade S355 unless otherwise stated and to be coated with Intumescent paint for a minimum fire protection of 30mins
 - 3) All steel posts and columns to be tied to masonry at 450mm vertical centers. If the post or column is tied to a door opening vertical masonry ties should be used at 225mm vertical centers
 - 4) Do not scale from drawing
 - 5) If in doubt about any of the information presented here, please ask.
 - 6) Min bearing for all Steel beams on padstones or spreader plates is 100mm unless otherwise specified
 - 7) All new masonry blocks to be minimum strength of 3.6N in M4 mortar
 - 8) Contractor responsible for temporary stability and temporary supports during construction

Drawn by	DT	No.	Description	Date
Checked by	MA			

PROJECT	64 Delancey Street London NW1 7RY
CLIENT	Dr Pooja Shah

Proposed Ground Floor External Door Details	DG1
DRAWING REF:	WD 602

Project Ref:	1222
Scale (@ A1)	1/1 1/10
Date	16/03/2021