

01. Substructure

01.1

Prepare the ground where the studio and surrounding SUD's areas will be installed, removing all vegetation and top soil. Treat ground with weed killer and lay geotextile membrane over that will prevent any further vegetation, but allow rainwater to drain to suds layers. depths and locations of the suds to be agreed with building control on site. To be formed in porous materials and / or crates. Above geotextile membrane lay min 40mm of white gravel.

01.2

Studio to be supported on Ground Screws as produced by GBGS Company Ltd or similar approved. Number and size to be confirmed by GBGS / Main Contractor following review of ground conditions.

01.3

Green roof should retain much of the rainwater falling on the studio, but provide a rainwater pipe that empties onto / into the SUD's area. Suds to have min 1.5m3 storage capacity.

02. Super Structure

02.1

Form Floor as one, with all joists fixed together using screws, bolts and timber connectors, all supported by the Ground Screw foundations with a clear 100mm air void under. Joists to be 145x50mm C24 timbers, and doubled on main lines of support. Joists to have trays or Tyvek Supro Breather Membrane fixed between to support 120mm Sheep's Wool Insulation, with Tyvek Vapour check over and 22mm OSB or Plywood deck. Floor finish assumed to be timber strip floor with matt under, but to be to client's specification.

02.2

Form External Walls using 100x50mm impregnated studs, sole plates, mid bracing and head plates, with 12mm OSB or Plywood either side. Build in 100mm Sheep's Wool insulation between studs. Internally fix Tyvek Vapour Check (linked to that in floor and roof) with 25x50mm battens vertically to form a service void for wires and pipes. Clad internally with 12.5mm Plasterboard with taped and scrimmed joints unless otherwise directed by the client. Fit 89x15mm skirtings to walls to cover edge of floor finish, but allowing expansion as required by the manufacturer. Note that the plasterboard linings are not required in the external store and shown finished with plywood, but could have vertical boarding to match outside added should the client prefer this.

Externally fix Tyvek Supro Breather membrane with 22x44mm vertical battens and then 22x44mm horizontal battens, all at 400mm centres and clad with cedar T&G&V jointed boards. To include corner cover strips if required.

02.2

Form Internal Walls to have same base as external walls using 100x50mm impregnated studs, sole plates, mid bracing and head plates, with 12mm OSB or Plywood either side. Build in 100mm Sheep's Wool insulation between studs. Internally fix Tyvek Vapour Check (linked to that in floor and roof) with 12.5mm plasterboard with taped and scrimmed joints to match elsewhere. As stated client may request alternative finish. Where wall is into external store, on that side finish with the plywood or with additional vertical cedar boards to client's requirements. Internal door and lining to be simple flush door, liming 32mm by width to suit wall build up and 44x15mm architraves to match the skirting profile used.

02.3

Form roof using 165x50mm C24 joists at max 400mm centres. Between joists fix 120mm Sheep's Wool Insulation as shown. Run 50x50mm impregnated battens under with 50mm Sheep's Wool insulation between. Build in Tyvek Vapour Check to underside and then fix 50x50mm at right angles to those above, fixed at 400mm centres. Allow void for lights and services. Fix 12.5mm plasterboard with taped and scrimmed joints or as otherwise directed by the client to corm ceiling. In the external store, fix external quality plywood or timber boarding to match external walls to complete ceiling in lieu of plasterboard. Above joists fix 25x50mm battens to provide cross ventilation over the joists and form min 1:80 slope to roof using impregnated firing pieces. Form deck using 18mm external quality WBP plywood and form roof using Bauder Thermofol Membrane system adhered to deck, including all trims to edges as required and in full accordance with Bauder's Instructions, or a similar approved system. Form green roof using the Bauder XF301 sedum blanket, with Bauder AL40 Edge retention / edge Trim secured using additional strip of roof membrane. To have Bauder SDF drainage Mat under sedum. A similar green roof system may be installed providing full details are handed to Building Control. To rear of studio fix gutter and down pipe as shown, type and colour to be agreed with client. Provide 25mm ventilation all round of roof with insect mesh as shown on the detailed drawings.

Note: All products listed may be replaced with similar and equivalent providing the BCO approves prior to Construction

Proposed Garden Studio and Store

Sketch Drawing

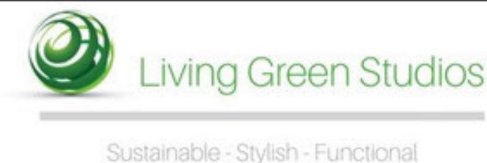

SM12 Architects 12 Maycross Avenue, Morden, Surrey, SM4 4DA • T. 020 7183 2900, E. mail@studio-m12.co.uk		Studio M12 Date: June 2021 Scale: 1:25 @ A3	
Drawing Title: Floor Plan	Drawing No: MB	Purpose: BR	Revision: P2

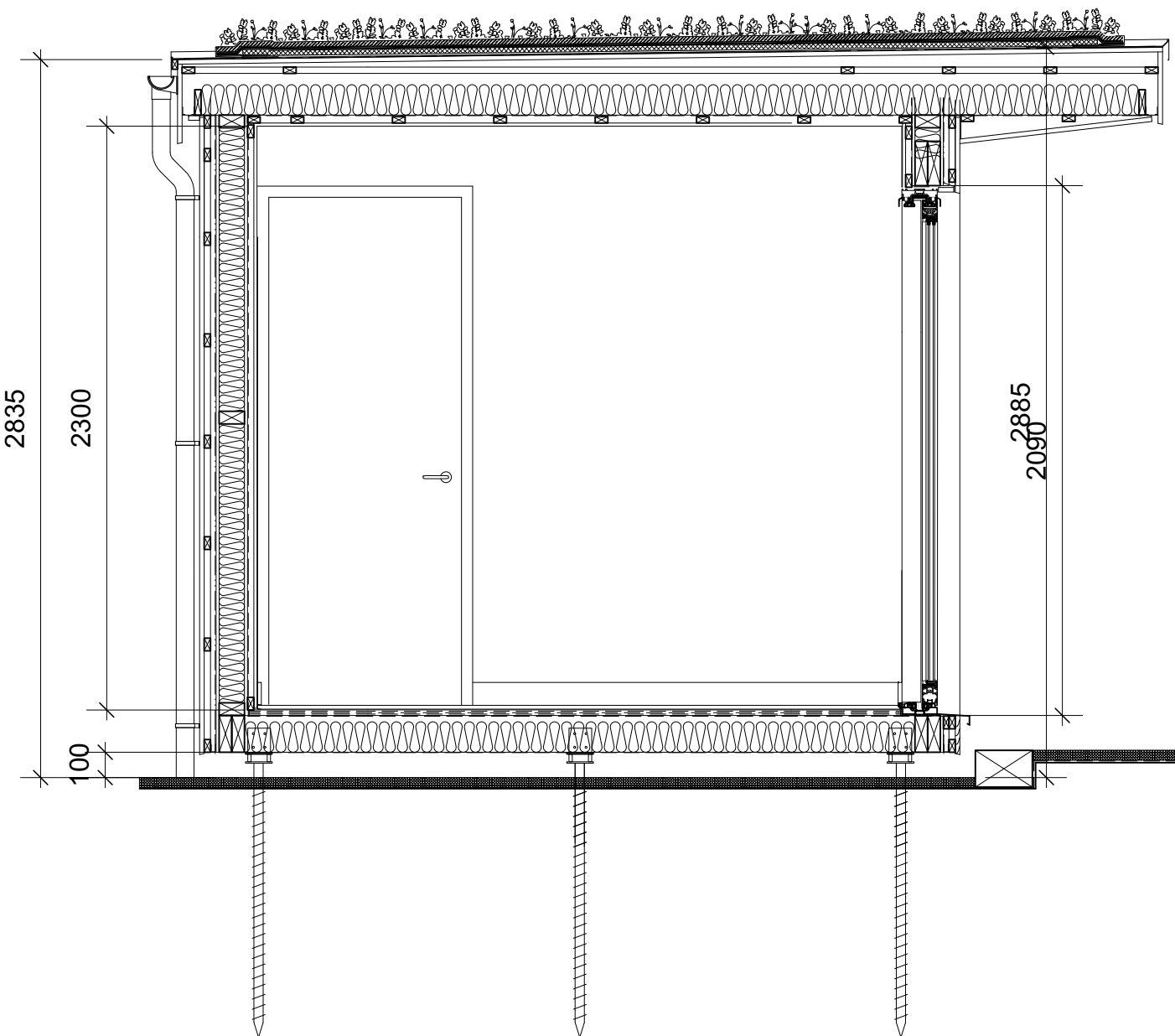

01. Substructure

01.1

Prepare the ground where the studio and surrounding SUD's areas will be installed, removing all vegetation and top soil. Treat ground with weed killer and lay geotextile membrane over that will prevent any further vegetation, but allow rainwater to drain to suds layers. depths and locations of the suds to be agreed with building control on site. To be formed in porous materials and / or crates. Above geotextile membrane lay min 40mm of white gravel.

01.2

Studio to be supported on Ground Screws as produced by GBGS Company Ltd or similar approved. Number and size to be confirmed by GBGS / Main Contractor following review of ground conditions.

01.3

Green roof should retain much of the rainwater falling on the studio, but provide a rainwater pipe that empties onto / into the SUD's area. Suds to have min 1.5m³ storage capacity.

02. Super Structure

02.1

Form Floor as one, with all joists fixed together using screws, bolts and timber connectors, all supported by the Ground Screw foundations with a clear 100mm air void under. Joists to be 145x50mm C24 timbers, and doubled on main lines of support. Joists to have trays or Tyvek Supro Breather Membrane fixed between to support 120mm Sheep's Wool Insulation, with Tyvek Vapour check over and 22mm OSB or Plywood deck. Floor finish assumed to be timber strip floor with matt under, but to be to client's specification.

02.2

Form External Walls using 100x50mm impregnated studs, sole plates, mid bracing and head plates, with 12mm OSB or Plywood either side. Build in 100mm Sheep's Wool insulation between studs. Internally fix Tyvek Vapour Check (linked to that in floor and roof) with 25x50mm battens vertically to form a service void for wires and pipes. Clad internally with 12.5mm Plasterboard with taped and scrimmed joints unless otherwise directed by the client. Fit 89x15mm skirtings to walls to cover edge of floor finish, but allowing expansion as required by the manufacturer. Note that the plasterboard linings are not required in the external store and shown finished with plywood, but could have vertical boarding to match outside added should the client prefer this.

Externally fix Tyvek Supro Breather membrane with 22x44mm vertical battens and then 22x44mm horizontal battens, all at 400mm centres and clad with cedar T&G&V jointed boards. To include corner cover strips if required.

02.2

Form Internal Walls to have same base as external walls using 100x50mm impregnated studs, sole plates, mid bracing and head plates, with 12mm OSB or Plywood either side. Build in 100mm Sheep's Wool insulation between studs. Internally fix Tyvek Vapour Check (linked to that in floor and roof) with 12.5mm plasterboard with taped and scrimmed joints to match elsewhere. As stated client may request alternative finish. Where wall is into external store, on that side finish with the plywood or with additional vertical cedar boards to client's requirements. Internal door and lining to be simple flush door, liming 32mm by width to suit wall build up and 44x15mm architraves to match the skirting profile used.

02.3

Form roof using 165x50mm C24 joists at max 400mm centres. Between joists fix 120mm Sheep's Wool Insulation as shown. Run 50x50mm impregnated battens under with 50mm Sheep's Wool insulation between. Build in Tyvek Vapour Check to underside and then fix 50x50mm at right angles to those above, fixed at 400mm centres. Allow void for lights and services. Fix 12.5mm plasterboard with taped and scrimmed joints or as otherwise directed by the client to corm ceiling. In the external store, fix external quality plywood or timber boarding to match external walls to complete ceiling in lieu of plasterboard. Above joists fix 25x50mm battens to provide cross ventilation over the joists and form min 1:80 slope to roof using impregnated firing pieces. Form deck using 18mm external quality WBP plywood and form roof using Bauder Thermofol Membrane system adhered to deck, including all trims to edges as required and in full accordance with Bauder's Instructions, or a similar approved system. Form green roof using the Bauder XF301 sedum blanket, with Bauder AL40 Edge retention / edge Trim secured using additional strip of roof membrane. To have Bauder SDF drainage Mat under sedum. A similar green roof system may be installed providing full details are handed to Building Control. To rear of studio fix gutter and down pipe as shown, type and colour to be agreed with client. Provide 25mm ventilation all round of roof with insect mesh as shown on the detailed drawings.

Note: All products listed may be replaced with similar and equivalent providing the BCO approves prior to Construction

Proposed Garden Studio and Store

Sketch Drawing

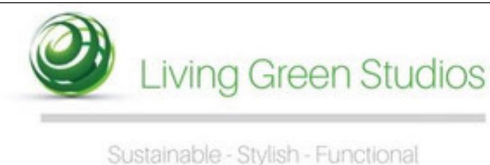

SM12 Architects		Studio M12	
12 Maycross Avenue, Morden, Surrey, SM4 4DA • T. 020 7183 2900, E. mail@studio-m12.co.uk			
Drawing Title:	June 2021	Date:	Scale: 1:25 @ A3
Drawn By:	MB	Purpose:	BR
Drawing Number:	A501:WD:202	Revision:	P2

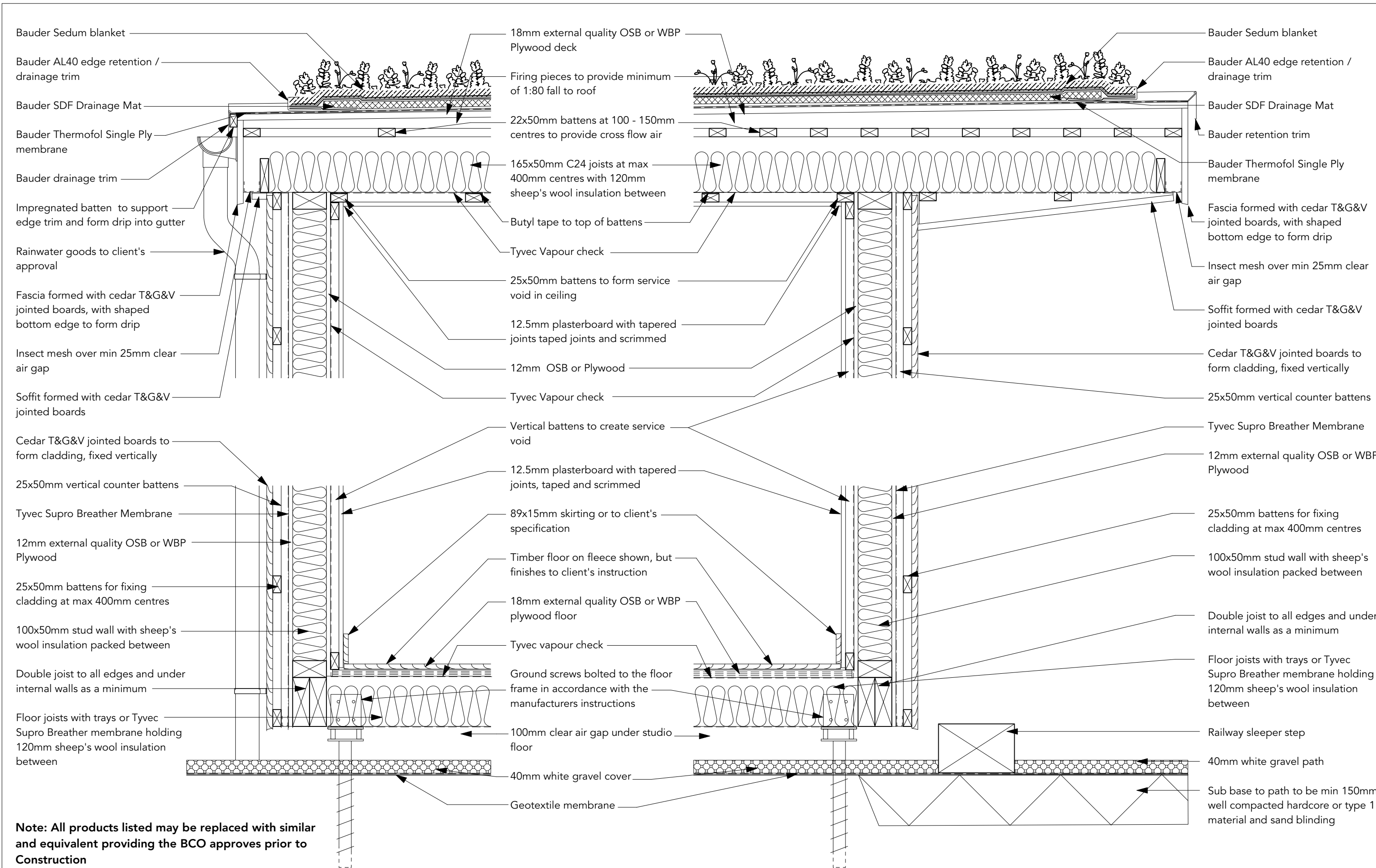

Note: All products listed may be replaced with similar and equivalent providing the BCO approves prior to Construction

Rev. No.	Rev. Details	Rev. Date

Proposed Garden Studio and Store

Sketch Drawing



SM12		Studio_M12	
Architects			
12 Maycross Avenue, Morden, Surrey, SM4 4DA • T. 020 7183 2900, E. mail@studio-m12.co.uk			
Client:	June 2021	Scale:	1:10 @ A3
Drawn By:	MB	Purpose:	BR
Drawing Number:	A501:WD:301		Revision:
			P2

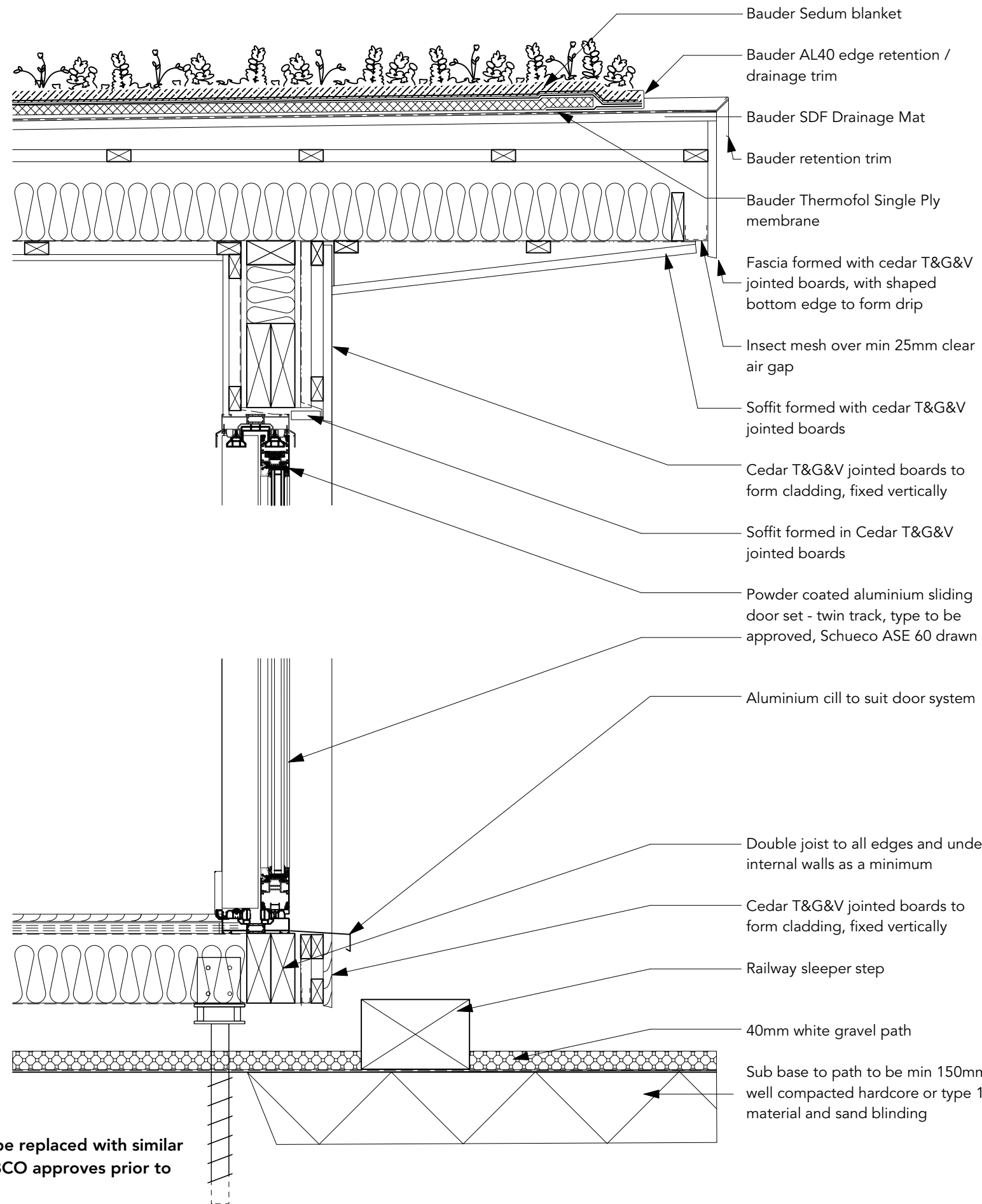

Note: All products listed may be replaced with similar and equivalent providing the BCO approves prior to Construction

Rev. No.	Rev. Details	Rev. Date

Proposed Garden Studio and Store

Sketch Drawing

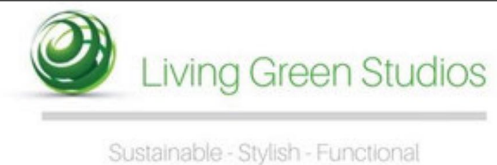

SM12		Studio M12	
Architects			
12 Maycross Avenue, Morden, Surrey, SM4 4DA • T. 020 7183 2900, E. mail@studio-m12.co.uk			
Drawing No:		Date:	Scale:
Detail Sheet 02		June 2021	1:10 @ A3
Drawn By:	Purpose:		
MB	BR		
Drawing Number:		Revision:	
A501:WD:302		P2	