

Tel: 020 8921 5222



Mr Hussain  
Flat 59  
1 Pilot Walk  
Greenwich  
SE10 0UN

**Directorate of Regeneration,  
Enterprise & Skills**  
The Woolwich Centre, 5th Floor  
35 Wellington Street  
London, SE18 6HQ

**20/0203/CP**

10 August 2020

**CERTIFICATE OF LAWFUL USE OR DEVELOPMENT  
(PROPOSED) GRANTED**

Dear Mr Hussain,

**Town & Country Planning Act 1990 : Section 192  
(as amended by Section 10 of the Planning and Compensation Act 1991)  
Town & Country Planning (Development Management Procedure)(England) Order 2015  
Town & Country Planning (General Permitted Development)(England) Order 2015**

**Site: FLAT 59, 1 PILOT WALK, GREENWICH, LONDON, SE10 0UN**  
**Applicant: Mr Hussain**  
**Proposal: A lawful development certificate (proposed) is sought for the change of use of part of the flat to an administrative office (Private Hire Vehicle Operator).**  
**Drawings** Layout Plan and Site Location Plan

The Royal Borough of Greenwich hereby certify that on 22 January 2020 the **Use** described in the proposal in respect of the land specified in the site and shaded on the plan attached to this certificate **would have been** lawful within the meaning of Section 192 of the Town and Country Planning Act 1990 (as amended), for the following reason(s)

The proposed administration office would not materially affect the appearance of the property or its primary use as a family home; therefore planning permission is not required. The development is considered to be permitted under Part III, Section 55, Paragraph 2 (a) of the Town and Country Planning Act 1990, as amended.

Yours faithfully



Assistant Director

SITE PLAN Reference: 20/0203/CP

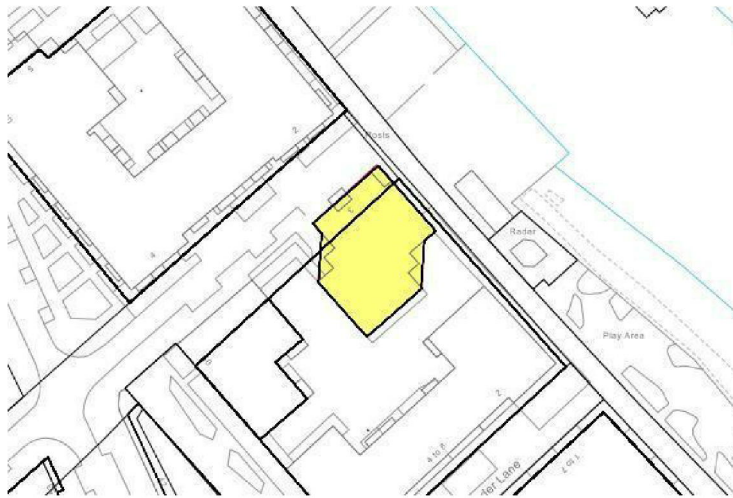

Location: FLAT 59, 1 PILOT WALK, GREENWICH, LONDON, SE10 0UN

## **SCHEDULE OF INFORMATIVE(S)**

Application Reference: 20/0203/CP

At: FLAT 59, 1 PILOT WALK, GREENWICH, LONDON, SE10 0UN

1. The Certificate of Lawfulness has been approved on the basis that the applicant will be the only person to use the dwellinghouse for taking bookings over the phone and via email at Flat 59, 1 Pilot Walk
2. The Certificate of Lawfulness has been approved on the basis that there will be no members of the public nor drivers accessing Flat 59, 1 Pilot Walk in order to use the administration office.

### Notes

1. This certificate is issued solely for the purpose of section 191/192 of the Town and Country Planning Act 1990 (as amended).
2. It certifies that the **Use** specified in the proposal taking place on the site described above **would have been** lawful, on the specified date and, thus, **was not** liable to enforcement action under section 172 of the Act on that date.
3. This certificate applies only to the extent of the **Use** described in the proposed and to the site specified above and identified on the attached plan. Any **Use** which is materially different from that described or which relates to other land may render the owner or occupier liable to enforcement action.
4. The effect of the certificate is also qualified by the provision in section 192(4) of the 1990 Act, as amended, which states that the lawfulness of a described use or operation is only conclusively presumed where there has been no material change, before the use is instituted or the operation begun, in any of the matters relevant to determining lawfulness.

### Notes

*The Council in assessing the merits of this application have taken into consideration the provisions of the National Planning Policy Framework*

*You are reminded that you may also require approval under the Building Regulations. Advice and application forms can be obtained from Building Control at this address, by telephone on 020 8921 5413 or by emailing [building.control@royalgreenwich.gov.uk](mailto:building.control@royalgreenwich.gov.uk)*