

Waste and Recycling Plan:

The restaurant to be in contract with a private waste collation company (or local council’s waste collection if they collect commercial waste twice a week), which collect the commercial waste twice a week.

To store the waste internally, two 240L internal plastic bin are provided in the basement, which is sufficient to store three days’ waste.

Two 240L plastic bins to be sufficient to store the three days’ waste. A figure below shows the location of bins in the basement.

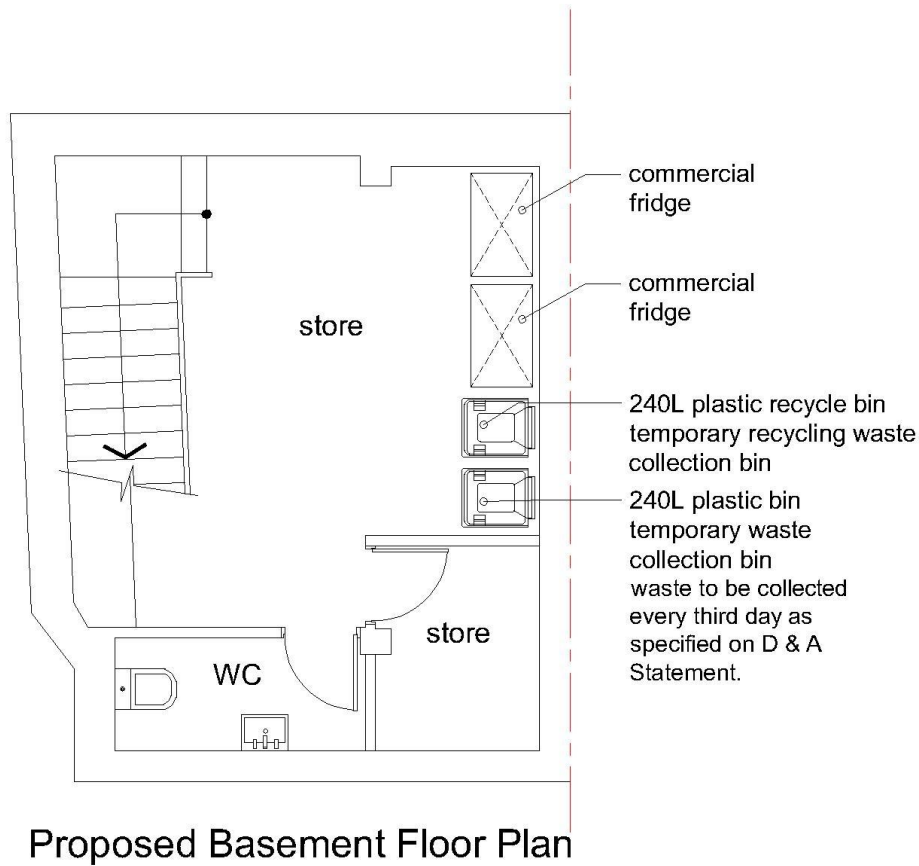

The bin sacks to be placed outside the premises (as mentioned on the figure below) on the day of collection two hours prior to the collection time.

