

Proposed Basement Floor Plan

1:100

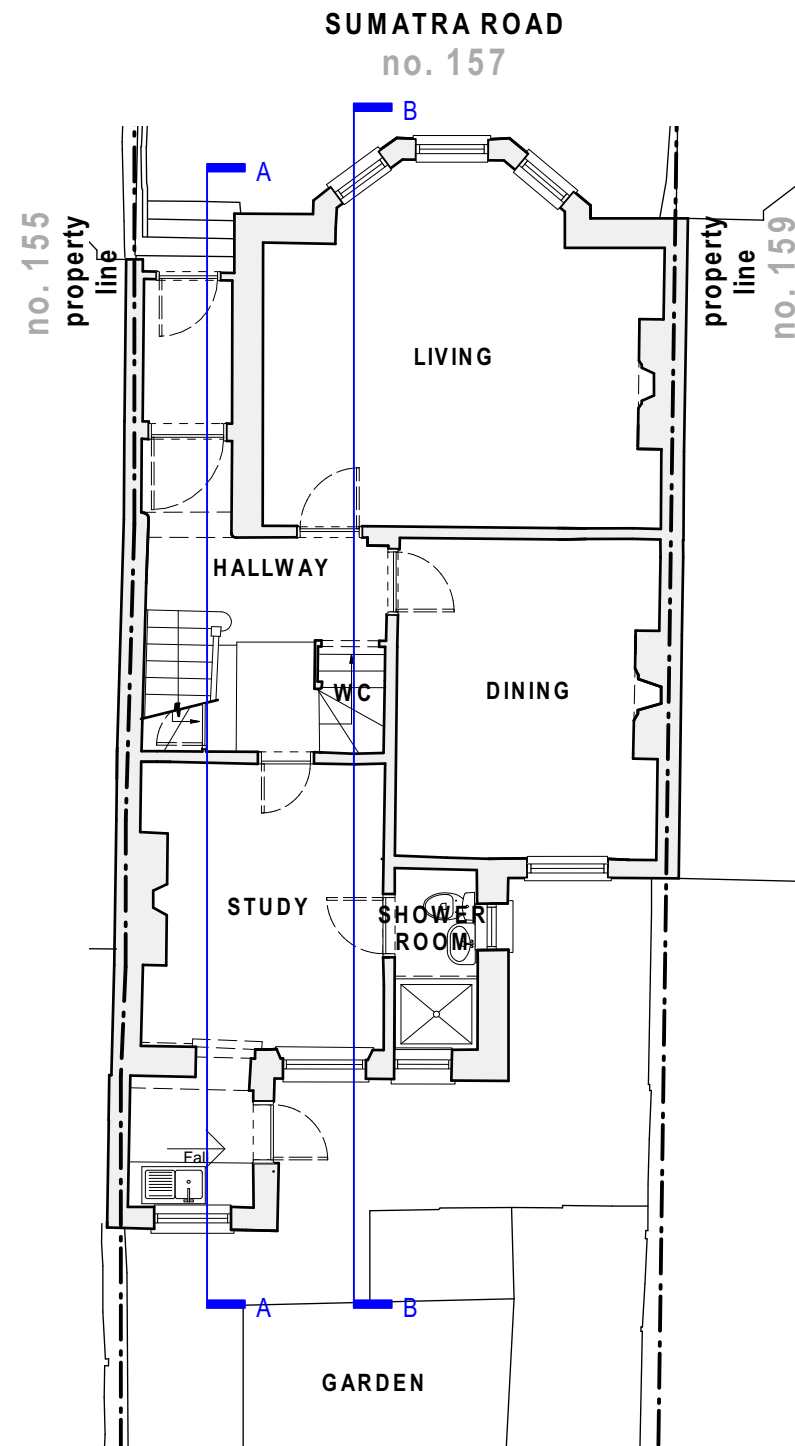

Proposed Ground Floor Plan

1:100

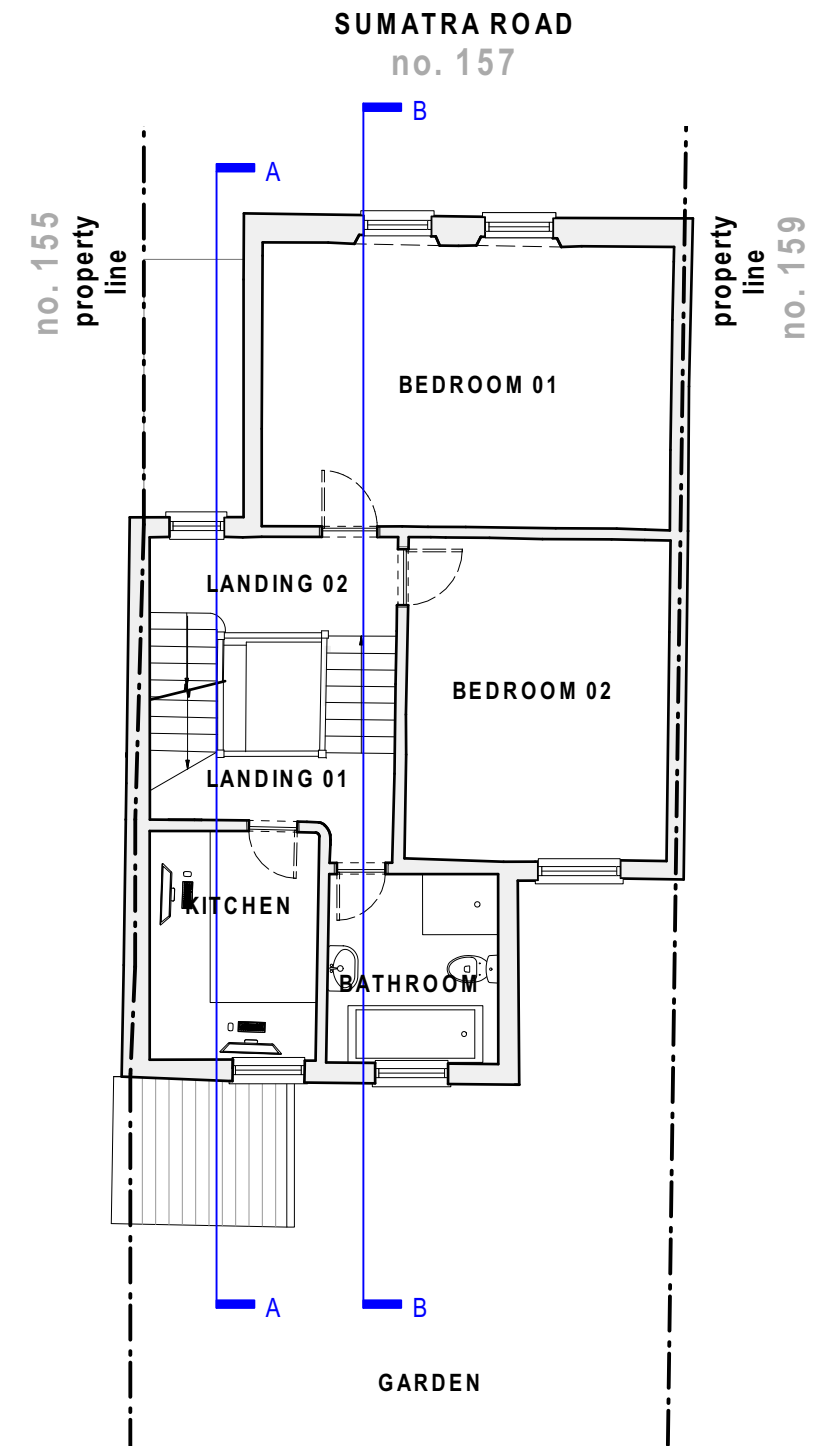

Proposed First Floor Plan

1:100

Key

- ① New L-shape dormer extension.

<table border="1"> <thead> <tr> <th>Rev:</th> <th>Date:</th> <th>Description:</th> </tr> </thead> <tbody> <tr> <td>00</td> <td>07.05.2021</td> <td>Issue for comment</td> </tr> <tr> <td>01</td> <td>15.05.2021</td> <td>Issue for planning</td> </tr> </tbody> </table>	Rev:	Date:	Description:	00	07.05.2021	Issue for comment	01	15.05.2021	Issue for planning		Project: 157 Sumatra Road NW6 1PN	
Rev:	Date:	Description:										
00	07.05.2021	Issue for comment										
01	15.05.2021	Issue for planning										
		Dwg no: 2110 / PL.05										
		Drawing: Proposed Floor Plans B1, 00 & 01										
NOTES: Do not scale from this drawing. All dimensions in millimeters. All dimensions to be checked on site. All omissions and discrepancies to be reported to the architect immediately. This drawing is © betterPAD.		Date: May 2021 Scale: 1:100 @ A3	<table border="1"> <tr> <td>C</td> <td>D</td> <td>Rev:</td> <td>01</td> </tr> <tr> <td>bP</td> <td>bP</td> <td></td> <td></td> </tr> </table>	C	D	Rev:	01	bP	bP			W www.betterpad.co.uk E hello@betterpad.co.uk
C	D	Rev:	01									
bP	bP											

Planning