

Existing Plan 1:100

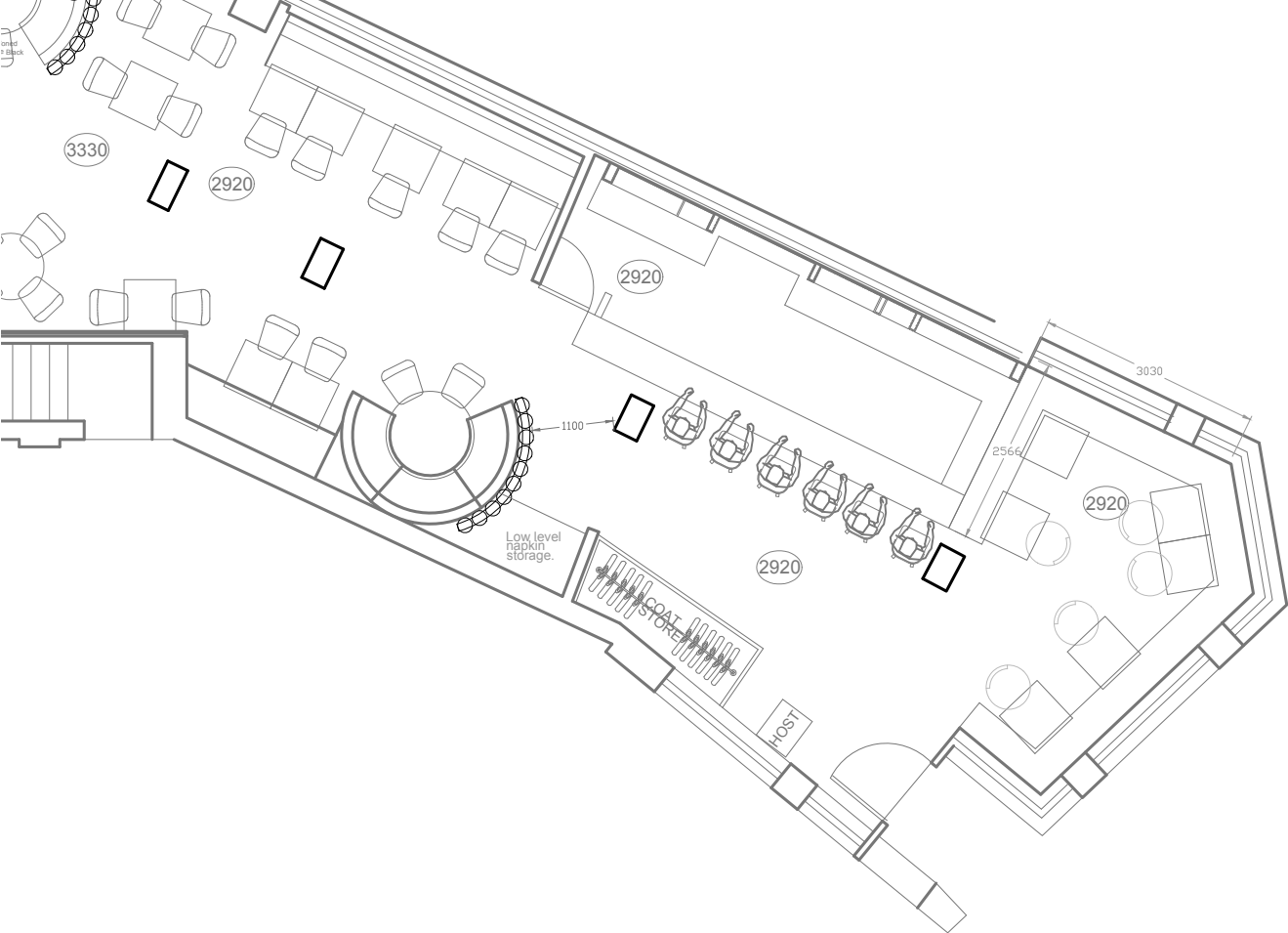

Existing Site Plan 1:1250

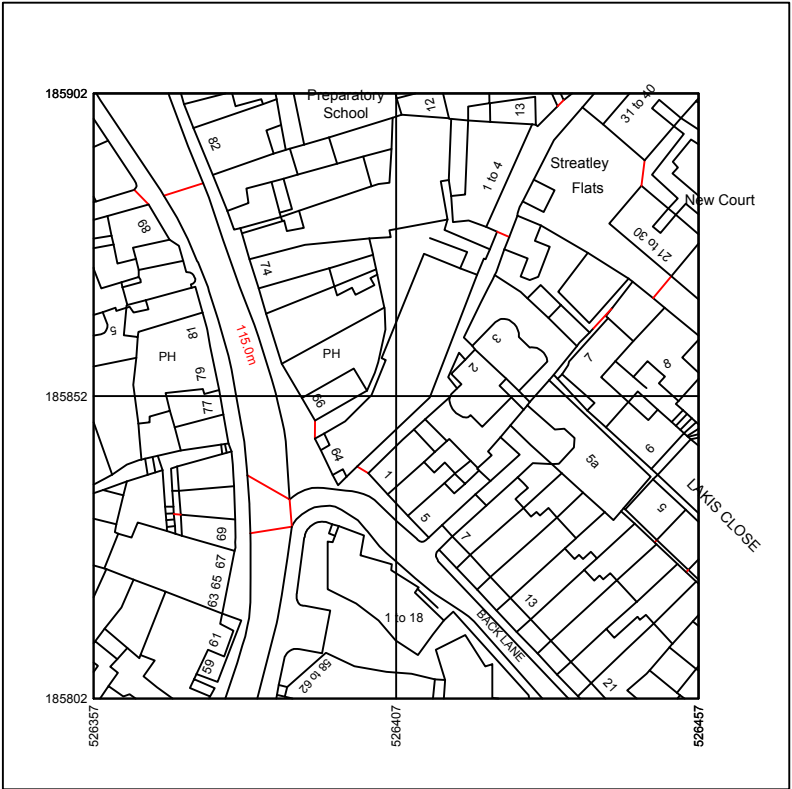

<div><div>RARE</div><div>RESTAURANTS</div></div>	GENERAL NOTES	7. All finishes are to be implemented to a high quality.	Original	22.02.21	<div>Emily Marlborough</div> <div>Telephone: 0203 277 7776</div> <div>e-mail: emily@mrestaurants.co.uk</div>	Project: Gaucho Hampstead			
	1. All finishes are to conform to the required current Building Codes & Regulations in the applicable country.	8. Any dimensions are to be taken from the setting out plan only and are not to be scaled from the the drawings.				Client: Rare Restaurants			
	2. The Contractor must verify all site dimensions, drawings, details and specifications and report any discrepancies to Rare Restaurants before proceeding with any work.	9. It is the contractors responsibility to ensure that any building works are carried out in accordance with current Building Regulations and Local Authority requirements.				Drawing Title: Existing Plan			
	3. All requested drawings showing fixings and construction details are required to be approved by Rare Restaurants prior to commencement of work.	10. The contractor is to check and appraise all design and construction details and offer alternatives, as appropriate, to implement the design.							
	5. All specified items are to be installed in accordance with the manufacturers recommendations on a suitable substrate.	11. In the event that there is a conflict in information, the Contractor is to highlight the discrepancies to the designer / Contract Administrator.							
	6. The Contractor is to provide a safe and suitable working environment which conforms to the current Health and Safety and Local Authority regulations.	12. This drawing is to read in conjunction with the other relevant drawings, specifications, schedules and co-consultants information.				Status: Customer Approval	Scale: 1:100/1250	Size: A3	Drawing Number: 220221GHAMPSTEADE

Proposed Weekend Plan Sat - Sun 1:100

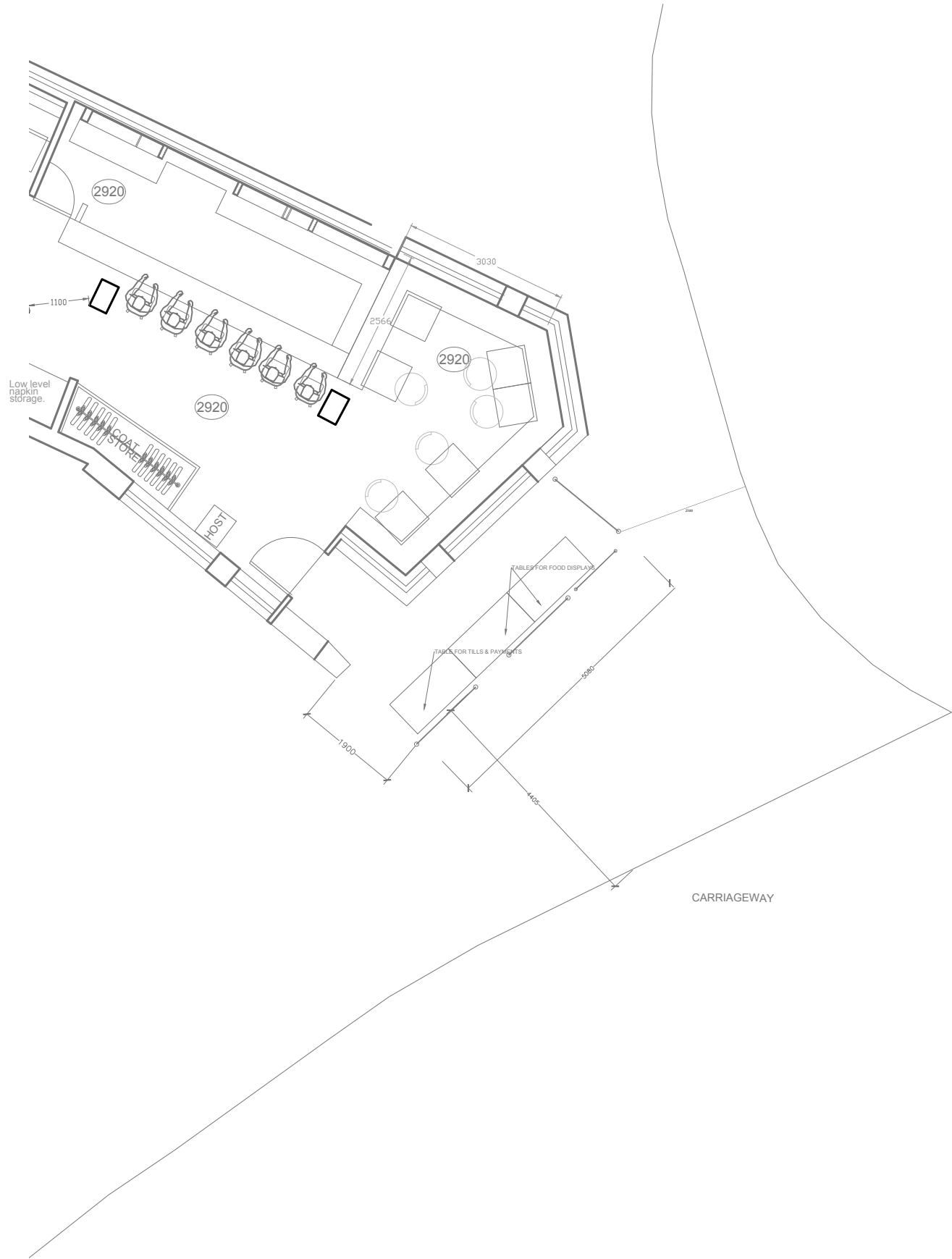

<div>RARE</div> <div>RESTAURANTS</div>	<p>GENERAL NOTES</p> <p>1. All finishes are to conform to the required current Building Codes &amp; Regulations in the applicable country.</p> <p>2. The Contractor must verify all site dimensions, drawings, details and specifications and report any discrepancies to Rare Restaurants before proceeding with any work.</p> <p>3. All requested drawings showing fixings and construction details are required to be approved by Rare Restaurants prior to commencement of work.</p> <p>5. All specified items are to be installed in accordance with the manufacturers recommendations on a suitable substrate.</p> <p>6. The Contractor is to provide a safe and suitable working environment which conforms to the current Health and Safety and Local Authority regulations.</p> <p>7. All finishes are to be implemented to a high quality.</p> <p>8. Any dimensions are to be taken from the setting out plan only and are not to be scaled from the the drawings.</p> <p>9. It is the contractors responsibility to ensure that any building works are carried out in accordance with current Building Regulations and Local Authority requirements.</p> <p>10. The contractor is to check and appraise all design and construction details and offer alternatives, as appropriate, to implement the design.</p> <p>11. In the event that there is a conflict in information, the Contractor is to highlight the discrepancies to the designer / Contract Administrator.</p> <p>12. This drawing is to read in conjunction with the other relevant drawings, specifications, schedules and co-consultants information.</p>			Original	22.02.21	<div>Emily Marlborough</div> <div>Telephone: 0203 277 7776</div> <div>e-mail: emily@mrestaurants.co.uk</div>		<div>Project: Gaucho Hampstead</div> <div>Client: Rare Restaurants</div> <div>Drawing Title: Proposed Site Plans</div>	
						Status: Customer Approval	Scale: 1:100	Size: A3	Drawing Number: 220221GHAMPSTEADP1