

KEY	REV	DATE	DESCRIPTION	KEY	CLIENT	NOTE	LOCATION	WHITE RED ARCHITECTS						
	P1	17/05/21	Planning Issue		ARTA	<div>1. Do not scale from this drawing.</div> <div>2. All dimensions to be checked on site by the contractor and such dimensions to be their responsibility.</div> <div>3. Report all drawings errors, omissions, and discrepancies to the architect.</div> <div>4. This document may be issued in an uncontrolled CAD format to enable others to use it as background information to make alterations and/or additions. In that instance the file will be accompanied by a PDF version. It is for those making such alterations and additions to ensure that they make use of current background information. WRA Ltd Accepts no liability for any such alterations or additions to the background information or arising out of changes to background information which occur prior to alterations or additions being made.</div>	23-35 Adelaide Road London, NW3 3QB	white-red.co.uk T (+44) 20 78 594521 45 Charlotte Road, London, EC2A 3PD						
								PROJECT NAME:						
								ADELAIDE ROAD						
								DRAWING TITLE:						
								EXISTING GROUND (no. 23-27)						
								DRAWN		CHECKED	SCALE @A3		STATUS	
								FB		JH	1:100		PLANNING	
								PROJECT No.		ZONE	TYPE	SHEET No.		REVISION
								5391				01_100		P1
							NOT FOR CONSTRUCTION							

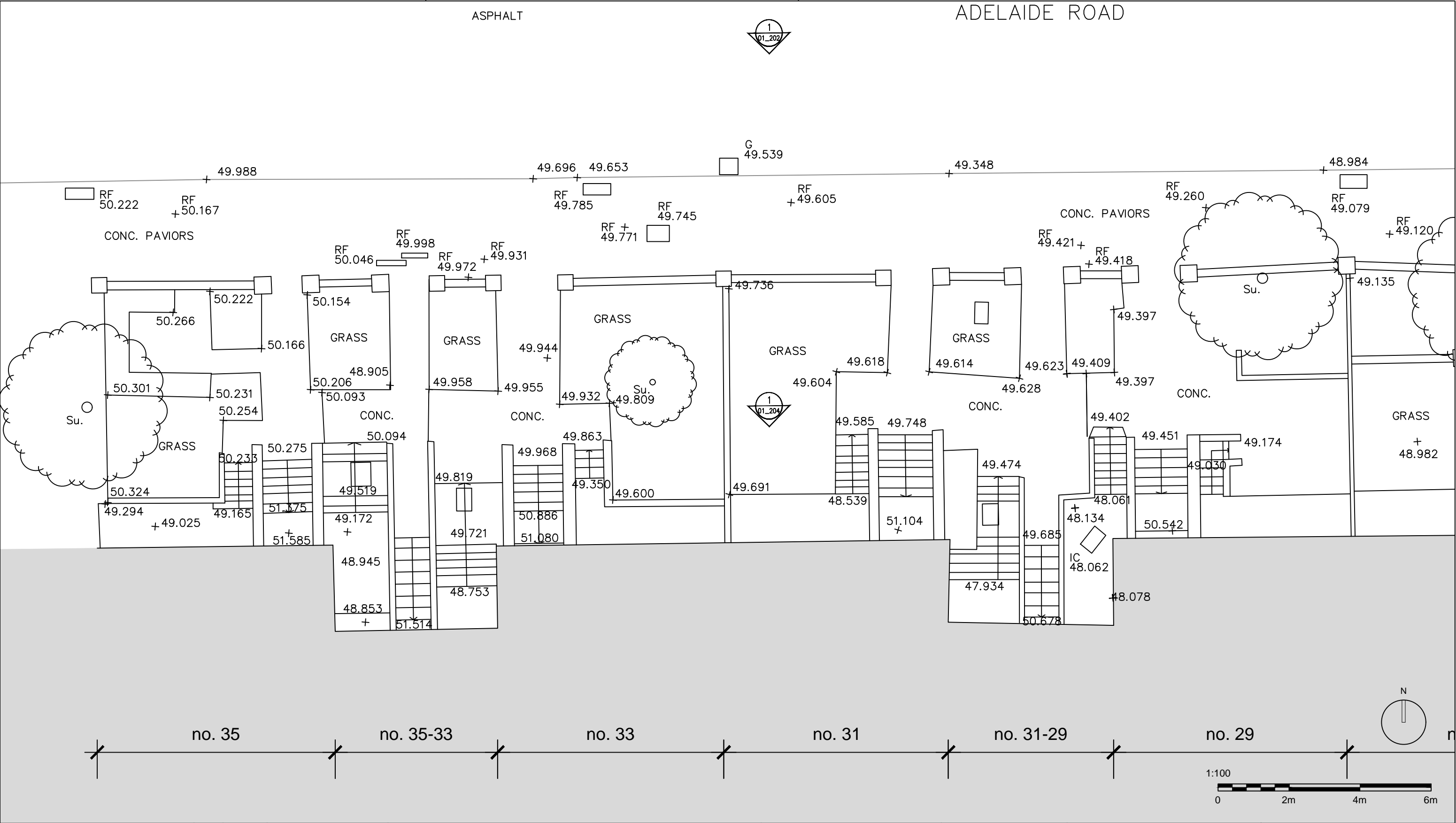

KEY	REV	DATE	DESCRIPTION	KEY	CLIENT	NOTE	LOCATION	WHITE RED ARCHITECTS					
	P1	17/05/21	Planning Issue		ARTA	1. Do not scale from this drawing. 2. All dimensions to be checked on site by the contractor and such dimensions to be their responsibility. 3. Report all drawings errors, omissions, and discrepancies to the architect. 4. This document may be issued in an uncontrolled CAD format to enable others to use it as background information to make alterations and/or additions. In that instance the file will be accompanied by a PDF version. It is for those making such alterations and additions to ensure that they make use of current background information. WRA Ltd Accepts no liability for any such alterations or additions to the background information or arising out of changes to background information which occur prior to alterations or additions being made.	23-35 Adelaide Road London, NW3 3QB	white-red.co.uk T (+44) 20 78 594521 45 Charlotte Road, London, EC2A 3PD					
								PROJECT NAME:					
								ADELAIDE ROAD					
								DRAWING TITLE:					
								EXISTING GROUND (no. 29-35)					
								DRAWN		CHECKED	SCALE @A3	STATUS	
								FB	JH	1:100		PLANNING	
								PROJECT No.		ZONE	TYPE	SHEET No.	REVISION
									5391			01_101	P1

NOT FOR CONSTRUCTION



KEY	REV	DATE	DESCRIPTION	KEY
	P1	17/05/21	Planning Issue	

CLIENT	NOTE	LOCATION	WHITE RED ARCHITECTS				
ARTA	<div>1. Do not scale from this drawing.</div> <div>2. All dimensions to be checked on site by the contractor and such dimensions to be their responsibility.</div> <div>3. Report all drawings errors, omissions, and discrepancies to the architect.</div> <div>4. This document may be issued in an uncontrolled CAD format to enable others to use it as background information to make alterations and/or additions. In that instance the file will be accompanied by a PDF version. It is for those making such alterations and additions to ensure that they make use of current background information. WRA Ltd Accepts no liability for any such alterations or additions to the background information or arising out of changes to background information which occur prior to alterations or additions being made.</div>	23-35 Adelaide Road London, NW3 3QB	<div>white-red.co.uk T (+44) 20 78 594521 45 Charlotte Road, London, EC2A 3PD</div>				
		PROJECT NAME:					
		ADELAIDE ROAD					
		DRAWING TITLE:					
		EXISTING FRONT ELEVATION (no. 29-35)					
		DRAWN	CHECKED	SCALE @A3		STATUS	
		FB	JH	1:100		PLANNING	
		PROJECT No.		ZONE	TYPE	SHEET No.	REVISION
		5391				01_202	P1

NOT FOR CONSTRUCTION



KEY	REV	DATE	DESCRIPTION	KEY	CLIENT	NOTE 1. Do not scale from this drawing. 2. All dimensions to be checked on site by the contractor and such dimensions to be their responsibility. 3. Report all drawings errors, omissions, and discrepancies to the architect. 4. This document may be issued in an uncontrolled CAD format to enable others to use it as background information to make alterations and/or additions. In that instance the file will be accompanied by a PDF version. It is for those making such alterations and additions to ensure that they make use of current background information. WRA Ltd Accepts no liability for any such alterations or additions to the background information or arising out of changes to background information which occur prior to alterations or additions being made.	LOCATION 23-35 Adelaide Road London, NW3 3QB
-----	-----	------	-------------	-----	--------	--	--

