

General Notes
 Do not scale from this drawing
 All dimensions to be verified on site
 To be read in conjunction with all relevant documents
 In the event of discrepancy notify the Architect immediately
 This document is copyright of Hugh Cullum Architects Ltd

Issue Status
 SK Sketch E Existing Condition
 D Design P Permissions
 T Tender C Contract

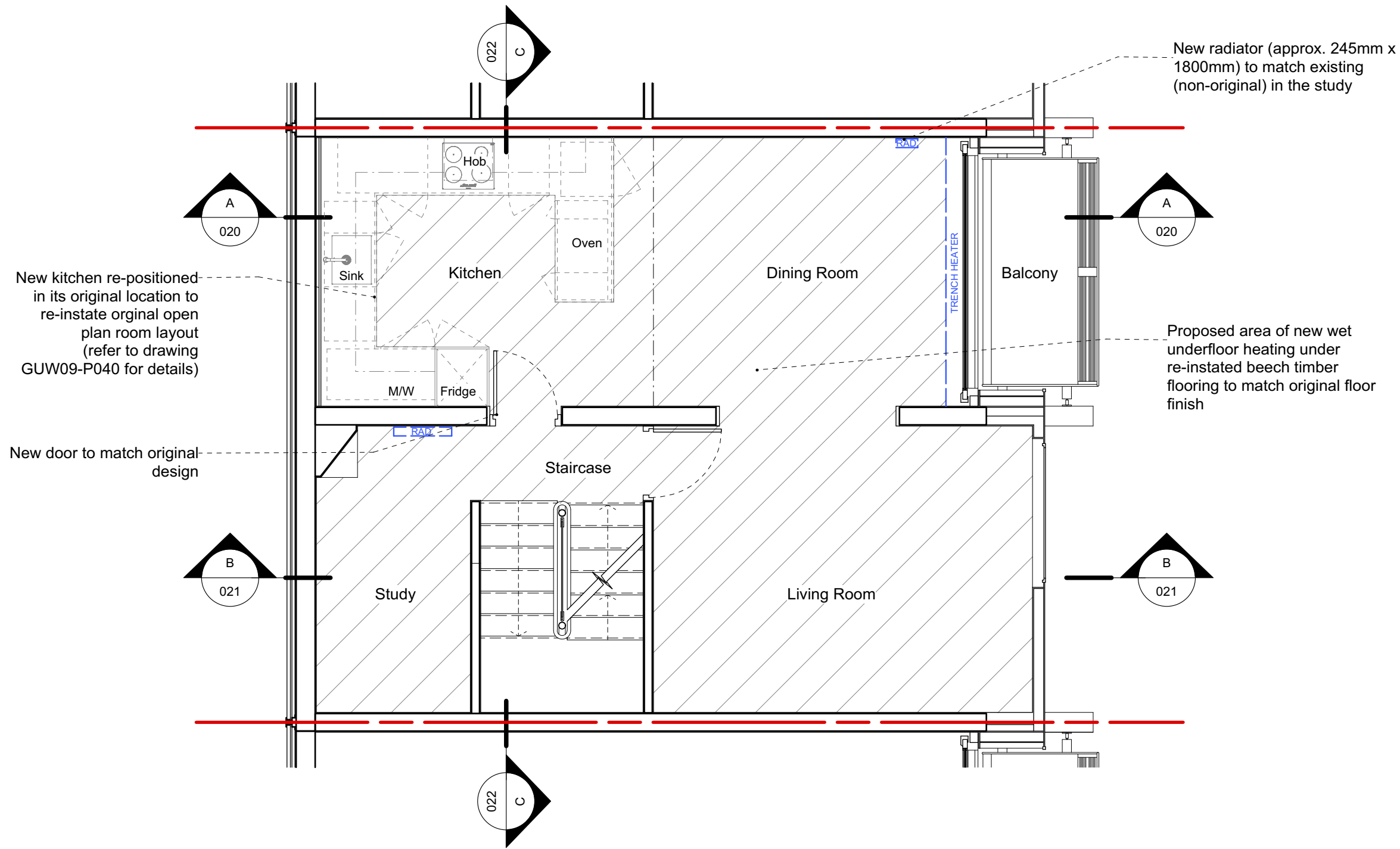

New kitchen re-positioned in its original location to re-instate original open plan room layout (refer to drawing GUW09-P040 for details)

New door to match original design

New radiator (approx. 245mm x 1800mm) to match existing (non-original) in the study

Proposed area of new wet underfloor heating under re-instated beech timber flooring to match original floor finish



As Proposed First Floor Plan

(_): Issued for LB Application

11.05.21 /TS/TS

HUGH CULLUM
 ARCHITECTS LTD
 Bloomsbury Design
 61b Judd Street
 London WC1H 9QT
 t 020 7383 7647
 f 020 7387 7645
 mail@hughcullum.com

9 Grand Union Walk
 As Proposed
 First Floor Plan
 1:50@A3 May 2021
 Drawn: TS Checked: TS
GUW09-P011(_)