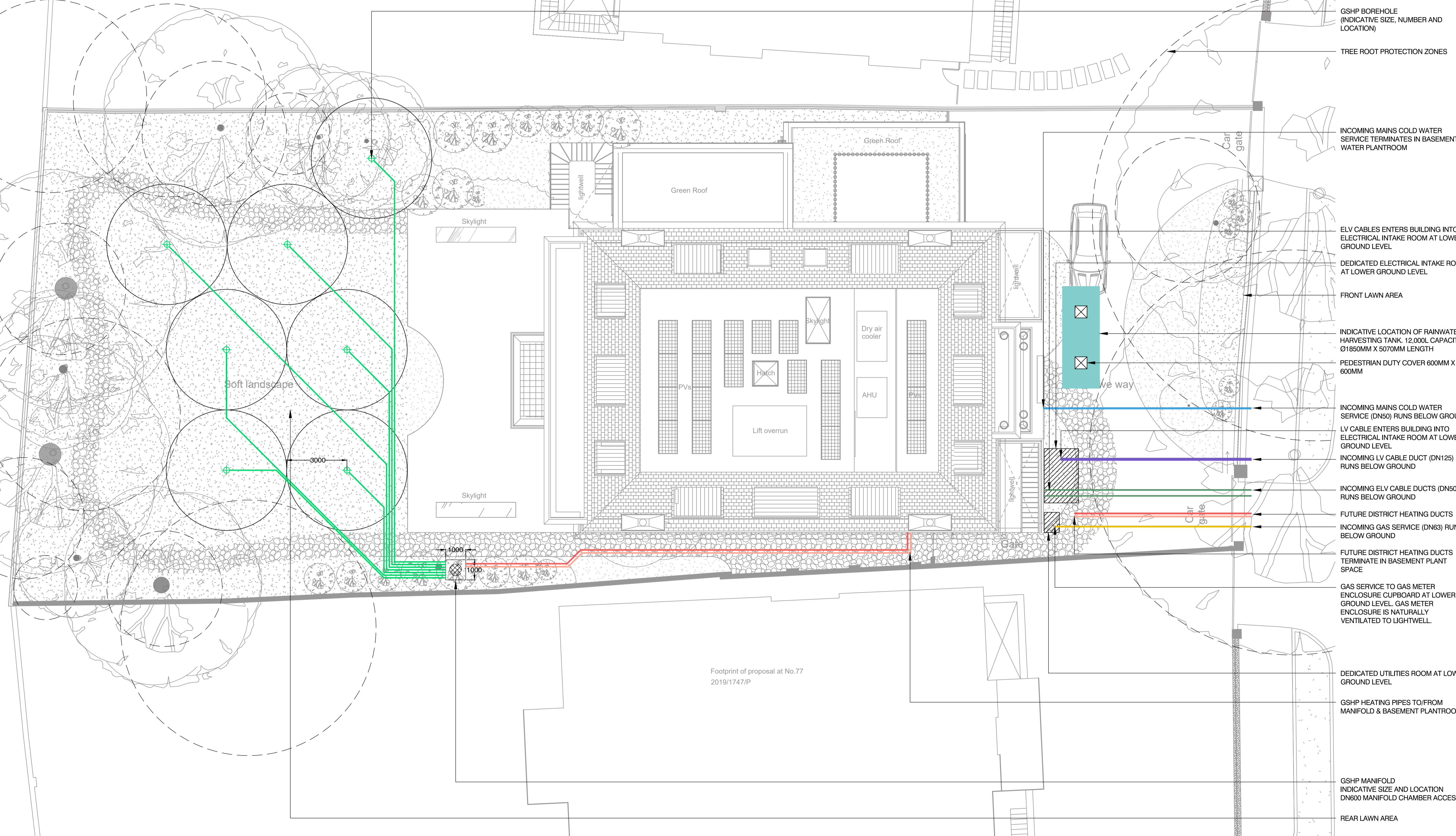

FIGURE 1: NIUG GUIDELINES ON THE POSITIONING OF UNDERGROUND APPARATUS FOR NEW DEVELOPMENT SITES



- NOTES**
- Do not scale this drawing
  - Drawing only to be used for the status indicated
  - Drawing to be read in conjunction with relevant architectural and structural drawings and specifications
  - Refer to architectural drawings for setting out of all plant & equipment
  - Ground source heat pump information including borehole number, spacing, depth and location are indicative pending specialist design.
  - Rainwater harvesting tank location is indicative. Coordination with surface water attenuation in abeyance.

GSHP BOREHOLE (INDICATIVE SIZE, NUMBER AND LOCATION)

TREE ROOT PROTECTION ZONES

INCOMING MAINS COLD WATER SERVICE TERMINATES IN BASEMENT WATER PLANTROOM

ELV CABLES ENTERS BUILDING INTO ELECTRICAL INTAKE ROOM AT LOWER GROUND LEVEL

DEDICATED ELECTRICAL INTAKE ROOM AT LOWER GROUND LEVEL

FRONT LAWN AREA

INDICATIVE LOCATION OF RAINWATER HARVESTING TANK. 12,000L CAPACITY. Ø1850MM X 5070MM LENGTH

PEDESTRIAN DUTY COVER 600MM X 600MM

INCOMING MAINS COLD WATER SERVICE (DN50) RUNS BELOW GROUND

LV CABLE ENTERS BUILDING INTO ELECTRICAL INTAKE ROOM AT LOWER GROUND LEVEL

INCOMING LV CABLE DUCT (DN125) RUNS BELOW GROUND

INCOMING ELV CABLE DUCTS (DN50) RUNS BELOW GROUND

FUTURE DISTRICT HEATING DUCTS

INCOMING GAS SERVICE (DN63) RUNS BELOW GROUND

FUTURE DISTRICT HEATING DUCTS TERMINATE IN BASEMENT PLANT SPACE

GAS SERVICE TO GAS METER ENCLOSURE CUPBOARD AT LOWER GROUND LEVEL. GAS METER ENCLOSURE IS NATURALLY VENTILATED TO LIGHTWELL.

DEDICATED UTILITIES ROOM AT LOWER GROUND LEVEL

GSHP HEATING PIPES TO/FROM MANIFOLD & BASEMENT PLANTROOM

GSHP MANIFOLD INDICATIVE SIZE AND LOCATION DN600 MANIFOLD CHAMBER ACCESS

REAR LAWN AREA

P5	Preliminary	29/04/21
P4	Preliminary	15/05/20
P3	Preliminary	12/05/20
P2	Preliminary	06/05/20
P1	Preliminary	31/01/20

**NO. REVISION DATE**

**DRAWING STATUS**

**PRELIMINARY**

**LOCATION PLAN**

**INTEGRATION**  
 3-5 SPARFIELD STREET  
 LONDON EC2R 4QB  
 +44 (0)20 7183 8610  
 INTEGRATIONUK.COM

**CLIENT**

**PRIVATE CLIENT**

**ARCHITECT**

**KSR ARCHITECTS LLP**  
 14 Greenland Street  
 London, NW1 0ND

**PROJECT**

**79 AVENUE ROAD**  
 London  
 NW8 6JD

**TITLE**

**MEP SERVICES**  
 Ground Floor  
 Site Services Layout

<b>DATE</b>	<b>SCALE</b>	<b>SIZE</b>
APRIL 2021	1:100	A1

<b>DRAWING NO.</b>	<b>REV.</b>
581-INT-XX-GF-DR-MEP-6006	P5

© INTEGRATION CONSULTANCY LIMITED 2019