

Copyright Hawkins\Brown Architects  
No implied licence exists. This drawing should not be used to calculate areas for the purposes of valuation. Do not scale this drawing. All dimensions to be checked on the site by the contractor and such dimensions to be their responsibility. All work must comply with relevant British Standards and Building Regulations requirements. Drawing errors and omissions to be reported to the architect. To be read in conjunction with Architect's specification and other consultant information.

Rev	Description	Date
P01	Issued for Planning (Planning Amendments)	19/02/21

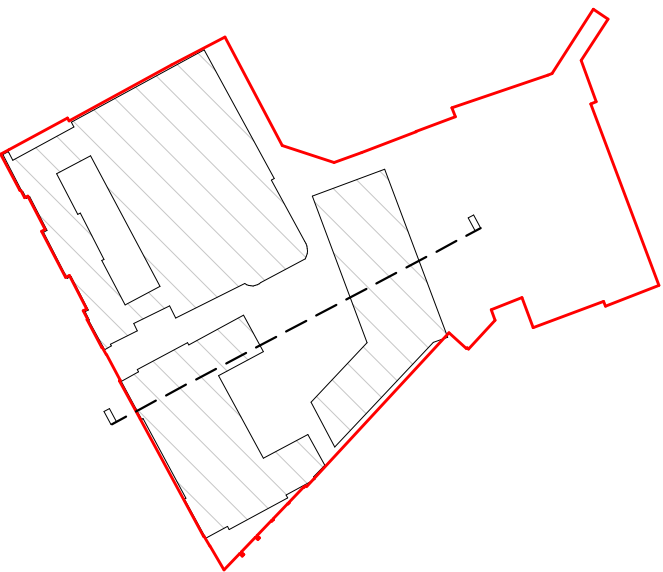

Site Plan: NTS

0 2 4 6 8 10m

159 St John Street  
London EC1V 4QJ  
mail@hawkinsbrown.com  
hawkinsbrown.com

# Hawkins\Brown

Project  
256 Gray's Inn Road  
London  
WC1X 8LD

Drawing  
Site Section EE - Proposed

Scale @ A1  
1 : 200

Date  
February  
2021

Drawn By

Checked By

Job Number  
17056

Status  
S2

Purpose of Issue  
For Information

Drawing No.  
BEMP-HBA-SW-ZZ-DR-A-20-1304P01

Rev