

Copyright Hawkins\Brown Architects
No implied licence exists. This drawing should not be used to calculate areas for the purposes of valuation. Do not scale this drawing. All dimensions to be checked on the site by the contractor and such dimensions to be their responsibility. All work must comply with relevant British Standards and Building Regulations requirements. Drawing errors and omissions to be reported to the architect. To be read in conjunction with Architect's specification and other consultant information.

Rev	Description	Date
P01	Issued for Planning (Planning Amendments)	15/02/21

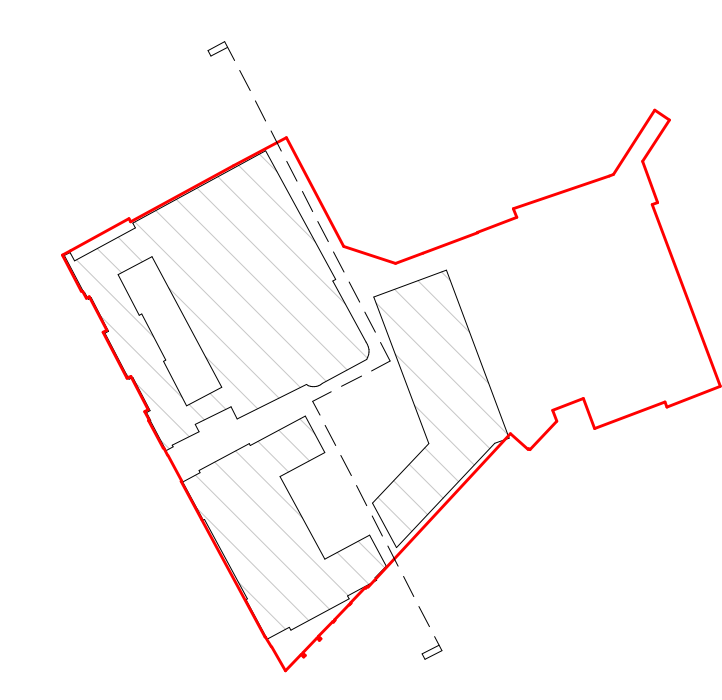

Site Plan: NTS

159 St John Street
London EC1V 4QJ
mail@hawkinsbrown.com
hawkinsbrown.com

Hawkins\Brown

Project
256 Gray's Inn Road
London
WC1X 8LD

Drawing
Site East Elevation - Proposed

Scale @ A0 1 : 200	Date February 2021
-----------------------	-----------------------

Drawn By	Checked By
----------	------------

Job Number 17056	Status S2	Purpose of Issue For Information
---------------------	--------------	-------------------------------------

Drawing No. BEMP-HBA-SW-ZZ-DR-A-20-1202 P01	Rev
--	-----