

Copyright Hawkins\Brown Architects  
No implied licence exists. This drawing should not be used to calculate areas for the purposes of valuation. Do not scale this drawing. All dimensions to be checked on the site by the contractor and such dimensions to be their responsibility. All work must comply with relevant British Standards and Building Regulations requirements. Drawing errors and omissions to be reported to the architect. To be read in conjunction with Architect's specification and other consultant information.

Rev	Description	Date
P01	Issued for Planning (Planning Amendments)	19/02/21

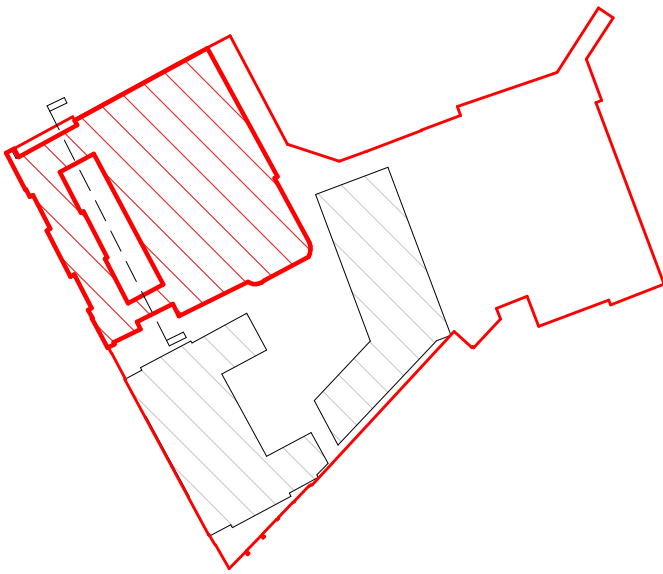

1 Site Plan: NTS

Material Palette

1. Precast brick facade using off-white/buff brick to standard dimensions
2. Brick to match existing fabric
3. Curtain wall system with bronze anodised aluminium frame: Low-iron and high performance glazing
4. Bronze anodised aluminium framed windows: Low-iron and high-performance glazing
5. Bronze anodised aluminium louvers to match curtain walling/windows
6. Precast reconstituted Portland Stone horizontal bands/ cills/ fills/ soffits
7. Glazed ceramic cladding panel/fins to external elevations
8. Glazed ceramic with engraved relief pattern
9. Architectural stonework to restoration of existing fabric (by stone specialist)
10. Slated pitched roof on timber bats
11. Bronze anodised aluminium spandrel windows (ceramic back-painted)
12. Upper section of existing southern pediment to be dismantled and rebuilt to match existing fabric

0 1 2 3 5m

159 St John Street  
London EC1V 4QU

mail@hawkinsbrown.com  
hawkinsbrown.com

# Hawkins\Brown

Project  
256 Gray's Inn Road  
London  
WC1X 8LD

Drawing  
Plot 1 West Courtyard Elevation - Proposed

Scale @ A1  
1 : 100

Date  
February  
2021

Drawn By

Checked By

Job Number  
17056

Status  
S2

Purpose of Issue  
For Information

Drawing No.  
BEMP-HBA-P1-ZZ-DR-A-20-1214

Rev  
P01