

Copyright Hawkins\Brown Architects  
No implied licence exists. This drawing should not be used to calculate areas for the purposes of valuation. Do not scale this drawing. All dimensions to be checked on the site by the contractor and such dimensions to be their responsibility. All work must comply with relevant British Standards and Building Regulations requirements. Drawing errors and omissions to be reported to the architect. To be read in conjunction with Architect's specification and other consultant information.

Rev	Description	Date
P01	Issued for Planning (Planning Amendments)	19/02/21

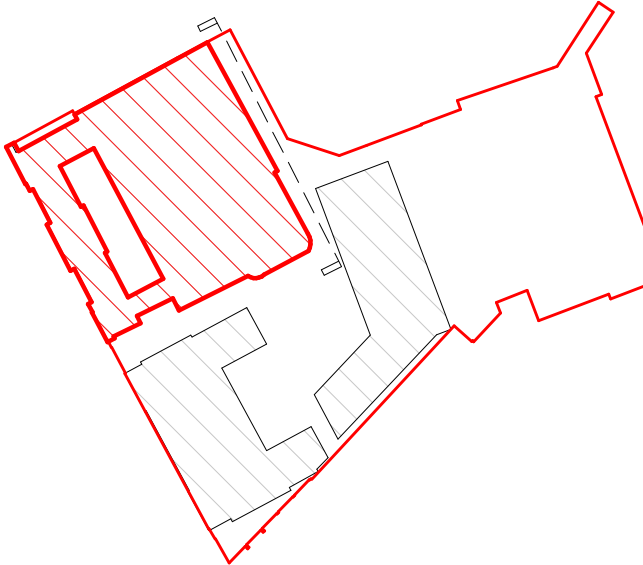

1 Site Plan: NTS

#### Material Palette

- Precast brick facade using off-white/buff brick to standard dimensions
- Brick to match existing fabric
- Curtain wall system with bronze anodised aluminium frame: Low-iron and high performance glazing
- Bronze anodised aluminium framed windows: Low-iron and high-performance glazing
- Bronze anodised aluminium louvers to match curtain walling/windows
- Precast reconstituted Portland Stone horizontal bands/ cills/ fills/ soffits
- Glazed ceramic cladding panels/fins to external elevations
- Glazed ceramic with engraved relief pattern
- Architectural stonework to restoration of existing fabric (by stone specialist)
- Slatted pitched roof on timber bats
- Bronze anodised aluminium spandrel windows (ceramic back-painted)
- Upper section of existing southern pediment to be dismantled and rebuilt to match existing fabric

0 1 2 3 5m

159 St John Street  
London EC1V 4QJ  
mail@hawkinsbrown.com  
hawkinsbrown.com

# Hawkins\Brown

Project  
256 Gray's Inn Road  
London  
WC1X 8LD

Drawing  
Plot 1 East Elevation - Proposed

Scale @ A1 1 : 100	Date February 2021
-----------------------	--------------------------

Drawn By	Checked By
----------	------------

Job Number 17056	Status S2	Purpose of Issue For Information
---------------------	--------------	-------------------------------------

Drawing No. BEMP-HBA-P1-ZZ-DR-A-20-1212	Rev P01
--	------------