

Copyright Hawkins\Brown Architects
No implied licence exists. This drawing should not be used to calculate areas for the purposes of valuation. Do not scale this drawing. All dimensions to be checked on the site by the contractor and such dimensions to be their responsibility. All work must comply with relevant British Standards and Building Regulations requirements. Drawing errors and omissions to be reported to the architect. To be read in conjunction with Architect's specification and other consultant information.

Rev	Description	Date
-----	-------------	------

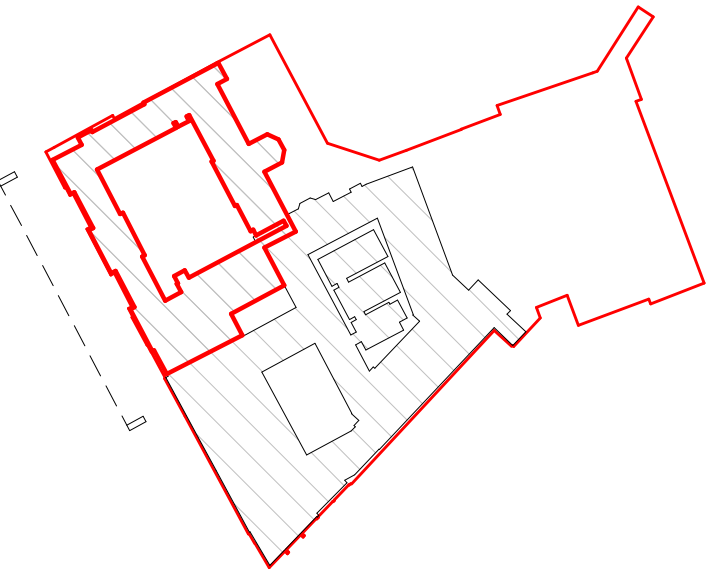

1 Site Plan: NTS

Demolition Key

- Retained building fabric
- Proposed cut lines
- Proposed window / door replacement. Existing stone lintels, cills and surrounding stonework to be retained
- Upper section of existing southern pediment to be dismantled and rebuilt to match existing fabric
- Existing building fabric to be demolished and replaced as part of proposed works
- Proposed demolitions
- Section cut lines
- Site boundary

0 1 2 3 5m

159 St John Street
London EC1V 4QJ
mail@hawkinsbrown.com
hawkinsbrown.com

Hawkins\Brown

Project
256 Gray's Inn Road
London
WC1X 8LD

Drawing
The Former Royal Free Hospital
(Plot 1 Site) West Elevation - Demolition

Scale @ A1
1 : 100

Date
February
2021

Drawn By

Checked By

Job Number
17056

Status
S2

Purpose of Issue
For Information

Drawing No.
BEMP-HBA-P1-ZZ-DR-A-00-1254

Rev



Calthorpe
Community
Gardens

Former Royal Free Hospital

Existing signage to be removed. Stonework to be repaired where required

Existing window to be removed and replaced with stone infill to match existing