

Copyright Hawkins\Brown Architects  
No implied licence exists. This drawing should not be used to calculate areas for the purposes of valuation. Do not scale this drawing. All dimensions to be checked on the site by the contractor and such dimensions to be their responsibility. All work must comply with relevant British Standards and Building Regulations requirements. Drawing errors and omissions to be reported to the architect. To be read in conjunction with Architect's specification and other consultant information.

Rev	Description	Date
P01	Plot 1 planning amendment: B2 footprint extended (SE corner)	14/08/20
P02	Plot 1 planning amendment: B2 footprint updated (SW corner)	04/12/20
P03	Issued for Planning (Planning Amendments)	19/02/21

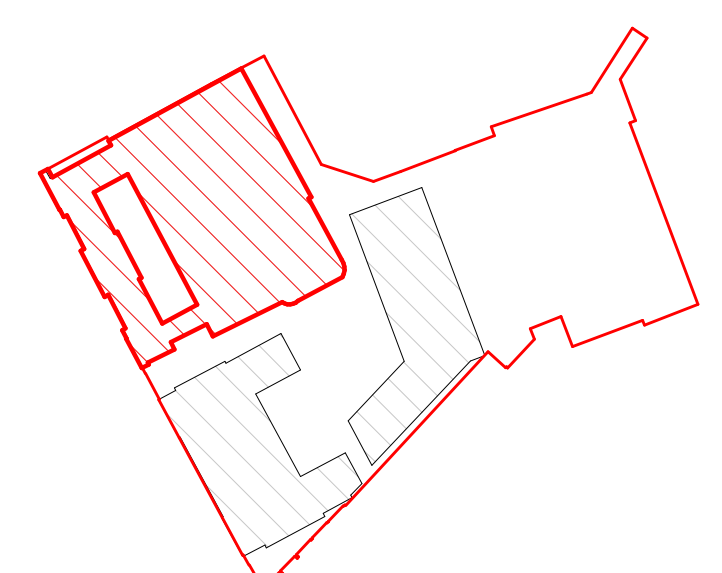

Site Plan: NTS

Planning Boundary

Note: Site boundary shown for information purposes only and does not represent a legal site demise.

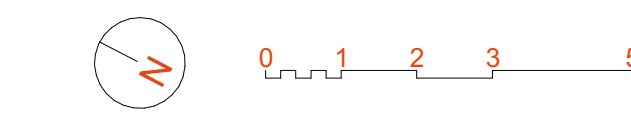

199 St John Street  
London EC1V 4QJ  
mail@hawkinsbrown.com  
hawkinsbrown.com

# Hawkins\Brown

Project  
256 Gray's Inn Road  
London  
WC1X 8LD

Drawing  
Plot 1 Level B2 GA Plan - Proposed

Scale @ A0 1 : 100	Date February 2021
-----------------------	-----------------------

Drawn By	Checked By
----------	------------

Job Number 17056	Status S2	Purpose of Issue For Information
---------------------	--------------	-------------------------------------

Drawing No. BEMP-HBA-P1-B2-DR-A-20-1100	Rev P03
--	------------