

SASH WINDOW DETAILS

All windows to be accoya timber.
Windows to be factory primed prior to delivery. To the recieve 2 coats of white gloss paint when installed

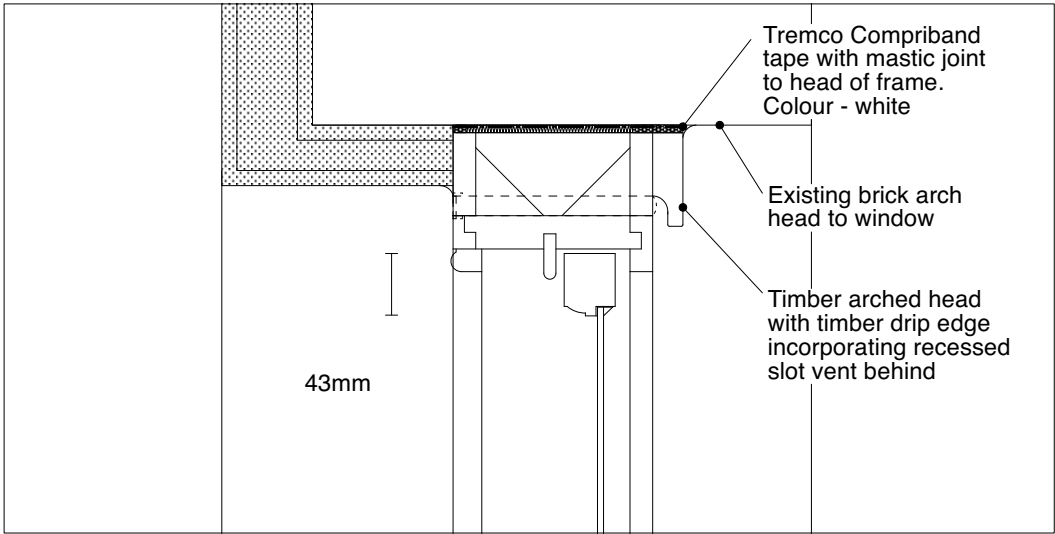

Head with brick arched head to rear brickwork

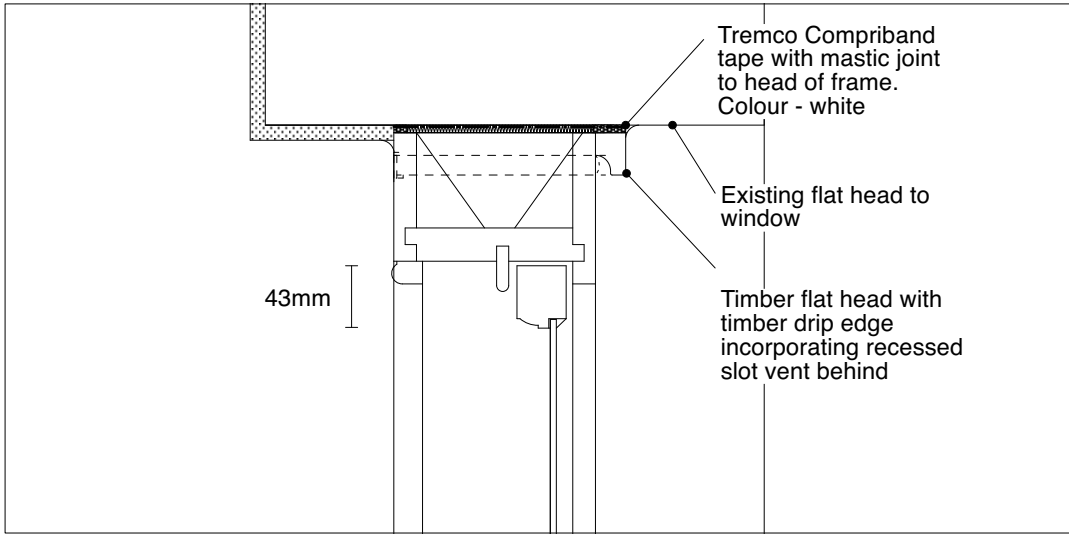

Head with flat head to lower ground & third floor

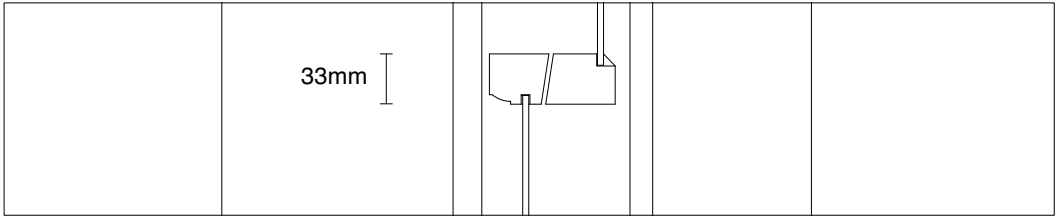

Meeting rails

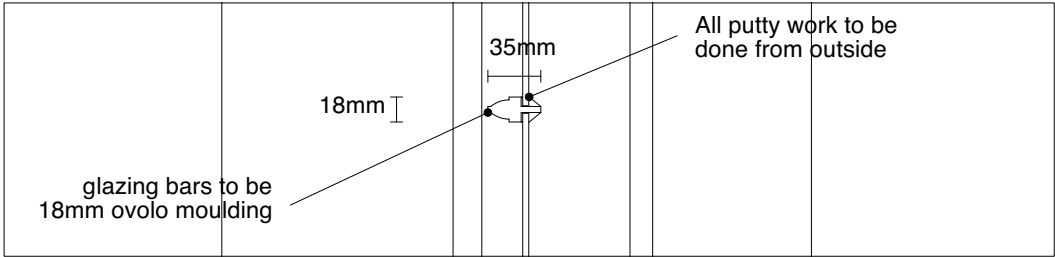

Horizontal glazing bar (rear façade only)

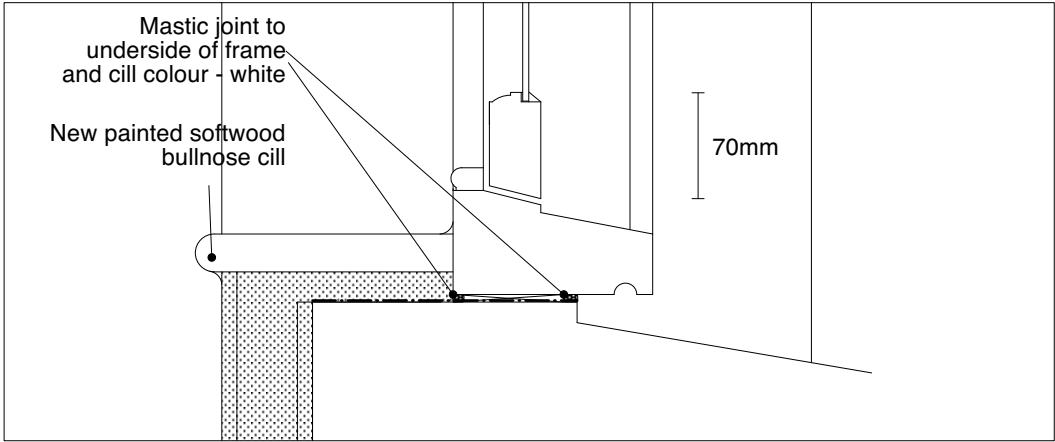

Cill

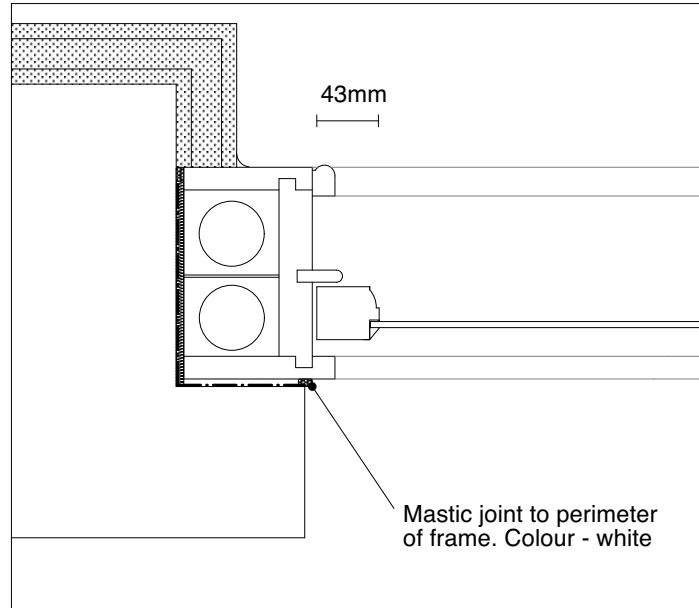

Jamb

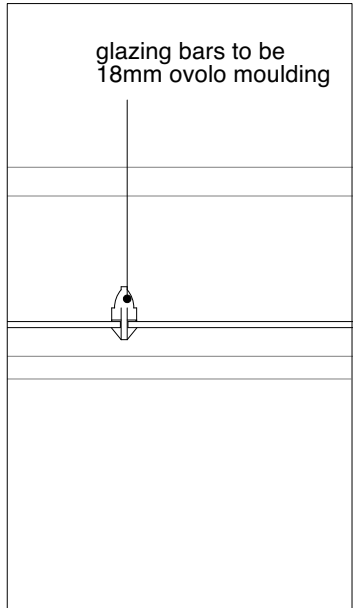

Vertical glazing bar (rear only)

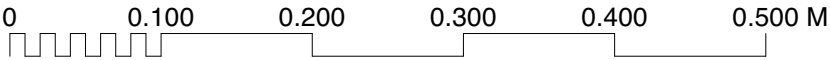

DRAFT