

Revision Notes	
Rev. A	06.04.2021
A1	Proposed lighting arrangement amended.
A2	Coffer ceiling in Gym omitted.

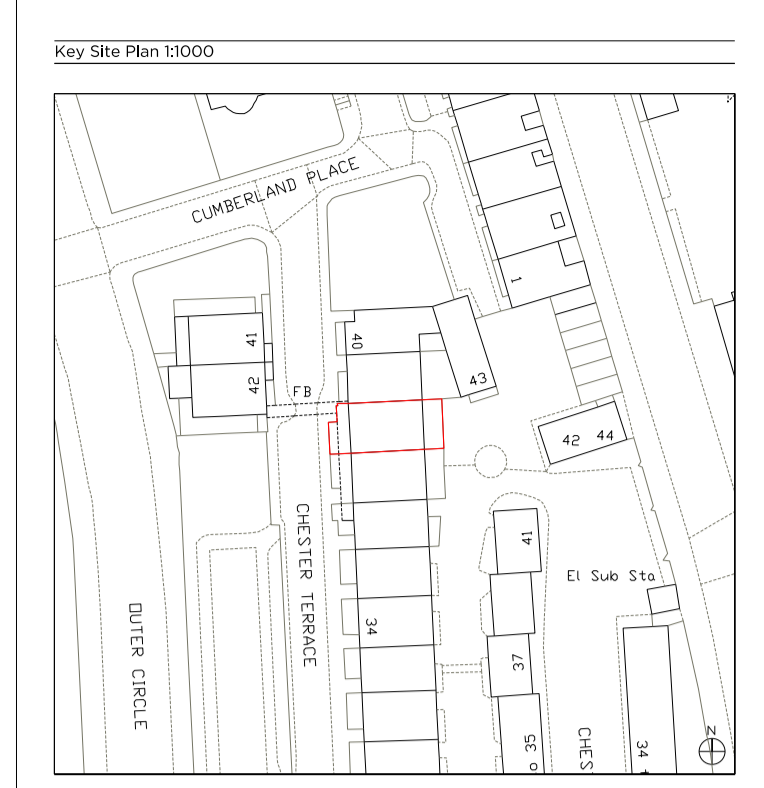

- Light Fixtures:**
- Pendant
 - Joinery downlight
 - Directional dimmable lights
 - Strip light
 - Internal wall light
 - Recessed internal wall light
 - External wall light
- Other fittings:**
- Motorised blind
 - Curtains on surface mounted curtain track
 - Recessed showerhead fitting

- Proposed Notes:**
- 01 New 'mezzo style' doors with french doors on the inner side. Refer to Door and Window Schedule for further detail.
 - 02 New staircase to Lower Ground Floor.
 - 03 Installation of new sbb, screed and waterproofing.
 - 04 New suspended ceiling.
 - 05 New slatings.
 - 06 New Lift car & door to existing Lift shaft.
 - 07 New fireplace surround, hearth and basket.
 - 08 New conservation rooflight.
 - 09 New timber roof structure.
 - 10 Rabbet timber deck and timber cladding to vertical faces of mansard.
 - 11 New moulded plaster ceiling rose.
 - 12 New security door at L.G.F.
 - 13 New privacy screen.

Rev. A	06.04.2021	Issued for Planning
Rev. -	04.12.2020	Issued for Planning

PLANNING

Project No. **20056**

Client
Nathan Harley (Resource Buildings & Interiors Ltd)

Date
December 2020

Scale
1:50 @ A1 / 1:100 @ A3

Project
**38 Chester Terrace
NW1 4ND**

Drawing Title:
Proposed Lower Ground Floor Plan RCP

Drawing No.	Rev.
P2290	A

Drawn	Approved	Signed
PK	LG	TB

**Marek
Wojciechowski
Architects Ltd.**

66 - 68 Margaret Street W1W 8SR T. 020 7580 9336 www.mwa.co.uk

Copyright Marek Wojciechowski Architects. No implied license exists. This drawing should not be used to calculate areas for the purposes of valuation. All dimensions to be checked on site by the contractor and such dimensions to be their responsibility. Do not scale drawings. All work must comply with relevant British Standards and Building Regulations requirements. Drawing errors and omissions to be reported to the architect.

Revision Notes	
Rev. A	29.03.2021
A.1 Existing recessed downlights to be removed from ceilings in principal rooms and ceilings to be patch repaired as per LBC comments.	
Rev. B	06.04.2021
B.1 Proposed lighting arrangement amended.	
B.2 Coffin ceiling in Kitchen omitted. Cornice added.	
B.3 Cornice added in Kitchen and Powder Room.	
Rev. C	08.04.2021
C.1 Proposed recessed downlights removed from ceilings in stairhall	

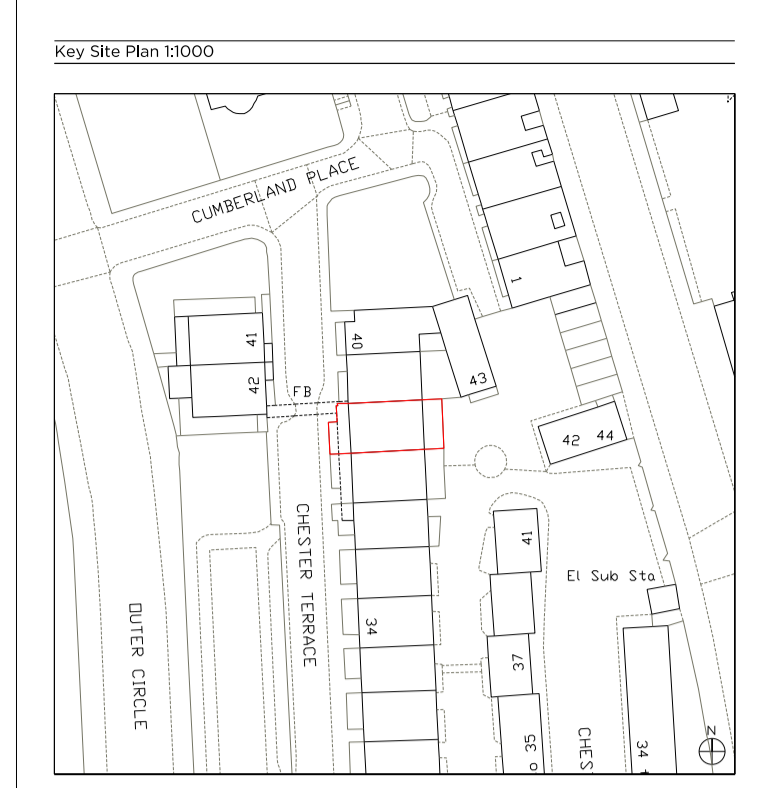

- Light Fittings:**
- Pendant
 - Joinery downlight
 - Directional dimmable lights
 - Strip light
 - Internal wall light
 - Recessed internal wall light
 - External wall light
- Other fittings:**
- Motorised blind
 - Curtains on surface mounted curtain track
 - Recessed showerhead fitting

- Proposed Notes:**
- 01 New 'Inners style' doors with french doors on the inner side. Refer to Door and Window Schedule for further detail.
 - 02 New staircase to Lower Ground Floor.
 - 03 Installation of new slab, screed and waterproofing.
 - 04 New suspended ceiling.
 - 05 New slatings.
 - 06 New Lift car & door to existing Lift shaft.
 - 07 New fireplace surround, hearth and basket.
 - 08 New conservation rooflight.
 - 09 New timber roof structure.
 - 10 Rabbet timber deck and timber cladding to vertical faces of mansard.
 - 11 New moulded plaster ceiling rose.
 - 12 New security door at LGF.
 - 13 New privacy screen.

Rev. C	08.04.2021	Issued for Planning
Rev. B	06.04.2021	Issued for Planning
Rev. A	29.03.2021	Issued for Planning
Rev. -	04.12.2020	Issued for Planning

PLANNING

Project No. **20056**

Client
Nathan Harley (Resource Buildings & Interiors Ltd)

Date
December 2020

Scale
1:50 @ A1 / 1:100 @ A3

Project
**38 Chester Terrace
NW1 4ND**

Drawing Title:
Proposed Upper Ground Floor Plan RCP

Drawing No.		Rev.
P2291		C
Drawn	Approved	Signed
PK	LG	TB



66 - 68 Margaret Street W1W 8SR T. 020 7580 9336 www.mwa.co.uk

Copyright Marek Wojciechowski Architects. No implied license exists. This drawing should not be used to calculate areas for the purposes of valuation. All dimensions to be checked on site by the contractor and such dimensions to be their responsibility. Do not scale drawings. All work must comply with relevant British Standards and Building Regulations requirements. Drawing errors and omissions to be reported to the architect.

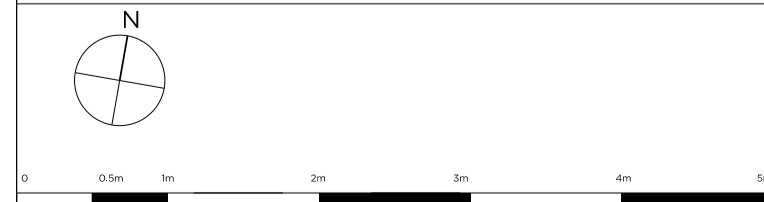

Revision Notes	
Rev. A	29.03.2021
A.1	Existing recessed downlights to be removed from ceilings in principal rooms and ceilings to be patch repaired as per LBC comments.
Rev. B	06.04.2021
B.1	Proposed lighting arrangement amended.
B.2	Coffer ceiling added to Bar and Study.
B.3	Cornice added to Bar and Hallway.
Rev. C	08.04.2021
C.1	Proposed recessed downlights removed from ceilings in stair hall.

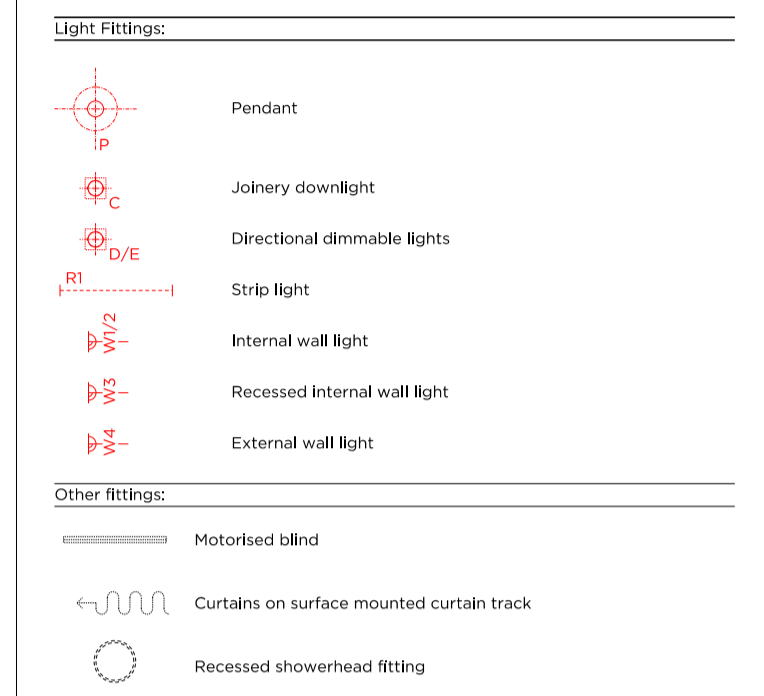
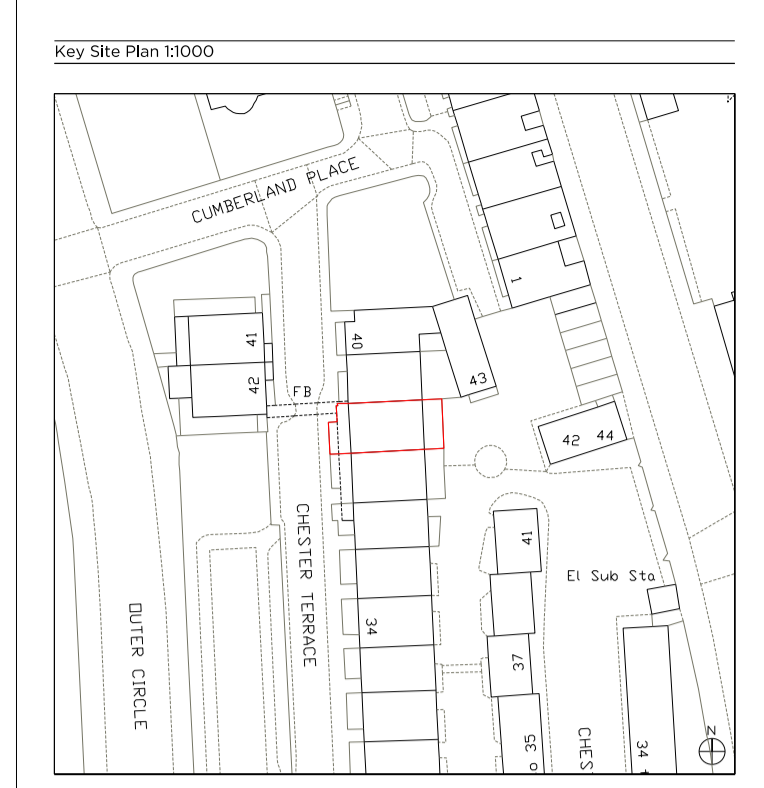

- Proposed Notes:**
- [01] New 'mews style' doors with french doors on the inner side. Refer to Door and Window Schedule for further detail.
 - [02] New staircase to Lower Ground Floor.
 - [03] Installation of new sbb, screed and waterproofing.
 - [04] New suspended ceiling.
 - [05] New slatings.
 - [06] New Lift car & door to existing Lift shaft.
 - [07] New fireplace surround, hearth and basket.
 - [08] New conservation rooflight.
 - [09] New timber roof structure.
 - [10] Rabbed timber deck and timber cladding to vertical faces of mansard.
 - [11] New moulded plaster ceiling rose.
 - [12] New security door at LGF.
 - [13] New privacy screen.

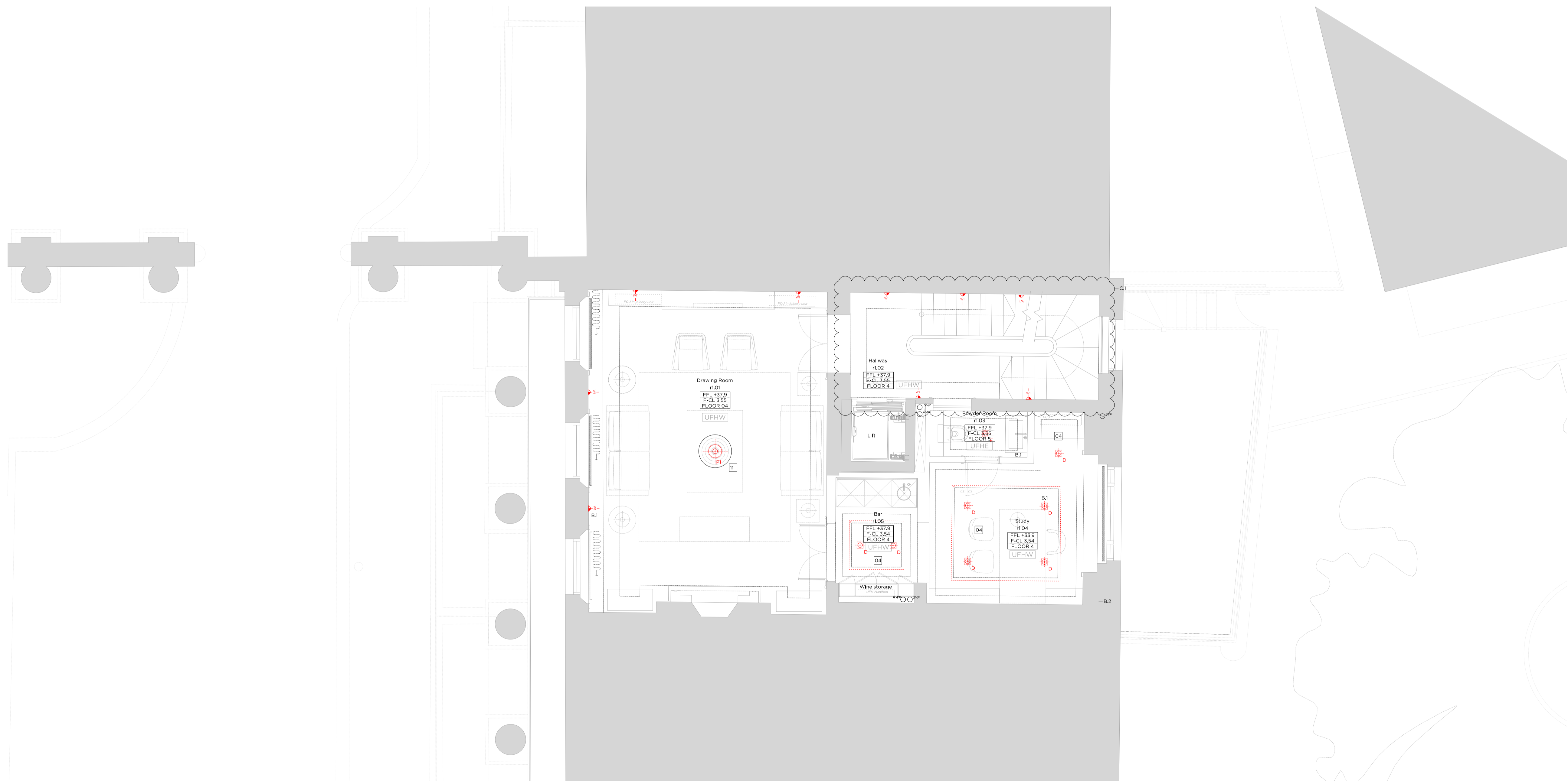

Rev. C	08.04.2021	Issued for Planning
Rev. B	06.04.2021	Issued for Planning
Rev. A	29.03.2021	Issued for Planning
Rev. -	04.12.2020	Issued for Planning

PLANNING

Project No. **20056**

Client
Nathan Harley (Resource Buildings & Interiors Ltd)

Date
December 2020

Scale
1:50 @ A1 / 1:100 @ A3

Project
**38 Chester Terrace
NW1 4ND**

Drawing Title
Proposed First Floor Plan RCP

Drawing No.	P2292	Rev.	C
Drawn	Approved	Signed	
PK	LG	TB	

**Marek
Wojciechowski
Architects Ltd.**

66 - 68 Margaret Street W1W 8SR T. 020 7580 9336 www.mwa.co.uk

Copyright Marek Wojciechowski Architects. No implied license exists. This drawing should not be used to calculate areas for the purposes of valuation. All dimensions to be checked on site by the contractor and such dimensions to be their responsibility. Do not scale drawings. All work must comply with relevant British Standards and Building Regulations requirements. Drawing errors and omissions to be reported to the architect.

N

Revision Notes	
Rev. A	06.04.2021
A.1	Proposed lighting arrangement amended.
A.2	Cornice added to Hallway and Master Ensuite.
A.3	Ceiling rose and pendant light added to Hallway and Master Bedroom.
Rev. B	08.04.2021
B.1	Proposed recessed downlights removed from stair hall ceiling.

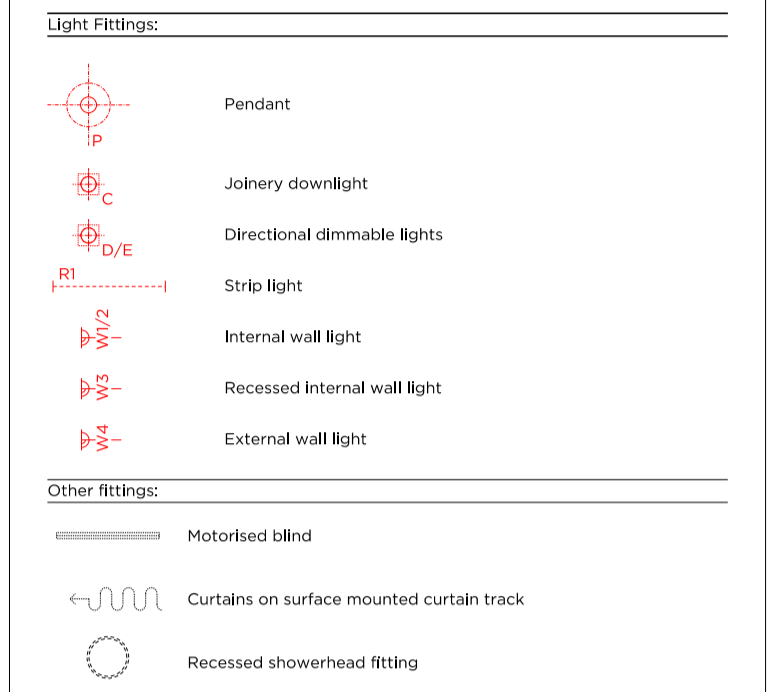
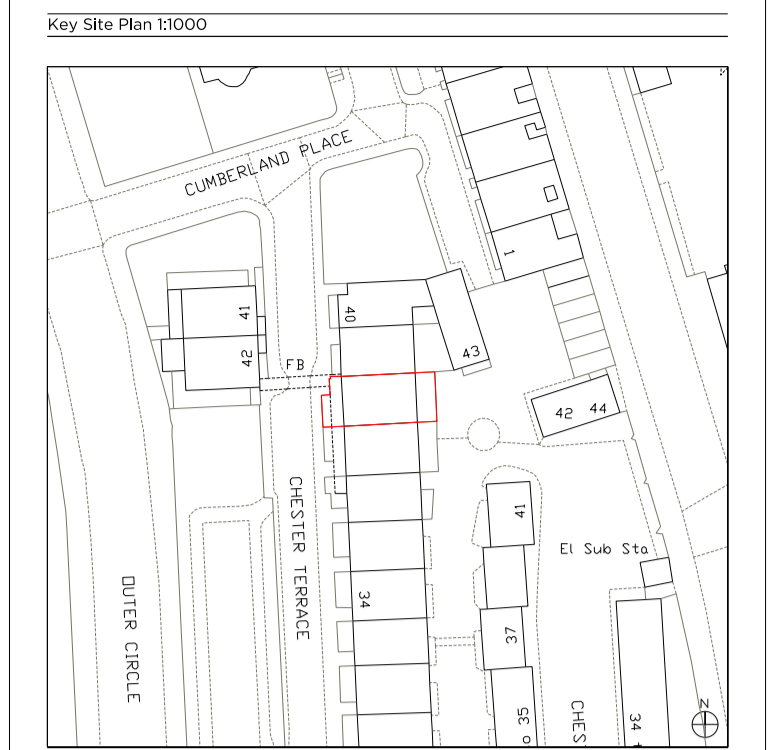

- Proposed Notes:**
- [01] New 'mews style' doors with french doors on the inner side. Refer to Door and Window Schedule for further detail.
 - [02] New staircase to Lower Ground Floor.
 - [03] Installation of new sbb, screed and waterproofing.
 - [04] New suspended ceiling.
 - [05] New slatings.
 - [06] New Lift car & door to existing Lift shaft.
 - [07] New fireplace surround, hearth and basket.
 - [08] New conservation rooflight.
 - [09] New timber roof structure.
 - [10] Rabbed timber deck and timber cladding to vertical faces of mansard.
 - [11] New moulded plaster ceiling rose.
 - [12] New security door at LGF.
 - [13] New privacy screen.

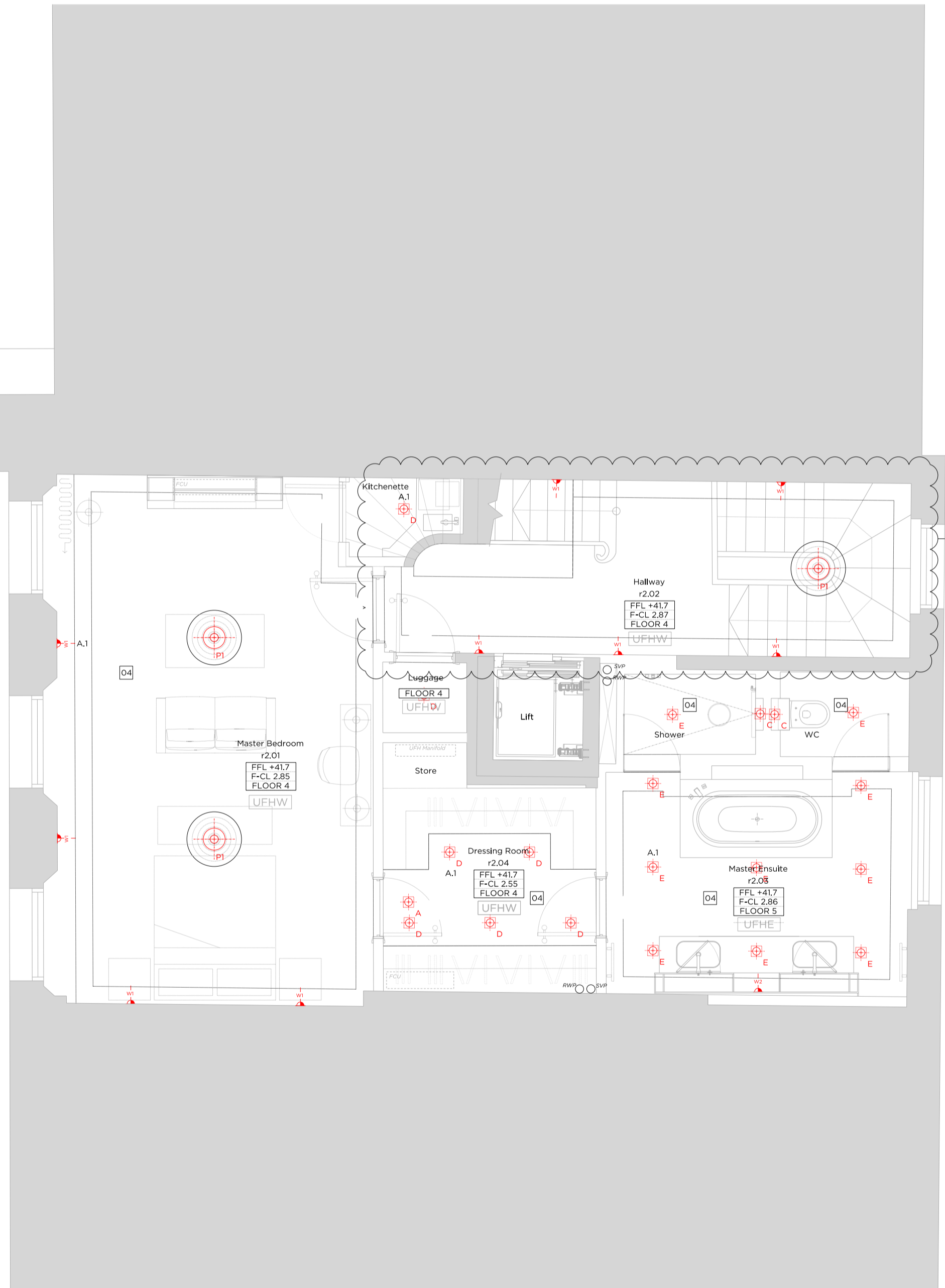

Rev. B	08.04.2021	Issued for Planning
Rev. A	06.04.2021	Issued for Planning
Rev. -	04.12.2020	Issued for Planning

PLANNING

Project No. **20056**

Client
Nathan Harley (Resource Buildings & Interiors Ltd)

Date
December 2020

Scale
1:50 @ A1 / 1:100 @ A3

Project
**38 Chester Terrace
NW1 4ND**

Drawing Title
Proposed Second Floor Plan RCP

Drawing No. **P2293** Rev. **B**

Drawn	Approved	Signed
PK	LG	TB



66 - 68 Margaret Street W1W 8SR T. 020 7580 9336 www.mwa.co.uk

Copyright Marek Wojciechowski Architects. No implied license exists. This drawing should not be used to calculate areas for the purposes of valuation. All dimensions to be checked on site by the contractor and such dimensions to be their responsibility. Do not scale drawings. All work must comply with relevant British Standards and Building Regulations requirements. Drawing errors and omissions to be reported to the architect.

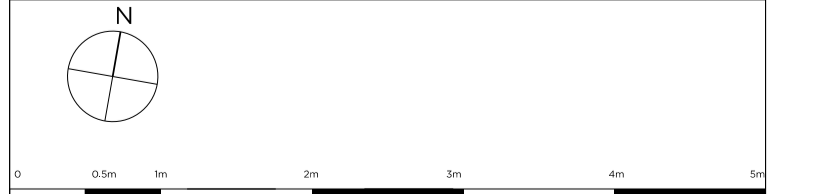

Revision Notes	
Rev. A	06.04.2021
A1	Proposed lighting arrangement amended.
A2	Cornice added to Hallway.

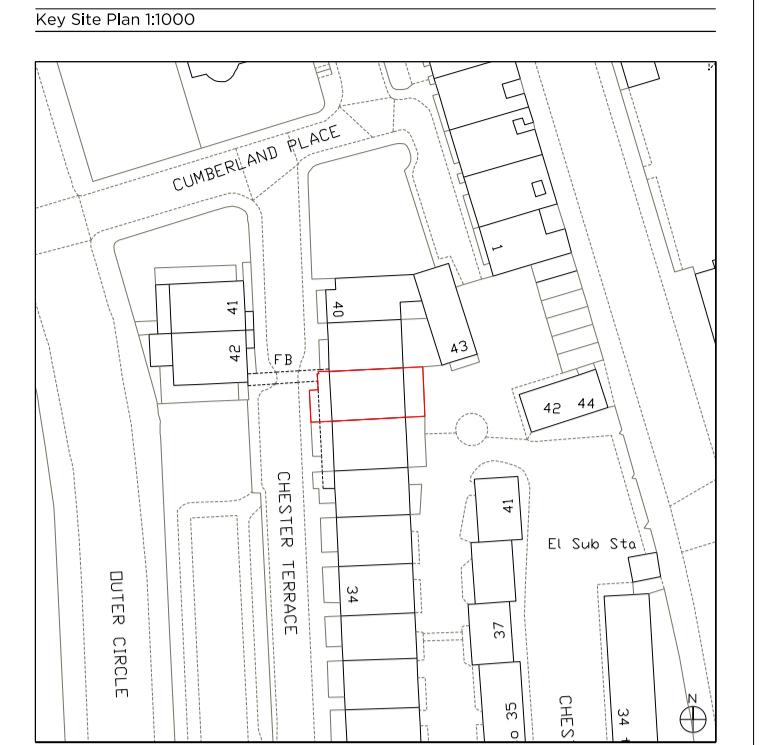

Light Fittings:

- Pendant
- Joinery downlight
- Directional dimmable lights
- Strip light
- Internal wall light
- Recessed internal wall light
- External wall light

Other fittings:

- Motorised blind
- Curtains on surface mounted curtain track
- Recessed showerhead fitting

- Proposed Notes:**
- [01] New 'micos style doors' with french doors on the inner side. Refer to Door and Window Schedule for further detail.
 - [02] New staircase to Lower Ground Floor.
 - [03] Installation of new slab, screed and waterproofing.
 - [04] New suspended ceiling.
 - [05] New slatings.
 - [06] New Lift car & door to existing Lift shaft.
 - [07] New fireplace surround, hearth and basket.
 - [08] New conservation rooflight.
 - [09] New timber roof structure.
 - [10] Rabbed timber deck and timber cladding to vertical faces of mansard.
 - [11] New moulded plaster ceiling rose.
 - [12] New security door at L.G.F.
 - [13] New privacy screen.

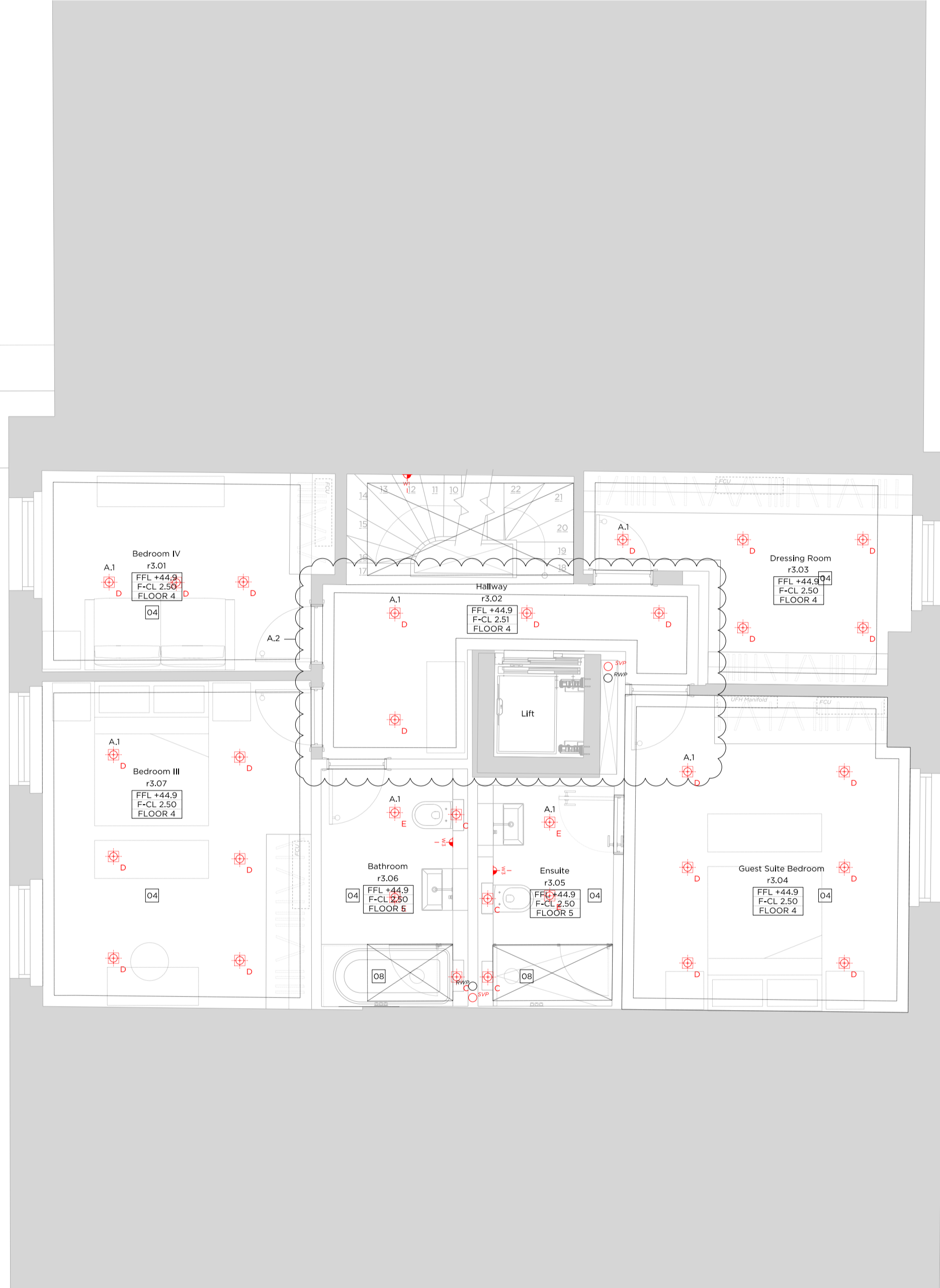

Rev. A	06.04.2021	Issued for Planning
Rev. -	04.12.2020	Issued for Planning

PLANNING

Project No. 20056

Client
Nathan Harley (Resource Buildings & Interiors Ltd)

Date
December 2020

Scale
1:50 @ A1 / 1:100 @ A3

Project
38 Chester Terrace
NW1 4ND

Drawing Title
Proposed Third Floor Plan RCP

Drawing No.	P2294	Rev.	A
Drawn	PK	Approved	LG
		Signed	TB

Marek Wojciechowski Architects Ltd.

66 - 68 Margaret Street W1W 8SR T. 020 7580 9336 www.mwa.co.uk

Copyright Marek Wojciechowski Architects. No implied license exists. This drawing should not be used to calculate areas for the purposes of valuation. All dimensions to be checked on site by the contractor and such dimensions to be their responsibility. Do not scale drawings. All work must comply with relevant British Standards and Building Regulations requirements. Drawing errors and omissions to be reported to the architect.