

R1 Rolling to Top of Wall Typical Detail
Q40/340A
1:10

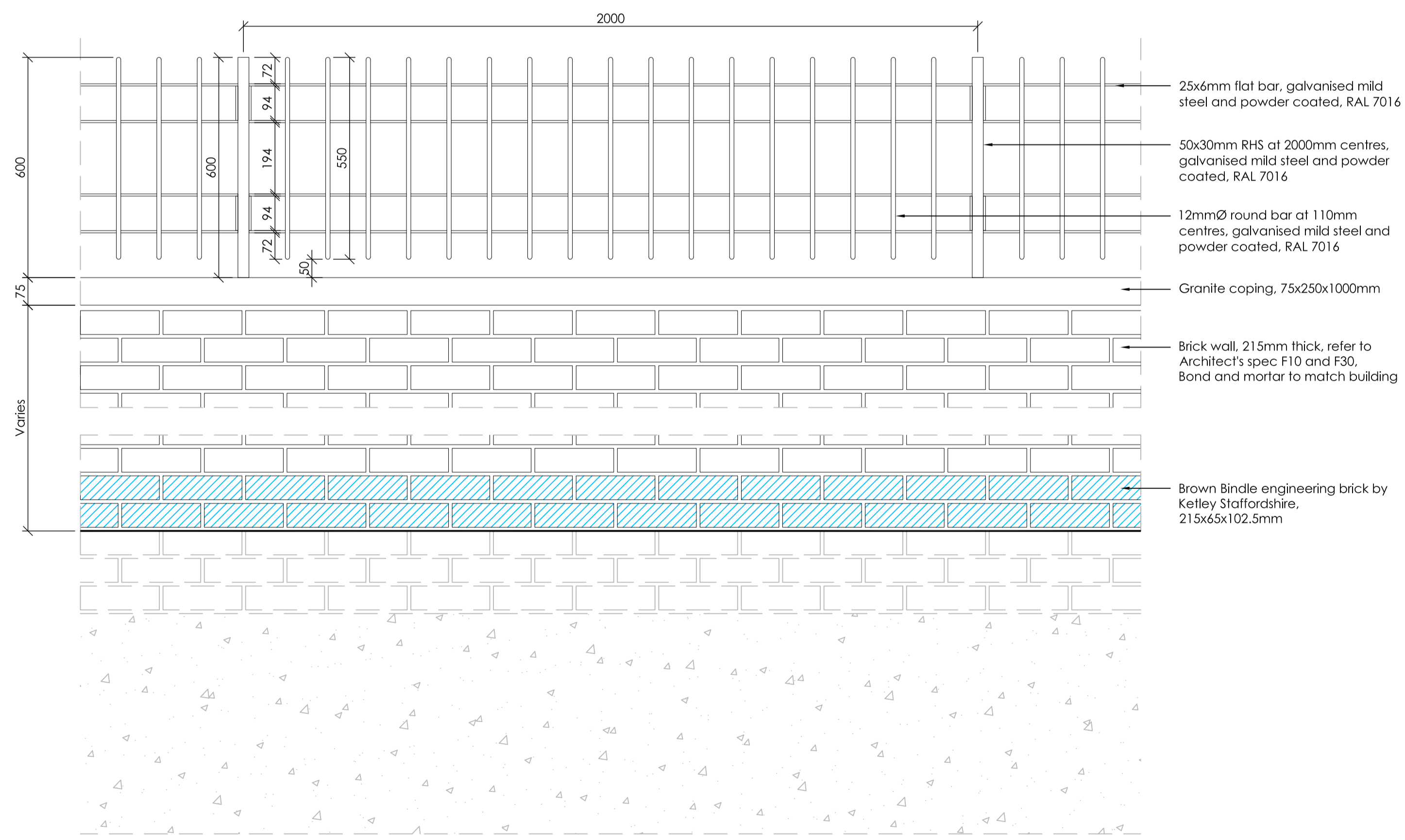

R2 Railing and Wall to Grafton Terrace Typical Detail
Q40/340B
F10/385A
1:10

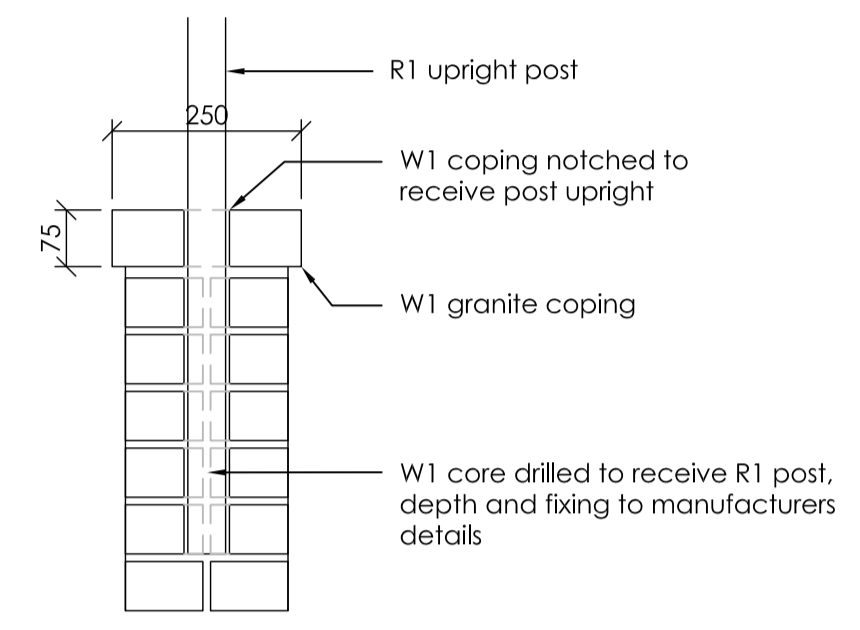
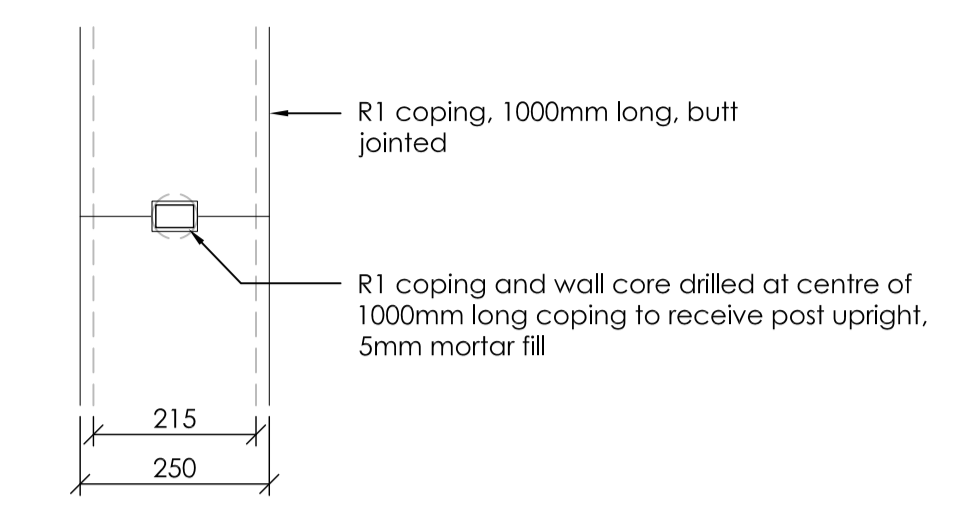
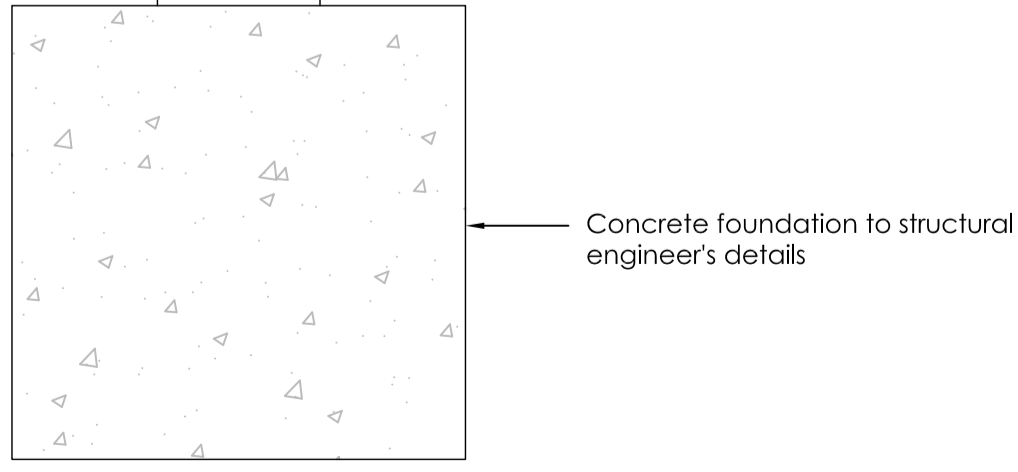
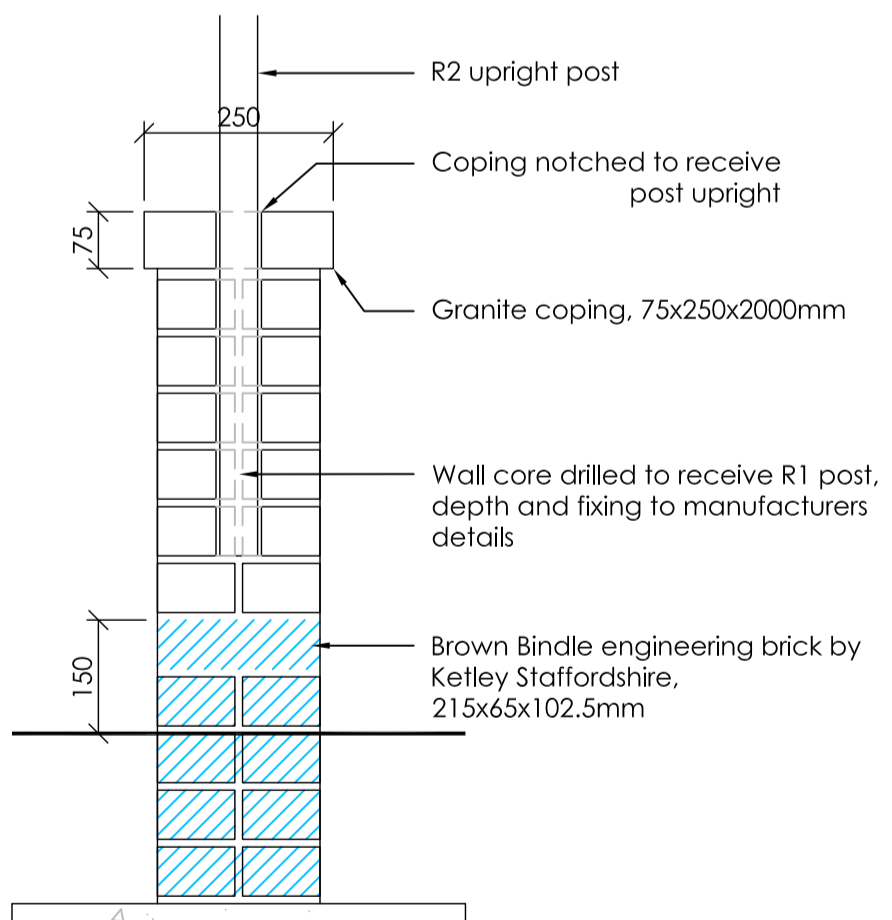
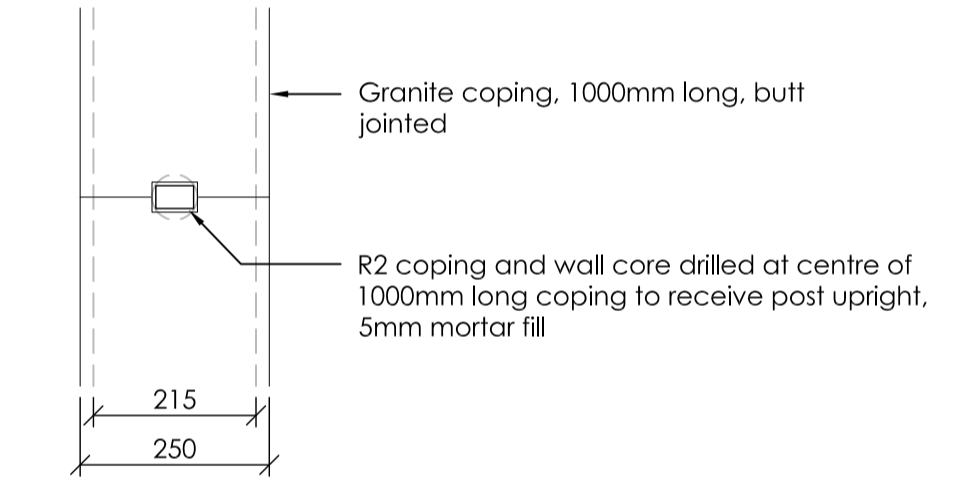

| STATUS | REV | DATE | DESCRIPTION | DSG | DRW | CHK | APP |
|--------|-----|------------|------------------|-----|-----|-----|---------|
| S3 | P03 | 25/09/2020 | Minor amendments | | | | AC TS |
| S3 | P02 | 22/05/2020 | Stage 4 Issue | | | | AC TS |
| S1 | P01 | 01/05/2020 | First Issue | | | | AC TS |

| STATUS | REV | DATE | DESCRIPTION | DSG | DRW | CHK | APP |
|-----------------|-----|------|-------------|-----|-----|-----|-----|
| ALL REVISIONS | | | | | | | |
| MAIN CONTRACTOR | | | | | | | |

BOUYGUES UK
Bouygues UK
Bicket House
1 Lambeth Palace Rd
Lambeth, London SE1 7EU
Tel: 020 7401 0020

Camden

KEY PLAN

ORIGINATOR
turkingtonmartin
Studio 3.04 Chester House, Kennington Park
1-3 Brixton Road, London, SW9 6DE
T: (+44) 020 3567 1050
E: studio@turkingtonmartin.com

PROJECT NAME
Maitland Park Redevelopment

DRAWING TITLE
Typical Details - Railings and Gates
Sheet 1

| | |
|--------------------------------|--|
| SCALE @ A1 1:10 | MODEL FILE NAME - REVISION Not Applicable |
| FIRST ISSUE DATE 01/05/2020 | PROJECT STAGE Stage 4 |
| | STATUS CODE S3 - Suitable for Review & Comments |

| PROJECT | ORIGINATOR | VOLUME | LEVEL | TYPE | ROLE | NUMBER | REV |
|---------|------------|--------|-------|------|------|--------|-----|
| MPR | TMA | ZZ | GF | DT | L | 300010 | P03 |