

NOTES.

All dimensions to be checked on site and not scaled from this drawing.

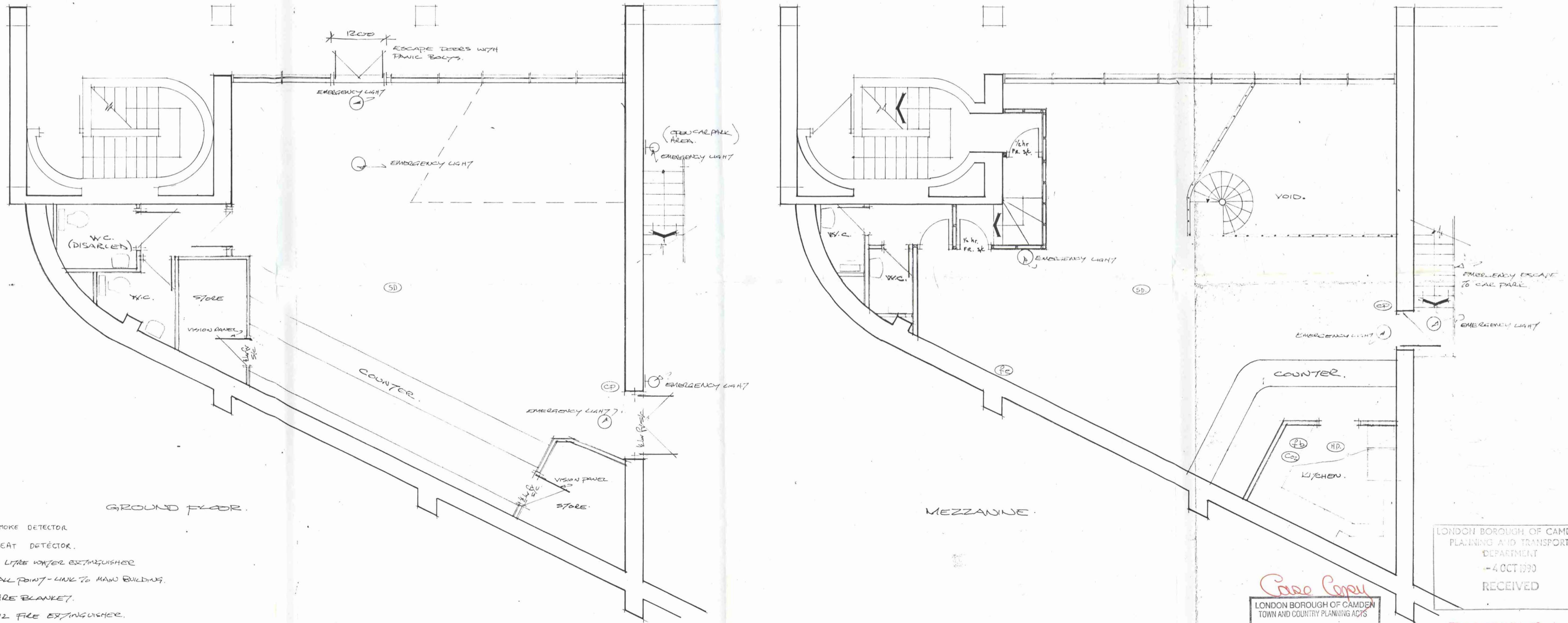

- (SD) SMOKE DETECTOR.
 - (HD) HEAT DETECTOR.
 - (LW) 3 LITRE WATER EXTINGUISHER.
 - (CP) CALL POINT - LINK TO MAIN BUILDING.
 - (FB) FIRE BLANKET.
 - (CO2) CO2 FLE EXTINGUISHER.
- STORE DOORS (LOCKABLE) TO HAVE 'THUMB TURN' LOCK IN EXTERIOR.

GROUND FLOOR.

MEZZANINE.

Case Copy
 LONDON BOROUGH OF CAMDEN
 TOWN AND COUNTRY PLANNING ACTS
 14 NOV 1990
 PLANS APPROVED
 ON BEHALF OF THE COUNCIL

LONDON BOROUGH OF CAMDEN
 PLANNING AND TRANSPORT
 DEPARTMENT
 - 4 OCT 1990
 RECEIVED

TP9003422 KI

Rev.	
PANTELLI MITCHELL & ASSOCIATES	
01-341 6960	
29 Park Road London N8 8TE	
Job Title	
SHOP UNIT SAINSBURYS CAMDEN BAKERY SITE	
Drawing Title	
PROPOSED PLANS	
Dwg. No.	Rev.
PMA/DA/02	
Scale	Job No.
1:50	