

1806(SK)013\_Rev\  
Bennetts Associates  
Roof Access Hatch  
22<sup>ND</sup> April 2021  
Scale 1:10 @ A3

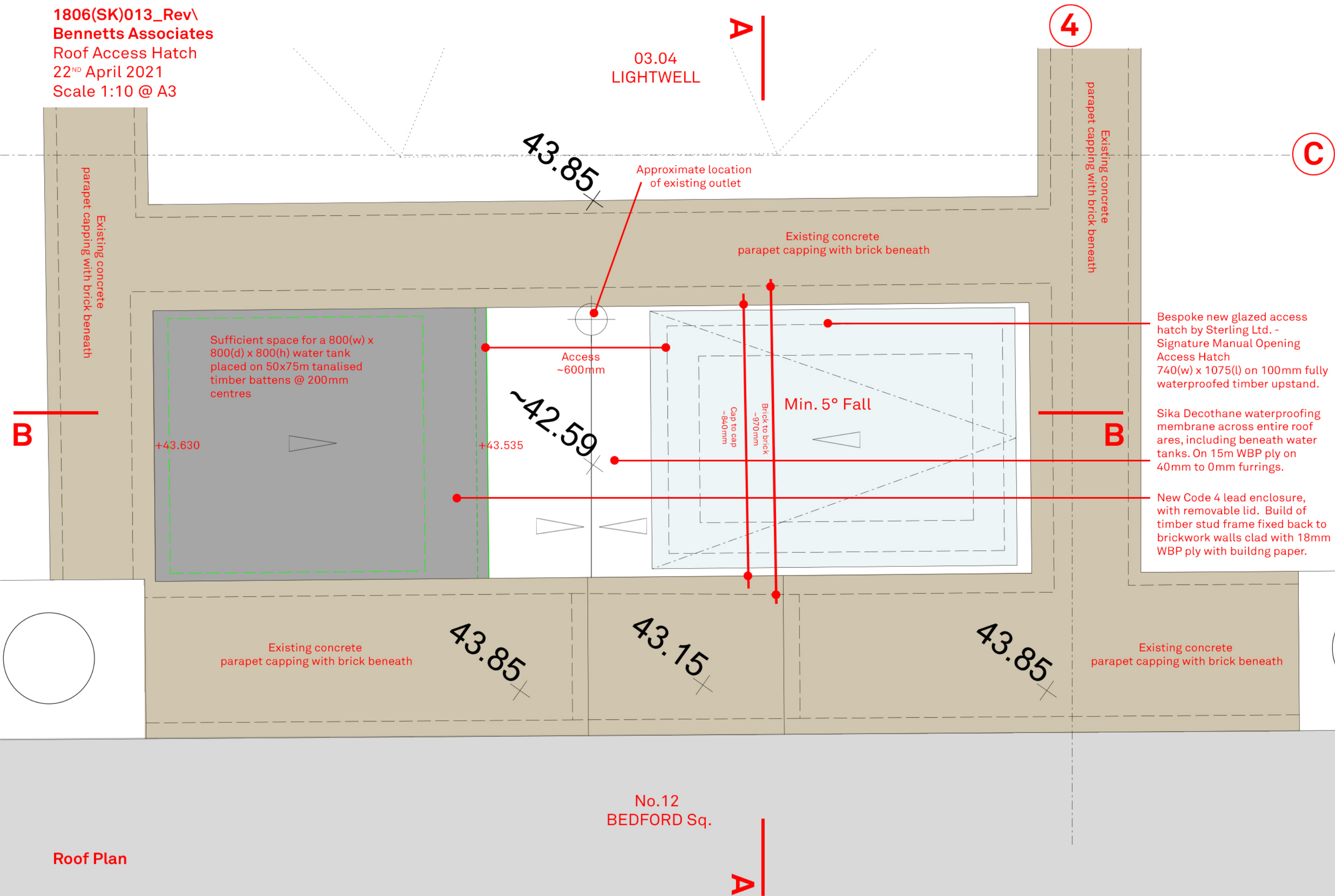

1806(SK)013\_Rev\  
Bennetts Associates  
Roof Access Hatch  
22<sup>ND</sup> April 2021  
Scale 1:10 @ A3

C

B

Cap to cap

840

+43.850

+43.850

+43.150

+42.370

Allow for replacment sand and  
lime render to enclosure interior  
on all sides to protect brickwork  
beneath.

03.04  
LIGHTWELL

Code 6 lead flashing over Sika  
membrane around entire  
perimeter, dressed into existing  
brick mortar joints with render  
bell bead above.

40mm furrings

525

15mm WBP ply

03-S-03  
STAIR LOBBY

No.12  
BEDFORD Sq.

Bespoke new glazed access  
hatch by Sterling Ltd. -  
Signature Manual Opening  
Access Hatch  
740(w) x 1075(l) on 100mm fully  
waterproofed timber upstand.

Sika Decothane waterproofing  
membrane across entire roof  
ares, including beneath water  
tanks. On 15m WBP ply on  
40mm to 0mm furrings.

Assumed existing timber roof  
structure retained with existing  
asphelt covering removed. New  
trimmer timbers may be  
required to support rooflight  
depending on current  
arrangement.

New plasterboard ceiling to be  
formed beneath adapted joists,  
including new reveals into  
rooflight to enclose new 100mm  
upstand.

PARTY WALL

Short Section

B

A

4

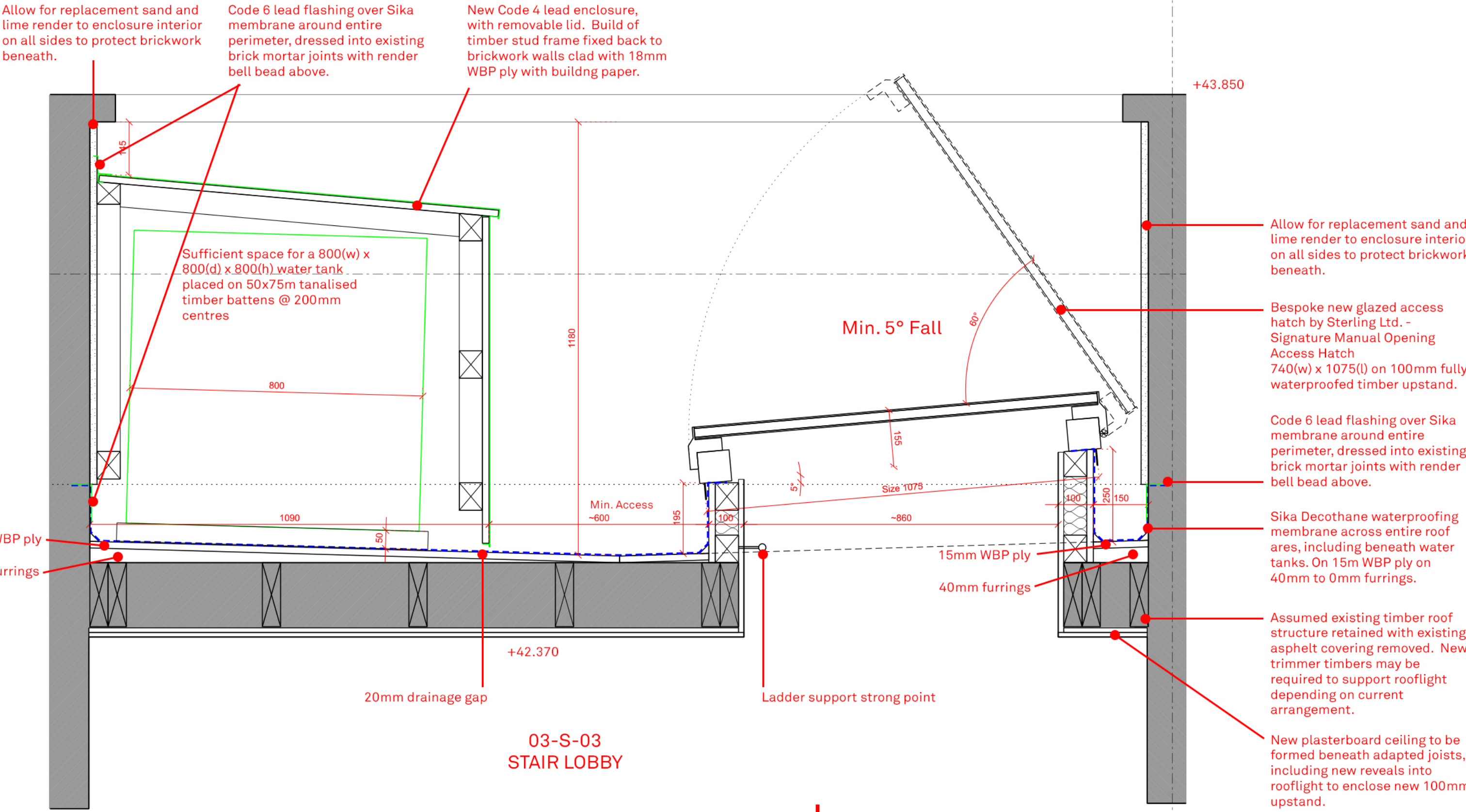

Long Section

A