

01 Rooflight short section (Scale 1:10)

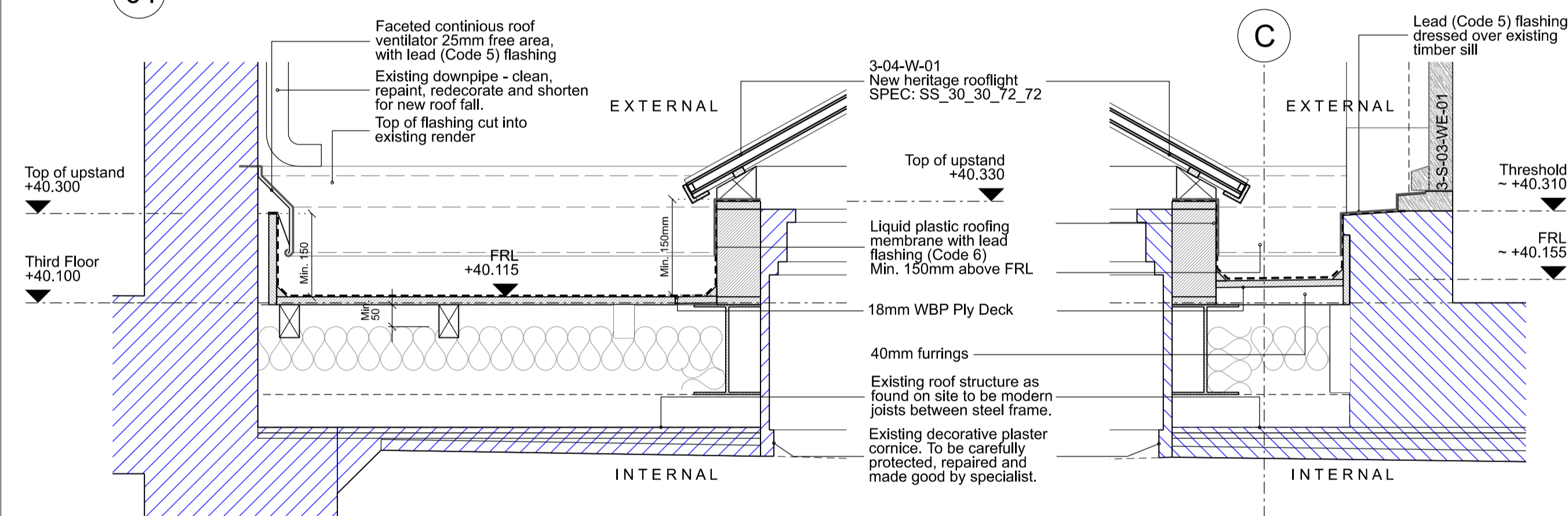

02 Rooflight long section (Scale 1:10)

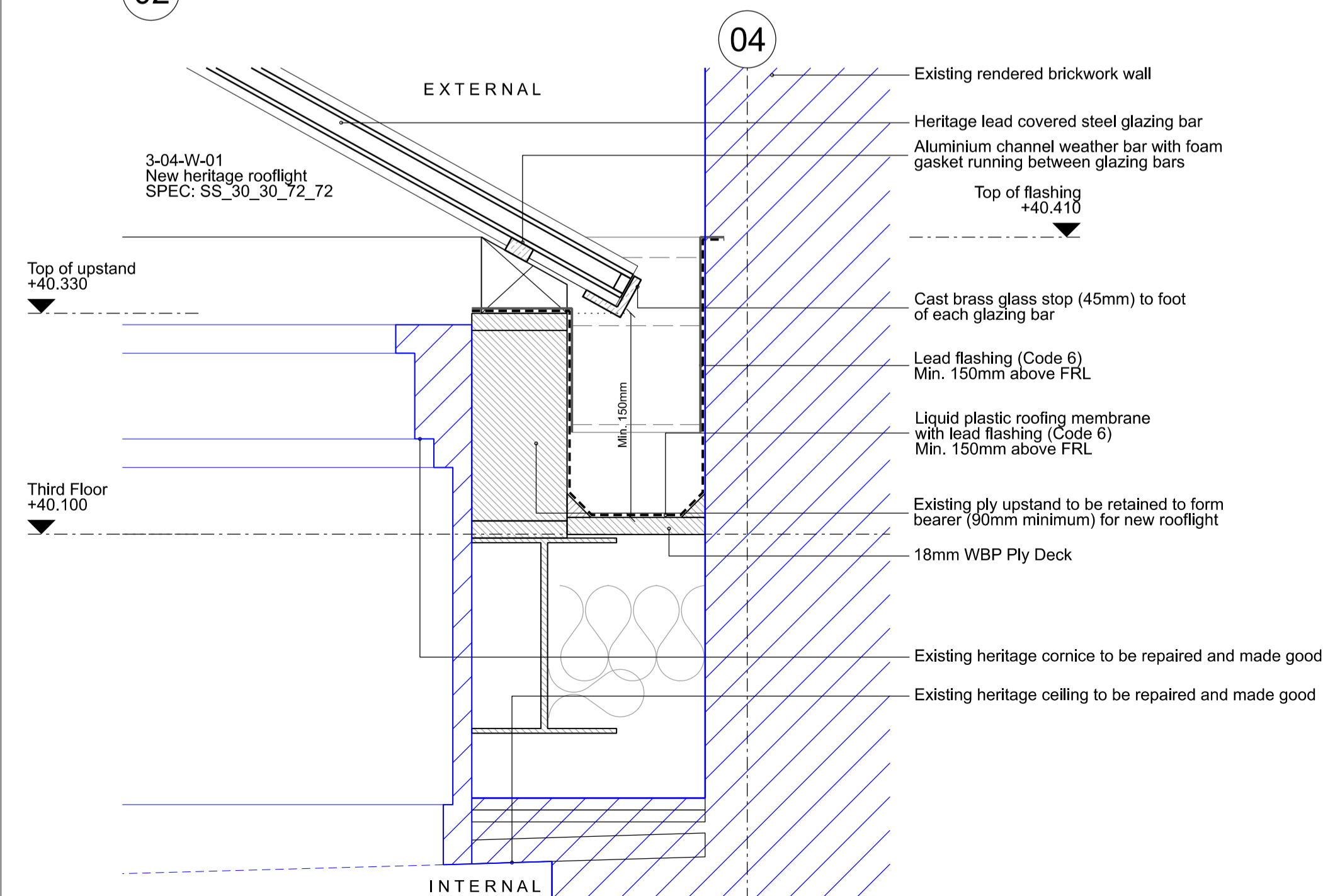

03 Typical rooflight parapet detail (Scale 1:5)

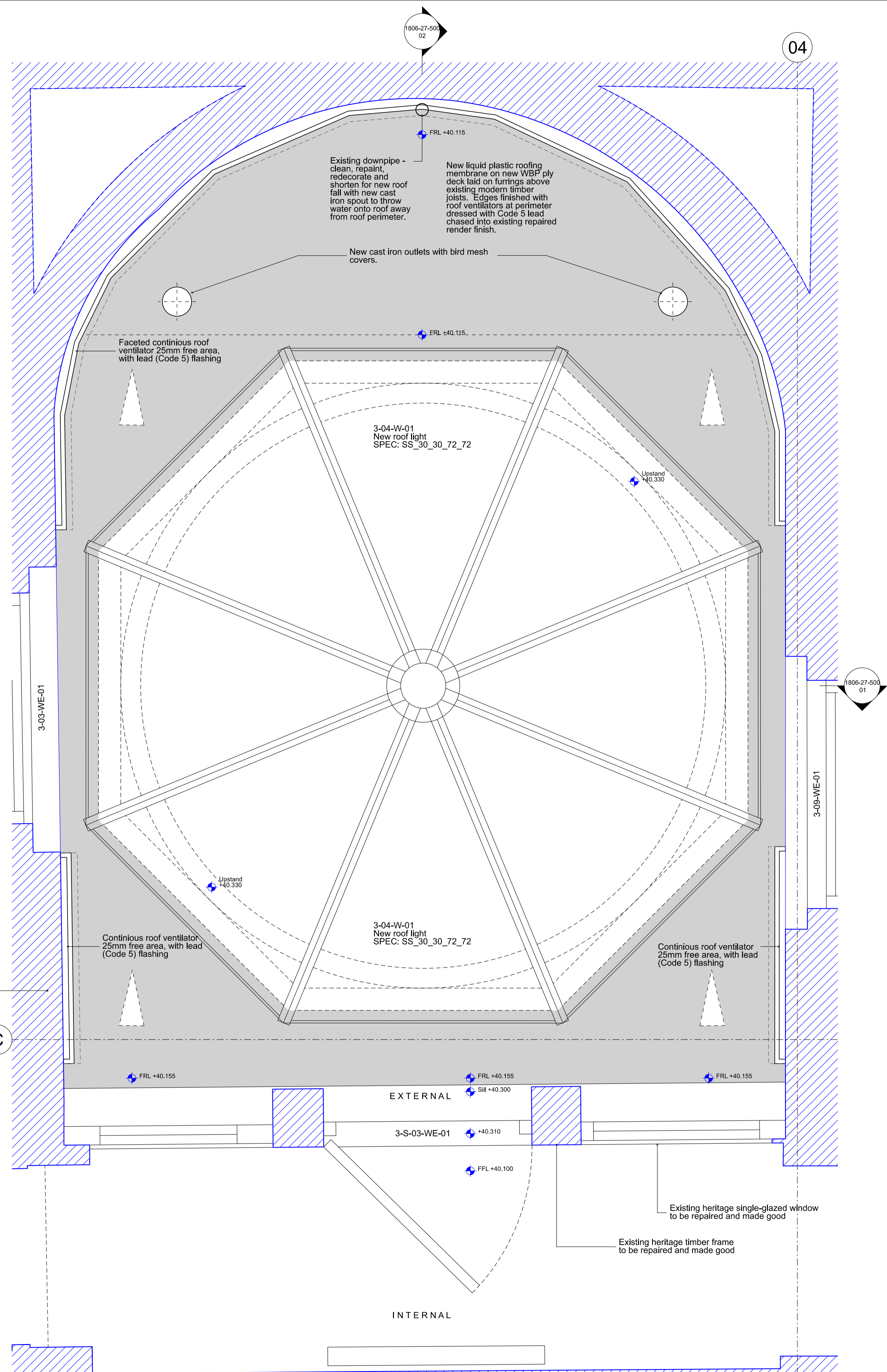

04 Rooflight Plan (Scale 1:10)

- Notes
- No demolitions to be undertaken without agreed temporary works or propping design;
  - All demolition dimensions and cut lines to be checked on site with any discrepancies brought to the attention of the CA or Architect before demolitions begin;
  - Do not scale from drawing;
  - Drawing to be printed in colour;
  - All lead details to be completed in accordance with The Lead Sheet Training Academy (LSTA), previously the Lead Sheet Association, Rolled Lead Sheet - The Complete Manual 2019 in accordance with BS EN 12588;
  - Extreme care is to be taken with the heritage plaster cornice and ceiling. Specialist advise is to be sought prior to commencement of any works.

EXISTING FABRIC

## BENNETTS ASSOCIATES

1 Rawstorne Place, London EC1V 7NL  
T +44(0)207 5203300 • www.bennettsassociates.com  
E mail@bennettsassociates.com

For Bennetts Associates' electronic information issue disclaimer -  
www.bennettsassociates.com/information/disclaimer/

Project Project No. 1806

**No.10 Bedford Sq.**  
31 West 56th Street Property Inc.

Drawing Title  
**Roof & Rooflights**  
**Third Floor**  
**03-04-W-01**

Drawing Number  
**1806\_P27\_500**

Revision/Suitability  
\\

Scale @ A3 Scale @ A1 Revision Date  
**1 : 20 1 : 10 210429**  
YY MM DD