

EXISTING FIFTH FLOOR PLAN
(1:100 @ A1)

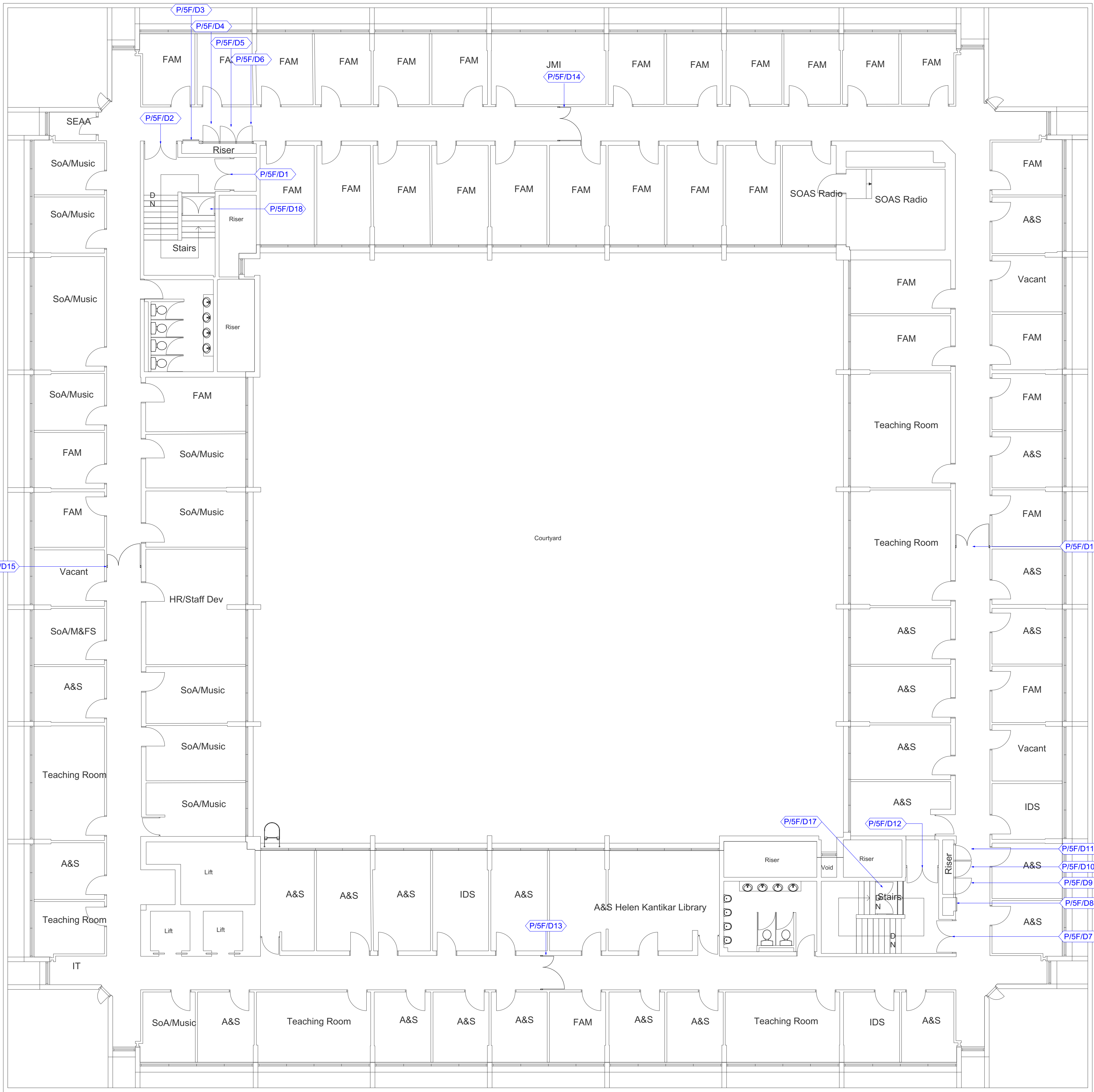

Scale 1:100 @ A1



Chartered Architects
Chartered Building Surveyors
Interior Designers
CDM Services

3 GP Centre, Yeoman Road,
Ringwood, Hampshire, BH24 3FF

+44 (0)1425 472 833
www.kendallkingscott.co.uk

Project
Fire Door Upgrade
- Philips Building
Client
SOAS University of London

Scale 1:100
Paper Size A1
Filename 200170.vwx
© Copyright Do not scale this drawing

PI30/04/21 MM First Issue
Rev Date By Ap Note

Drawing Title
Existing Fifth Floor Plan
Philips Building

Project Number Drawing Number Revision

200170-1208 P1

Date Drawn Checked Status
11/03/21 KW GC PLANNING ISSUE

Check all dimensions and levels on site

Only to be used on the site for which designed. The electronic transmission of designs/information contained in this drawing is carried out entirely at the User's risk and Kendall Kingscott Ltd. will have no liability for any errors or inaccuracies arising therefrom. The production of amended or updated information from the said designs/information by the User is entirely the responsibility of the User and Kendall Kingscott Ltd. shall have no responsibility in respect thereof whatsoever.