

PLAN

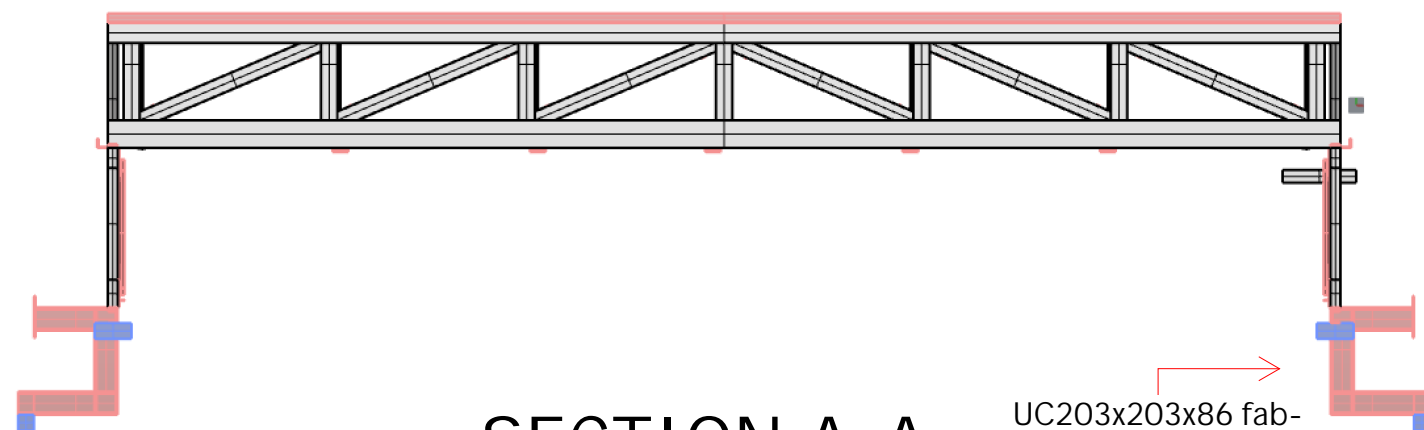

SECTION A-A

All rods to the 3 trusses to be replaced with 20mm diameter gr.8.8 bars. new washers in all locations, 150x90x30 typically, 300x90x60 to asterisked (*) location of both side trusses. Connections to be tightened, but care should be taken to avoid damage to timber

SECTION B-B

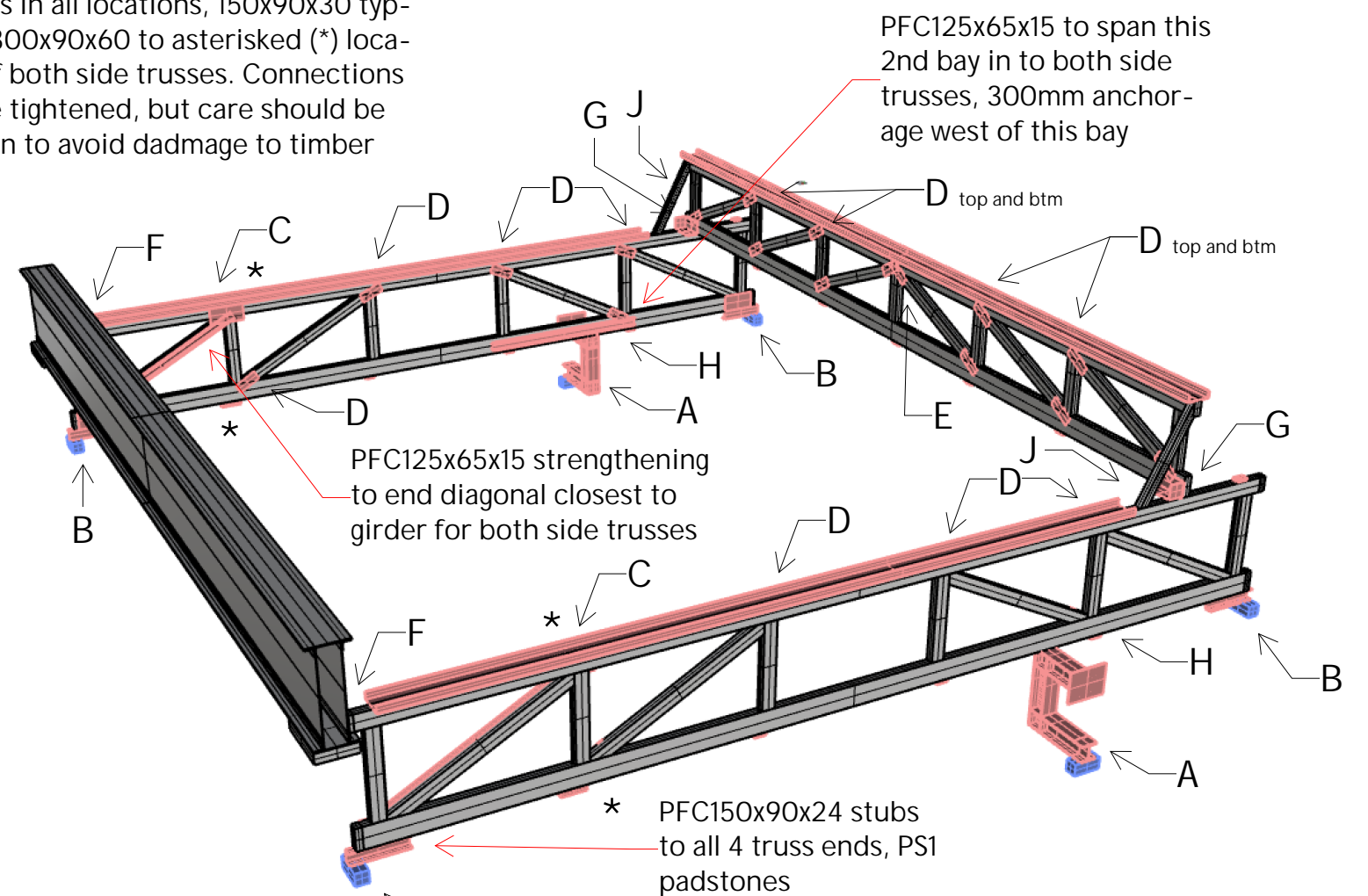
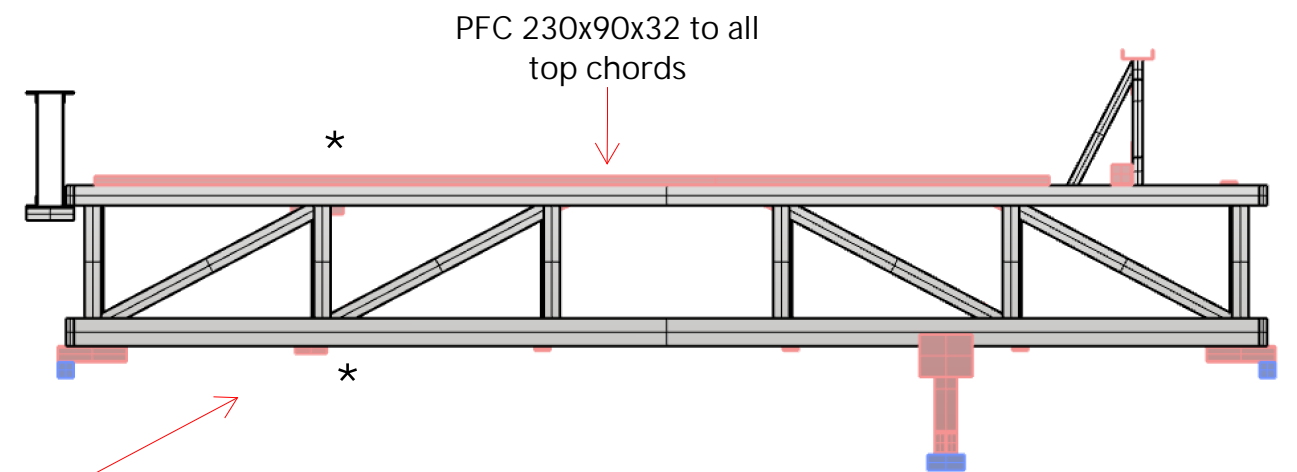

3D VIEW

Notes

Refer to HTS sketch SK241 for details and general notes
Separate parapets to architect's specification fixed into new floor joists
HTS to review all steelwork fabrication drawings prior to fabrication

Job	Koko	Date	30/03/20
Title	Timber Truss Remedial	Eng.	GGs
Job No.	1444	Sheet	SK240
		Rev.	I01