

1 EXTERNAL ELEVATION  
Scale: 1:10

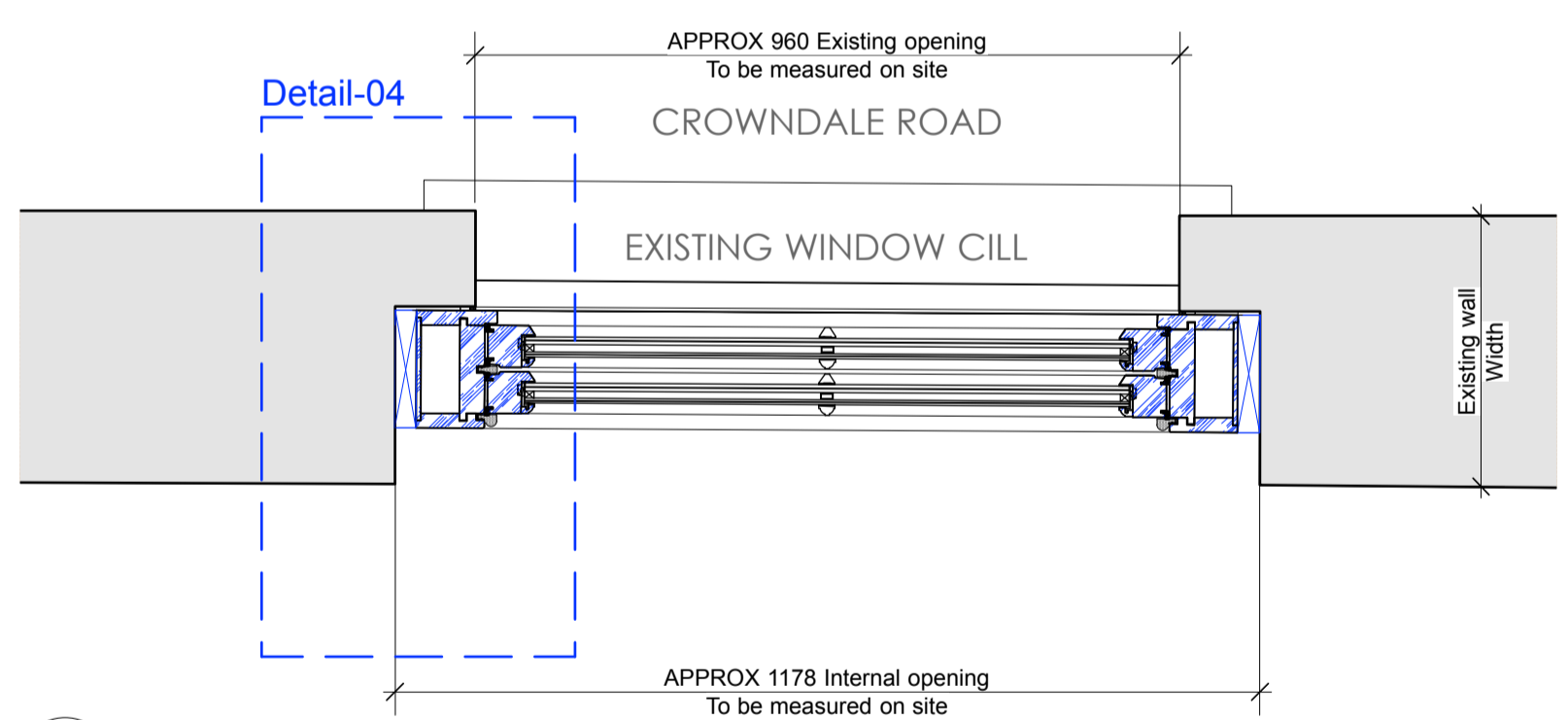

2 PLAN  
Scale: 1:10

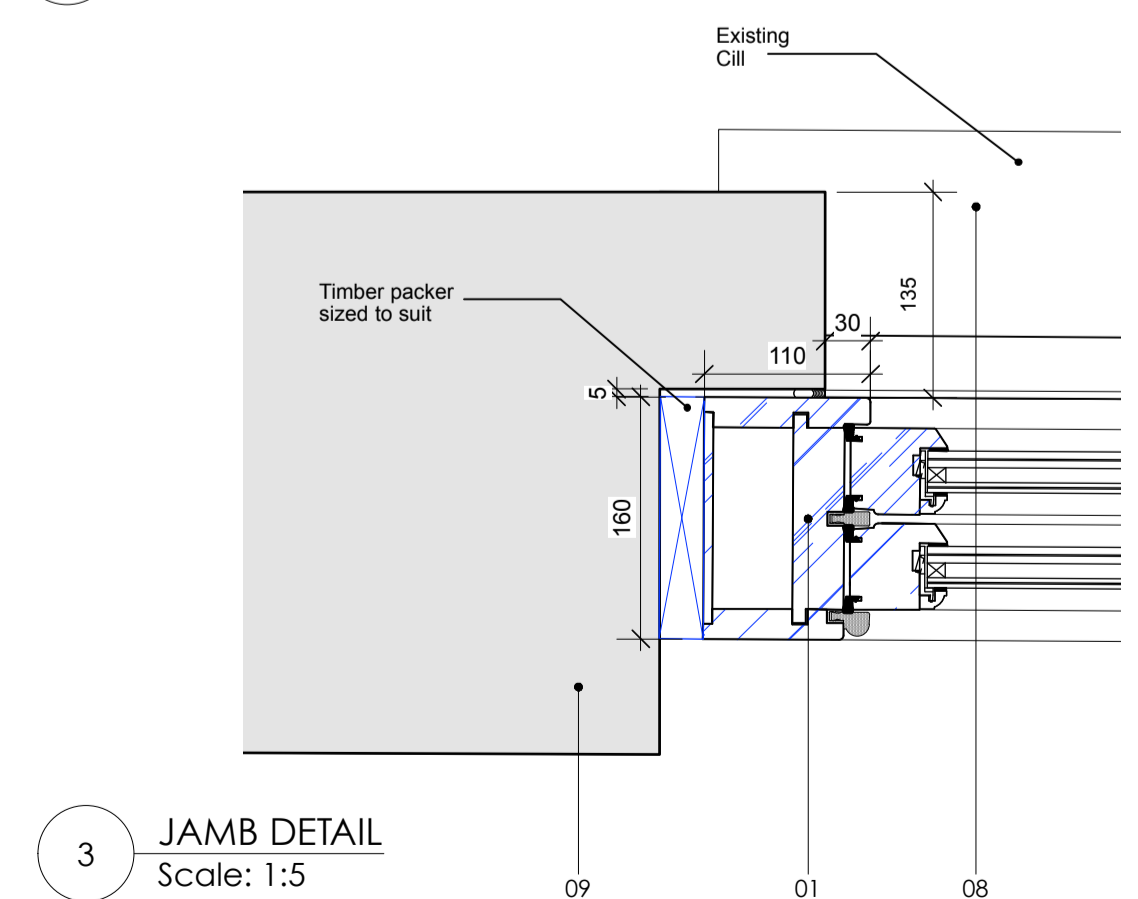

3 JAMB DETAIL  
Scale: 1:5

4 SECTION AA  
Scale: 1:10

7 HEAD DETAIL  
Scale: 1:5

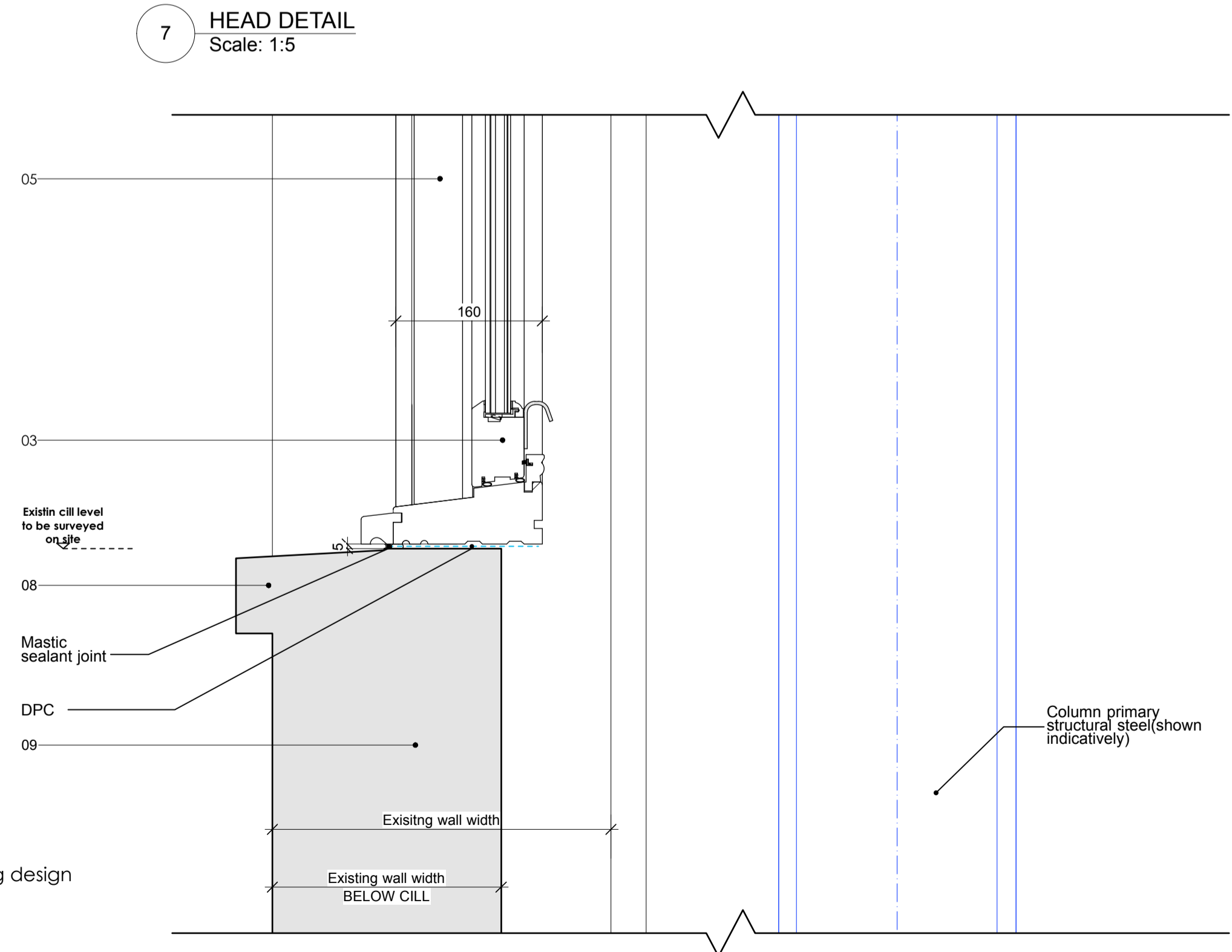

6 CILL DETAIL  
Scale: 1:5

**LEGEND**

- 01 - Box Sash Timber frame
- 02 - Timber top sash
- 03 - Timber bottom sash
- 04 - Sash Horn
- 05 - Fixed Sash Packer
- 06 - Clear Glazed Panes - to Acoustic spec for dB Rating Type Sash Lift; Finish to be approved and confirmed
- 07 - S/W packer
- 08 - Assumed Existing Concrete Cill to be surveyed and made good
- 09 - Assumed Existing Imperial brick masonry wall
- 10 - New concrete Lintel to replace old timber lintels (subject to assessment of existing lintel condition on site).

**WINDOWS**

Window Numbers: W2-14/ W2-15/ W2-16/ W2-17/ W2-18/ W2-19  
Refer to Window Schedule

IRONMONGERY: TO BE APPROVED BY ARCHITECT

Sash Fastener; Finish to be approved and confirmed  
Concealed Quadaxial Fixing Roses Lever Handle TBD (Finish TBC)  
Pulleys and Rope to be approved by Architects to match existing design

**NOTE**

Existing timber lintels to be replaced by new concrete lintels subject to condition survey. For structural connection details refer to:  
HTS-1444-P135-Section 1-1  
HTS-1444-SK216 25.09.29  
HTS-1444-SK217 25.09.19

Copyright: All rights reserved. This drawing must not be reproduced without permission.  
Only the original drawing should be relied upon. Contractors, subcontractors and suppliers must verify all dimensions on site before commencing any work or making any shop drawings.  
All shop drawings to be submitted to the architect for comment prior to fabrication.  
This drawing is to be read in conjunction with the Architect's specification, bills of quantities / schedules, structural, mechanical & electrical drawings and all discrepancies are to be reported to the architect.  
Do not scale from this drawing. Dimensions are in millimetres unless otherwise stated.

revision / date / amendments
C1 / 23/07/19 / - First Issue
C2 / 25/07/19 / - Notes updated
C3 / 03/10/19 / - Updates

- W2-14
- W2-15
- W2-16
- W2-17
- W2-18
- W2-19

EXISTING WALL - NEW SASH  
Crowndale Rd & Bayham St  
2nd Floor

# TYPE-K

03.10.19

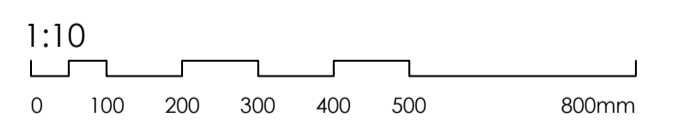

**CONSTRUCTION**

Archer Humphries Architects

Basement  
Central House  
142 Central Street  
London, United Kingdom  
EC1V 8AR  
T: +44 (0) 20 7251 8555

project title	
KOKO + Hope & Anchor + Bayham Place Camden, London	
drawing title	scale date
Typical Sash Window - Type K	Varies/A1 26.01.18
drawing number	drawn checked
AHA/ KKC /DET/665-4	PCD DA
	revision
	C3