

Copyright: All rights reserved. This drawing must not be reproduced without permission.
 Only the original drawing should be relied upon. Contractors, subcontractors and suppliers must verify all dimensions on site before commencing any work or making any shop drawings.
 All shop drawings to be submitted to the architect for comment prior to fabrication.
 This drawing is to be read in conjunction with the Architect's specification, bills of quantities / schedules, structural, mechanical & electrical drawings and all discrepancies are to be reported to the architect.
 Do not scale from this drawing. Dimensions are in millimetres unless otherwise stated.

revision / date / amendments

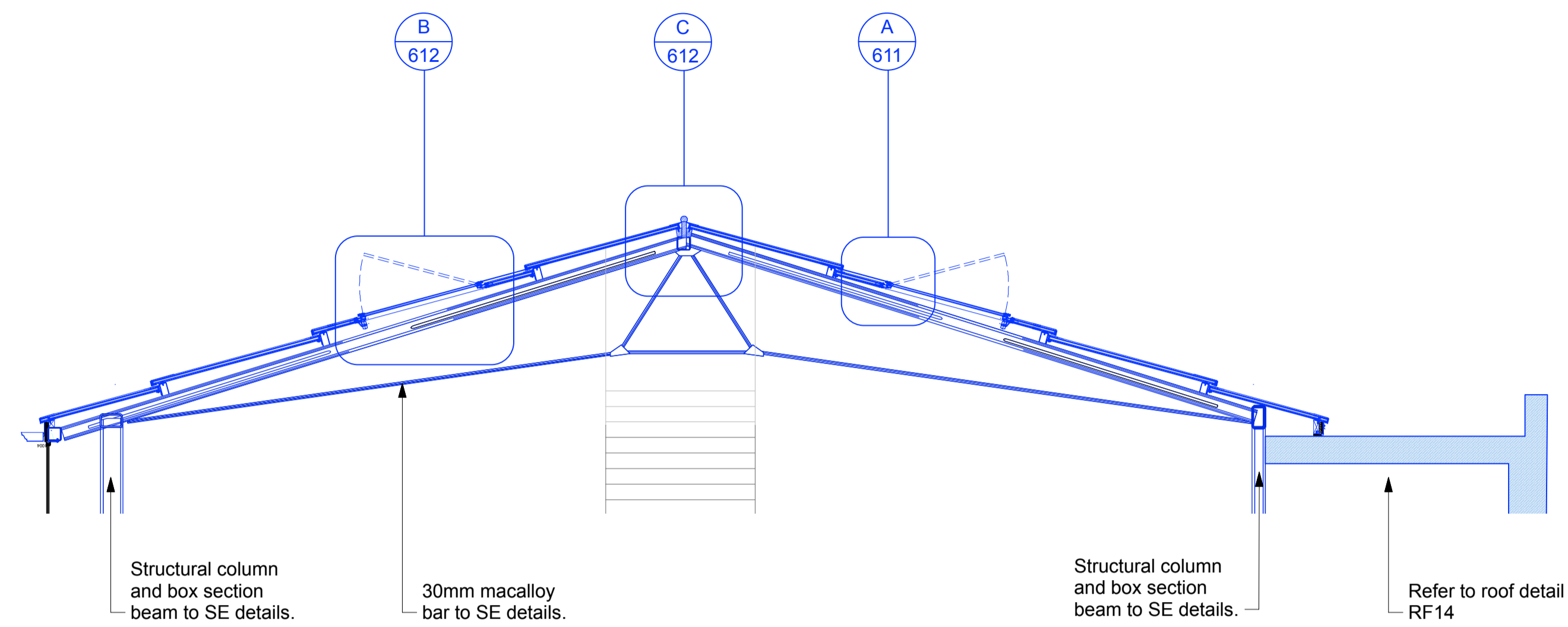
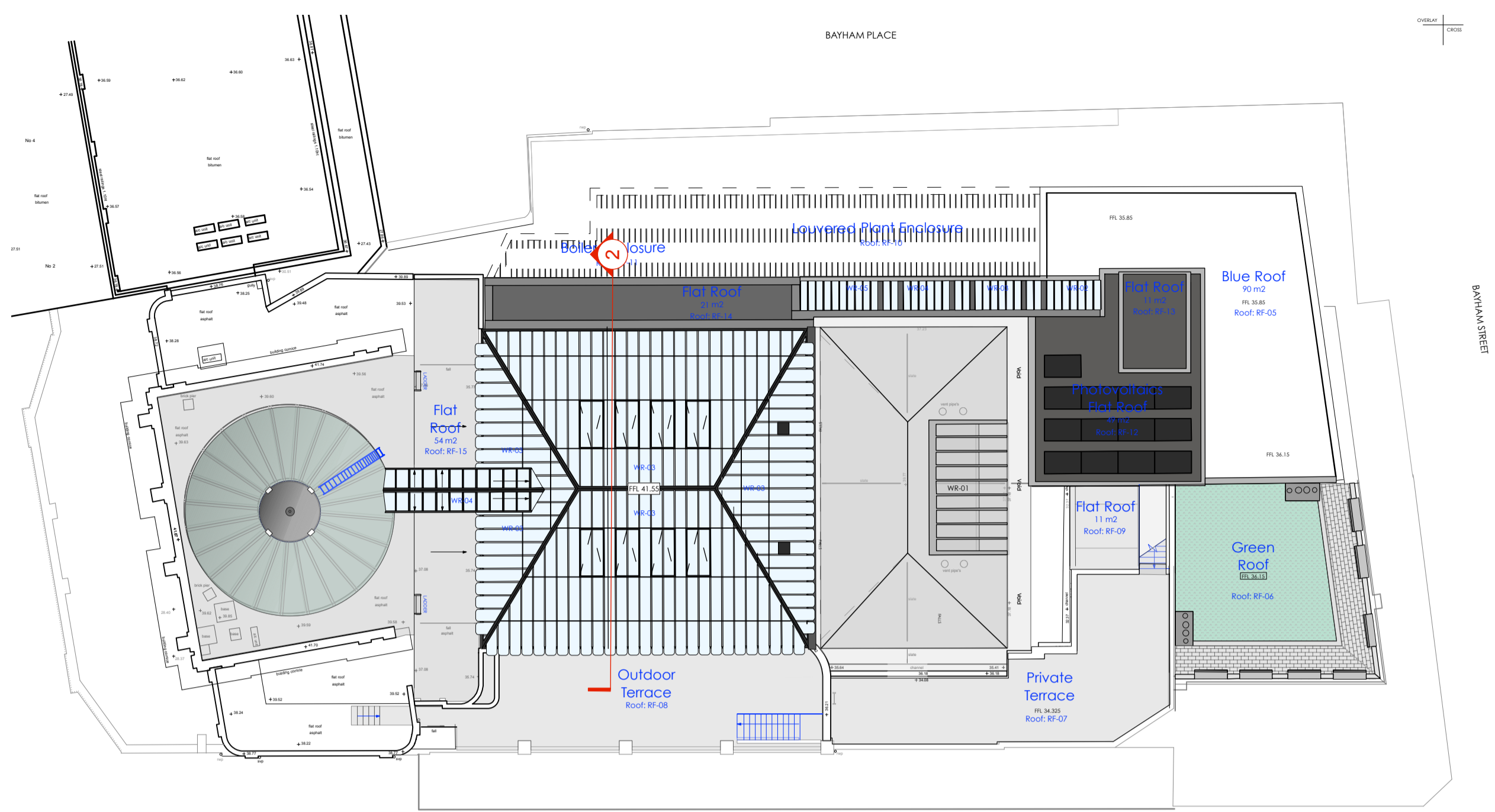

NB: Long slope conveys 3no glazing breaks with 4no tiers of glazing; upper glazing break (bars) to match with short slope glazing breaks (bars)

1 Proposed Roof Plan
Scale: 1:200

2 Proposed Glass Pavilion short section (Section FF)
Scale: 1:50

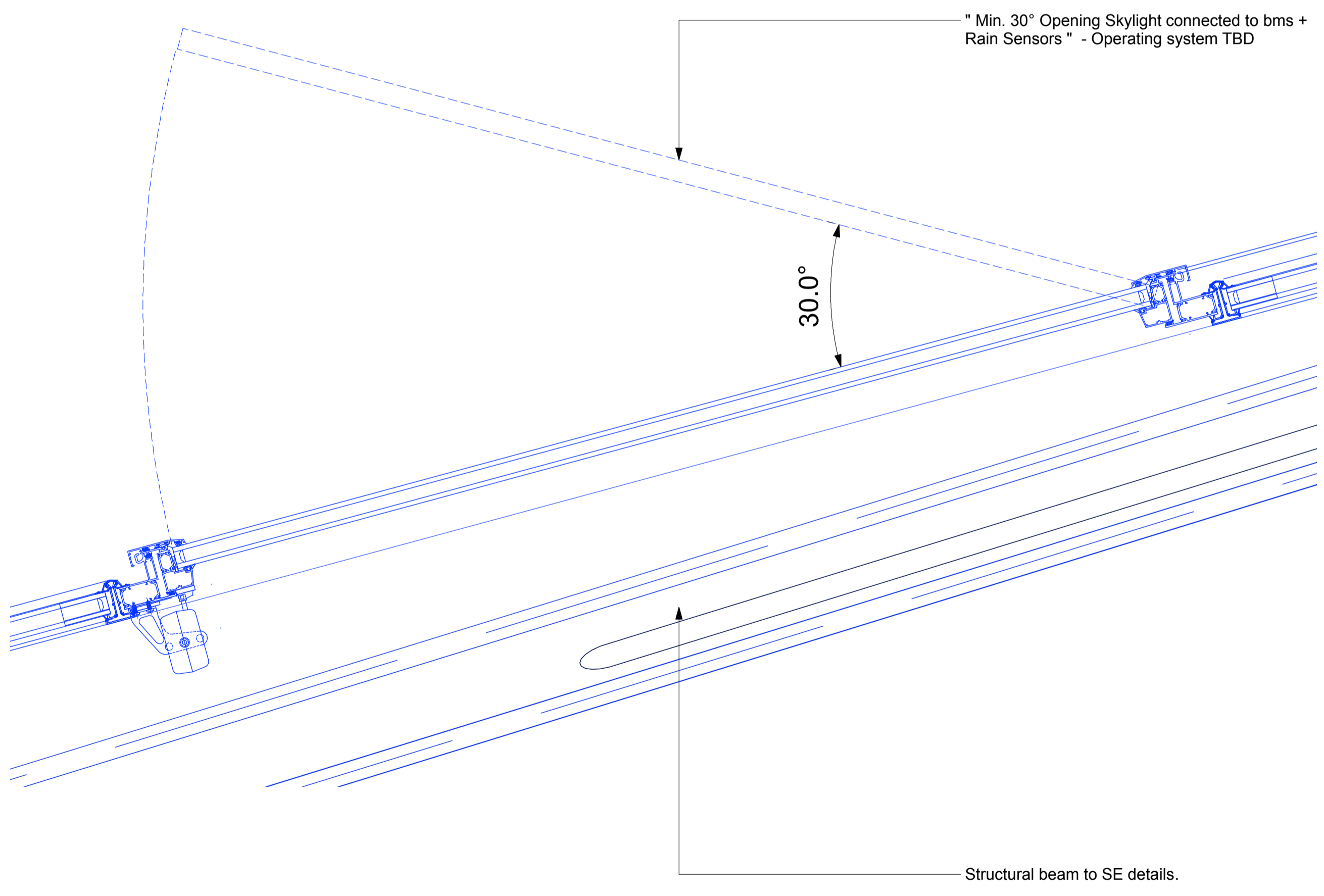

B Operable Skylight
Scale: 1:5

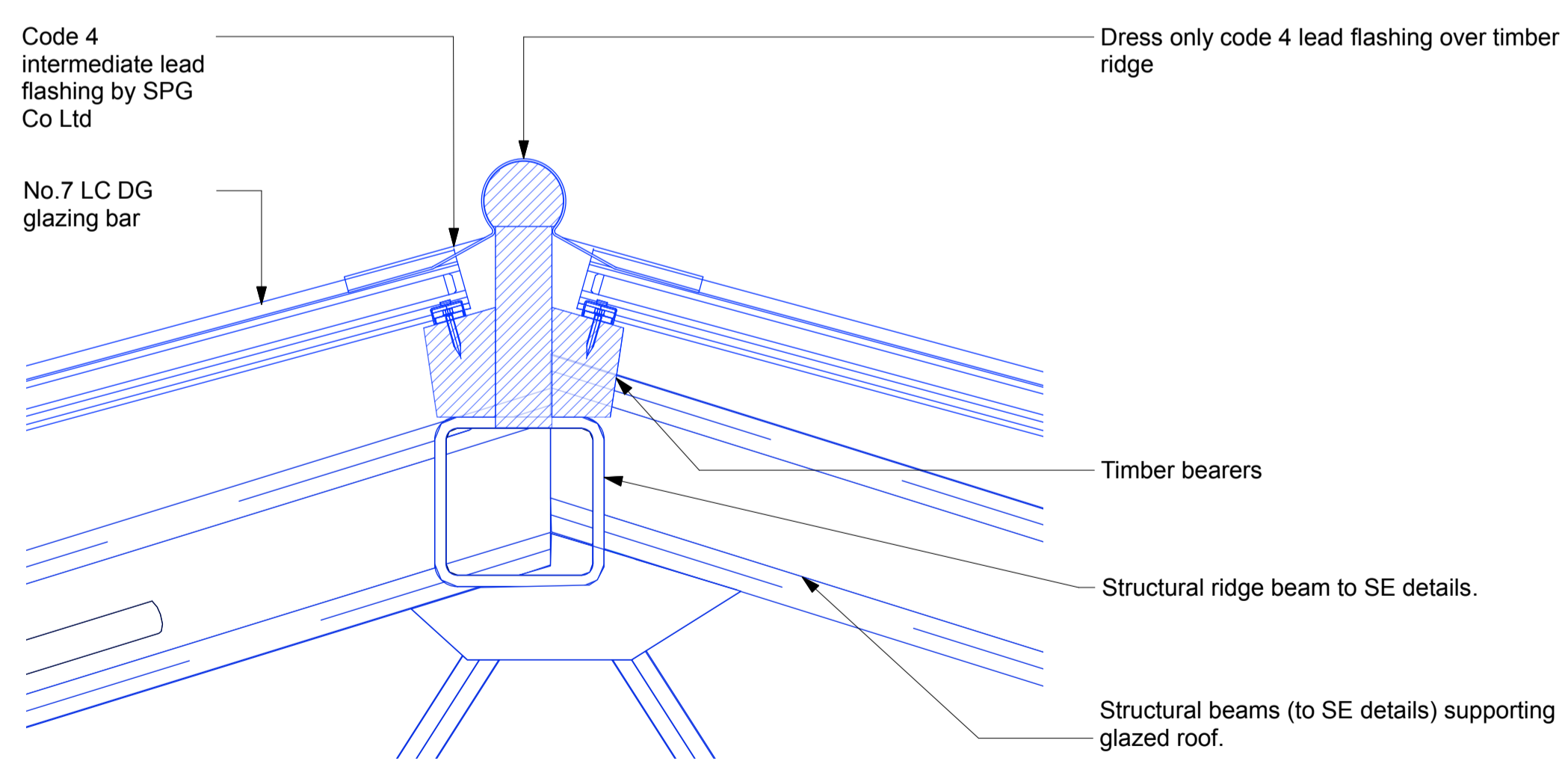

C Ridge Detail
Scale: 1:5

02.02.18

STAGE 4

Archer Humphryes Architects

Basement
Central House
142 Central Street
London, United Kingdom
EC1V 8AR
T: +44 (0) 20 7251 8555

project title		KOKO + Hope & Anchor + Bayham Place Camden, London	
drawing title	scale	date	
Proposed Glass Pavilion Details 3	1:25 @A1	11.08.17	
drawing number	revision	drawn	checked
AHA/KKC/DEI/612	-	FR	DA

Note:
 1. Drawing is design intent and to be read in conjunction with other consultant details.
 2. Refer to Fire Report for minimum fire requirements.
 3. Refer to Acoustic and Sustainability report for minimum respective acoustic and energy performance requirements.
 4. Refer to manufacturer's installation guidelines / information for all products prior to installation