

1 Proposed Roof Plan
Scale: 1:200

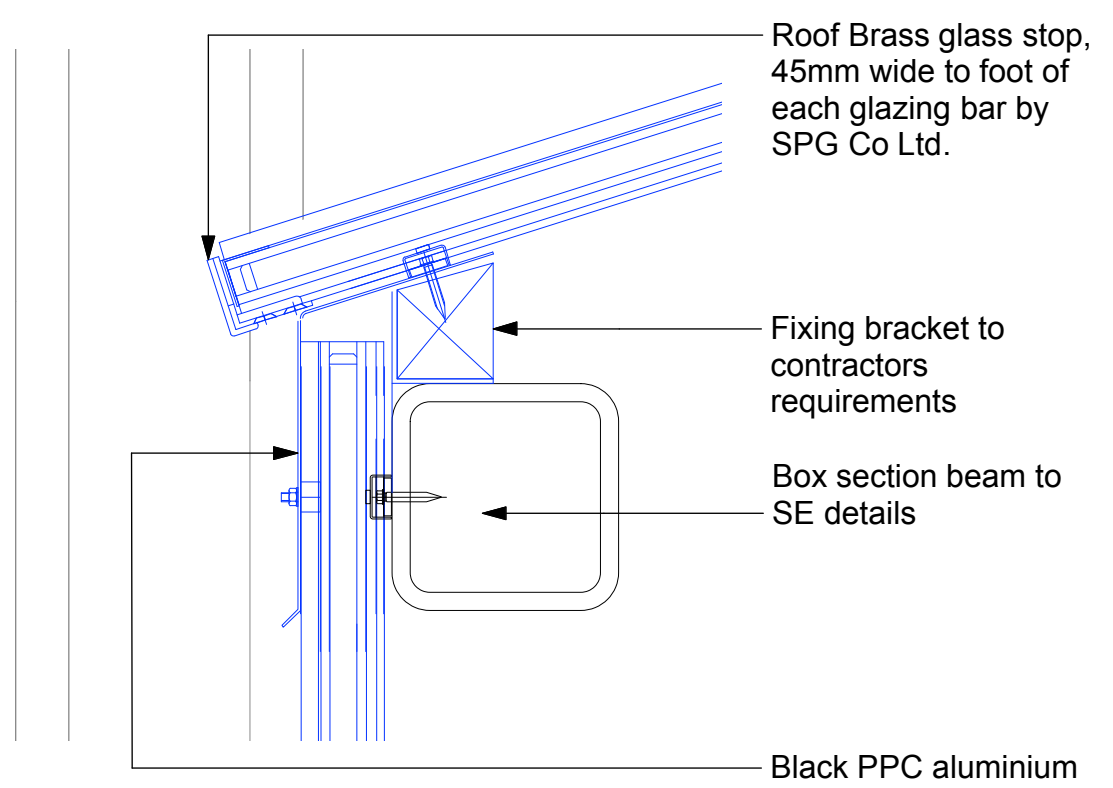

A Proposed Eaves Detail
Scale: 1:5

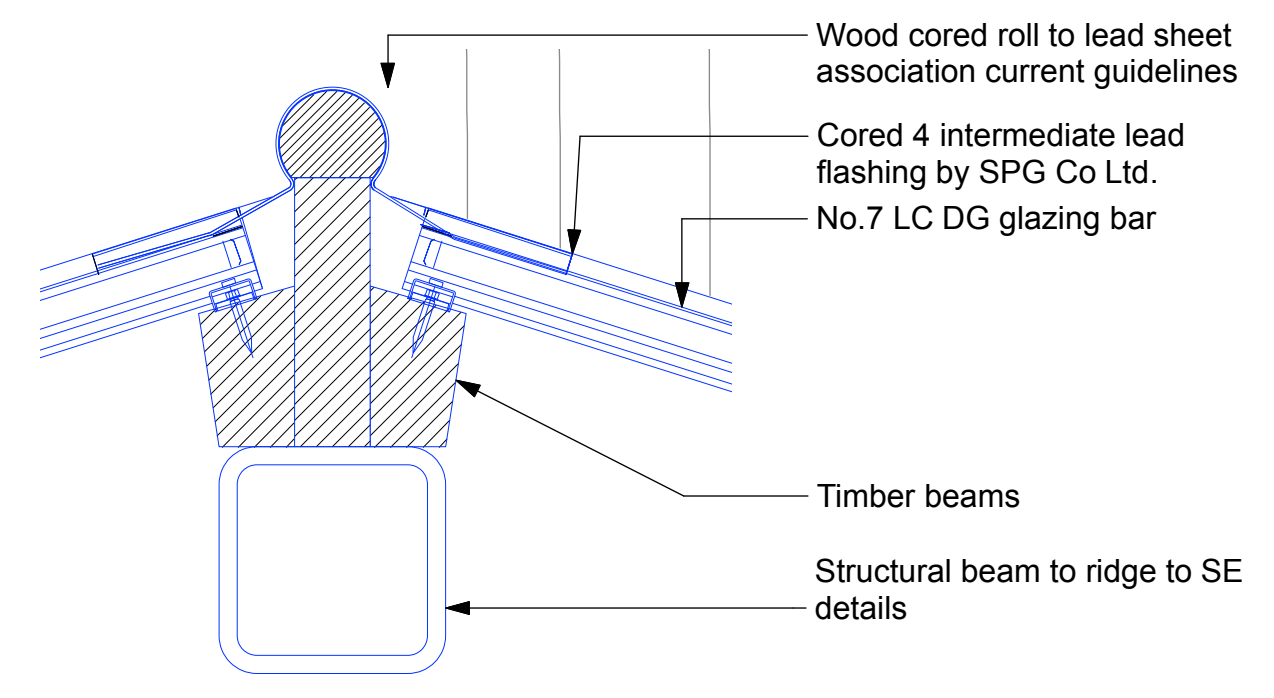

B Proposed Ridge Detail
Scale: 1:5

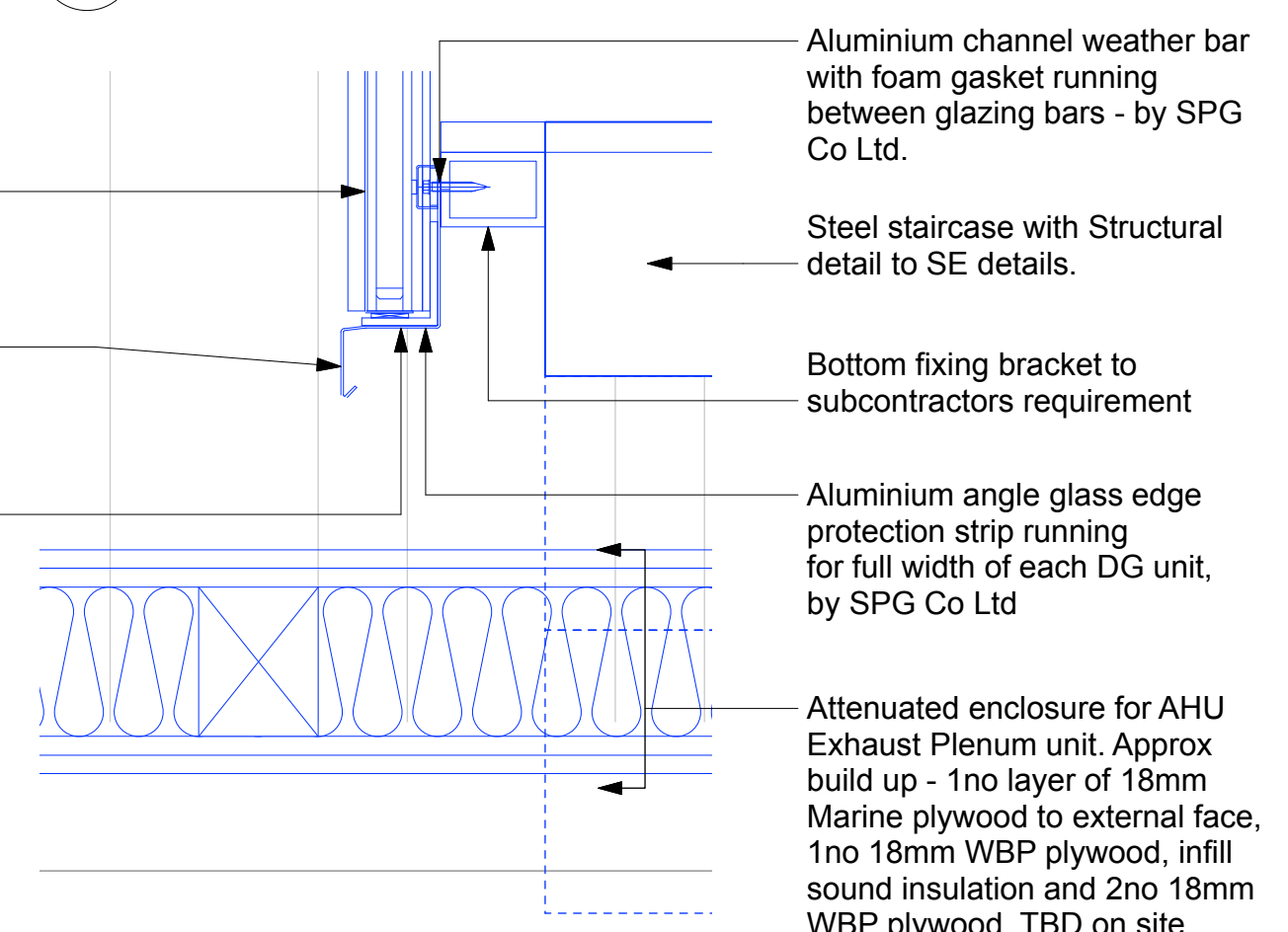

C Proposed Bottom Deck Detail
Scale: 1:5

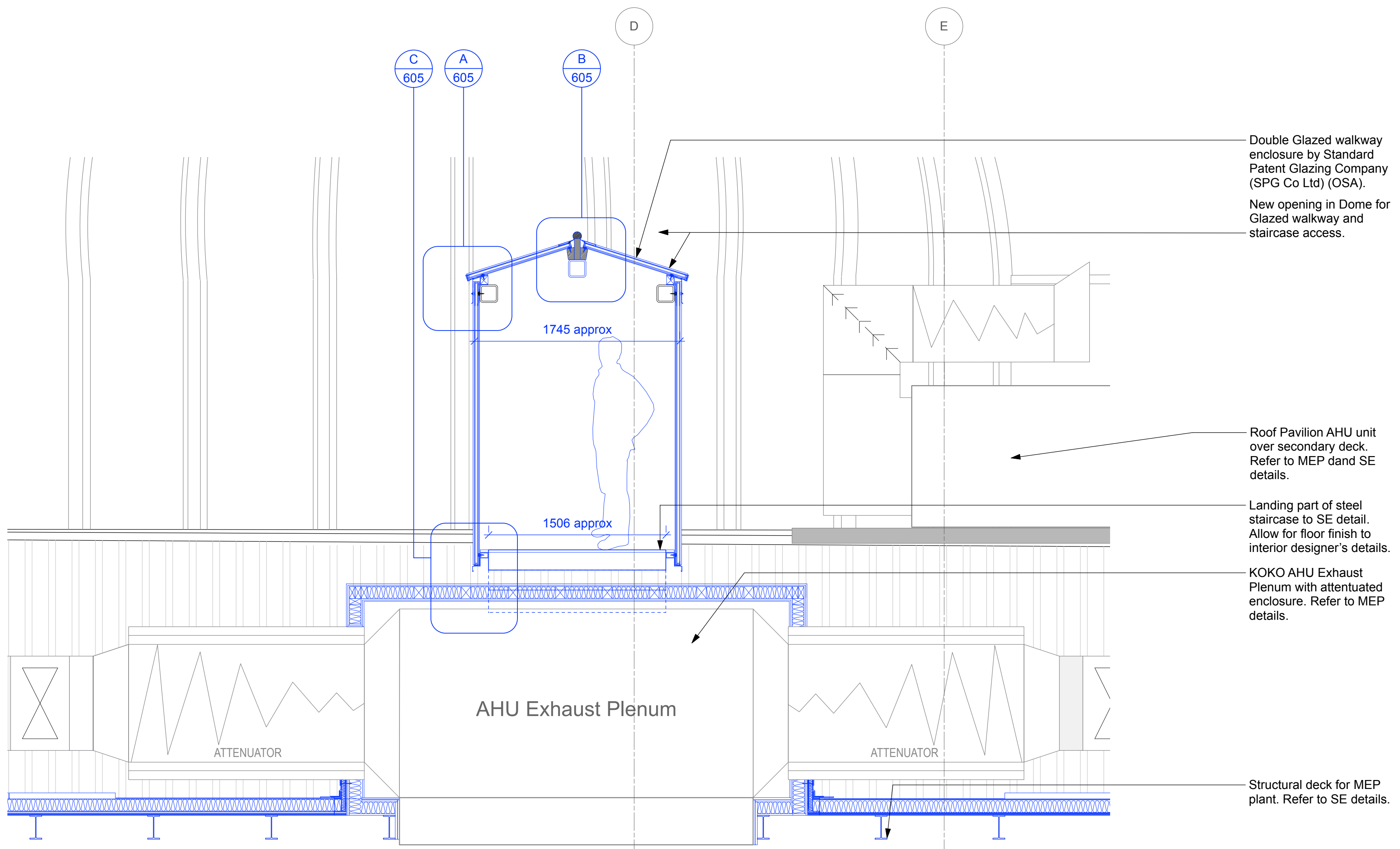

2 Proposed Section through Glazed walkway and Plant Enclosure
Scale: 1:25

Copyright: All rights reserved. This drawing must not be reproduced without permission.
Only the original drawing should be relied upon. Contractors, subcontractors and suppliers must verify all dimensions on site before commencing any work or making any shop drawings.
All shop drawings to be submitted to the architect for comment prior to fabrication.
This drawing is to be read in conjunction with the Architect's specification, bills of quantities / schedules, structural, mechanical & electrical drawings and all discrepancies are to be reported to the architect.
Do not scale from this drawing. Dimensions are in millimetres unless otherwise stated.

revision / date / amendments

Double Glazed walkway enclosure by Standard Patent Glazing Company (SPG Co Ltd) (OSA).
New opening in Dome for Glazed walkway and staircase access.

Roof Pavilion AHU unit over secondary deck. Refer to MEP and SE details.

Landing part of steel staircase to SE detail. Allow for floor finish to interior designer's details.

KOKO AHU Exhaust Plenum with attenuated enclosure. Refer to MEP details.

Structural deck for MEP plant. Refer to SE details.

02.02.18

STAGE 4

Archer Humphryes Architects

Basement
Central House
142 Central Street
London, United Kingdom
EC1V 8AR
T: +44 (0) 20 7251 8555

project title		KOKO + Hope & Anchor + Bayham Place Camden, London	
drawing title	scale	date	
Proposed Glazed Walkway + Plant Details 1	A1	11.08.17	
drawing number	drawn	checked	
AHA/KKC/DET/605	FR	DA	
revision			