

**Proposed landscaping around Campus building**  
 Area = 234m<sup>2</sup>  
**SuDS Proposal**  
 Use of permeable paving with gravel storage prior to infiltration into the ground.

**Campus Building**  
 Total roof area = 571m<sup>2</sup>  
 Normal roof area = 439m<sup>2</sup>  
 Green roof area = 132m<sup>2</sup>

Existing combined public sewer

**SuDS Proposal**  
 Runoff from Campus building roof and from re-routed Administration building roof (ie: via red arrow) to discharge from site via attenuation and flow control at a rate of 2 l/s into the existing private surface water drain.  
 Area = 921m<sup>2</sup>

**Existing Administration building**  
 runoff discharges via RWP into existing surface water gully.  
 Area = 210m<sup>2</sup>

**Current condition**  
 Existing **Administration building** runoff discharges via RWP into the existing private surface water drain (ie: via blue arrow)  
 Area = 350m<sup>2</sup>

**Railside development runoff** discharges via attenuation and flow control at a rate of 2 l/s into the existing private surface water drain.  
 Area = 288m<sup>2</sup>

Existing connection to public sewer

Impermeable paving to upper terrace as existing  
 Area = 233m<sup>2</sup>

Existing private surface water drain

**Service yard runoff** discharges via gullies into existing private surface water drain.  
 Area = 1444m<sup>2</sup>

**Redline boundary**  
 Area = 3330m<sup>2</sup>  
**Prior to railside development**  
 Area drained to sewer network = 3042m<sup>2</sup>  
 Area undrained = 288m<sup>2</sup>

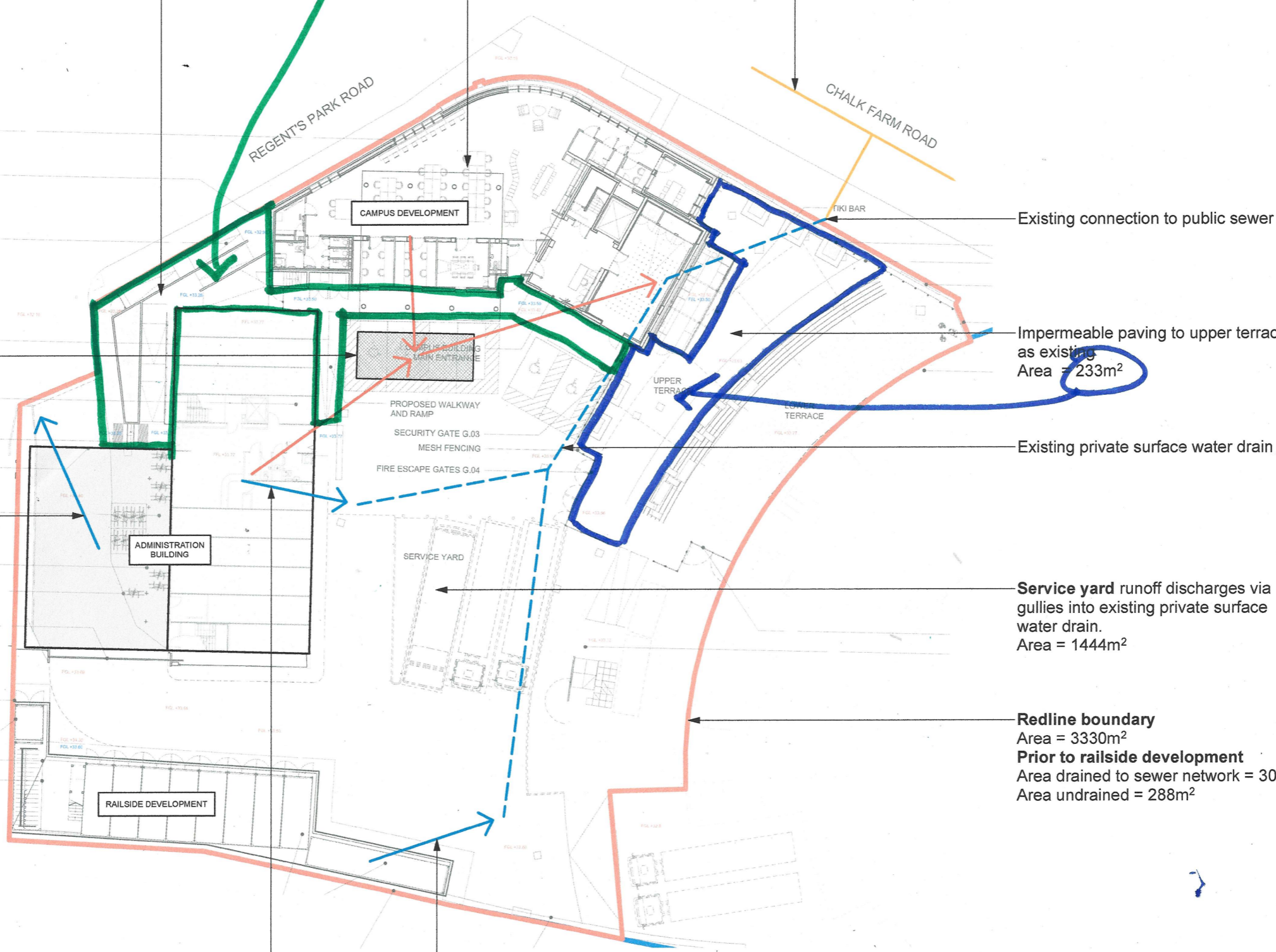

Momentum Consulting Engineers Ltd. have a quality management system accredited under BS EN ISO 9001 Certificate No. G02005206  
 This drawing has been prepared for the sole benefit of the client named below. The liability of Momentum, its directors and employees in respect to this information will not extend to any other project.  
 This drawing shall not be reproduced in any form without prior permission being granted.  
 This drawing is to be read in conjunction with all other relevant contract documents and other consultants information.  
 Do not scale from this drawing. Responsibility is not accepted for errors made by others when scaling from this drawing.  
 The dimensional accuracy of the digital data contained within this drawing may not be a true representation of the actual dimensional setting out. Responsibility is not accepted for errors made by others when using digital data from this drawing.  
 Work only to figured dimensions.  
 Unless indicated otherwise all levels are in metres and all dimensions are in millimetres. All levels and dimensions should be checked on site by the persons carrying out the work and any discrepancies notified to Momentum before proceeding with relevant works.  
 Where information on this drawing is not clear please contact us.  
 Setting out is the responsibility of the Architect. The Contractor must check any setting out given on Momentum drawings with the Architect before proceeding with associated works.

**H&S Symbols**

- Indicates a residual risk as a warning
- Indicates a residual risk requiring a compulsory action
- Indicates a residual risk requiring a prohibitive action
- Indicates a residual risk for information

**DRAFT**  
 NOT FOR CONSTRUCTION

T1 01.02.21 dp  
 Drawing replaces Drg. No. 2796-601

Rev	Date	By
Work Stage		
RIBA Stage 4		
Reason For Issue		
Tender		

Project Title  
 The Roundhouse  
 Camden  
 London  
 Campus Development

Client  
 The Roundhouse

Architect  
 Reed Watts

Drawing Title  
 GA Plan  
 Below Ground Drainage  
 Proposed  
 Catchment Areas

Date	Scale at A1	Scale at A3
Feb 21	1:200	1:400

Drawn by	Reviewed by	Approved by
dp	dp	dp

**MOMENTUM**  
 structural engineers  
 Bath | London  
 01225 444194 | 020 7739 6939  
 www.momentumengineering.com

Project No.	Drawing Ref.	Revision
2796	609	T1

