

**ISSUED FOR APPROVAL**

**Status A** ..... ☐  
(Proceed - No further comments)

**Status B** ..... ☐  
(Proceed incorporating comments)

**Status C** ..... ☐  
(Rejected)

**Signed** .....

**Date** .....

### THIRD FLOOR

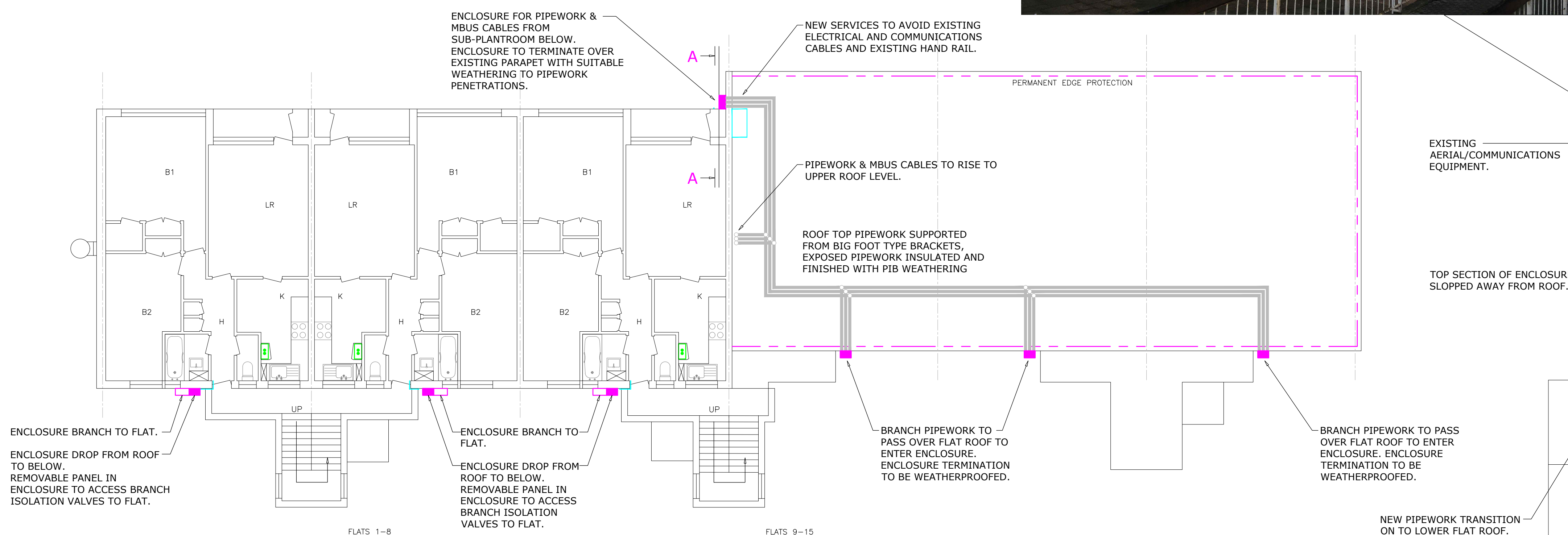

## SECOND FLOOR

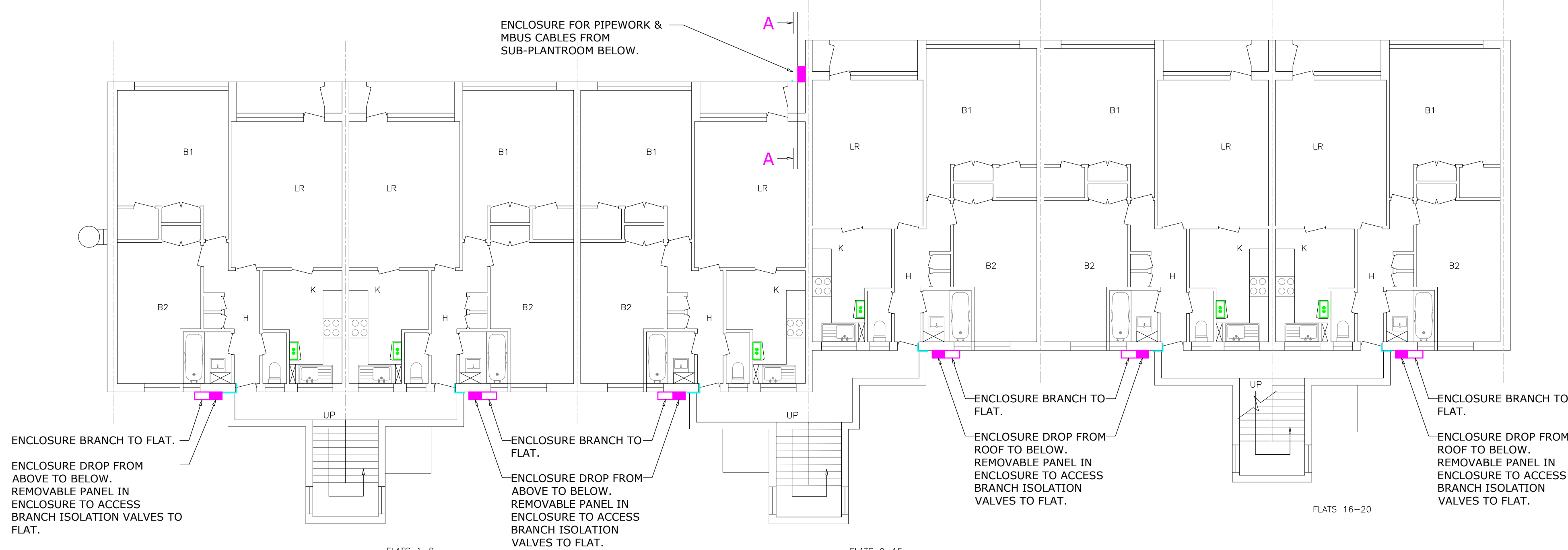

FIRST FLOOR

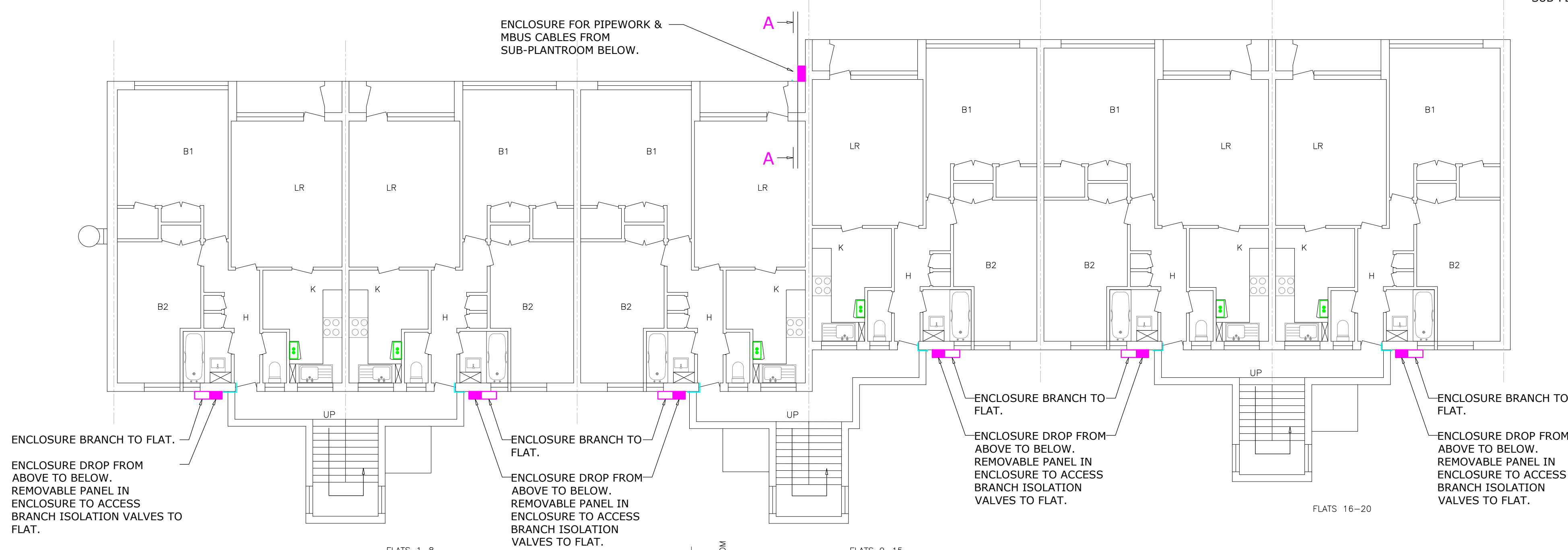

## GROUND FLOOR

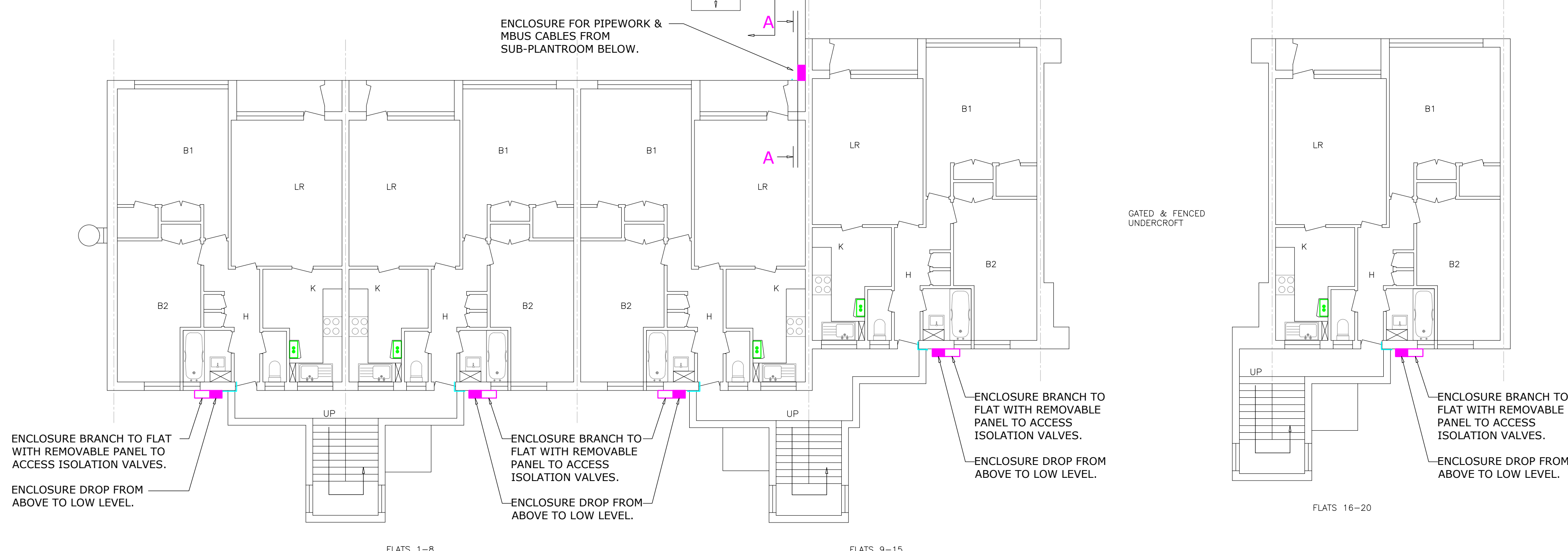

SECTION A-A (SCALE 1:25@A0)



Notes:

ENCASEMENT:  
2mm THICK PPC ALUMINIUM PIPE BOXING &  
ANGLE FRAMEWORK.  
RAL COLOUR TBA.  
VALVE ACCESS HATCHES SQUARE, FACE FIXED  
2mm THICK PPC ALUMINIUM COVER PLATE WITH  
CORNER FIXINGS TO ALLOW FUTURE ACCESS.  
ALL SHARP EDGES TO BE REMOVED.

FURTHER REFERENCE IS TO BE MADE TO PRE-PLANNING DRAWING I1237/M/DET/CHI/1 AND ASSOCIATED DETAIL DRAWINGS VIEWS 'A' TO 'L' INCLUSIVE.

C	25.03.21	First planning application issue.	F
Rev	Date	Description	D
Status: <b>PLANNING APPLICATION</b>			

**INVICTA**  
Building Services Ltd

Weald Court, 101-103 Tonbridge Road,  
Hildenborough,  
Kent TN11 9HL  
Telephone: 01732 833552  
Facsimile: 01732 834768



CLIENT  
LONDON BOROUGH OF  
CAMDEN

---

PROJECT  
ST SILAS ESTATE HEATING  
SYSTEM INSTALLATION  
CONTRACT. LONDON NW5

TITLE	CHISLET BLOCK PLANNING APPLICATION NEW PLAN LAYOUT
-------	--

Drawn: RDA	Date: 17.03.21	Scale:1:100@A0
Drawing No.	i1237/M/DET/CHI/16	Rev. C