

**NOTES**

- WHB - 300 TRAPPED WASTE
- SHR - 400 TRAPPED WASTE WITH TOP RODDING ACCESS
- BATH - 400 TRAPPED WASTE
- WC - 1000 SOIL PIPE
- WM - 400 TRAPPED STANDPIPE
- SINK - 400 TRAPPED WASTE
- DW - 400 TRAPPED STANDPIPE
- CYL - 400 TRAPPED STANDPIPE
- BOILER - 300 HEPVO DRY TRAPPED STANDPIPE

**LEGEND**

- PIPEWORK AT HIGH LEVEL
- PIPEWORK AT LOW LEVEL
- BELOW GROUND RAINAGE
- AAV - AIR ADMITTANCE VALVE
- CYL - CYLINDER
- DW - DISHWASHER
- FA - FROM ABOVE
- FCU - FAN COIL UNIT
- FG - FLOOR GULLY
- H/L - HIGH LEVEL
- L/L - LOW LEVEL
- RE - RODDING EYE
- RWO - RAIN WATER OUTLET
- RWP - RAIN WATER PIPE
- SHR - SHOWER
- SS - STUB STACK
- SVP - SOIL VENT PIPE
- T/A - TO ABOVE
- T/B - TO BELOW
- VP - VENT PIPE
- WC - WATER CLOSET
- WHB - WASH HAND BASIN
- WM - WASHING MACHINE
- WP - WASTE PIPE

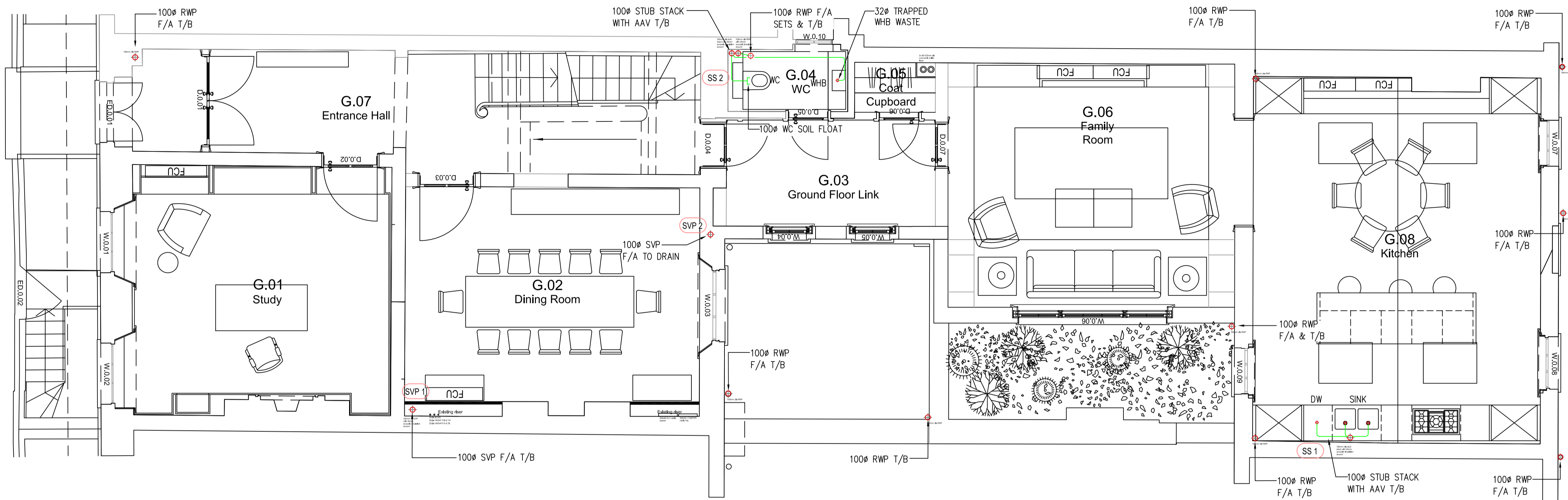

GROUND FLOOR PLAN

**BWIC NOTE**  
 USE OF EXISTING NOTCHES AND JOISTS TO BE USED WHERE PRACTICAL. ANY NEW NOTCH AND HOLES WILL BE CARRIED OUT IN ACCORDANCE TO LISTED BUILDING REGULATIONS AND STRUCTURAL ENGINEER'S DETAILS

**Note**  
 ALL DIMENSIONS TO BE VERIFIED ON SITE BEFORE SETTING OUT OR MAKING ANY SHOP DRAWINGS. THIS DRAWING IS TO BE READ IN CONJUNCTION WITH THE CONSULTANT ENGINEER'S SPECIFICATION.

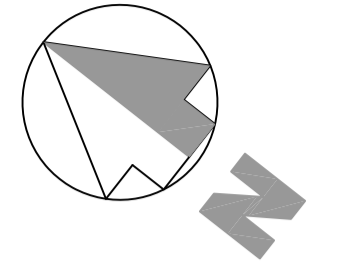

ref./date	REVISIONS
PT 23.12.20	PRE-TENDER ISSUE
PT1 03.02.21	PRE-TENDER ISSUE
T 22.02.21	TENDER ISSUE, GA'S UPDATED
T1 15.03.21	TENDER ISSUE, GA'S UPDATED

**WORK STAGE 2**

**KUT**  
 KUT LLP  
 First Floor  
 2E Berol House  
 25 Ashley Road  
 London  
 N17 9LJ  
 Tel: +44(0)20 8348 5171  
 Fax: +44(0)20 8340 8926  
 Email: tkp@kut.co.uk  
 Web: www.kut.co.uk

**LOWER GROUND & GROUND PUBLIC HEALTH SERVICES ABOVE GROUND DRAINAGE (WORKS STAGE 2)**

**Project**  
 55 CUMBERLAND TERRACE  
 CAMDEN, LONDON  
 NW1 4HJ

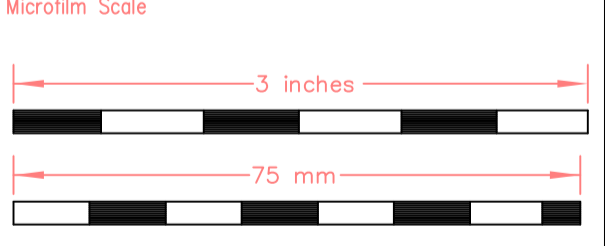

**Architect**  
 COLLETT-ZARZYCKI Ltd  
 Fernhead Studios, 2B  
 Fernhead Road, London W9 3ET  
 Tel: +44(0)20 8969 6967  
 Email: mail@czltd.co.uk

<b>Scale</b>	A1@1:50	<b>Drawn</b>	IC
<b>Date</b>	Nov 2020	<b>Checked</b>	

**Issue**  
 TENDER

Project No.	Services	Dwg No.	Rev.
6618	PH	WS2-101	T1

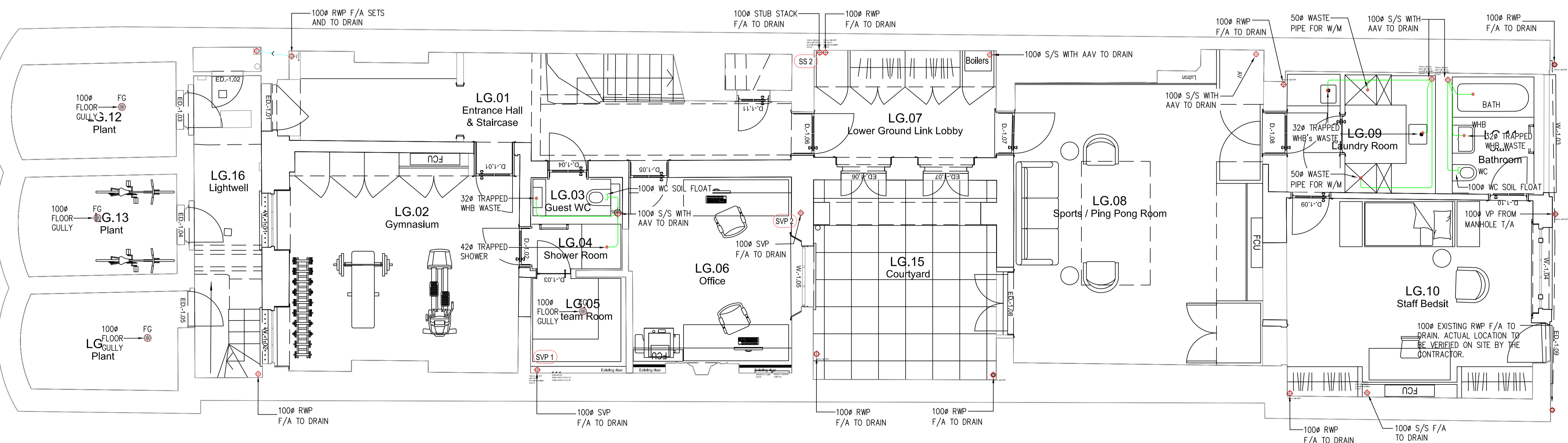

LOWER GROUND FLOOR PLAN

**Lower Ground & Ground**