







LEGEND

-  CEILING MOUNT IN-LINE EXTRACT FAN UNIT AS VECTAIRE'S MFIL100T COMPLETE WITH ADJUSTABLE OVER-RUN TIMER FROM 3 & 15 MINUTES OR EQUAL WITHIN JOINERY & REMOVABLE ACCESS PANEL.
-  EXTRACT AIR VALVE
-  FRESH AIR SUPPLY VALVE
-  RECTANGULAR VENTILATION DUCTWORK
-  EXTRACT
-  DUCTED COOKERHOOD
-  FIRE BREAK

NOTES

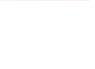
1. FOR EXACT FLOOR FINISHES REFER TO INTERIOR DESIGNER/ARCHITECTS DRAWINGS.
2. FINAL LOCATIONS OF AIR VALVES TO BE AGREED WITH ARCHITECT.
3. FINAL LOCATION OF MVHR & MEV BOOST SWITCHES TO BE AGREED WITH ARCHITECT.
4. FIRE BREAK 2 HR AS SUPPLIED BY DOMUS OR EQUAL & APPROVED TO BE PROVIDED WHERE PASSING THROUGH FIRE RATED WALLS & FLOORS.
5. VENTILATION DUCTWORK SHALL BE INSTALLED WITH FIRE BREAK DUCT CONNECTOR WHERE PENETRATING THROUGH FLOORS & ROOF.

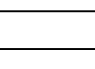
BWIC NOTE

1. USE OF EXISTING NOTCHES AND JOISTS TO BE USED WHERE PRACTICAL. ANY NEW NOTCH AND HOLES WILL BE CARRIED OUT IN ACCORDANCE TO LISTED BUILDING REGULATIONS AND STRUCTURAL ENGINEER'S DETAILS.
2. ANY HOLES IN WALLS TO HAVE 'LETTER BOX' ARRANGEMENT TO BE AGREED WITH MBP.

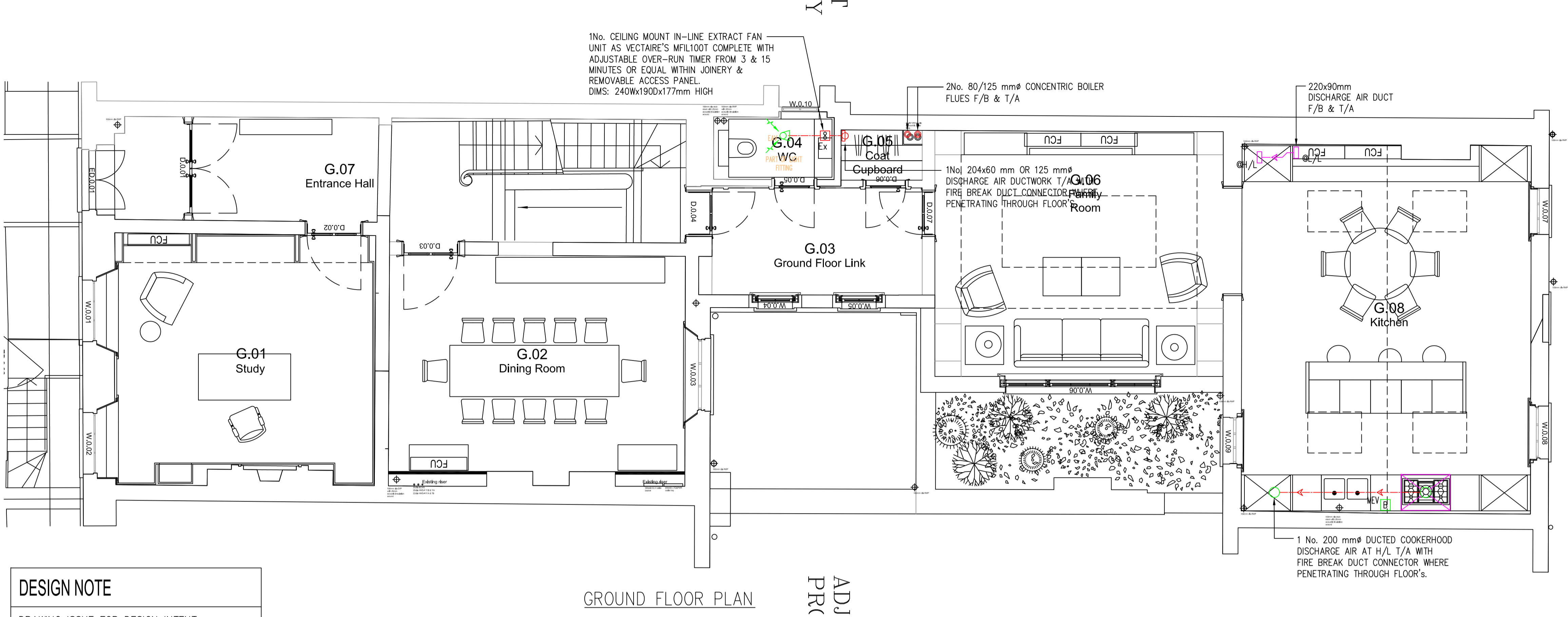

GROUND FLOOR PLAN
ADJ
PRC

DESIGN NOTE

DRAWING ISSUE FOR DESIGN INTENT DEVELOPMENT. FINAL LOCATION OF AIR VALVES VENTILATION END POSITIONS, IN PARTICULAR ILLUSTRATED AT THE EXTERNAL FACADES AND ROOF TO BE AGREED WITH PROJECT DESIGN TEAM AND SUBJECT TO PLANNING.

LOWER GROUND AND GROUND FLOOR MECHANICAL SERVICES VENTILATION

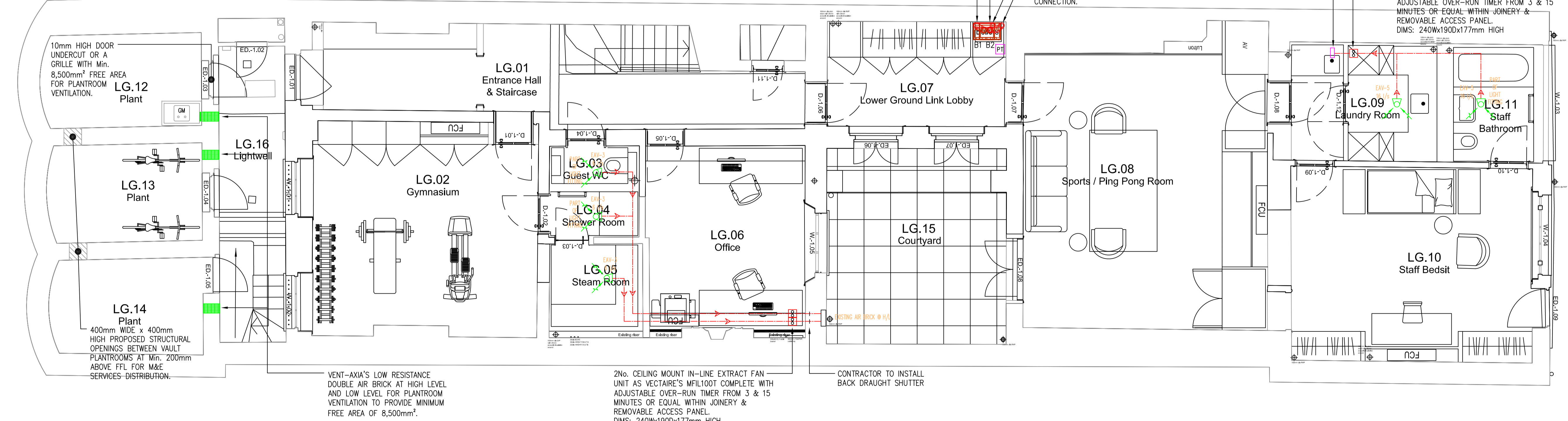

LOWER GROUND FLOOR PLAN
A.
P

Note
ALL DIMENSIONS TO BE VERIFIED ON SITE BEFORE SETTING OUT OR MAKING ANY SHOP DRAWINGS. THIS DRAWING IS TO BE READ IN CONJUNCTION WITH THE CONSULTANT ENGINEER'S SPECIFICATION.

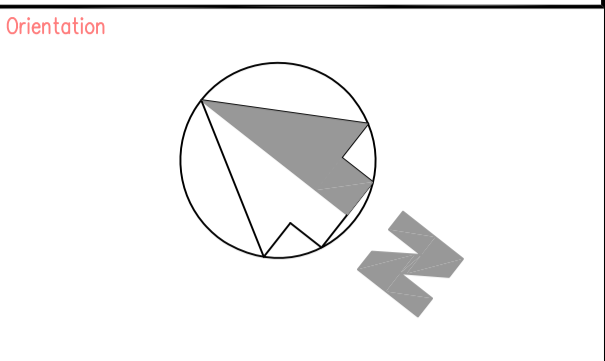

ref./date	REVISIONS
PT 23.12.20	PRE-TENDER ISSUE
PT1 03.02.21	PRE-TENDER ISSUE
T 22.02.21	TENDER ISSUE, GA'S UPDATED
T1 15.03.21	TENDER ISSUE, GA'S UPDATED

WORK STAGE 2



KUT LLP
First Floor
2E Berol House
25 Ashley Road
London
N17 9LJ
Tel: +44(0)20 8348 5171
Fax: +44(0)20 8340 8926
Email: tkp@kut.co.uk
Web: www.kut.co.uk

LOWER GROUND AND GROUND FLOOR MECHANICAL SERVICES VENTILATION

Project
55 CUMBERLAND TERRACE
CAMDEN, LONDON
NW1 4HJ

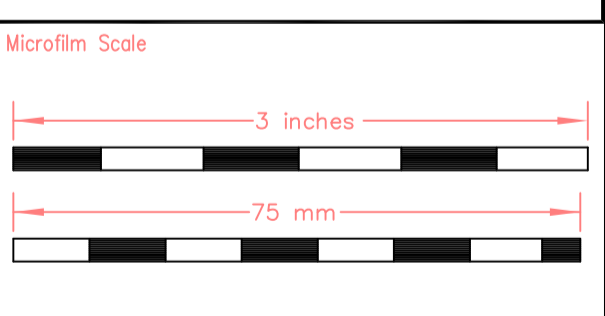

Architect
COLLETT-ZARZYCKI Ltd
Fernhead Studios, 2B
Fernhead Road, London W9 3ET
Tel: +44(0)20 8969 6967
email: mail@czltd.co.uk

Scale A1@1:50
Date Nov 2020
Issue TENDER

Project No.	Services	Dwg No.	Rev.
6618	M	WS2-112	T1

Lwr Grd & Grd