

**BWIC NOTE**  
 USE OF EXISTING NOTCHES AND JOISTS TO BE USED WHERE PRACTICAL. ANY NEW NOTCH AND HOLES WILL BE CARRIED OUT IN ACCORDANCE TO LISTED BUILDING REGULATIONS AND STRUCTURAL ENGINEER'S DETAILS

- NOTES**
- ALL GAS APPLIANCES TO BE PROVIDED WITH A GAS COCK.
  - INSTALLER TO INCLUDE FOR GAS SERVICE PIPEWORK RUNNING IN UNVENTILATED VOIDS TO BE IN GAS TRACPIPE AS SUPPLIED BY OMEGAFLEX LTD TEL 01295 6766 COMPLETE WITH OUTER SLEEVE PLASTIFLEX GF TO MEET GAS SAFE REQUIREMENTS.
  - GAS SAFE ENGINEER TO VERIFY & CHECK ALL PIPE SIZES AND INSTALLATION TO THEIR SATISFACTION PRIOR TO ANY WORKS CARRIED OUT TO ENSURE A GAS SAFE CERTIFICATE WILL BE ISSUED AT THE END OF THE PROJECT.
  - INSTALLER SHALL INCLUDE FOR ALL NECESSARY PIPEWORK FOR THE SHOWERS AND BATH ARRANGEMENTS IE. HAND SHOWERS BODY JETS, ETC.
  - ALL BASINS TO BE PROVIDED WITH FLOW REGULATOR (8 LPM) INCLUDING SINKS (12 LPM) ON THE H&C PIPEWORK.
  - ALL WATER SERVICE TO APPLIANCES, WASHING MACHINE, KITCHEN SINK, ETC. SHALL BE PROVIDED WITH ISOLATING BALLVALVE. ALL APPLIANCES AND WATERING POINTS SHALL BE PROVIDED WITH DOUBLE CHECK VALVE (DCV).
  - ALL ISOLATING VALVES TO BE LOCATED IN ACCESSIBLE LOCATIONS.
  - ALL EQUIPMENT SHALL BE COVERED AND PROTECTED FROM DUST & DEBRIS.
  - ALL PIPEWORK TO BE THERMALLY INSULATED AND SERVICES IDENTIFICATION LABELS TO BE PROVIDED TO ALL RUNS IN PLANT AREAS AND WITHIN BUILDING.
  - ALL SERVICES TO BE COORDINATED WITH THE COMFORT COOLING, PLUMBING, ELECTRICS, ETC.
  - ALL BATHS TO BE PROVIDED WITH HEATGAURD TMV2 THERMOSTATIC MIXING VALVE SET TO PROVIDE TEMPERATURE OF 48 DEG C TO BATHS. TMV AS SUPPLIED BY RELIANCE WATER CONTROLS LTD TEL:0800 389 5931 OR EQUAL.
  - ALL TOWEL RAILS TO BE AS SUPPLIED TO ARCHITECTS SPECIFICATION INCLUDE FOR ALL NECESSARY SUPPORTS AND CONNECTIONS.
  - INCLUDE CONDENSATE DRAIN FROM MVHR UNIT AND FAN COIL UNITS TO WASTE DRAINAGE SYSTEM VIA HEPVO DRY TRAP.
  - RV VALVES ON HWS RETURN SHALL BE ALWA-KOMBI 4 CIRCULATION THROTTLE VALVES AS SUPPLIED BY HONEYWELL OR EQUAL.

**Note**  
 ALL DIMENSIONS TO BE VERIFIED ON SITE BEFORE SETTING OUT OR MAKING ANY SHOP DRAWINGS. THIS DRAWING IS TO BE READ IN CONJUNCTION WITH THE CONSULTANT ENGINEER'S SPECIFICATION.

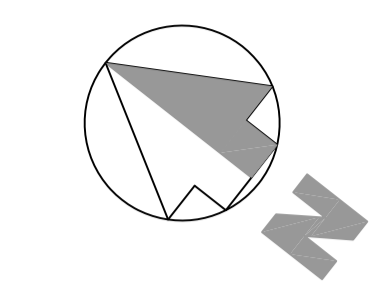

ref./date	REVISIONS
PT 23.12.20	PRE-TENDER ISSUE
PT1 03.02.21	PRE-TENDER ISSUE
T 22.02.21	TENDER ISSUE, GA's UPDATED
T1 15.03.21	TENDER ISSUE, GA's UPDATED

**WORK STAGE 2**

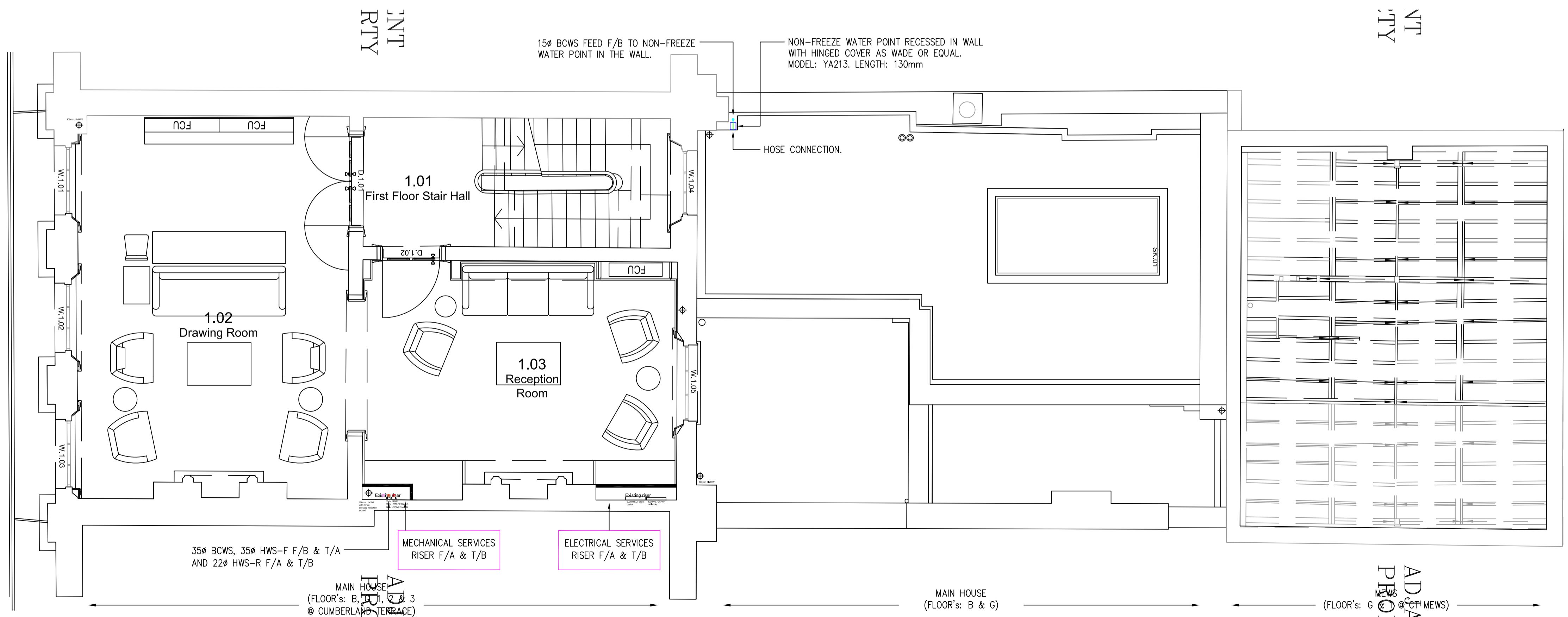
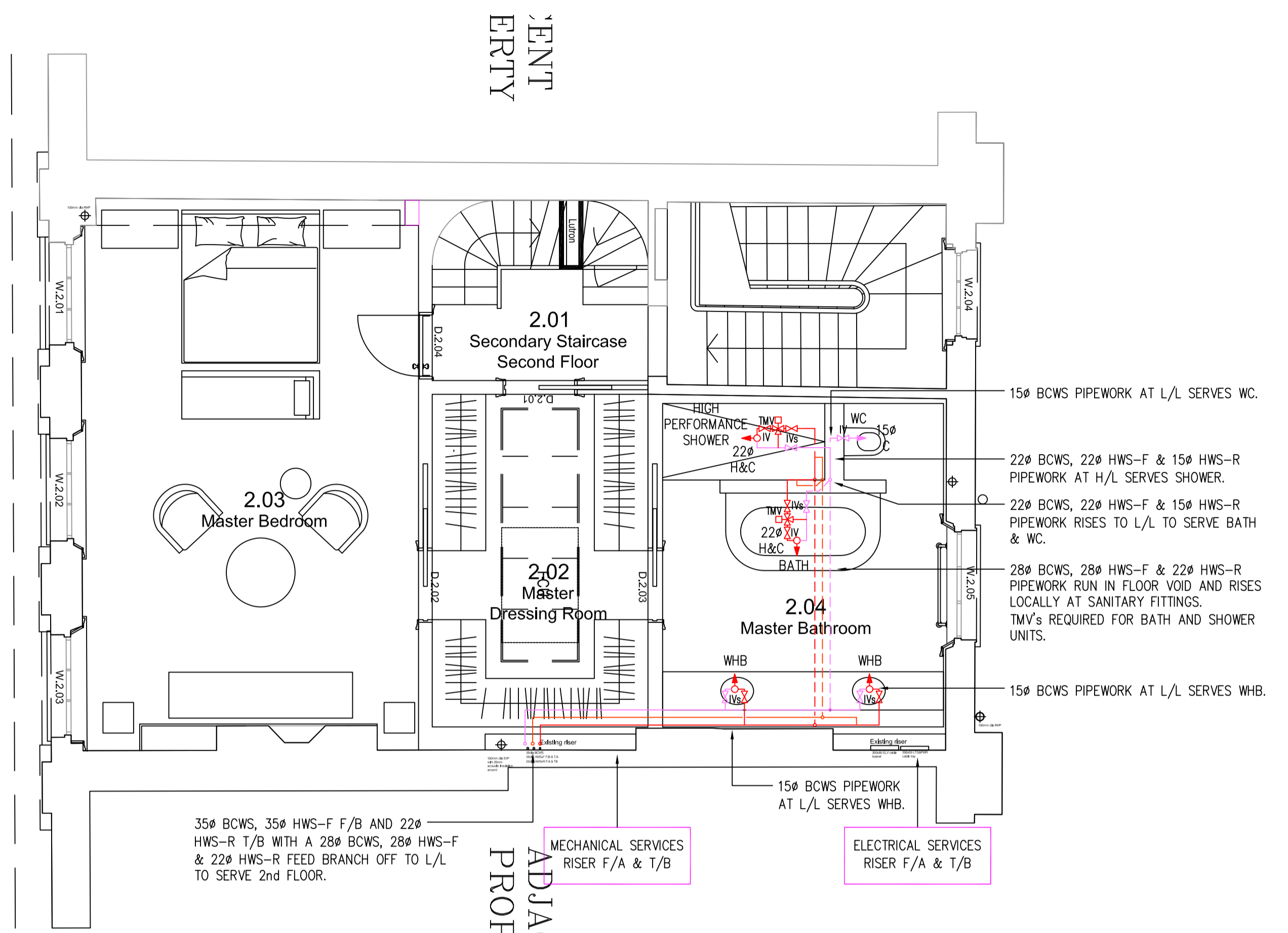

**KUT**

KUT LLP  
 First Floor  
 2E Berol House  
 25 Ashley Road  
 London  
 N17 9LJ  
 Tel: +44(0)20 8348 5171  
 Fax: +44(0)20 8340 8926  
 Email: tkp@kut.co.uk  
 Web: www.kut.co.uk

**FIRST & SECOND FLOOR MECHANICAL SERVICES DOMESTIC WATER SERVICES**

**Project**  
 55 CUMBERLAND TERRACE  
 CAMDEN, LONDON  
 NW1 4HJ

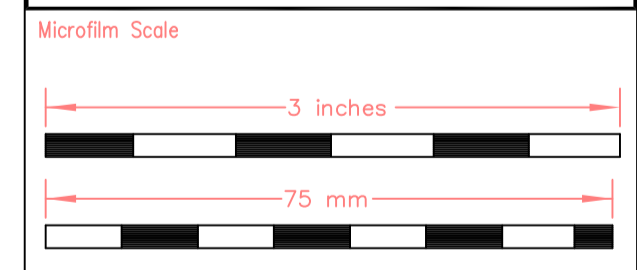

**Architect**  
 COLLETT-ZARZYCKI Ltd  
 Fernhead Studios, 2B  
 Fernhead Road, London W9 3ET  
 Tel: +44(0)20 8969 6967  
 Email: mail@czltd.co.uk

Scale	A1@1:50	Drawn	SAS
Date	Nov 2020	Checked	

**Issue**  
**TENDER**

Project No.	Services	Dwg No.	Rev.
6618	M	WS2-103	T1

**1st & 2nd**