

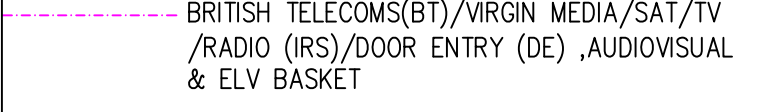

LEGEND	
	LV POWER & LIGHTING CABLE TRAY
	BRITISH TELECOMS(BT)/VIRGIN MEDIA/SAT/TV /RADIO (IRS)/DOOR ENTRY (DE) ,AUDIOVISUAL & ELV BASKET
	DISTRIBUTION BOARD

BWIC NOTE
 USE OF EXISTING NOTCHES AND JOISTS TO BE USED WHERE PRACTICAL. ANY NEW NOTCH AND HOLES WILL BE CARRIED OUT IN ACCORDANCE TO LISTED BUILDING REGULATIONS AND STRUCTURAL ENGINEER'S DETAILS

- NOTES**
- THIS DRAWING SHALL BE RED IN CONJUNCTION WITH THE ARCHITECT, INTERIOR DESIGNER, STRUCTURAL ENGINEER'S, MECHANICAL AND PUBLIC HEALTH DRAWINGS
 - ENTIRE CABLE MANAGEMENT SYSTEM SHALL BE METAL WITH METAL SUPPORTS/FIXINGS IN ACCORDANCE WITH BS7671 AM3, UNLESS SPECIFIED OTHERWISE.
 - MAINTAIN MIN. 150mm SEGREGATION BETWEEN MAINS POWER AND ELV (NON-MAINS POWER) CABLING IN PARALLEL RUNS.
 - CONTAINMENT INSTALLATION SHALL BE COORDINATED WITH MECHANICAL AND PUBLIC HEALTH SERVICES ROUTED WITHIN THE BUILDING INCLUDING CORRIDOR AND RISERS.
 - REFER TO UKPN DRAWING NUMBER EDS 08-0123-15 FOR SERVICE TERMINATION AND METERING ARRANGEMENT FOR UP TO 400AMPS CUT-OUT AT BASEMENT LEVEL ENTRY.
 - THE VIRGIN MEDIA INTAKE POSITION IS INDICATIVE ONLY. FINAL LOCATION TO BE AGREED ON SITE

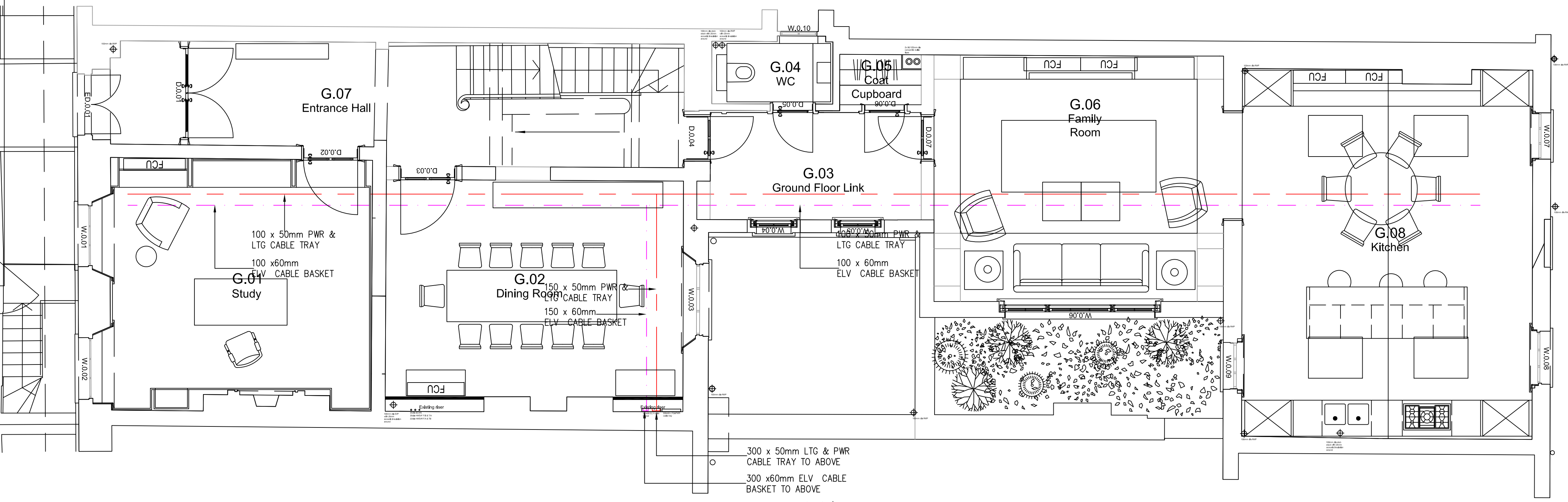

AD PR
 GROUND FLOOR PLAN

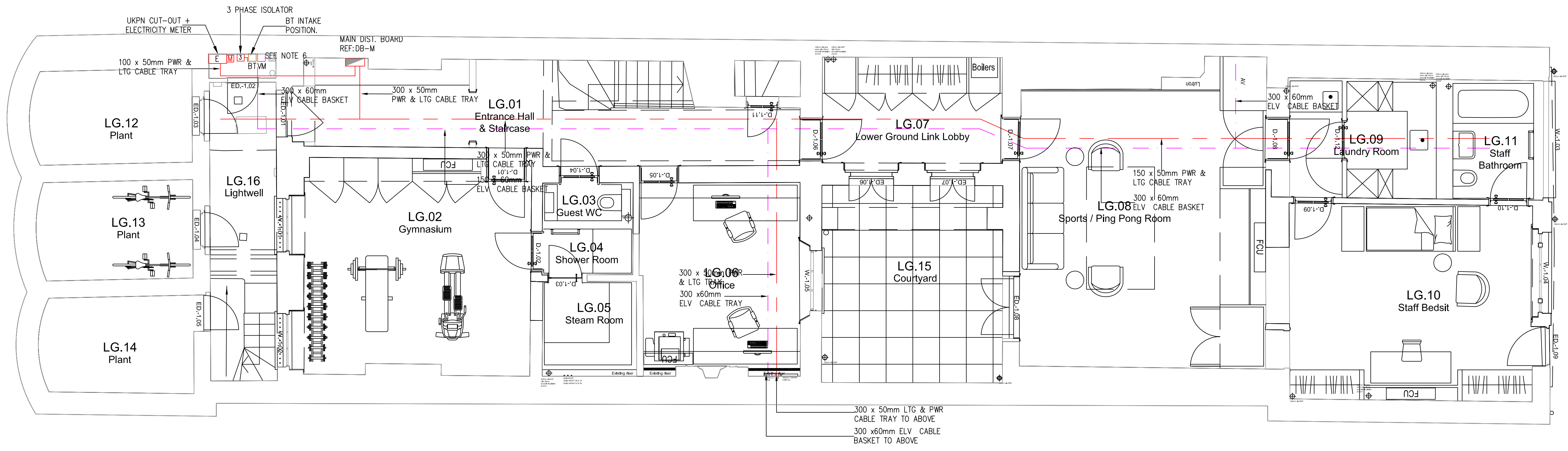

LOWER GROUND FLOOR PLAN

Note
 ALL DIMENSIONS TO BE VERIFIED ON SITE BEFORE SETTING OUT OR MAKING ANY SHOP DRAWINGS. THIS DRAWING IS TO BE READ IN CONJUNCTION WITH THE CONSULTANT ENGINEER'S SPECIFICATION.

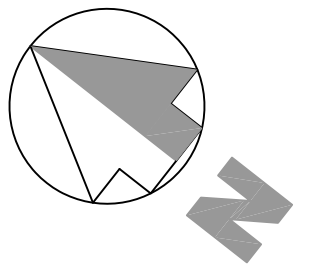

ref./date	REVISIONS
PT 23.12.20	WORK STAGE 2 - PRE-TENDER
PT 29.01.21	WORK STAGE 2 - PRE-TENDER
T 22.02.21	TENDER ISSUE
T1 15.03.21	TENDER ISSUE, GA'S UPDATED

WORK STAGE 2

KUT
 KUT LLP
 First Floor
 25 Berol House
 25 Ashley Road
 London
 N17 9LJ
 Tel: +44(0)20 8348 5171
 fax: +44(0)20 8340 8926
 email: tkp@kut.co.uk
 web: www.kut.co.uk

LOWER GROUND AND GROUND FLOOR ELECTRICAL SERVICES CONTAINMENT LAYOUT

Project
 55 CUMBERLAND TERRACE
 CAMDEN, LONDON
 NW1 4HJ

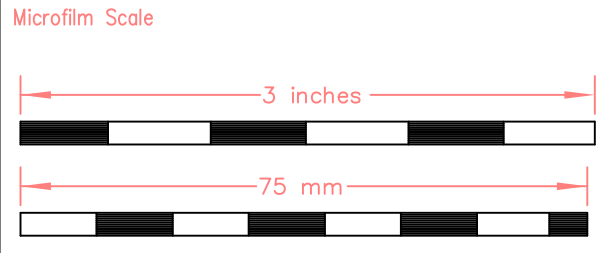

Architect
 COLLETT-ZARZYCKI Ltd
 Fernhead Studios, 2B
 Fernhead Road, London W9 3ET
 Tel: +44(0)20 8969 6967
 email: mail@czltd.co.uk

ref	Scale	Drawn	AL
55CT - GA (21-03-03)	A1@1:50	Drawn	AL

Issue
 TENDER

Project No.	Services	Dwg No.	Rev.
6618	E	WS2-109	T1

Lower Ground & Ground