

EXISTING SIDE (SOUTH) ELEVATION
1.100

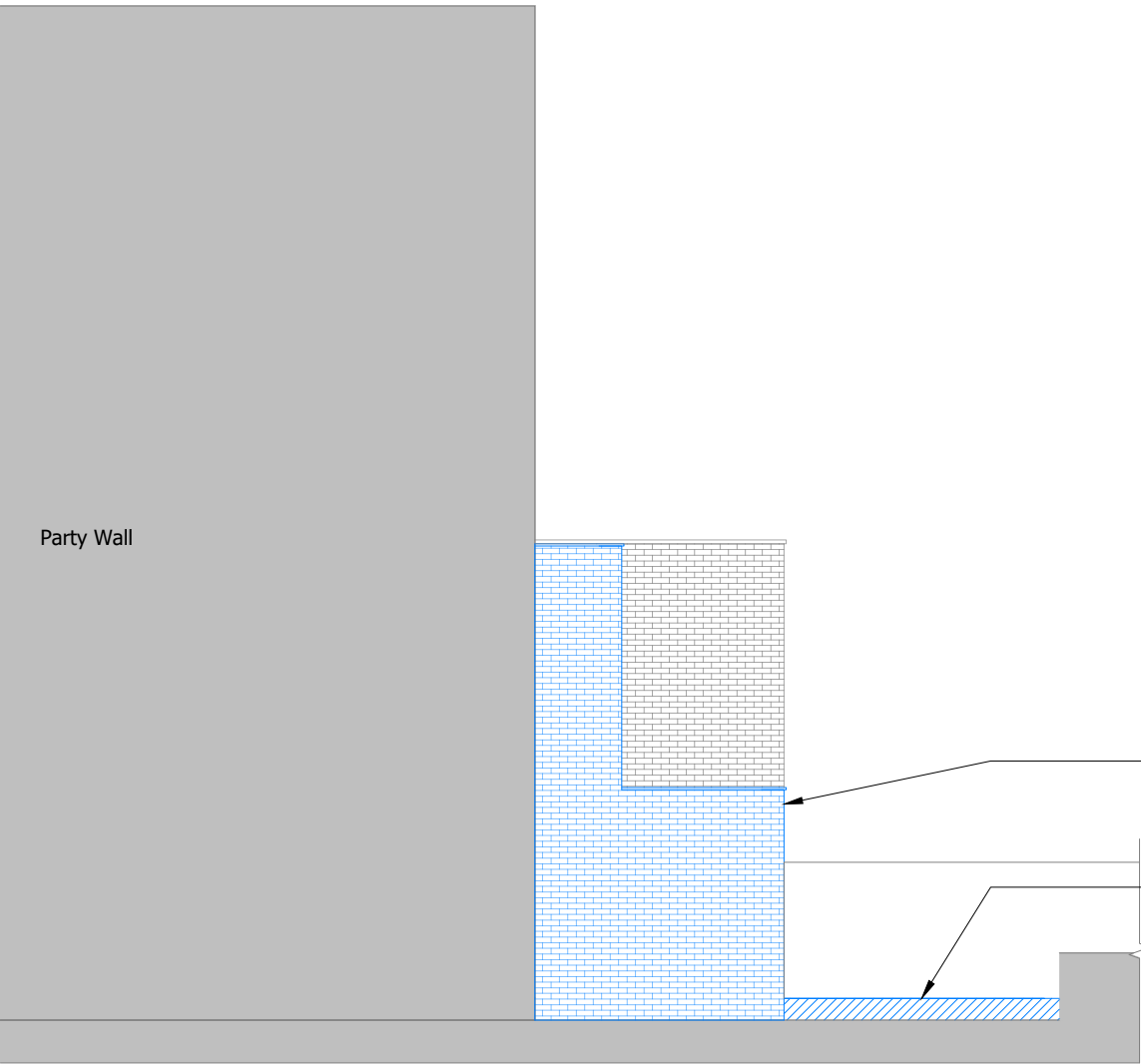

PROPOSED SIDE (SOUTH) ELEVATION
1.100

These plans have been drawn for the purpose of planning permission and lawful consents.

All drawings to be signed off by building control before the commencement of any works.

Any measurments required for construction must not be scaled from this drawing but taken on site.

All structural elements to be signed off by structural engineer and agreed with Building Control prior to the commencement of works.

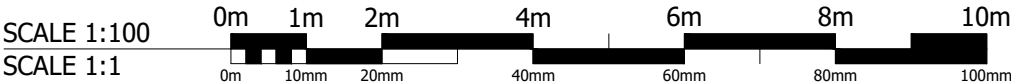

Status		
PLANNING		
Project		
60b Fitzjohns Avenue		
Drawing		
Side (South) Elevations		
Job Number	Drawing Number	Drawing Revision
A19-213	PRE003	-
Date	Scale @ A3	Drawn
03.03.21	1.100	-