

© This drawing is the property of Miltiadou Cook Mitzman architects. No disclosure or copy of it may be made without the written permission of Miltiadou Cook Mitzman architects.

- For construction purposes:**
- Do not scale this drawing.
 - All dimensions and levels to be checked on site.
 - Discrepancies to be reported to Miltiadou Cook Mitzman architects before proceeding.
 - If in any doubt about information on this drawing contact Miltiadou Cook Mitzman architects.

REVISION NUMBER	DATE	BY	NOTES
P1	14/02/2020	OR	Issued to Planning

P2	15/06/2020		
P3	16/12/2020		

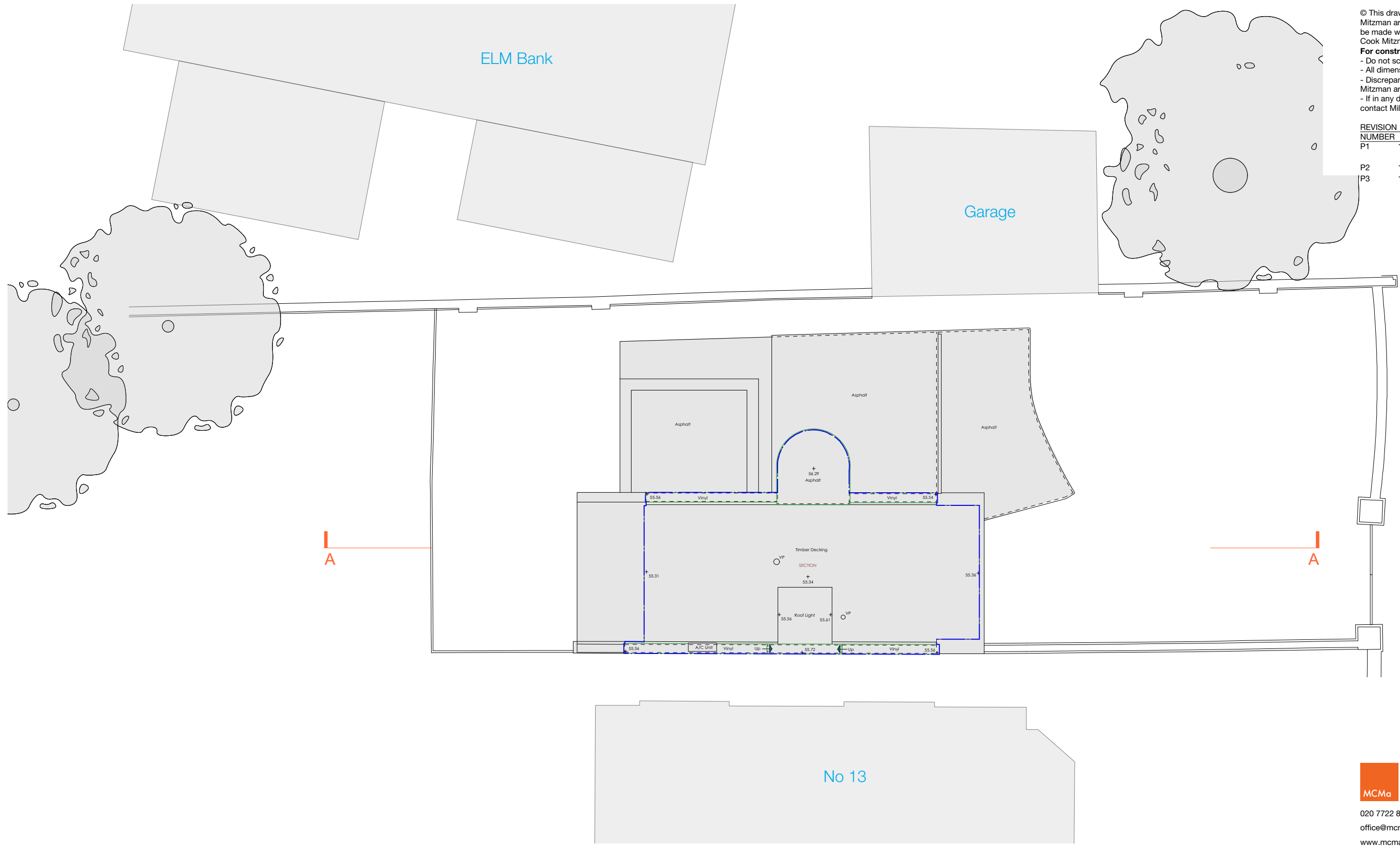

1 Proposed Roof Plan
1:100

- Approved under Application ref: 2020/0746/P
- Root Protection Area
- Outline of existing property (Ground level)

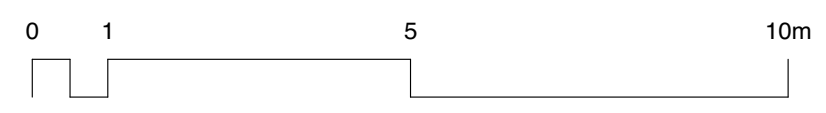

MILTIADOU COOK MITZMAN architects llp
MCMa

020 7722 8525 office@mcma.design www.mcma.design
Unit 1 Primrose Mews Sharpleshall Street London NW1 8YW

CLIENT
Carmel & Emanuel Mond

PROJECT
15 Lyndhurst Terrace, London NW3 5QA

SHEET TITLE
Proposed Roof Plan

SCALE
1:100

DATE CREATED 16/12/2020 **FILE REFERENCE** 297-A-P-Bldg

DRAWING NUMBER	REVISION
246-DWG-103	P3