

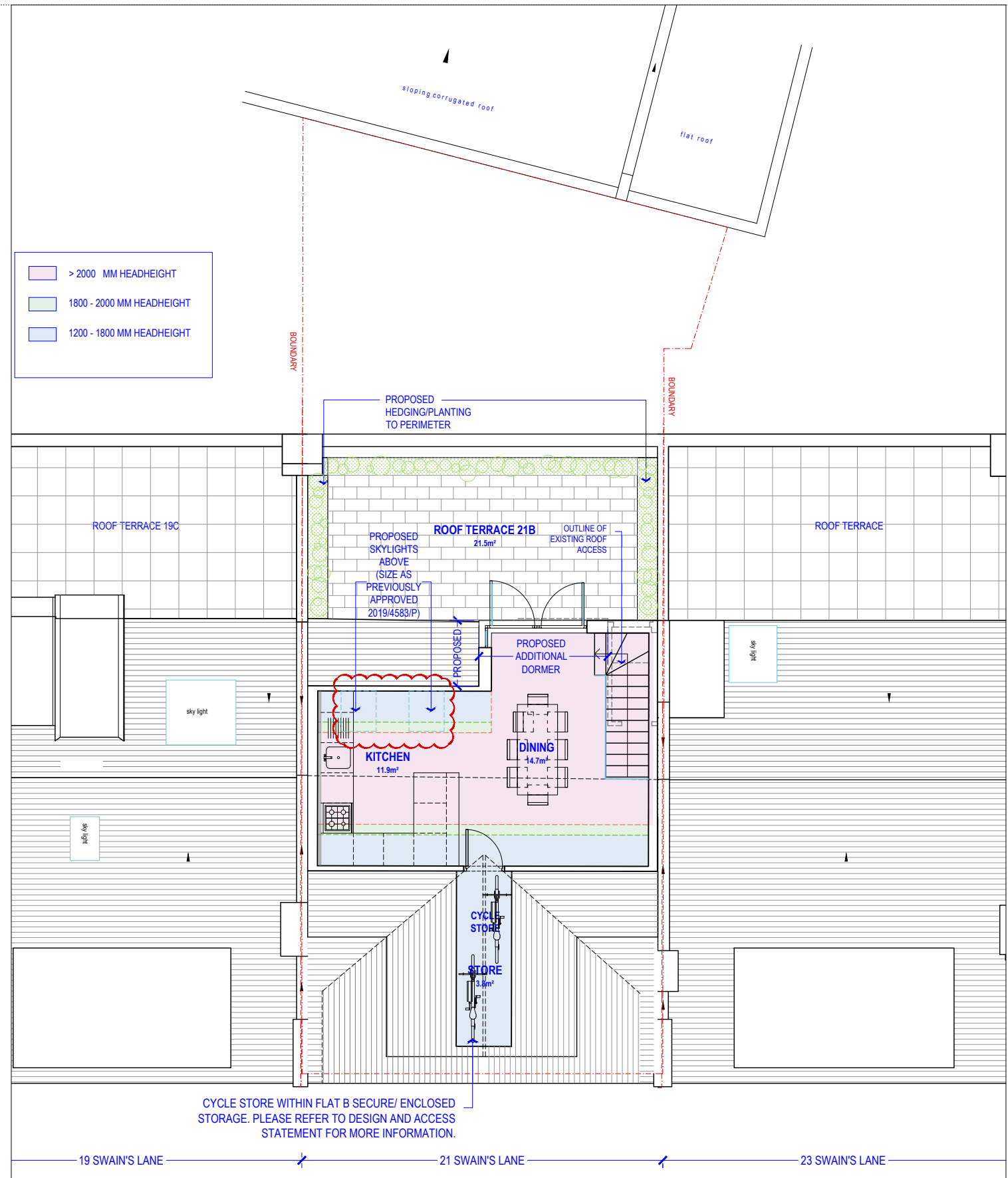

[01] PROPOSED SECOND FLOOR PLAN

@1:100



[02] PROPOSED THIRD FLOOR/LOFT PLAN

@1:100

NOTE:  
DO NOT SCALE FROM DRAWINGS - EXCEPT FOR PLANNING PURPOSES.  
ALL DISCREPANCIES TO BE REPORTED TO ARCHITECT IMMEDIATELY.  
ALL DIMENSIONS TO BE VERIFIED BY CONTRACTOR ON SITE PRIOR TO THE COMMENCEMENT OF ANY WORKS.

- P1 26/10/20 Planning Application Issue
- P2 23/02/21 Dormer width reduced; skylights amended
- P3 04/03/21 Dormer width reduced further to 50% of sloping roof width

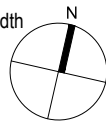

**VIVENDI ARCHITECTS LTD**

Unit E3U, Bounds Green Industrial Estate, Ringway, London N11 2UD  
Tel/Fax +44 (0)20 3232 4000 - email: info@vivendiarchitects.com

© VIVENDI ARCHITECTS LTD 2009  
All rights reserved. including but not limited to The Copyright, Designs and Patents Act 1988

PROJECT TITLE:  
21B Swain's Lane, London N6 6QX

DRAWING TITLE:  
Proposed Second & Third Floor/Loft Plans

CLIENT:  
LXE Investments Ltd.

DRAWN:  
SM / AW

CHECKED:  
GK

ISSUED BY:  
GK

JOB AND DRAWING NO:

STATUS:  
PLA

SCALE AT A3:  
1:100

REVISION:  
P3

1803-P02-00