

10mm CLEAR TOUGHENED - PAR / 16mm BLACK ARGON CAVITY / 6mm CLEAR TOUGHENED LOW-E - PAR

POLYESTER POWDER COATED JET BLACK RAL 9005 (MATT)

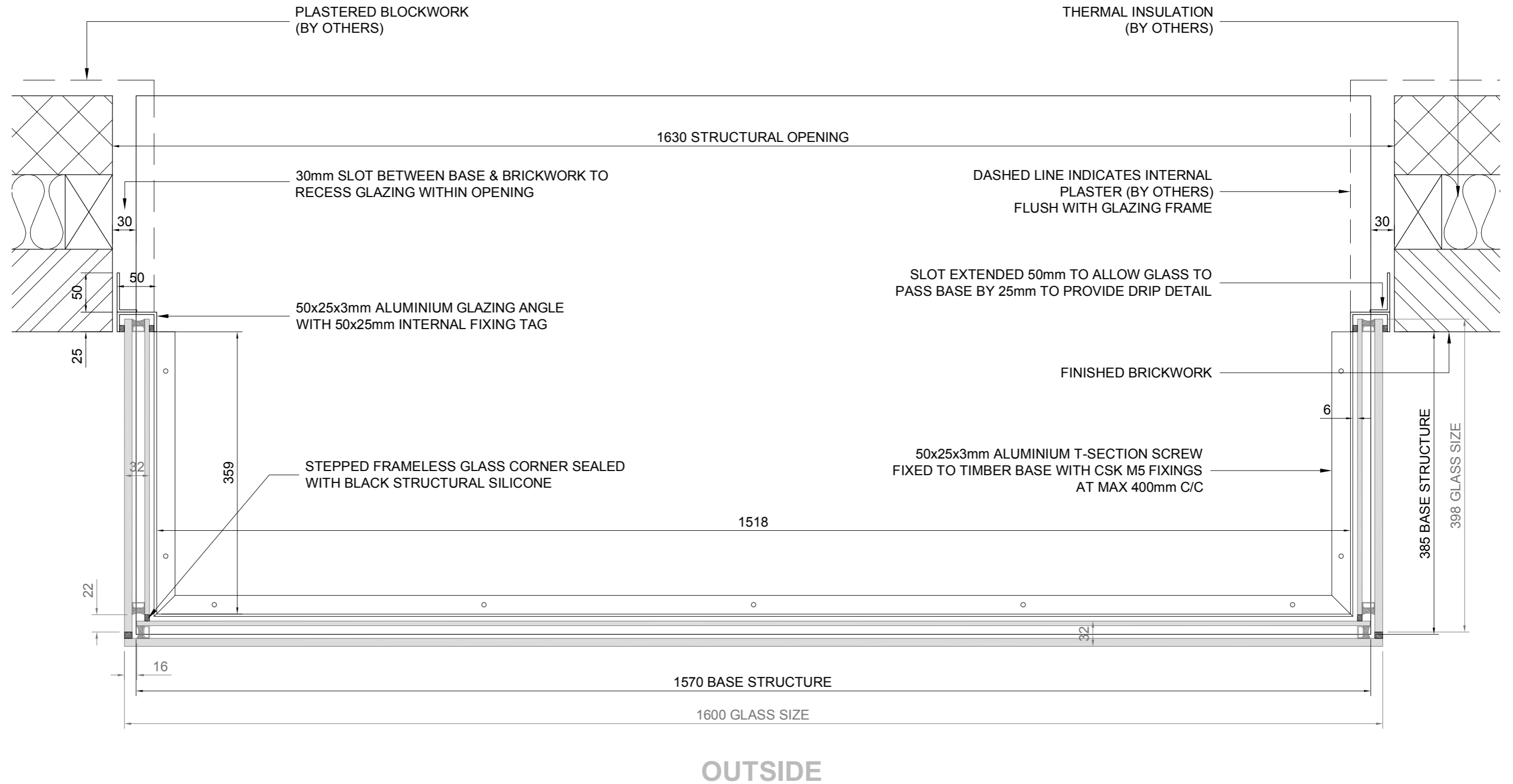

**MAXLIGHT**

Unit 1, Victoria Industrial Estate  
Victoria Road W3 6UU  
T: 020 8896 0700  
www.maxlight.co.uk



Revision / Date / Comments		
0	14.12.2016	FIRST ISSUE

Project	
	ADDRESS, POSTCODE
	TYPICAL DETAILS

Title	Oriel Bay Window Plan
-------	-----------------------

Drawn by	Danny Furr	Scale	1:5 @ A3
Survey by	Insert Name	Project ref.	SD51
Site contact			02