

Rev	Date	By	Description
A	24/11/2020	AZ	Parking spaces added;
B	27/11/2020	AZ	Parking spaces arrangement amended; pedestrians walkways added;
C	02/12/2020	AZ	Graphic amendments; van car parking arrangement changed;
D	07/12/2020	AZ	Ground Floor arrangement amended following comments form Client;
E	07/12/2020	AZ	Label amended;
F	04/02/2021	AZ	Cycle positions amended;
G	03/03/2021	AZ	Door 1,2 and 3 extended; column removed follow email instruction from SEGRO 17/02/21;

Pedestrians Walkway

Red broken line indicates existing partitions removed and made good.

Floor removed to accommodate reconfigured stair

up

PROPOSED FIRST FLOOR PLAN  
Scale 1:100 @A1

34.85 ramp up to 35.16 at an angle of 1 degree

Column removed subject to SE input

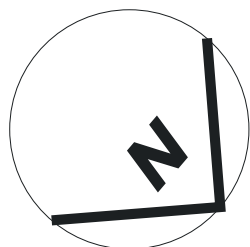

**SEGRO**  
**SGP**

Architects + Masterplanners

Waterfront House  
2a Smith Way  
Grove Park  
Enderby  
Leicester LE19 1SX

t: +44 (0)116 247 0557

[www.stephengeorge.co.uk](http://www.stephengeorge.co.uk)

Refurbishment  
3-6 Spring Place  
Kentish Town

Drawing Name:  
Proposed Floor Plan

Drawing Stage: PLANNING

Suitability: S2 - Information

SGP File Ref: 19-275

19-275 30/09/2020 AZ JN 1:100 @ A1 G

SGP Project No. Date Drawn Team Scale Rev

Drawing Number:

19-275 -SGP-XX-00-DR-A-131100

Project Code Originator Volume Level Type Role Number

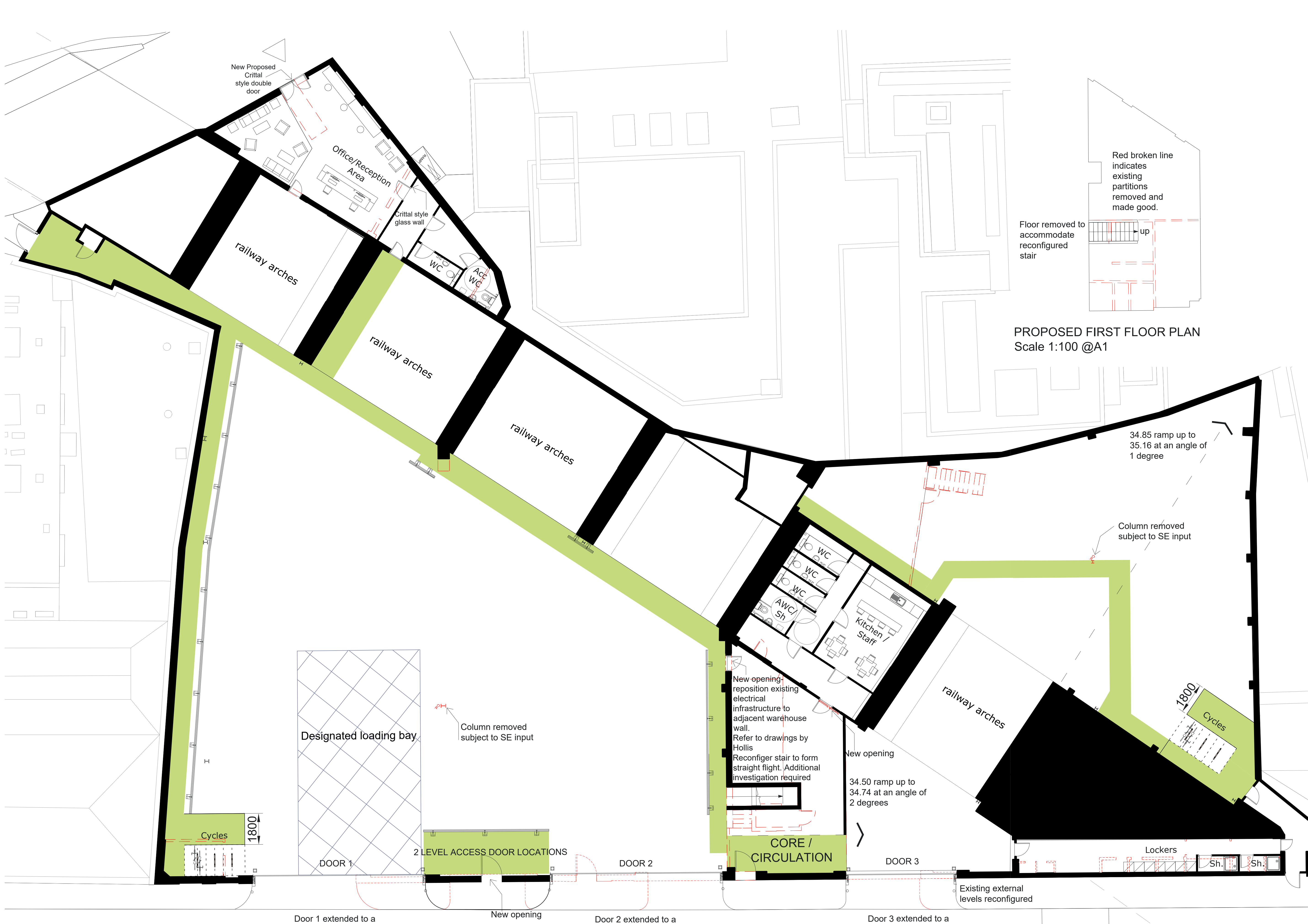

PROPOSED GROUND FLOOR PLAN  
Scale 1:100 @A1

Door 1 extended to a  
Max. width of 10m

New opening  
Existing loading door and  
windows removed and  
blocked up

Door 2 extended to a  
Max. width of 10m

Door 3 extended to a  
Max. width of 6.4m

# SPRING PLACE

Red Line Boundary based on O/S Data and NOT confirmed as the Legal Boundary

This drawing, the works and concepts depicted are copyright of Stephen George + Partners LLP and may not be reproduced or made use of, either directly or indirectly without express written consent. Do not scale off this drawing. All heights, levels, sizes and dimentions to be checked on site before any work is put to hand.