

Scale 1:100 at A3

0 1 2 3 4 5 6 7 8 9 10 m

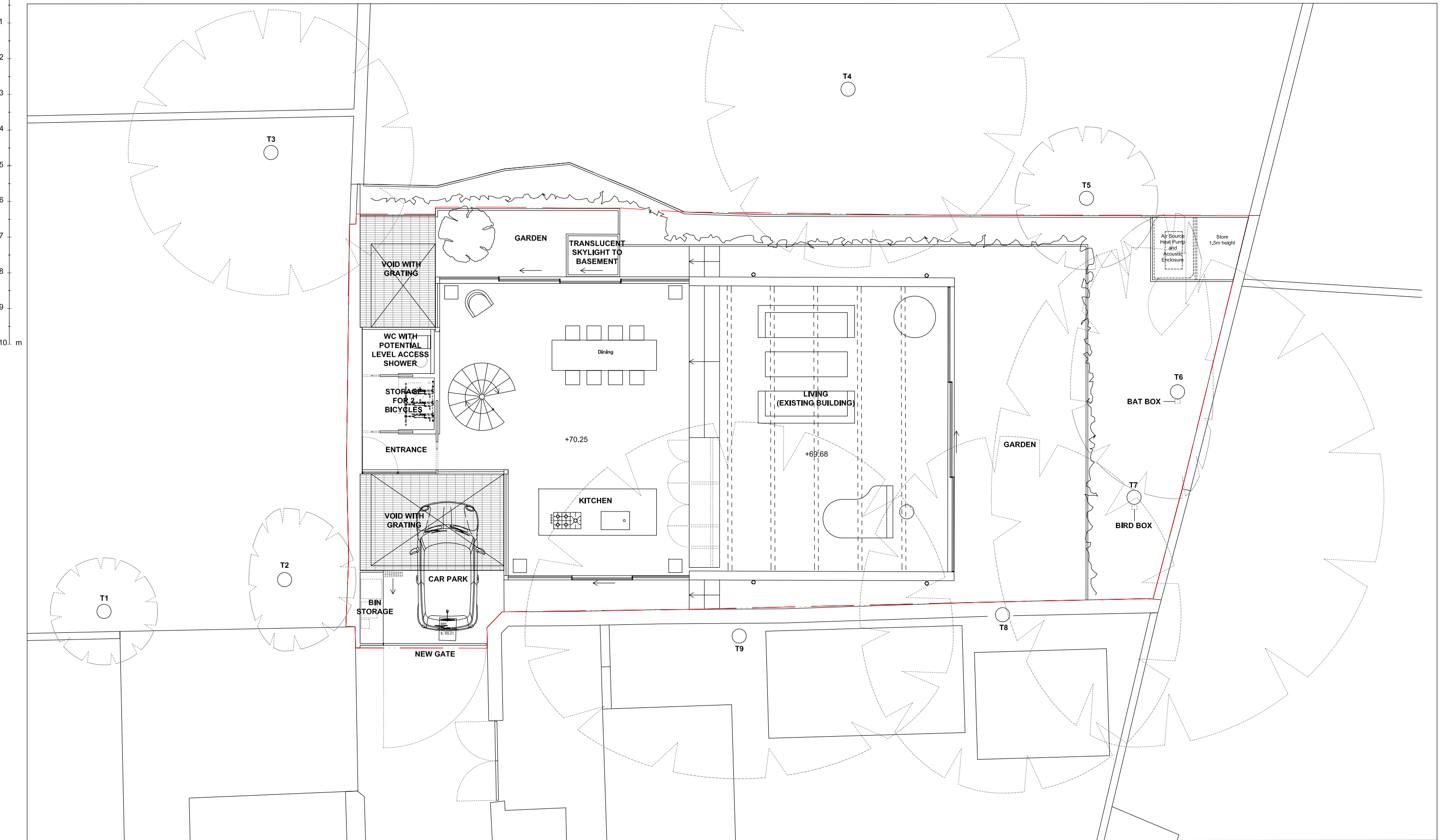

01 Proposed - Ground Floor Plan
1:100 @ A3 / 1:50 @ A1

Revision	Date	Comments	Drawing Title	Project	Scale	Drawing Number	Revision
P01	29.11.2016	Minor changes on details	Proposed - Ground Floor Plan	201	1:50 @ A1 1:100 @ A3	PLANNING	P08
P02	27.01.2017	Minor changes according to piling position					
P03	24.02.2017	Minor changes to add PV panels					
P04	01.08.2018	Boundary line updated, skylight and lightwell reduced in size.	Client SPENCER BAYLIN	Date 29.11.2016	Drawn By SA	201 202	Gianni Botsford Architects
P05	21.11.2019	South Wall updated to glazing, skylight and lightwell size increased, internal layout revised					
P06	05.12.2019	Air Source Heat Pump + Acoustic Enclosure added					
P07	18.02.2020	ASHP Enclosure Design Development - resubmitted to Planning in connection with amendment Ref.2019/6095/P					
P08	17.03.2021	ASHP Enclosure Design Development - Issued as part of S73 Application					
<p>This drawing is copyright. This drawing is the property of Gianni Botsford Architects Ltd. It may not be copied or disclosed to any third party without the permission of Gianni Botsford Architects Ltd.</p> <p>The contractor shall submit full-size setting out drawings based on information provided in the drawings and specifications to the architect for comment without which manufacture shall not commence.</p>			Project 13A Pond Street, London, NW3 2PN		<p>2nd Floor South 65, Judds Road London W12 9ED T +44 (0)20 7434 2277 info@giannibotsford.com</p>		