

CEILING OF EN-SUITE SHOWER ROOM TO BE SET 400MM DOWN FROM CEILING OF MAIN BATHROOM AND TO BE FINISHED IN PAINTED WATERPROOF PLYWOOD

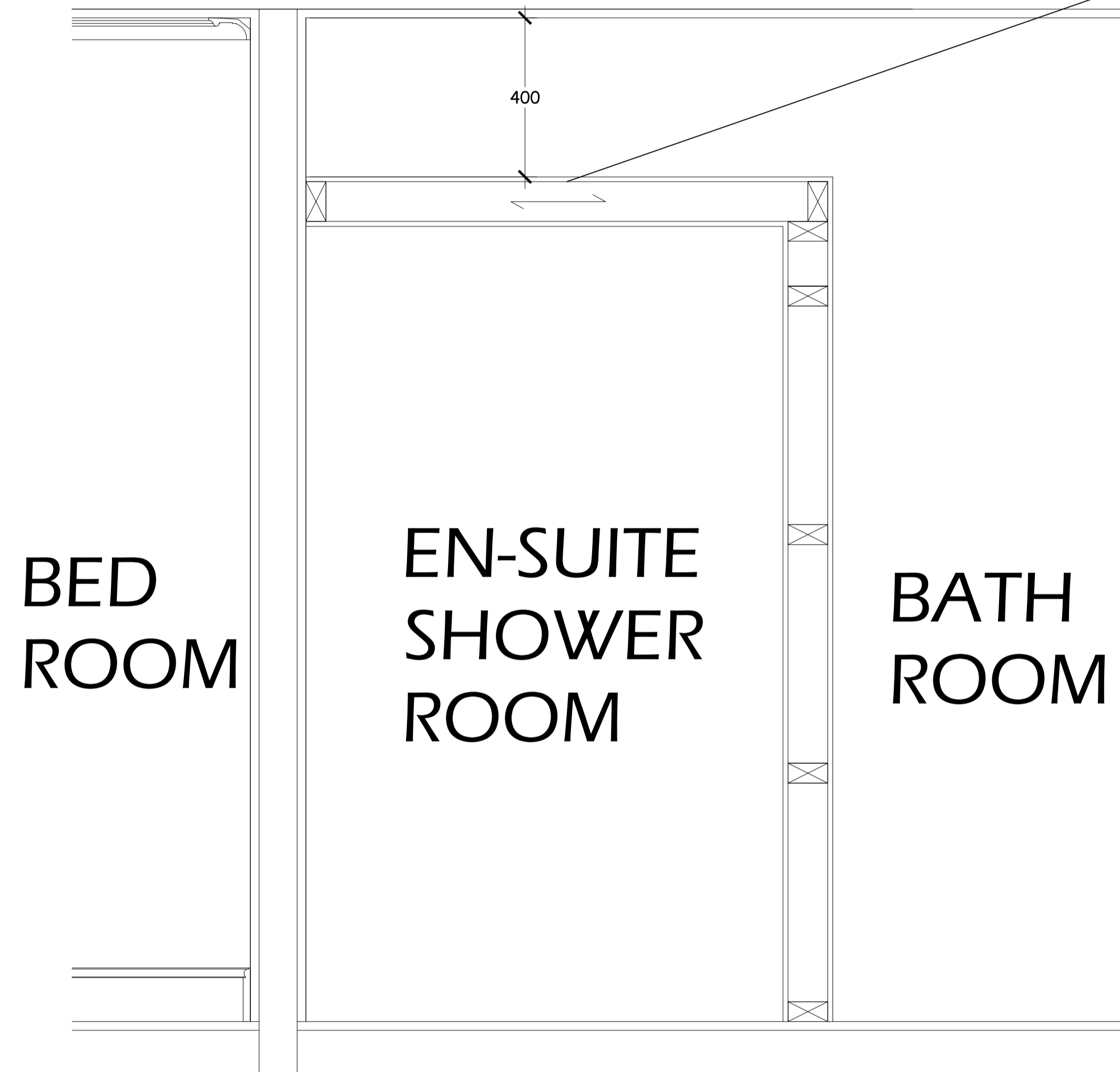

SECTION DETAIL
1:10 SCALE

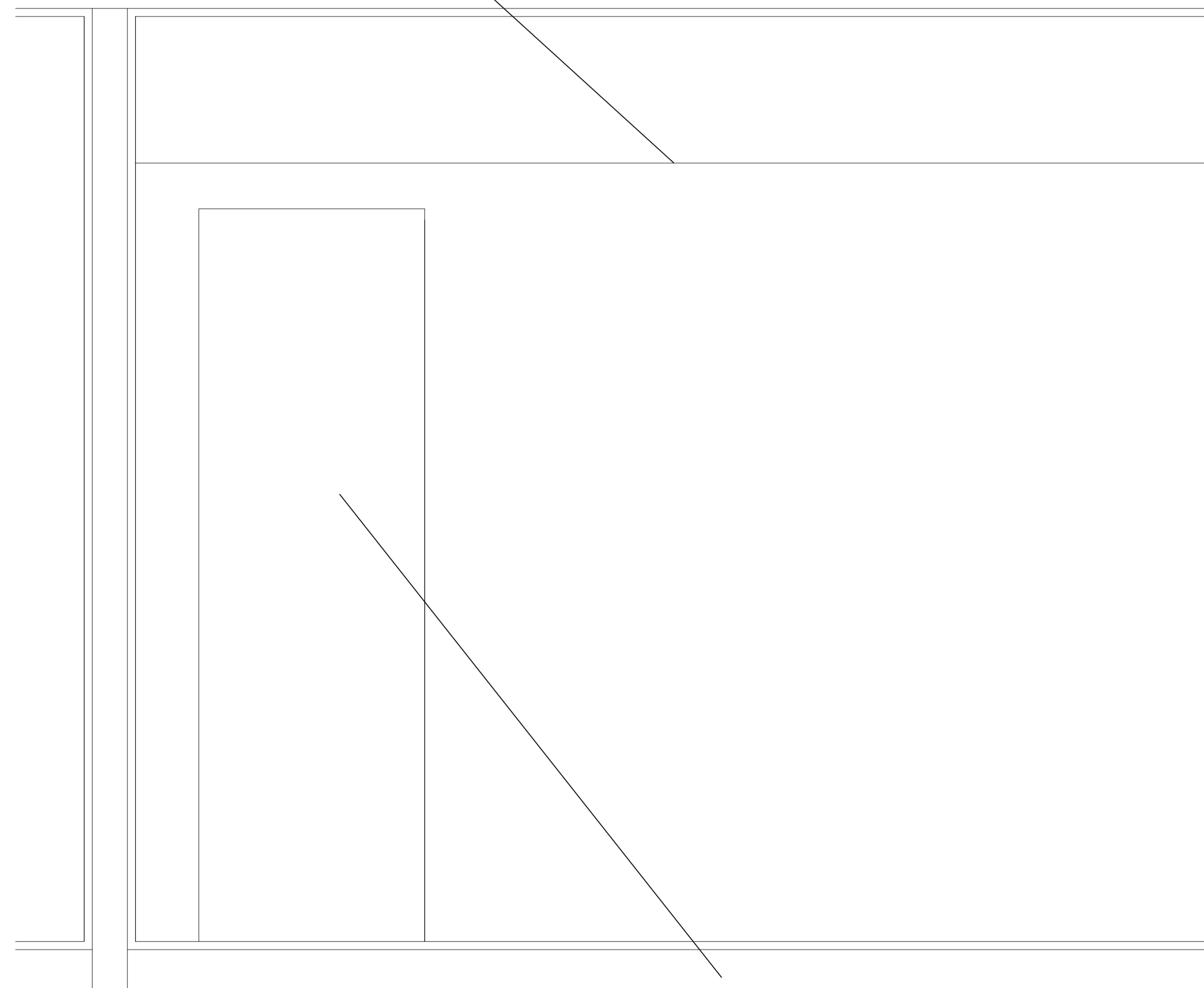

ELEVATION DETAIL FROM BATHROOM
1:10 SCALE

SMILEY JIM LIMITED
5 UNDERWOOD RISE
TUNBRIDGE WELLS
KENT TN2 5RY

| REVISION | ITEM | DATE |
|----------|------|------|
| | | |
| | | |
| | | |
| | | |
| | | |
| | | |

Client
MUNESH MAHTANI

Site Address
33 GOLDINGTON ST
LONDON NW1 1UE

Drawing Title
DETAILS EN-SUITE
BATHROOM

| | |
|--------------------|------------------------------------|
| Date 06/03/2021 | Scale 1:10 @ A1 |
| Paul | Checked by/Checked on: 06/03/21 |

| | |
|------------|----------------|
| Job Number | Drawing Number |
| | MP 12 |

HINGED RENDERED FLUSH
PANEL SET IN
FINELINE METAL FRAME
PAINTED WHITE TO MATCH
RENDER COLOUR

DOUBLE GLAZED UNIT SET IN
FINELINE METAL FRAME

INTERNAL TIMBER LINING WITH
HINGED PANEL PAINTED SAME
COLOUR AS WALLS TO GIVE
CONTINUOUS SURFACE
APPEARANCE

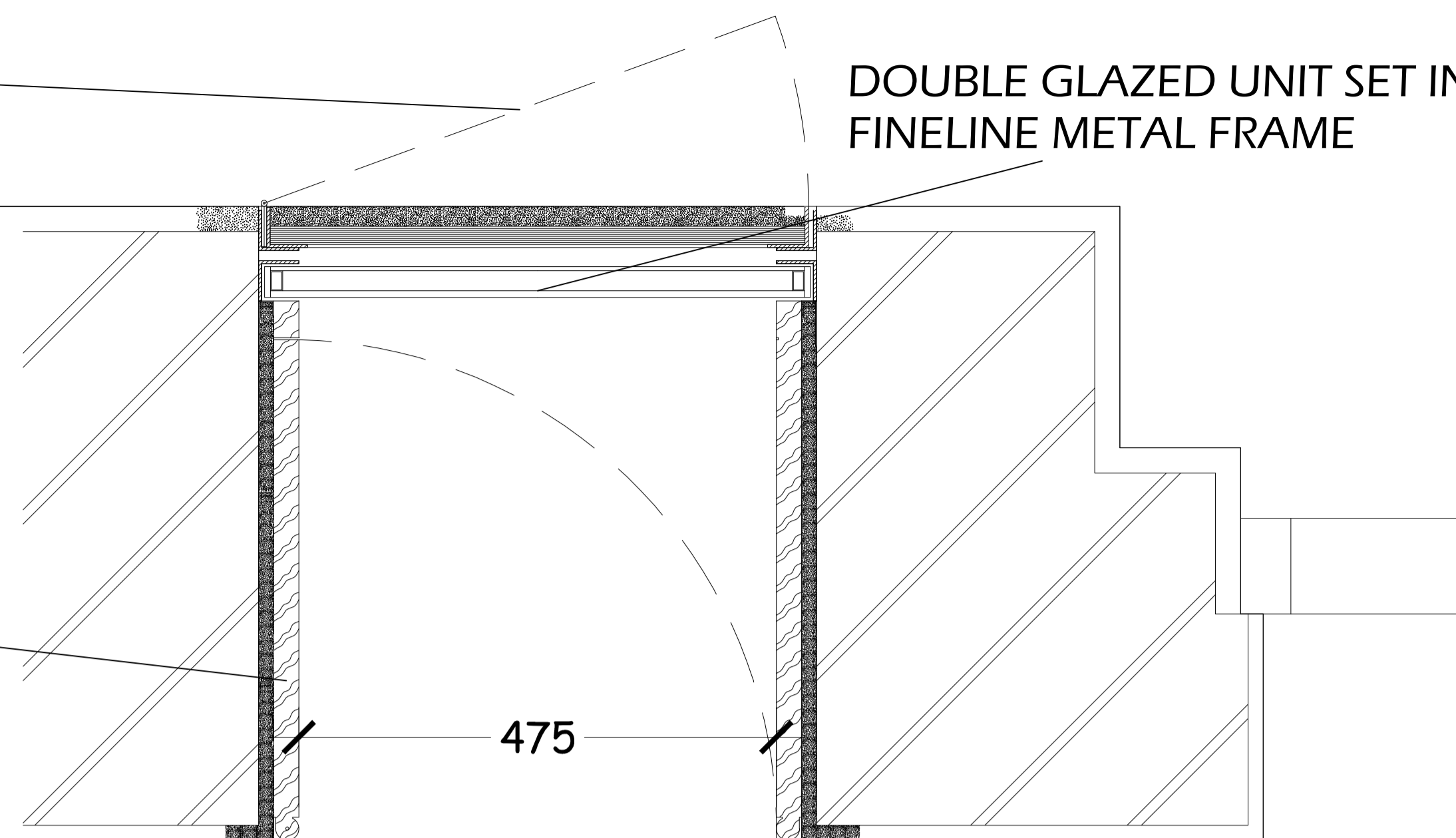

PLAN DETAIL 1:5 SCALE

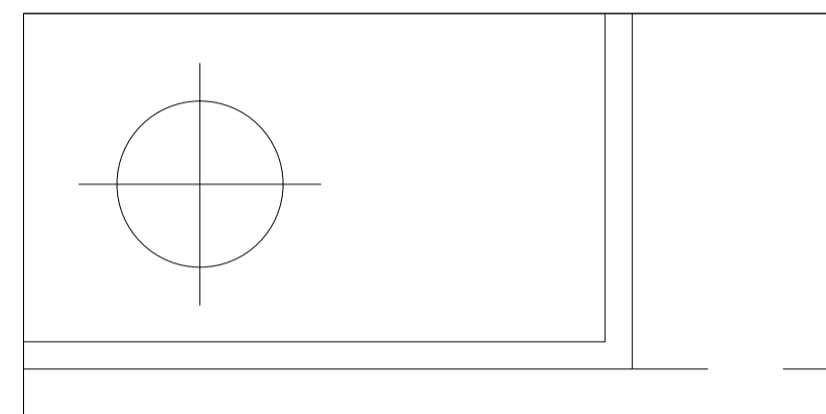

INTERNAL ELEVATION 1:10 SCALE

EXTERNAL ELEVATION 1:10 SCALE

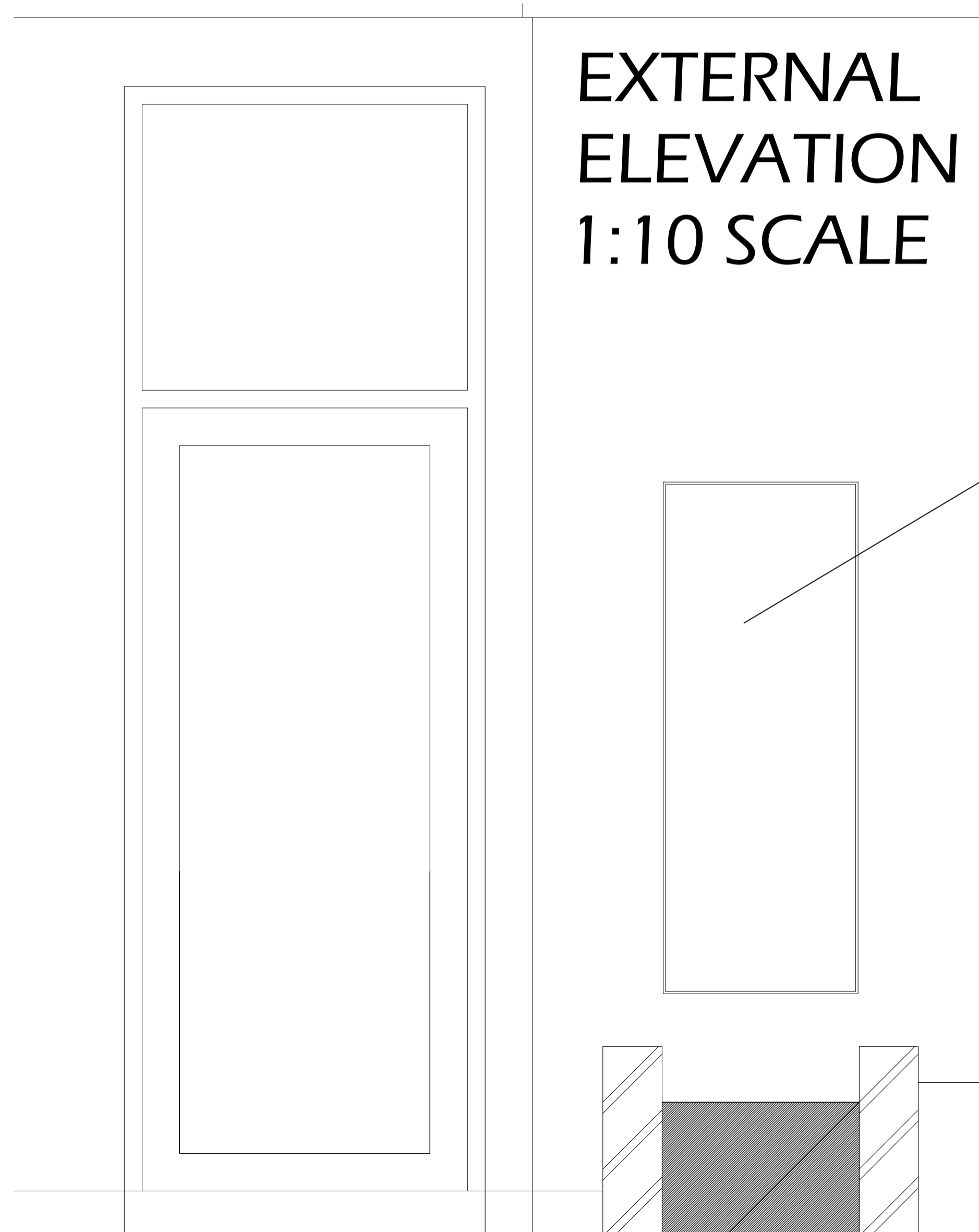

HINGED RENDERED
FLUSH PANEL SET IN
FINELINE METAL FRAME
PAINTED WHITE TO
MATCH RENDER
COLOUR

INTERNAL TIMBER LINING
WITH HINGED PANEL
PAINTED SAME COLOUR
AS WALLS TO GIVE
CONTINUOUS SURFACE
APPEARANCE

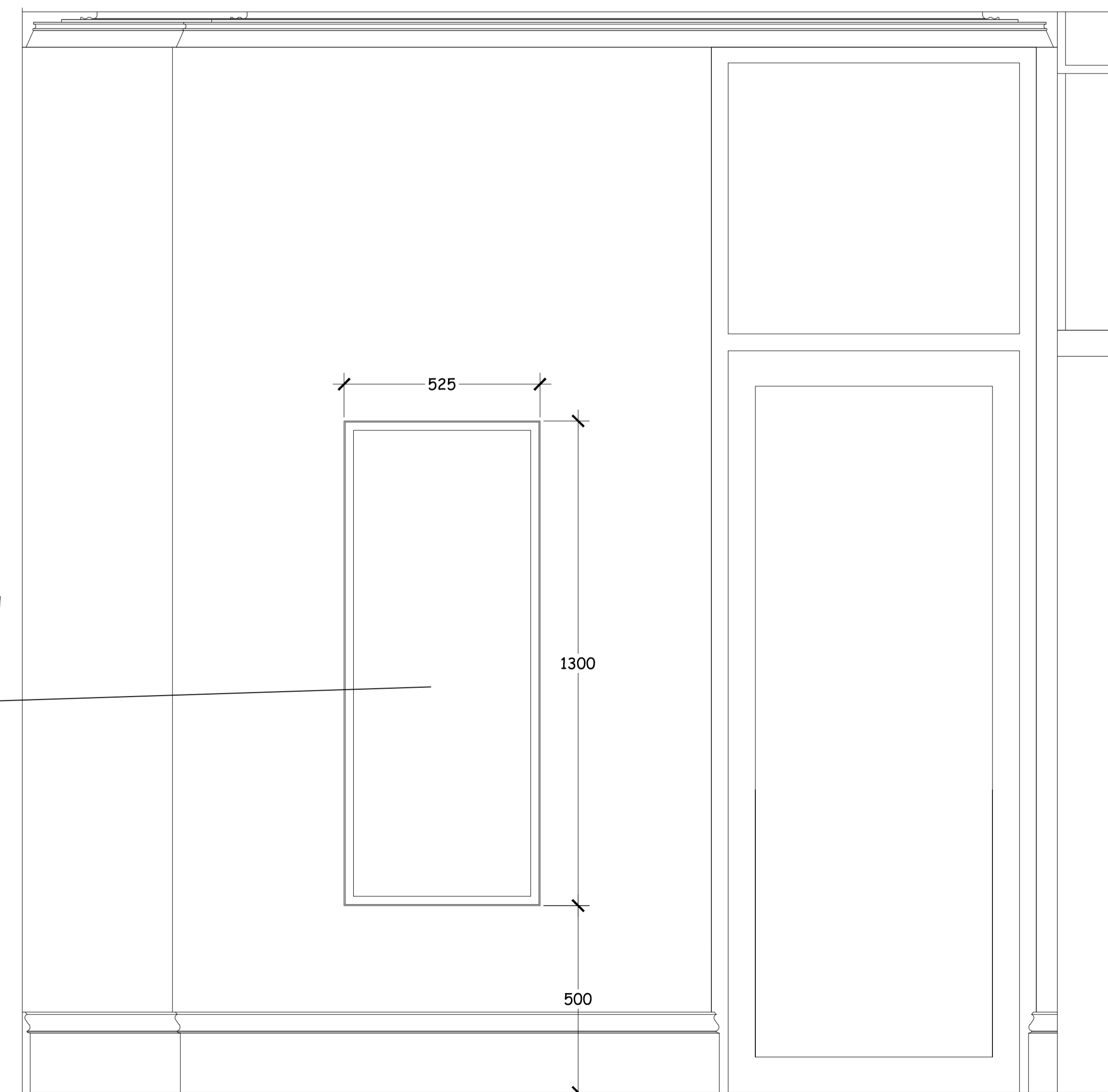

SMILEY JIM LIMITED
5 UNDERWOOD RISE
TUNBRIDGE WELLS
KENT TN2 5RY

| REVISION | ITEM | DATE |
|----------|------|------|
| | | |
| | | |
| | | |
| | | |

Client
MUNESH MAHTANI
Site Address
**33 GOLDINGTON ST
LONDON NW1 1UE**

Drawing Title
**DETAILS - DINING ROOM
WINDOW**

Date
06/03/2021 Scale
1:10 & 1:5 @ A1
Checked by:
Paul Checked on:
06/03/21

Job Number Drawing Number
MP 11

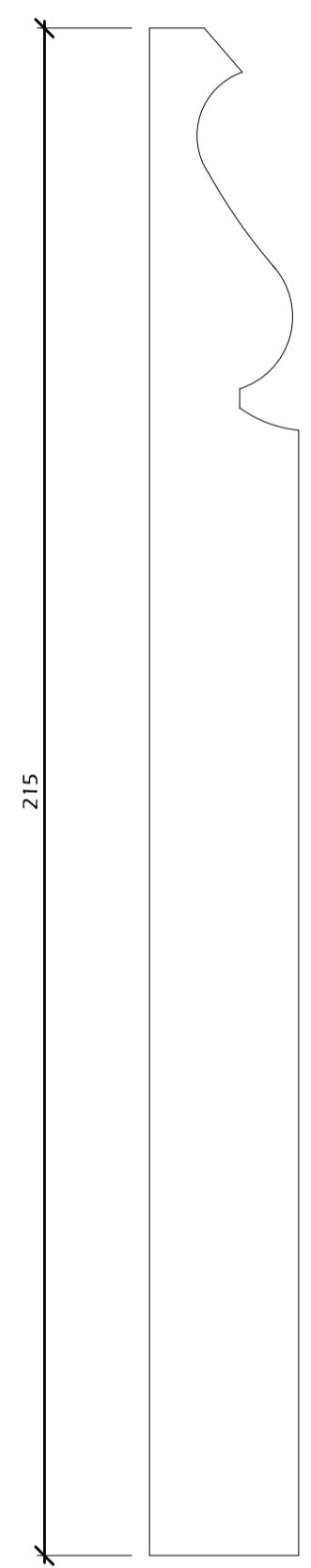
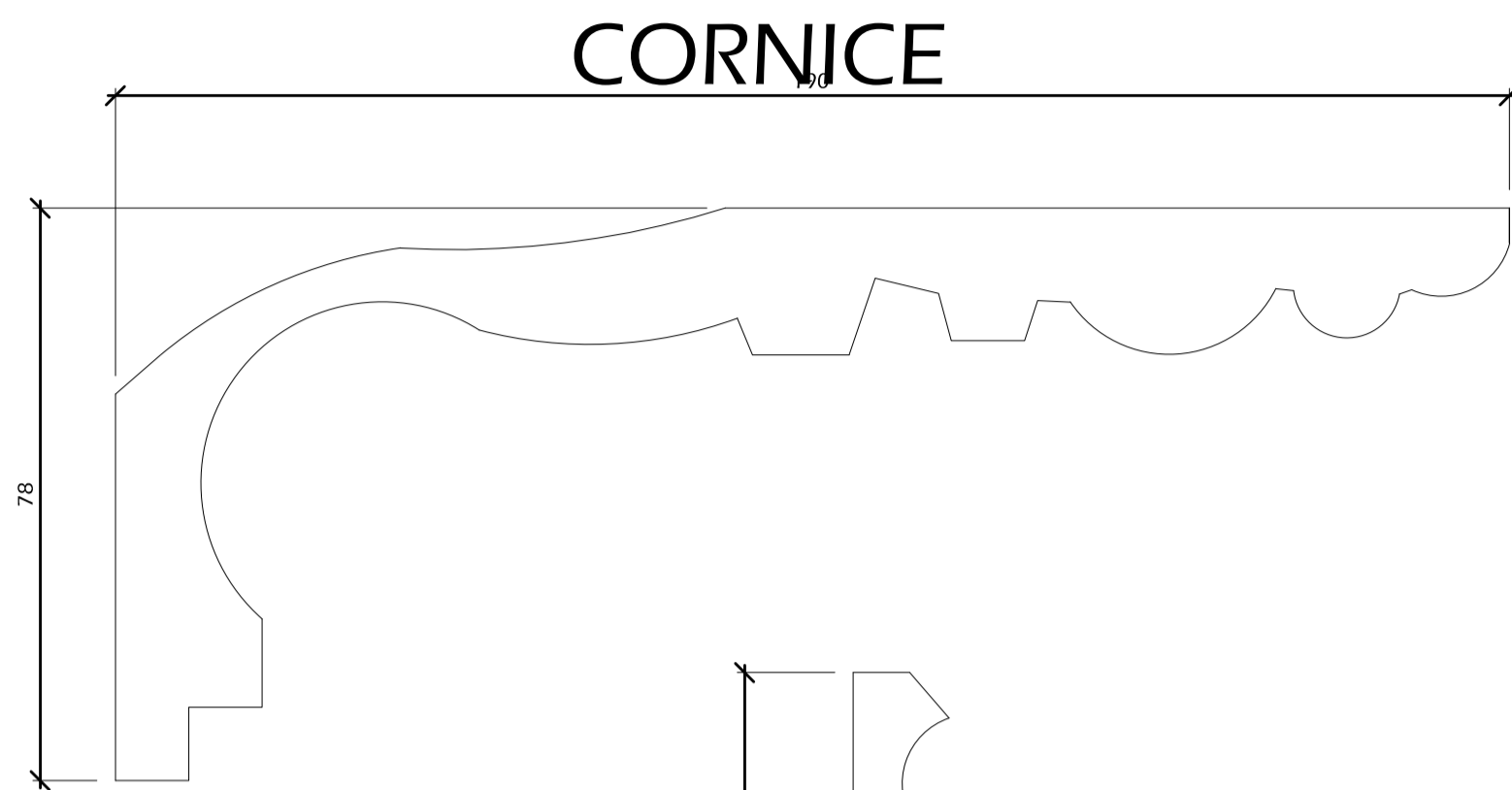

SKIRTING

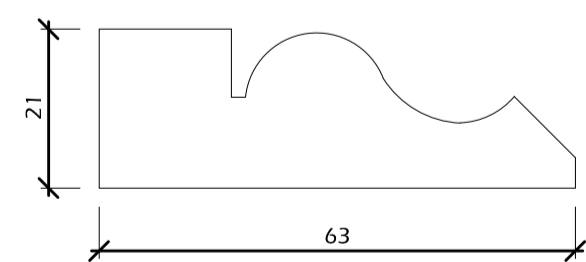

ARCHITRAVE

GROUND FLOOR

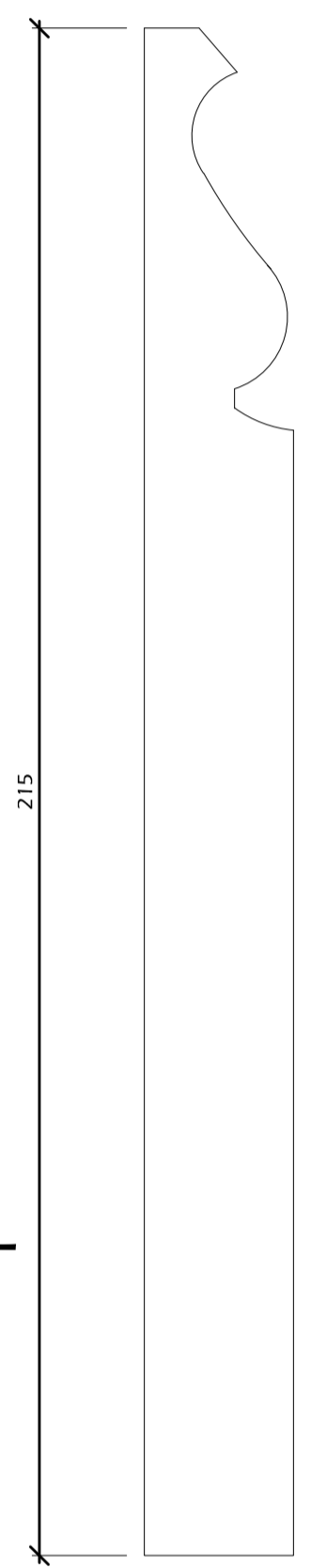
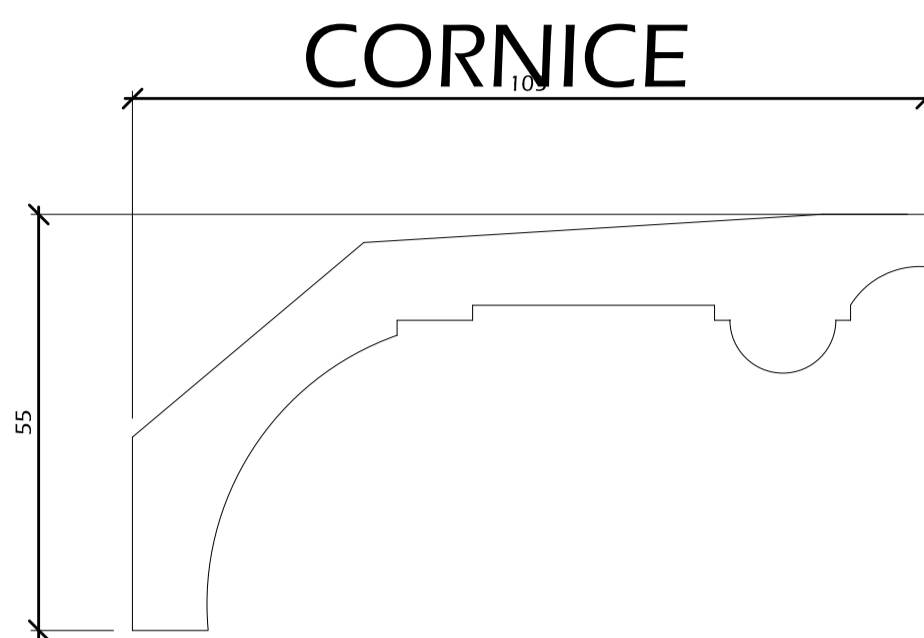

SKIRTING

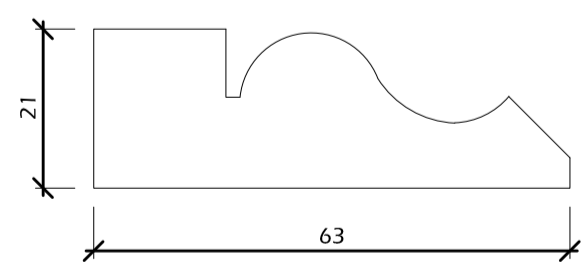

ARCHITRAVE

1ST FLOOR

PICTURE RAIL

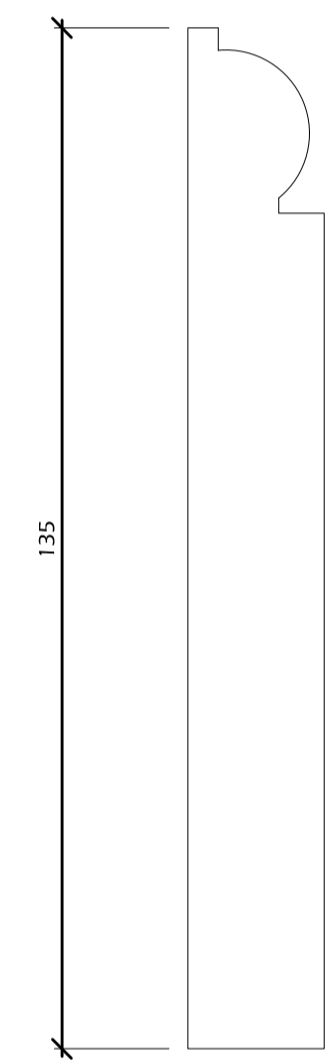
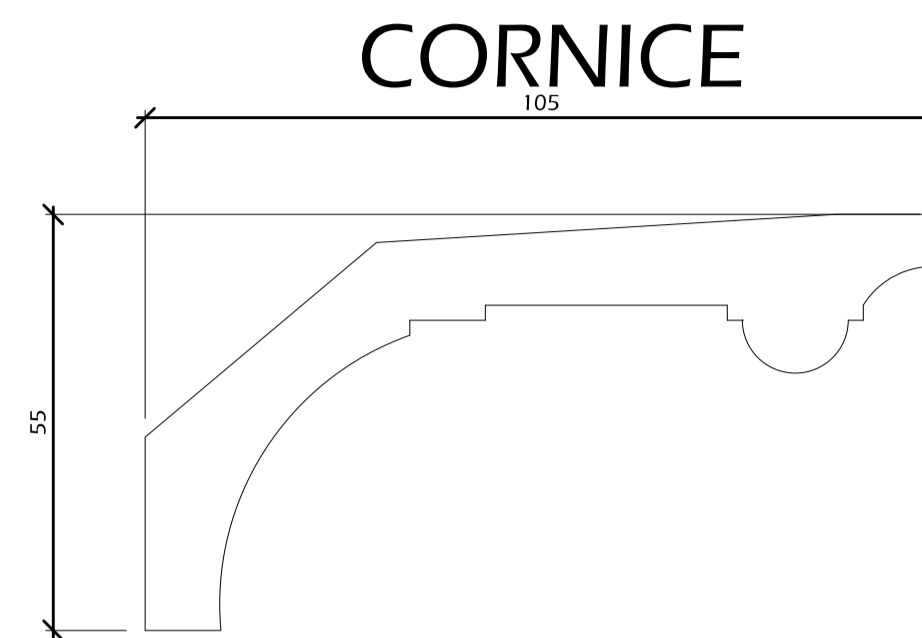
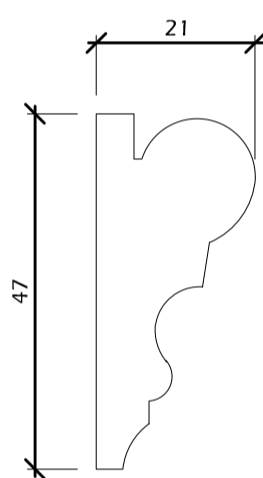

SKIRTING

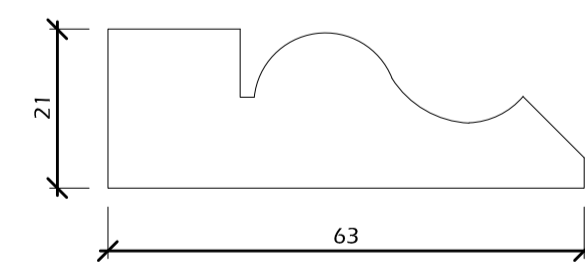

ARCHITRAVE

2ND FLOOR

SMILEY JIM LIMITED
 5 UNDERWOOD RISE
 TUNBRIDGE WELLS
 KENT TN2 5RY

| REVISION | ITEM | DATE |
|----------|------|------|
| | | |
| | | |
| | | |
| | | |
| | | |

Client: **MUNESH MAHTANI**
 Site Address: **33 GOLDINGTON ST LONDON NW1 1UE**

Drawing Title: **DETAILS AS PROPOSED**

Date: **06/03/2021** Scale: **1:1 @ A1**
 Paul Checked by: **Paul** Checked on: **06/03/21**

| | |
|------------|----------------|
| Job Number | Drawing Number |
| | MP 10 |

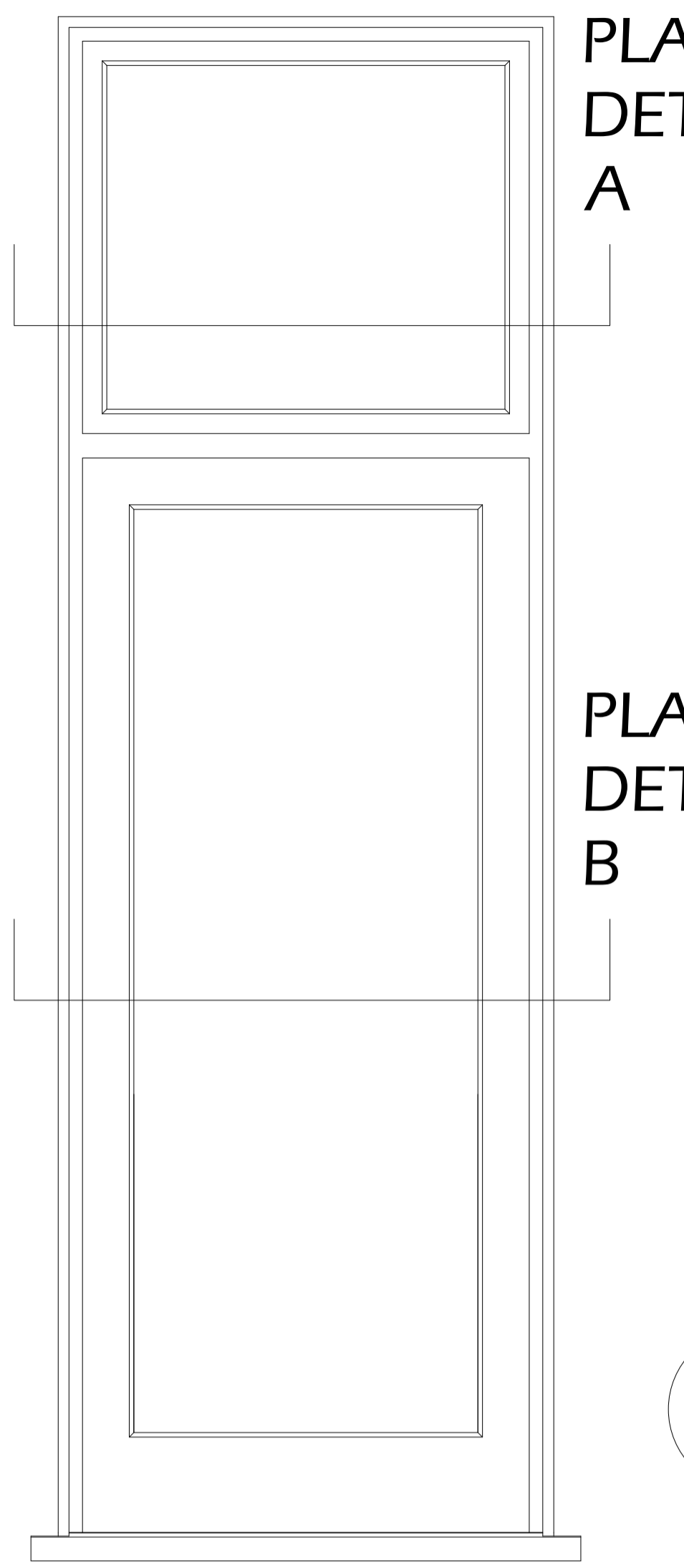

PLAN
DETAIL
A

PLAN
DETAIL
B

SECTION
DETAIL

D5

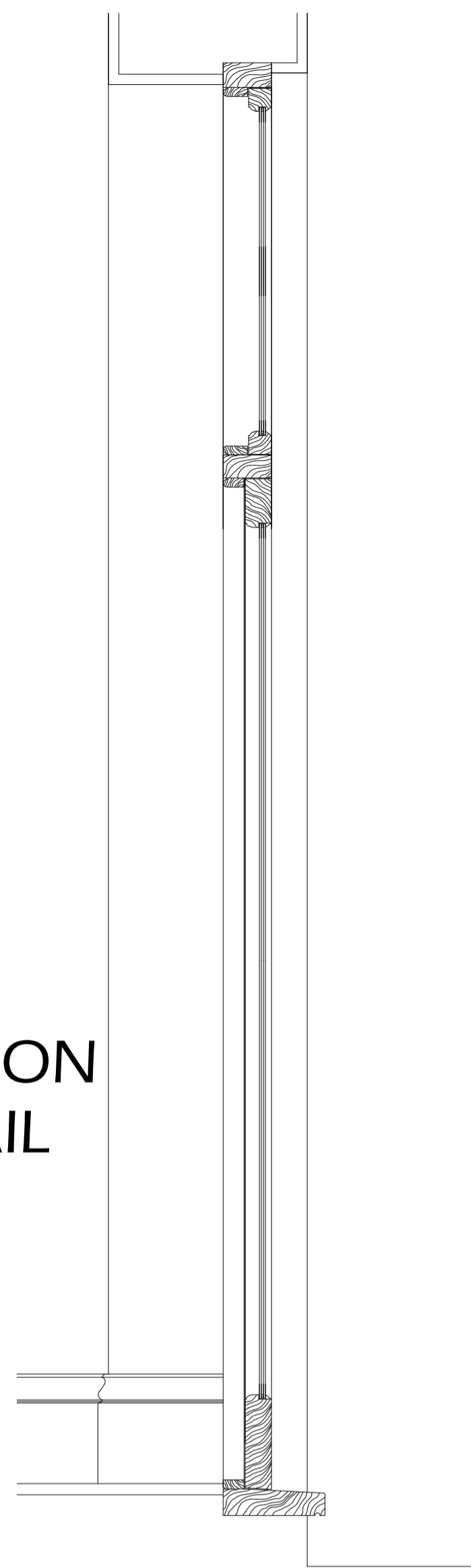

ELEVATION

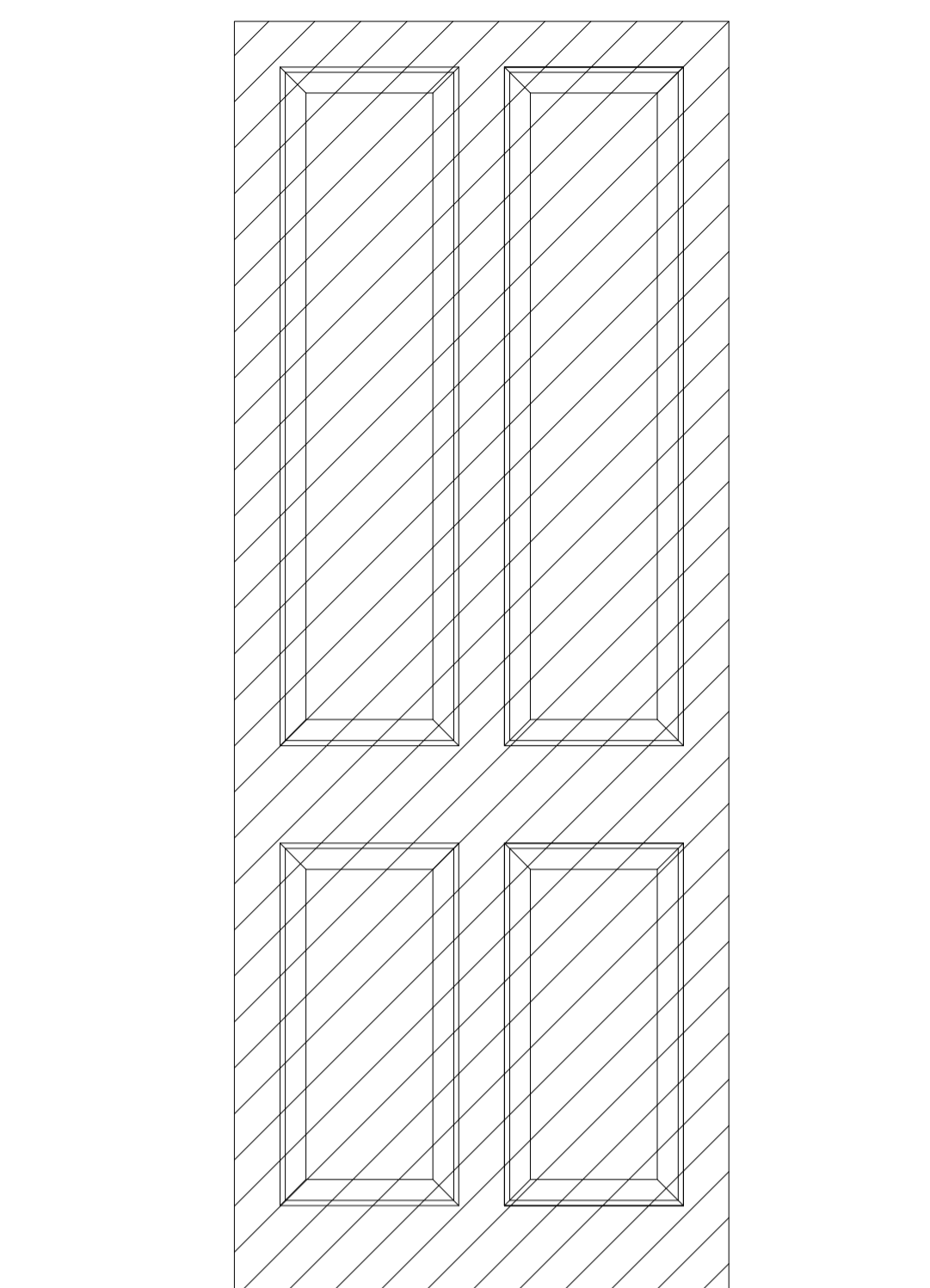

ELEVATION

D8

EXISTING DOOR
PLASTERED OVER
BOTH SIDES

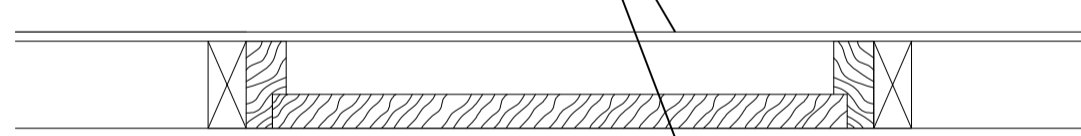

PLAN DETAIL

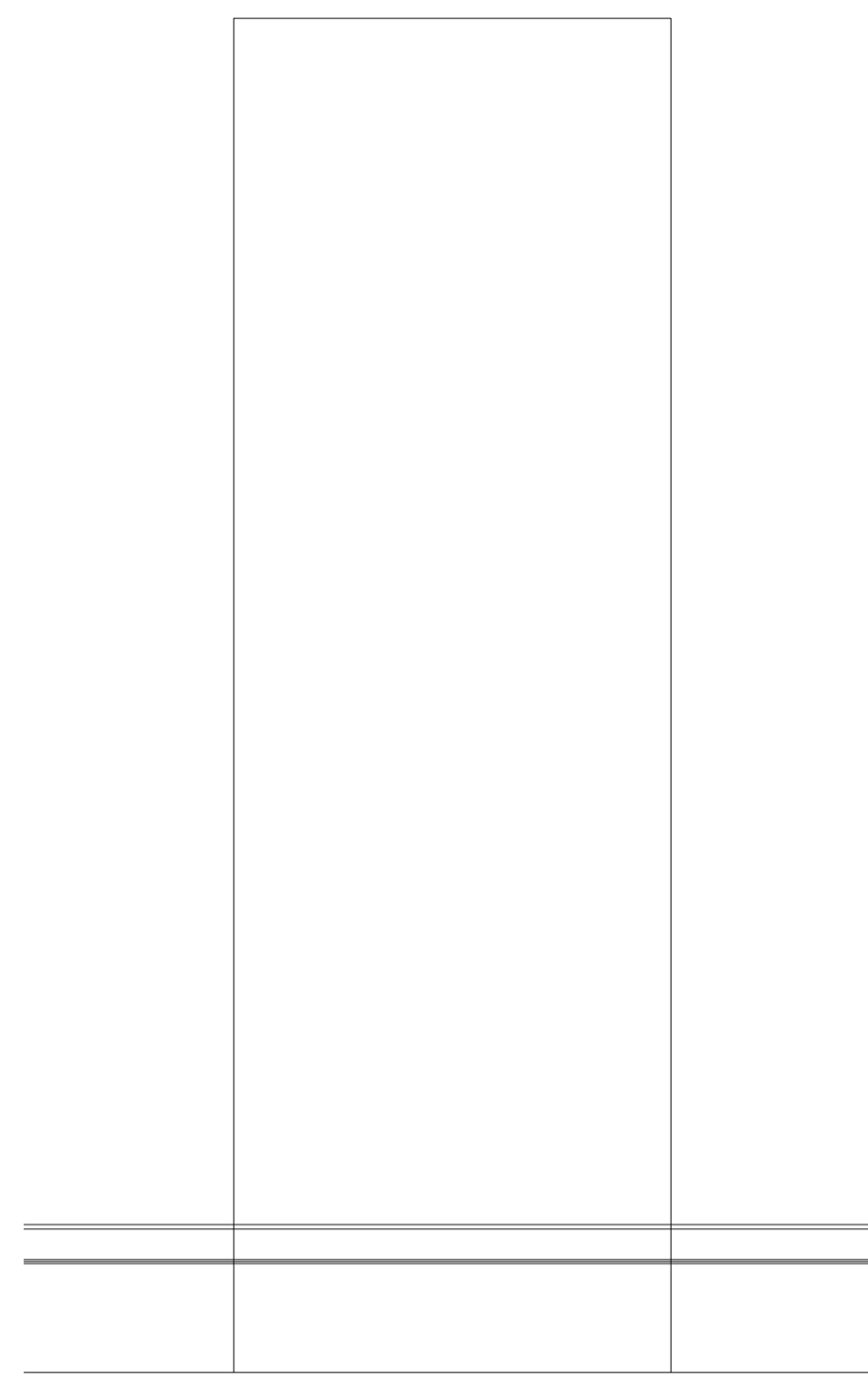

ELEVATION

D10



new flush/
secret door

PLAN DETAIL

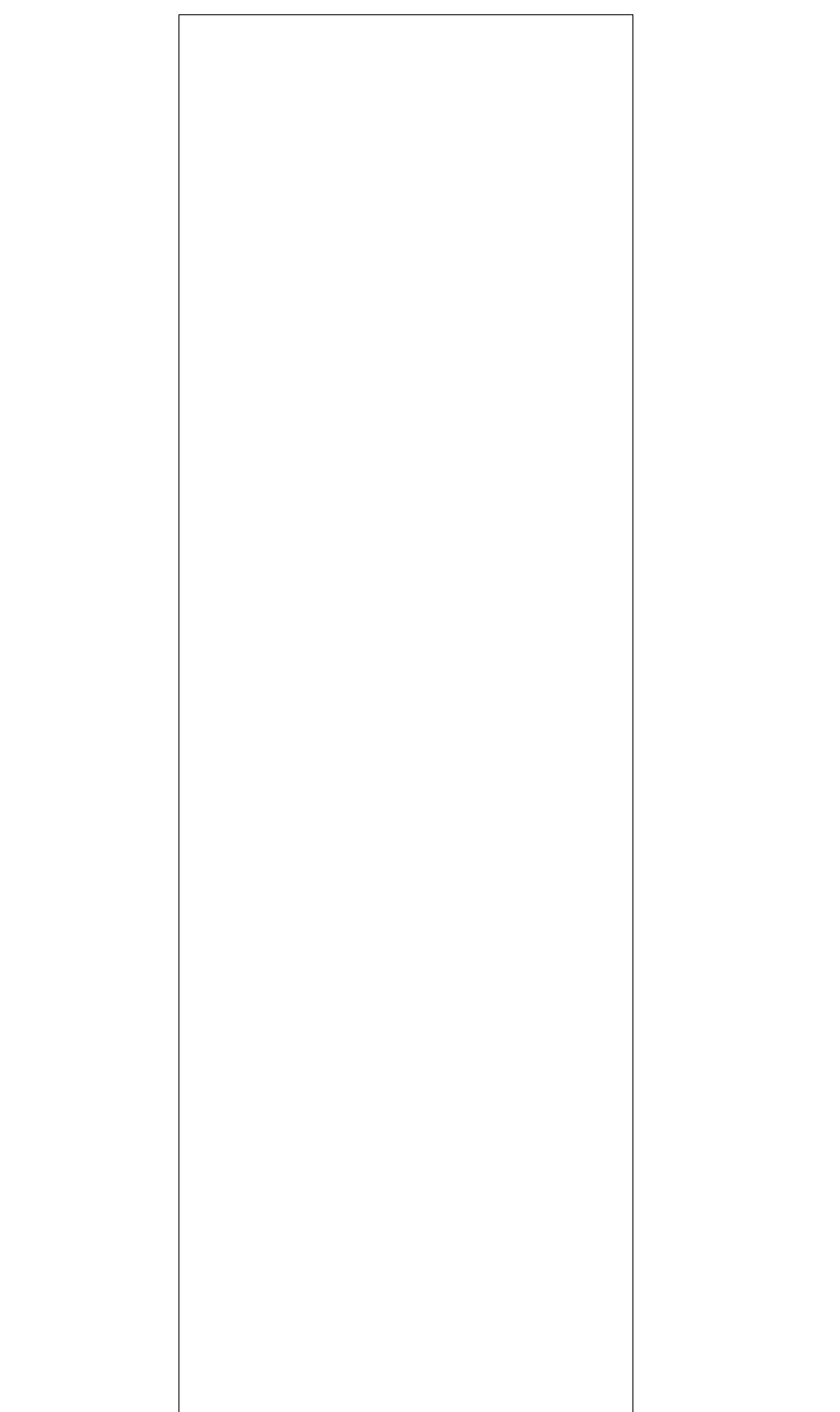

ELEVATION

D11



new flush/
secret door



PLAN
DETAIL
A

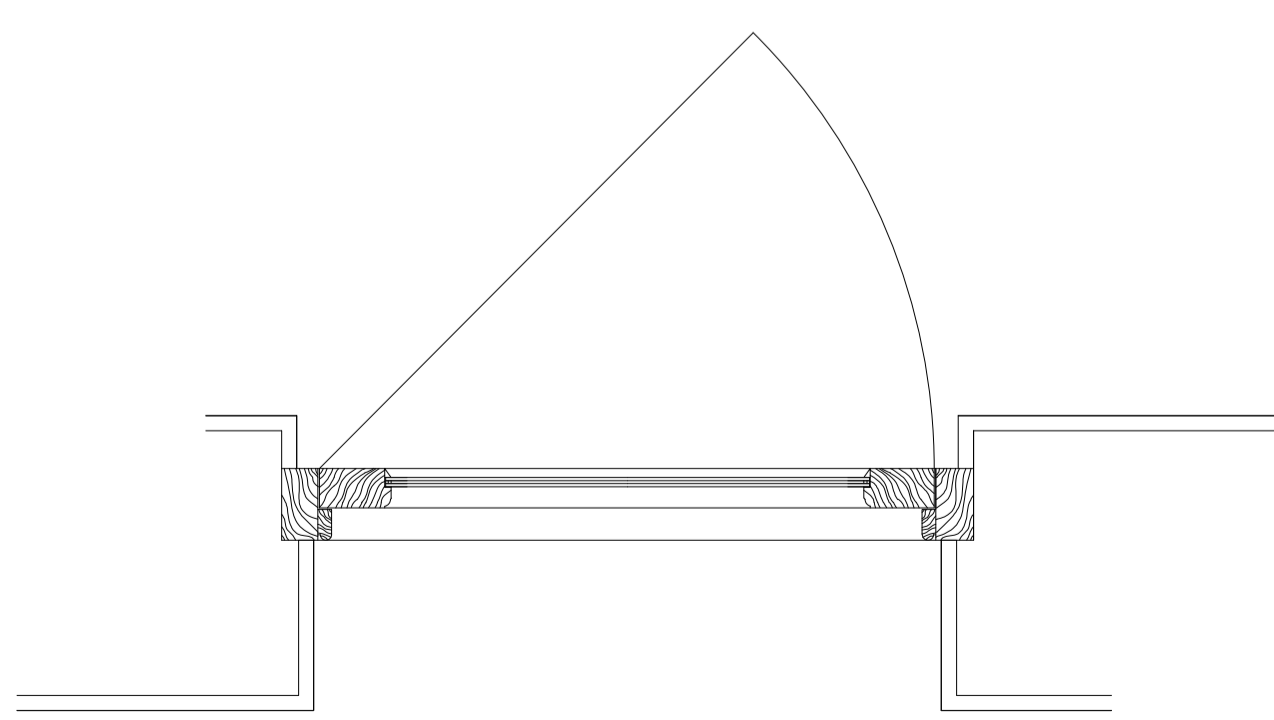

PLAN
DETAIL
B

SMILEY JIM LIMITED
5 UNDERWOOD RISE
TUNBRIDGE WELLS
KENT TN2 5RY

| REVISION | ITEM | DATE |
|----------|------|------|
| | | |
| | | |
| | | |
| | | |

Client
MUNESH MAHTANI

Site Address
33 GOLDINGTON ST
LONDON NW1 1UE

Drawing Title
DETAILS AS PROPOSED

Date
06/03/2021

Scale
1:10 @ A1

Checked by:
Paul

Checked on:
06/03/21

| | |
|------------|----------------|
| Job Number | Drawing Number |
| | MP 08 |

GROUND FLOOR

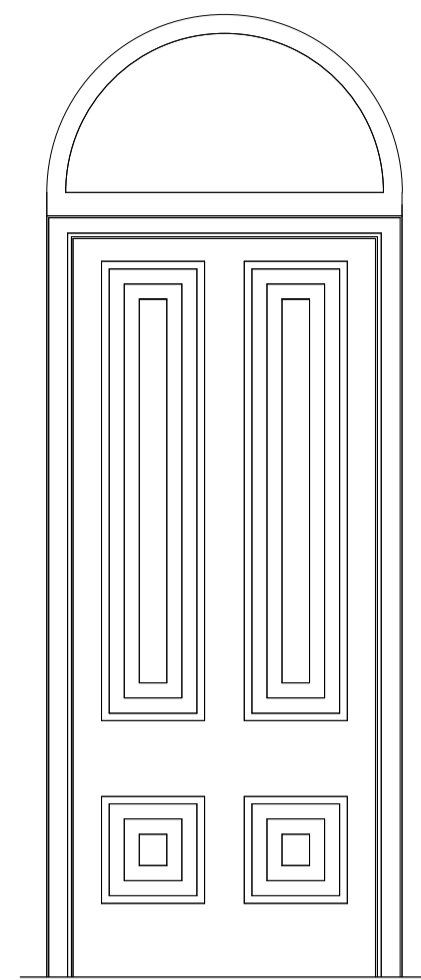

D1
EXISTING DOOR
NO CHANGE

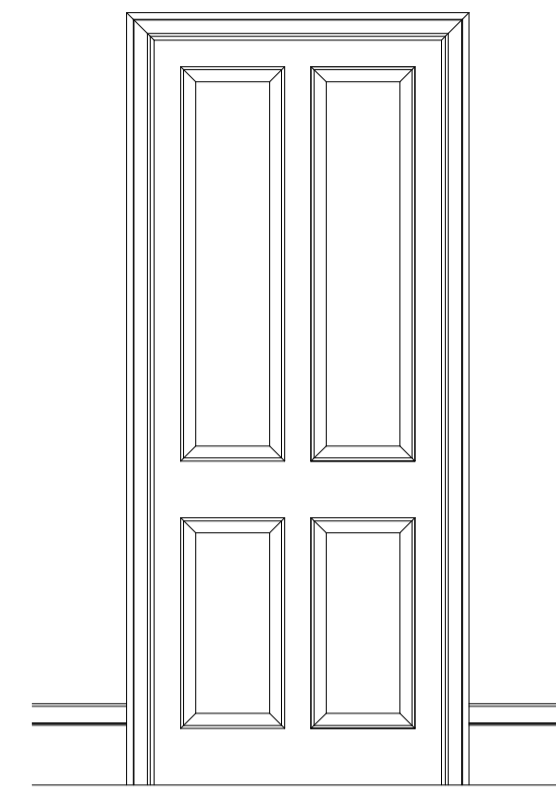

D2
NEW DOOR
TYPE A

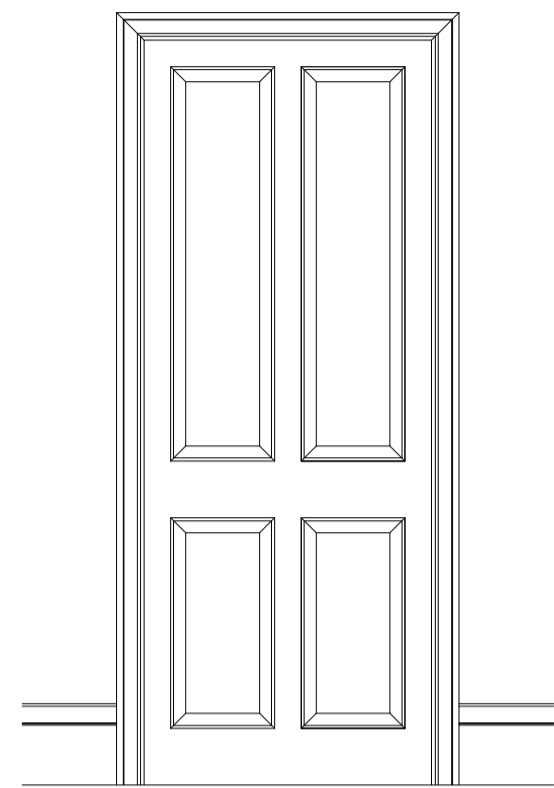

D3
EXISTING DOOR
NO CHANGE

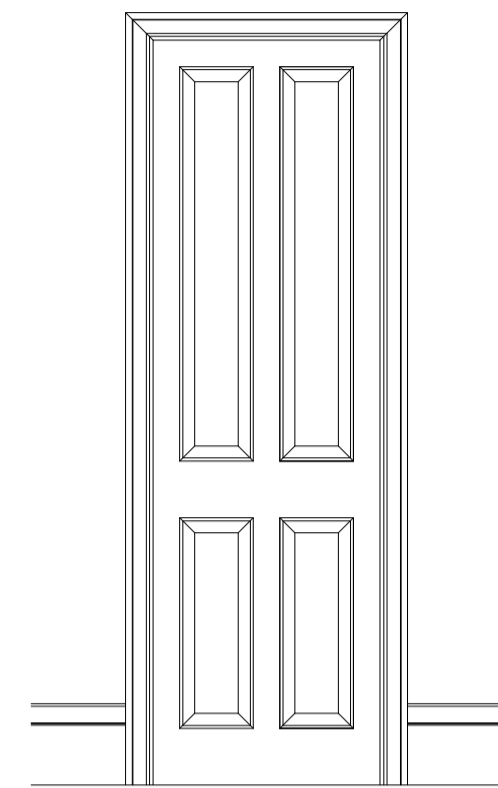

D4
EXISTING DOOR
NO CHANGE

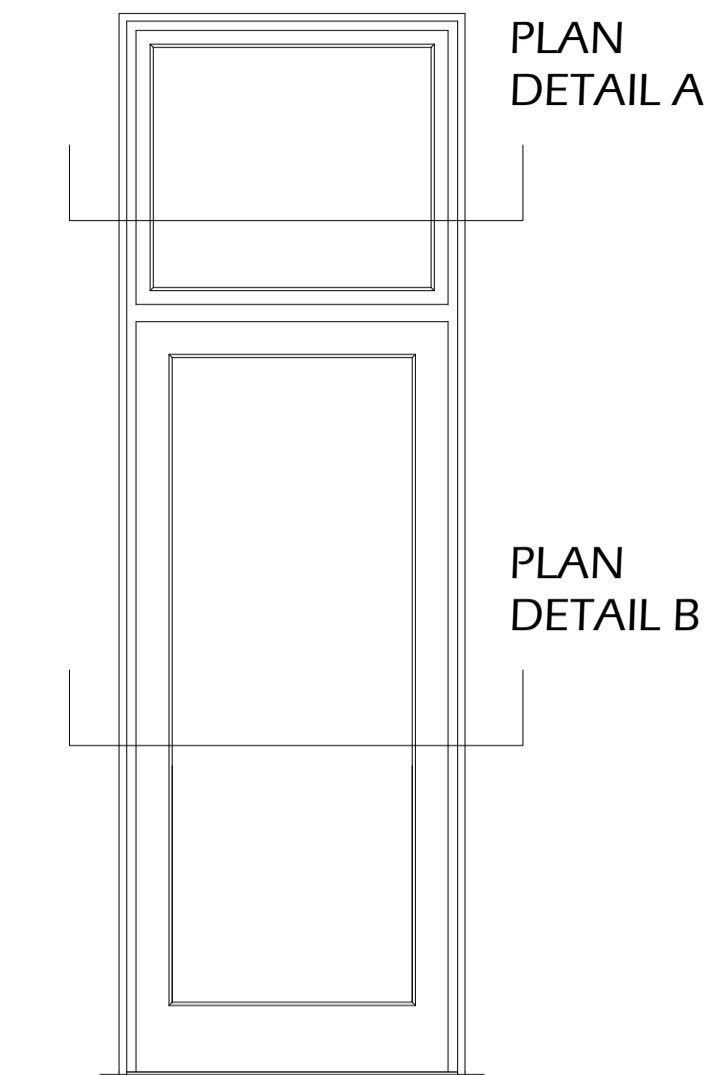

D5
NEW DOOR
TYPE B

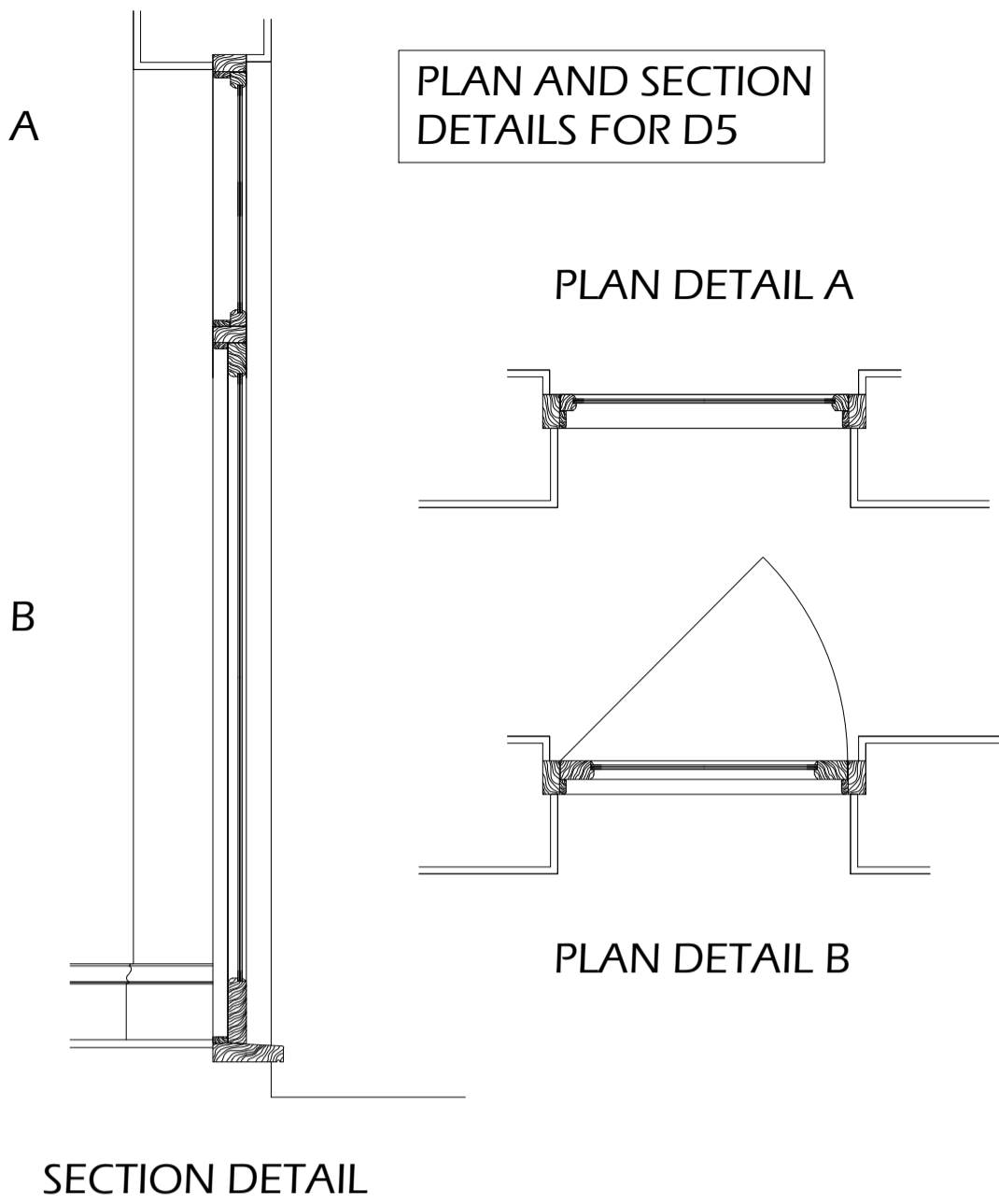

FIRST FLOOR

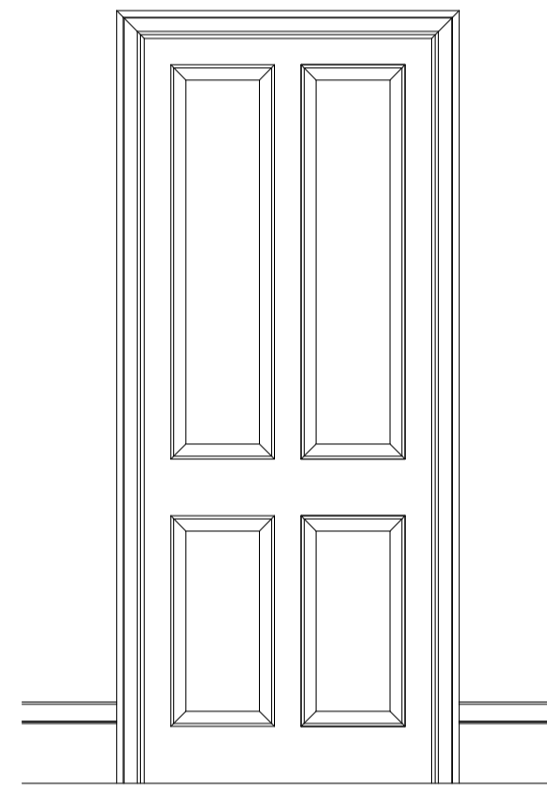

D6
NEW DOOR
TYPE A

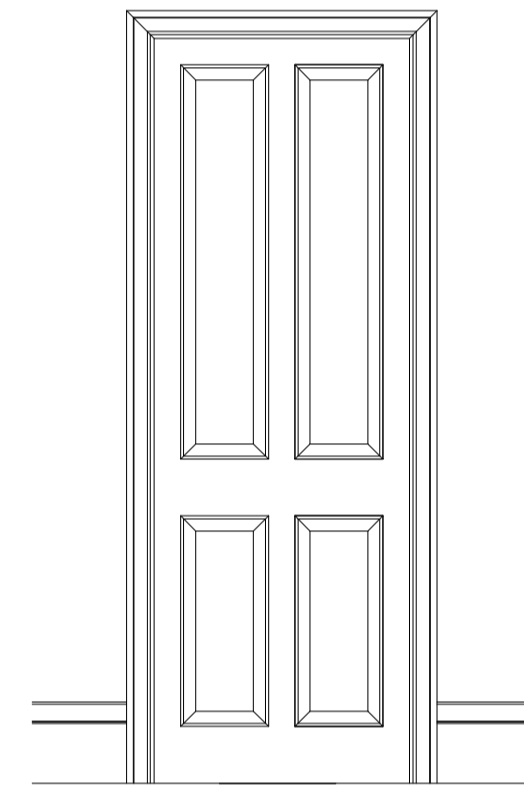

D7
NEW DOOR
TYPE A

SECOND FLOOR

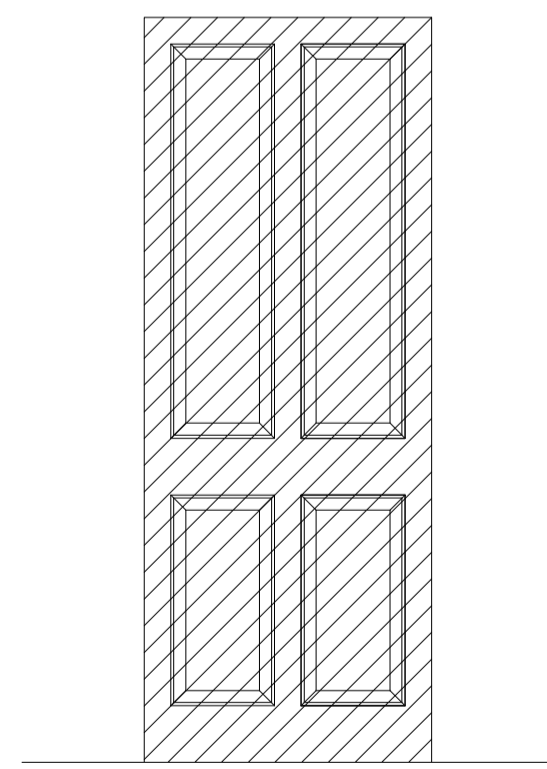

D8
EXISTING DOOR
PLASTERED OVER
BOTH SIDES

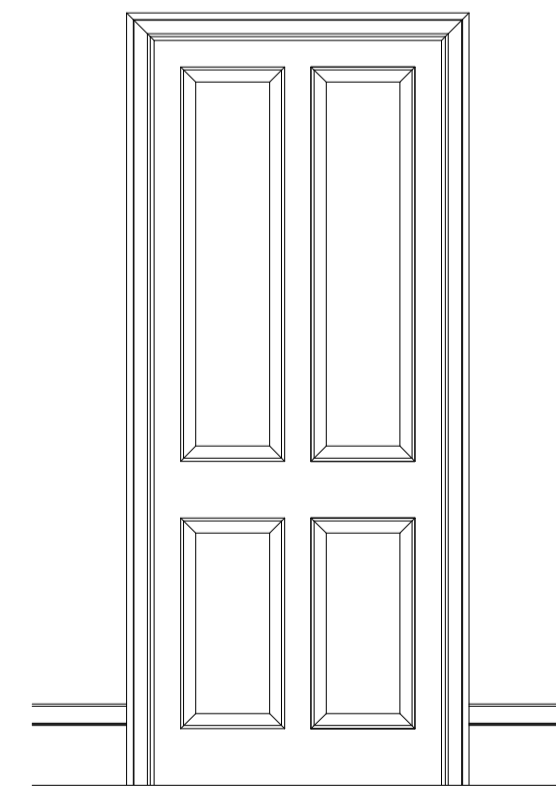
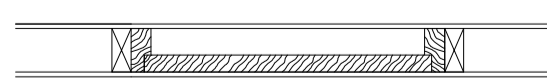

D9
NEW DOOR
TYPE A

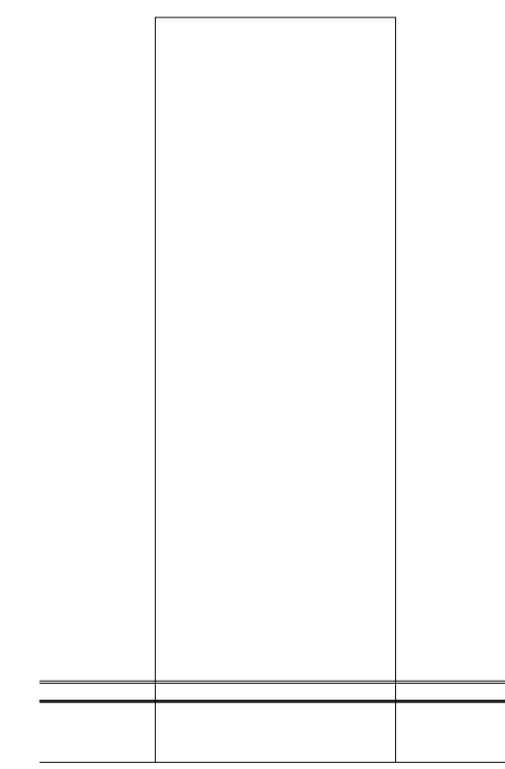

D10
new flush/
secret door

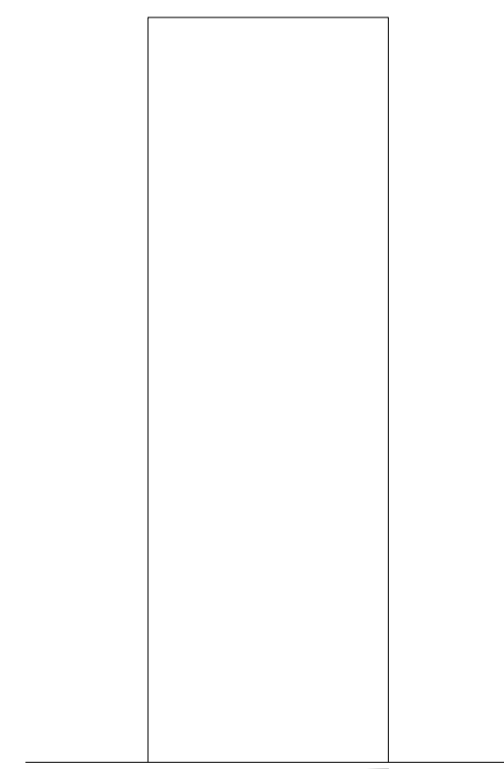

D11
new flush/
secret door

SMILEY JIM LIMITED
5 UNDERWOOD RISE
TUNBRIDGE WELLS
KENT TN2 5RY

| REVISION | ITEM | DATE |
|----------|------|------|
| | | |
| | | |
| | | |
| | | |
| | | |
| | | |
| | | |
| | | |
| | | |
| | | |

Client
MUNESH MAHTANI
Site Address
33 GOLDINGTON ST
LONDON NW1 1UE

Drawing Title
DETAILS - DOOR SCHEDULE

Date
06/03/2021
Scale
1:20 @ A1

Checked by
Paul
Checked on
06/03/21

| | |
|------------|----------------|
| Job Number | Drawing Number |
| MP | 07 |

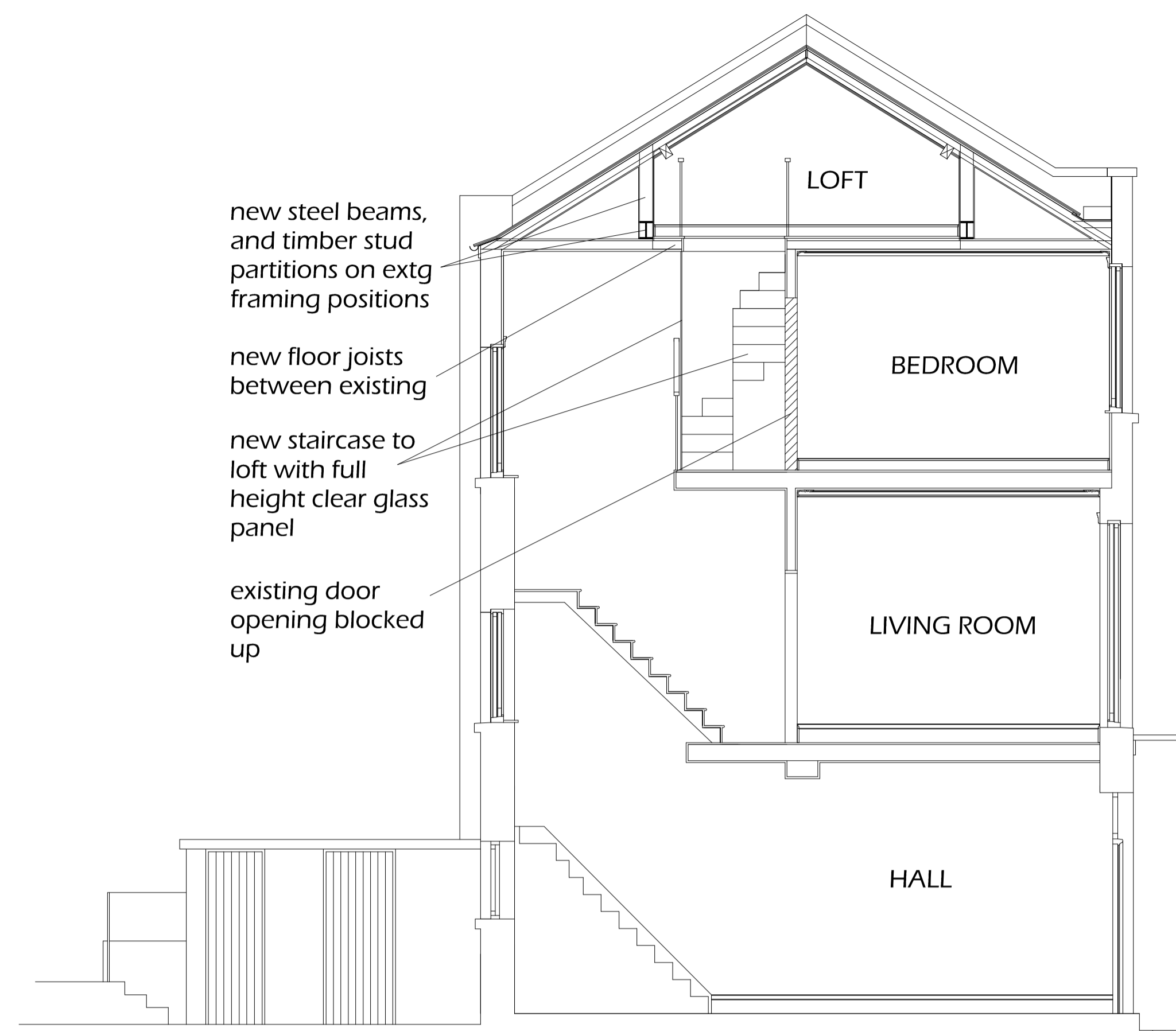

SECTION A-A

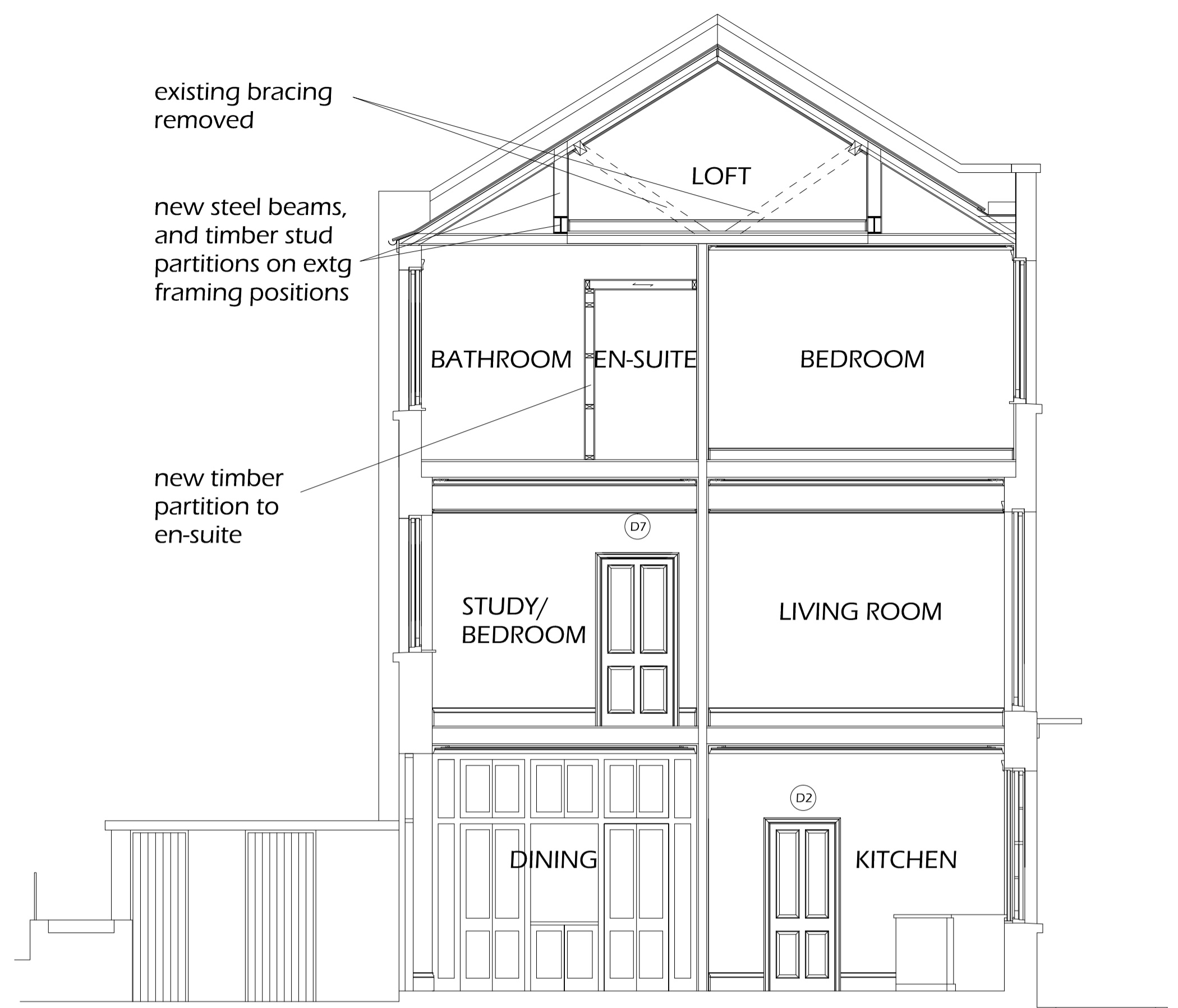

SECTION B-B

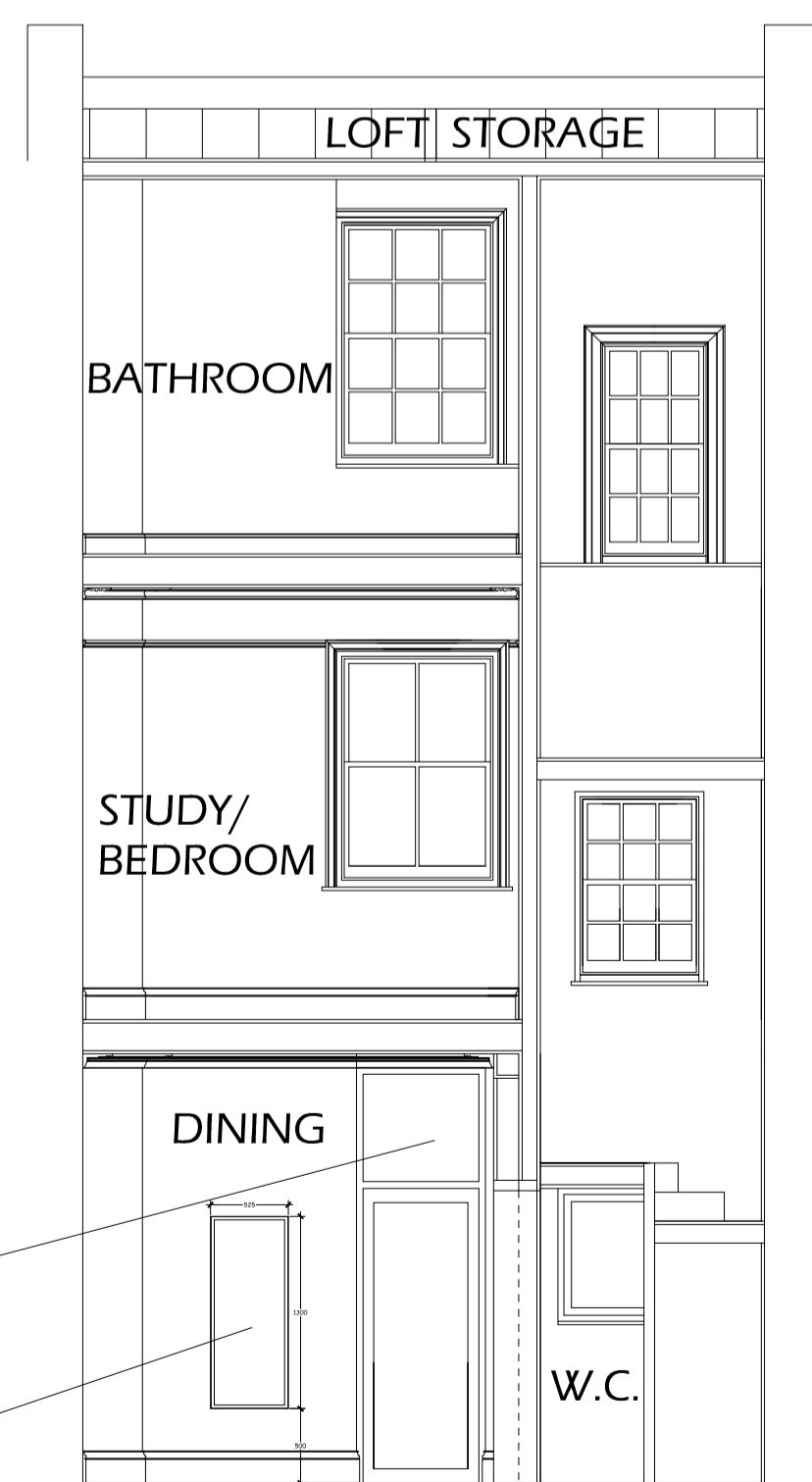

SECTION C-C

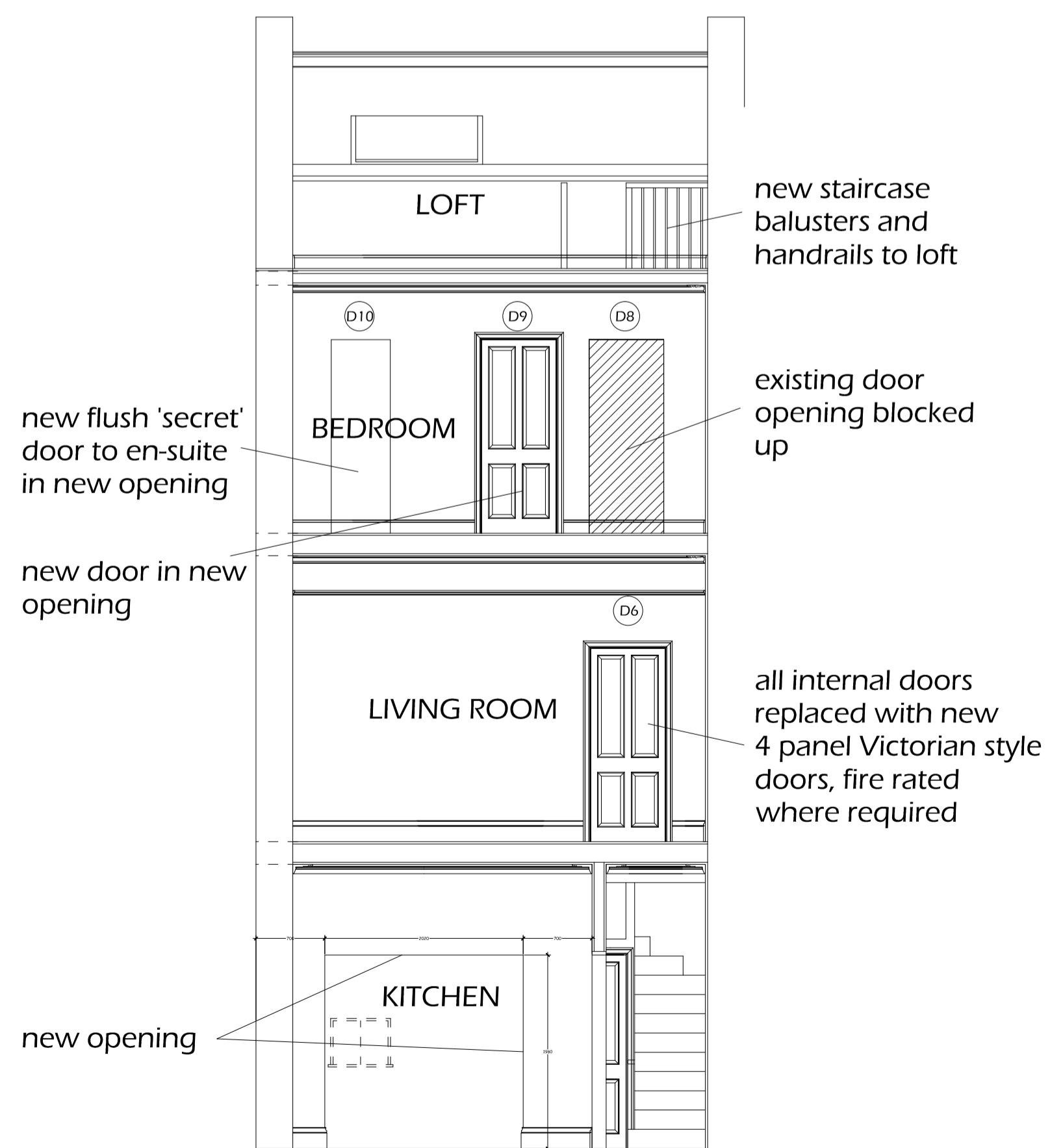

SECTION D-D

SMILEY JIM LIMITED
 5 UNDERWOOD RISE
 TUNBRIDGE WELLS
 KENT TN2 5RY

| REVISION | ITEM | DATE |
|----------|------|------|
| | | |
| | | |
| | | |
| | | |

Client: **MUNESH MAHTANI**
 Site Address: **33 GOLDINGTON ST LONDON NW1 1UE**

Drawing Title: **SECTIONS (1) AS PROPOSED**

Date: **06/03/2021** Scale: **1:50 @ A1**
 Paul Checked by: **06/03/21**

| | |
|------------|----------------|
| Job Number | Drawing Number |
| | MP 06A |

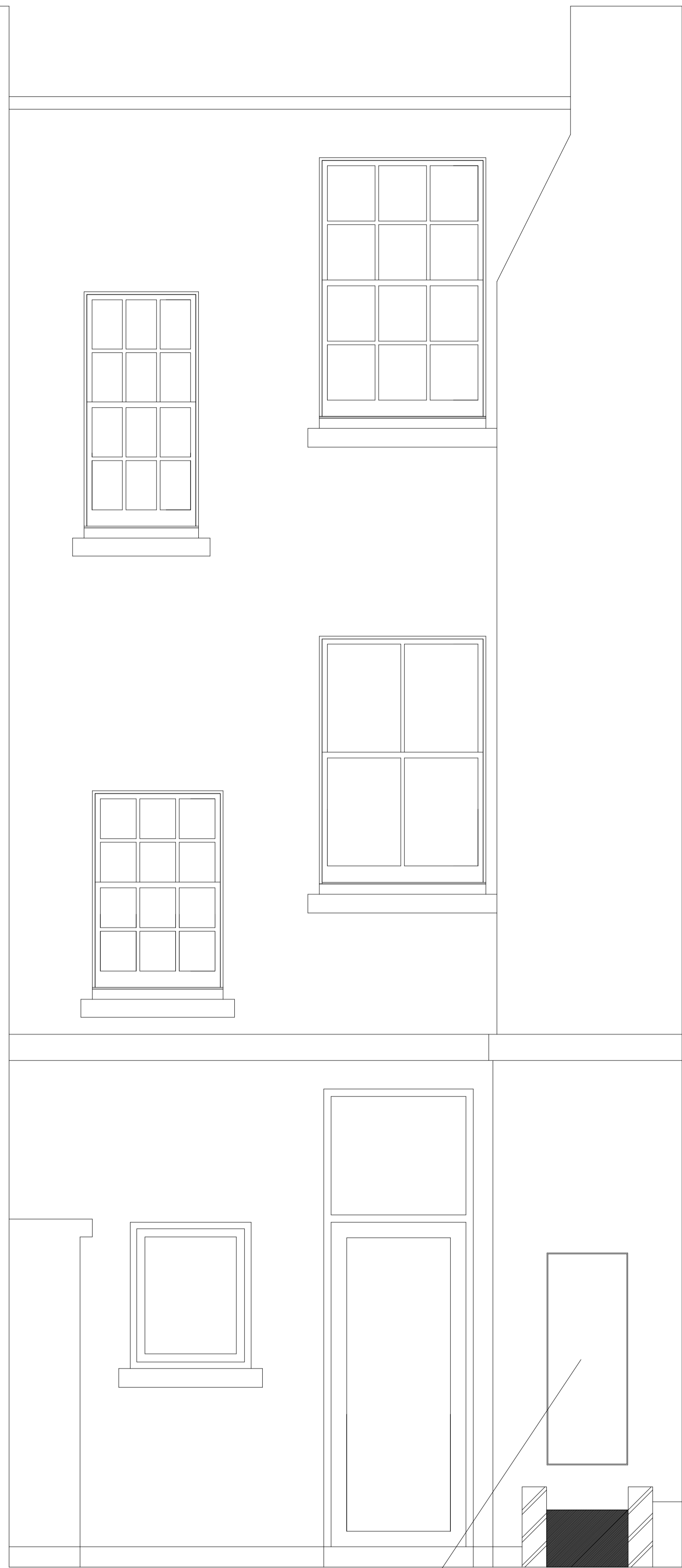

REAR ELEVATION
1:20 SCALE

stucco panel in minimal metal frame painted to match render



REAR ELEVATION

new window with minimal metal frame

new opening and window

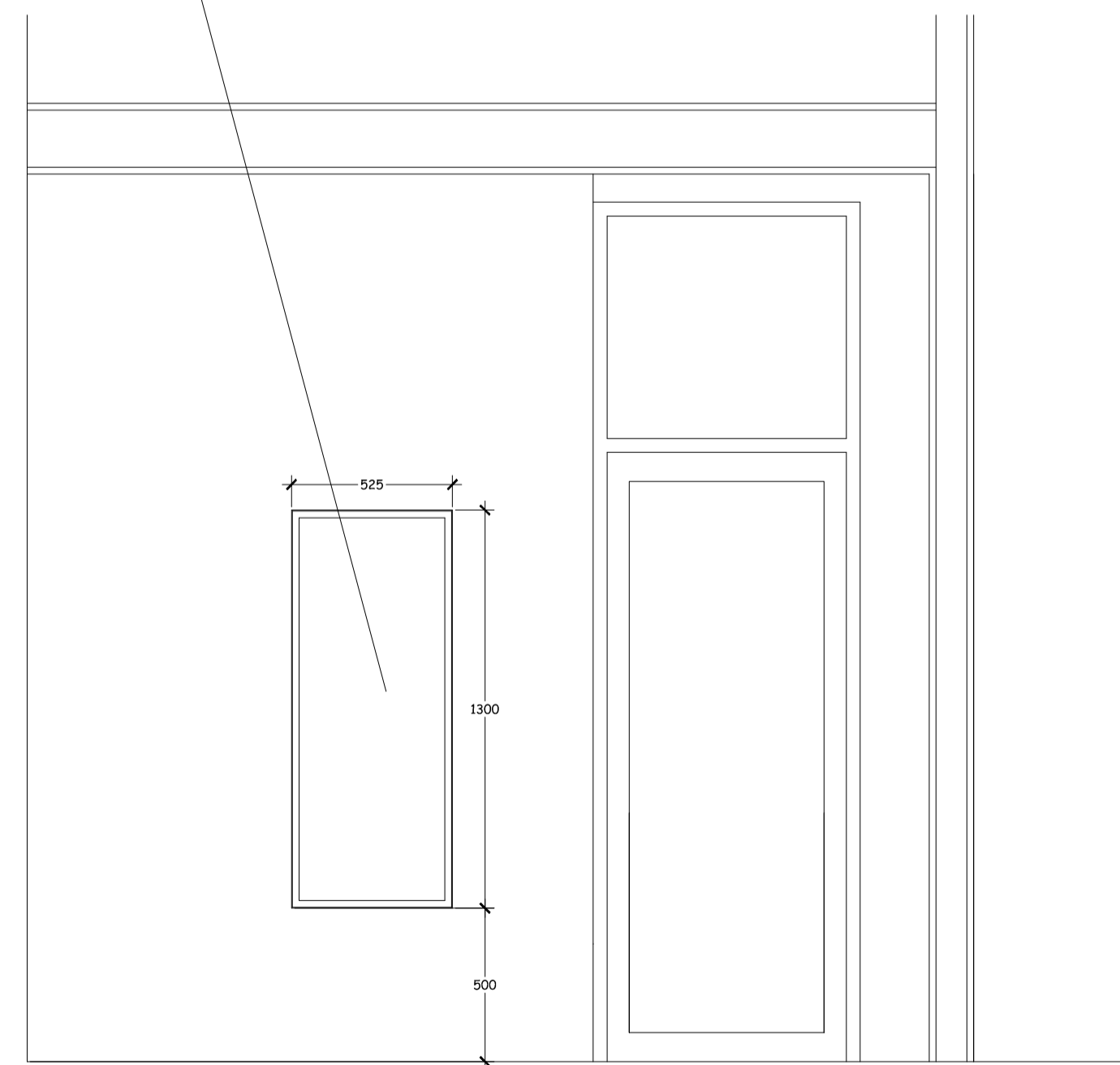

INTERIOR ELEVATION

SMILEY JIM LIMITED
5 UNDERWOOD RISE
TUNBRIDGE WELLS
KENT TN2 5RY

| REVISION | ITEM | DATE |
|----------|------|------|
| | | |
| | | |
| | | |
| | | |

Client
MUNESH MAHTANI
Site Address
**33 GOLDINGTON ST
LONDON NW1 1UE**

Drawing Title
ELEVATIONS (2) AS PROPOSED

Date
06/03/2021 Scale
1:50 @ A1

Paul Checked by: **Paul** Checked on: **06/03/21**

| | |
|------------|----------------|
| Job Number | Drawing Number |
| | MP 05B |

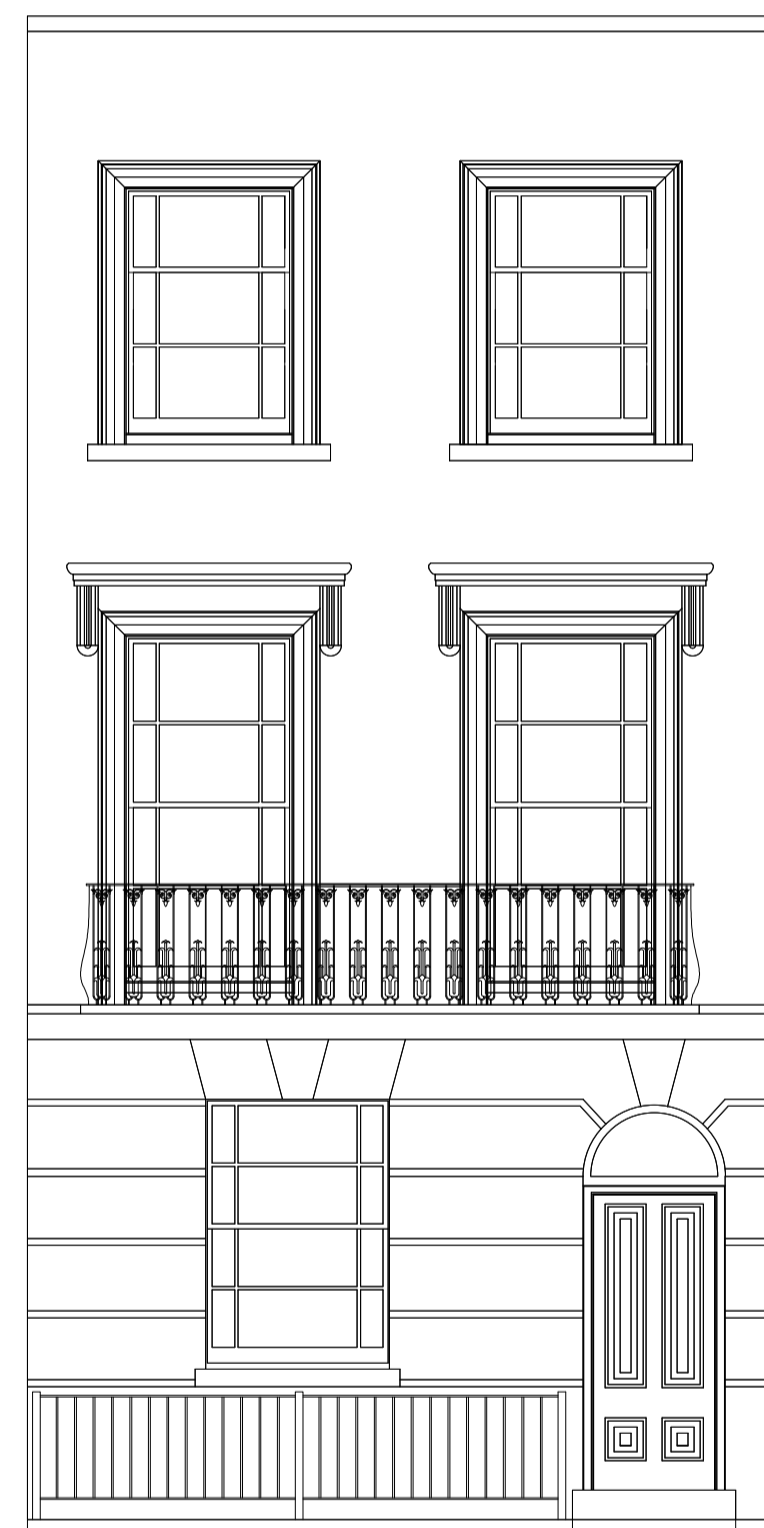

FRONT ELEVATION

(01)



REAR ELEVATION

new hinged flush rendered panel with window behind in minimal metal frame

water feature

planting bed

new timber door and fanlight in existing opening

SMILEY JIM LIMITED
5 UNDERWOOD RISE
TUNBRIDGE WELLS
KENT TN2 5RY

| REVISION | ITEM | DATE |
|----------|------|------|
| | | |
| | | |
| | | |
| | | |
| | | |
| | | |
| | | |
| | | |
| | | |
| | | |

Client
MUNESH MAHTANI
Site Address
**33 GOLDINGTON ST
LONDON NW1 1UE**

Drawing Title
ELEVATIONS (1) AS PROPOSED

| | |
|----------------------------|--------------------------------|
| Date 06/03/2021 | Scale 1:50 @ A1 |
| Checked by: Paul | Checked on: 06/03/21 |

| | |
|------------|----------------|
| Job Number | Drawing Number |
| | MP 05A |

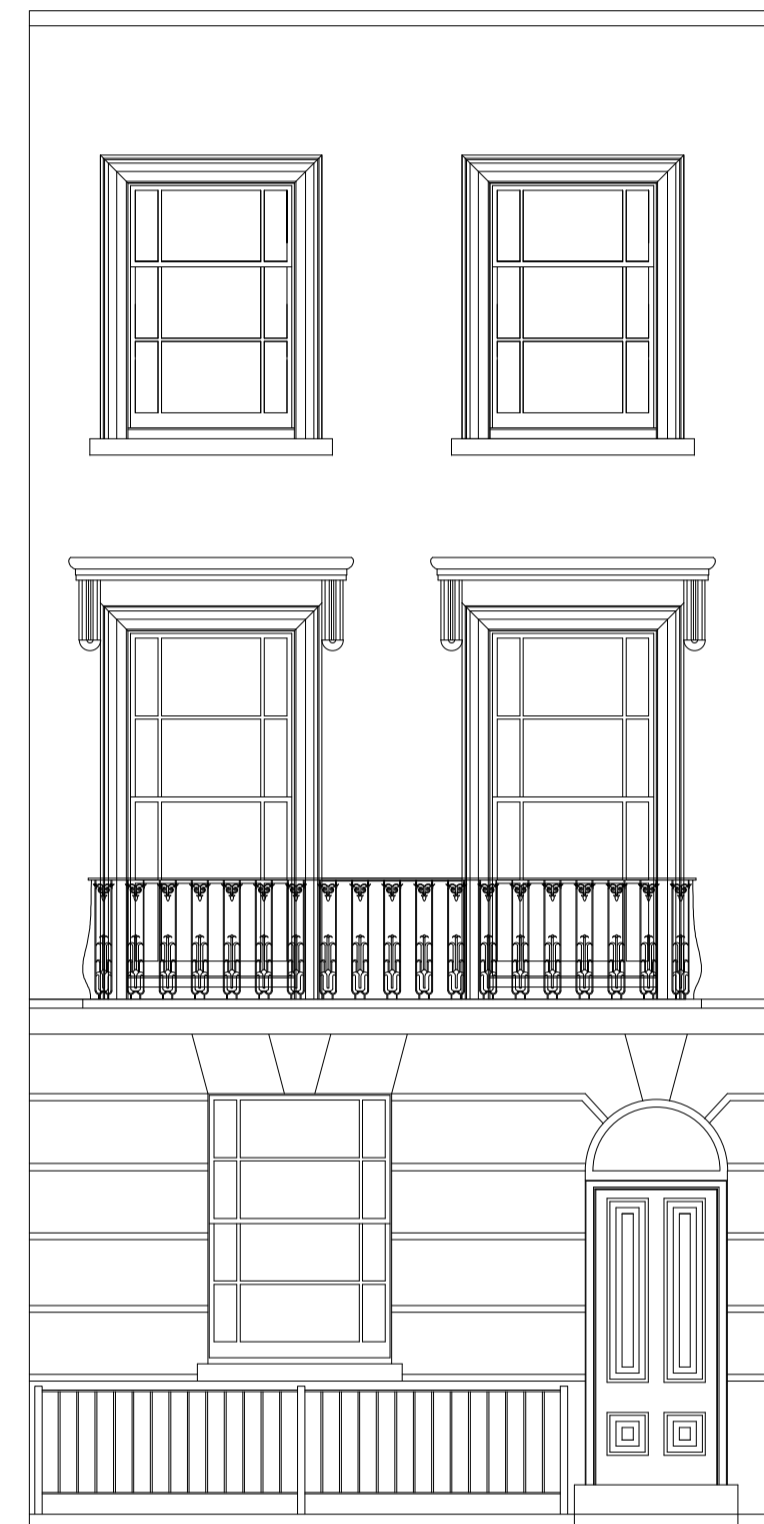

FRONT ELEVATION



REAR ELEVATION



SMILEY JIM LIMITED
5 UNDERWOOD RISE
TUNBRIDGE WELLS
KENT TN2 5RY

| REVISION | ITEM | DATE |
|----------|------|------|
| | | |
| | | |
| | | |
| | | |
| | | |

Client
MUNESH MAHTANI
Site Address
**33 GOLDINGTON ST
LONDON NW1 1UE**

Drawing Title
ELEVATIONS AS EXISTING

| | |
|----------------------------|--------------------------------|
| Date 28/09/2020 | Scale 1:50 @ A1 |
| Checked by: Paul | Checked on: 28/09/20 |

| | |
|------------|----------------|
| Job Number | Drawing Number |
| | MP 03 |



SECTION A-A



SECTION B-B



SECTION C-C

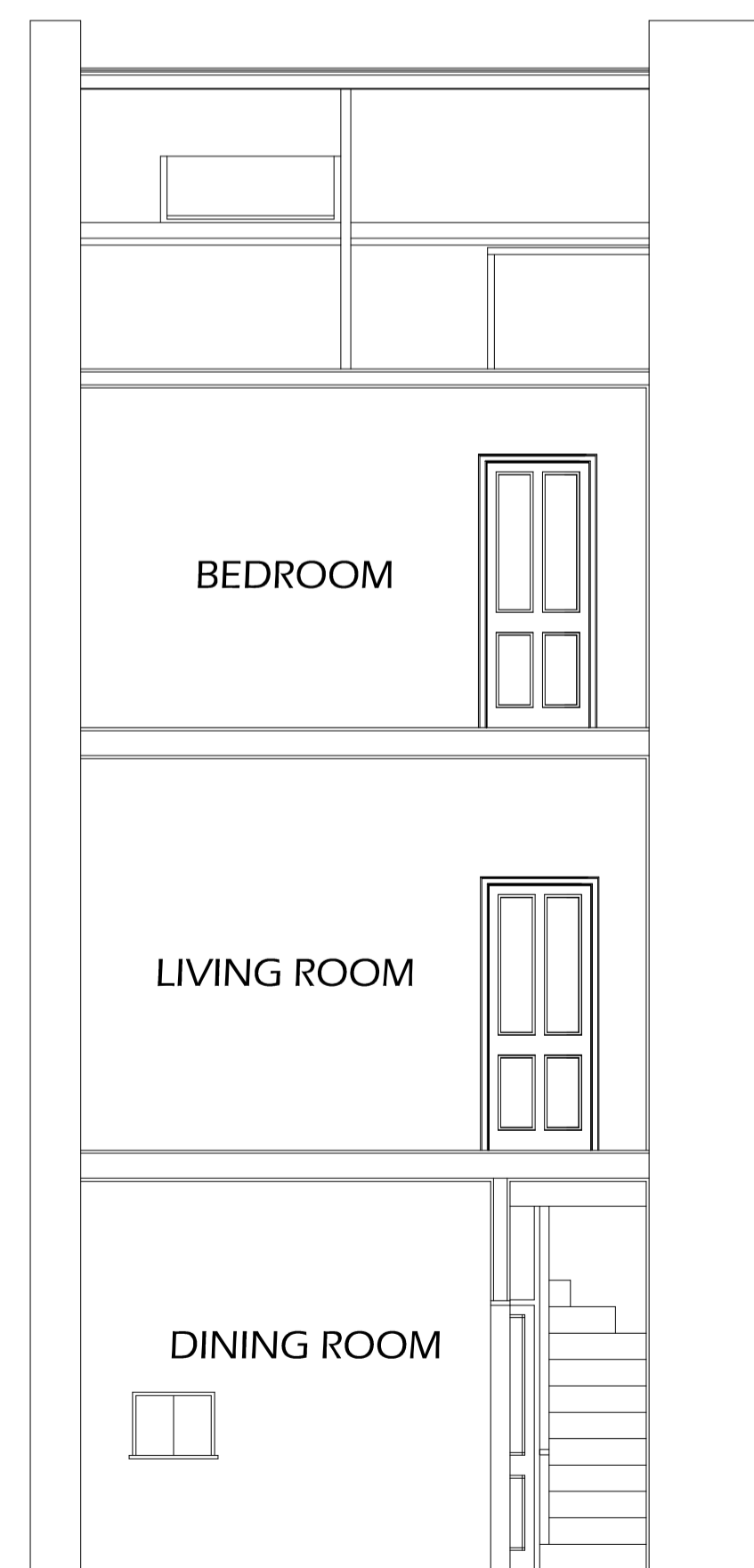

SECTION D-D

SMILEY JIM LIMITED
5 UNDERWOOD RISE
TUNBRIDGE WELLS
KENT TN2 5RY

| REVISION | ITEM | DATE |
|----------|------|------|
| | | |
| | | |
| | | |
| | | |

Client
MUNESH MAHTANI
Site Address
**33 GOLDINGTON ST
LONDON NW1 1UE**

Drawing Title
SECTIONS AS EXISTING

| | |
|---------------------------|--|
| Date 28/09/2020 | Scale 1:50 @ A1 |
| Paul | Checked by: Paul Checked on: 28/09/20 |

| | |
|------------|----------------|
| Job Number | Drawing Number |
| | MP 02 |

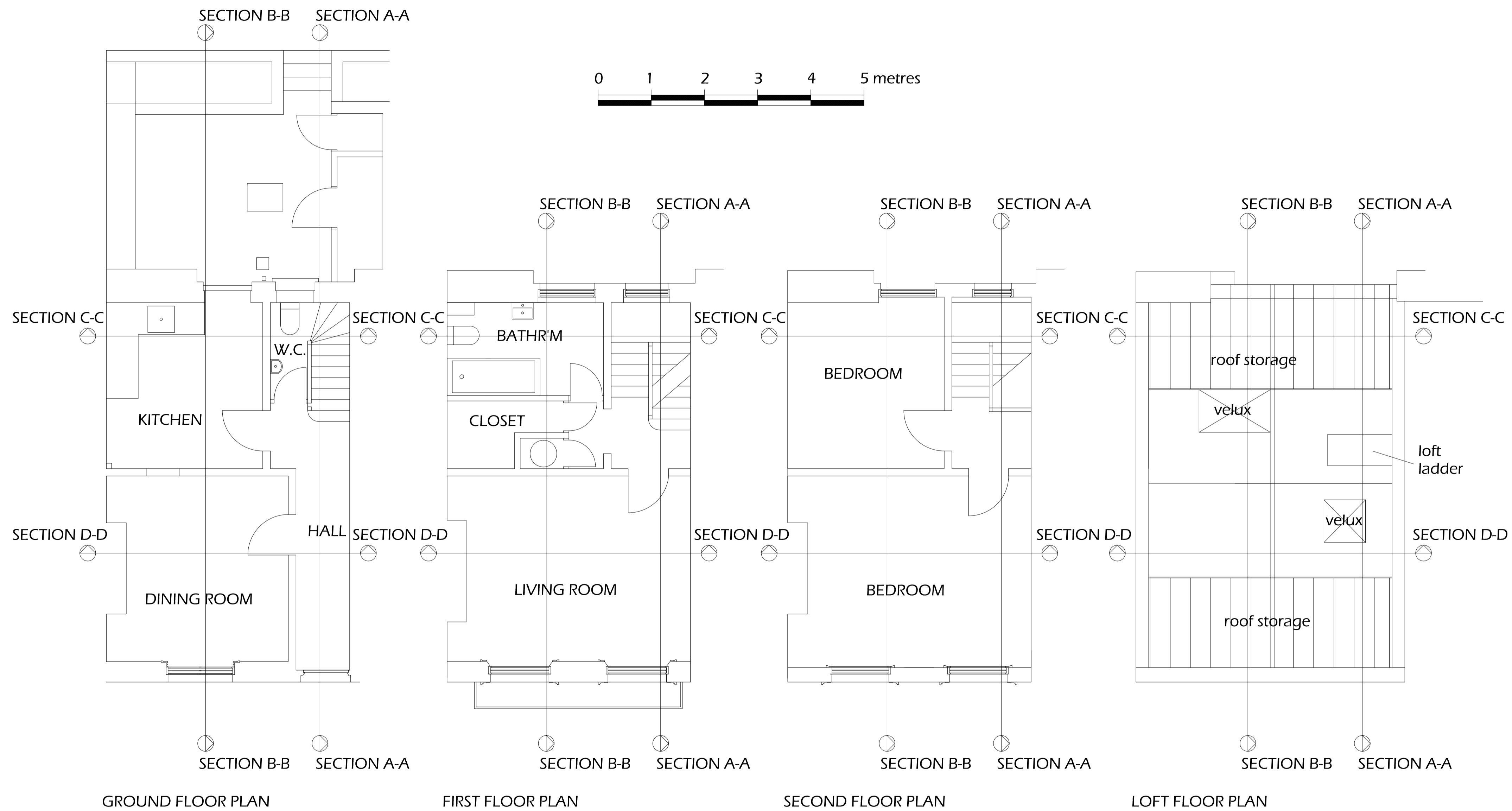

SMILEY JIM LIMITED
 5 UNDERWOOD RISE
 TUNBRIDGE WELLS
 KENT TN2 5RY

| REVISION | ITEM | DATE |
|----------|------|------|
| | | |
| | | |
| | | |
| | | |
| | | |

Client
 MUNESH MAHTANI

Site Address
 33 GOLDINGTON ST
 LONDON NW1 1UE

Drawing Title
 PLANS AS EXISTING

| | |
|--------------------|-------------------------------------|
| Date 28/09/2020 | Scale 1:50 @ A1 |
| Paul | Checked by: Checked on: 28/09/20 |

| | |
|------------|----------------|
| Job Number | Drawing Number |
| | MP 01 |