

EXISTING

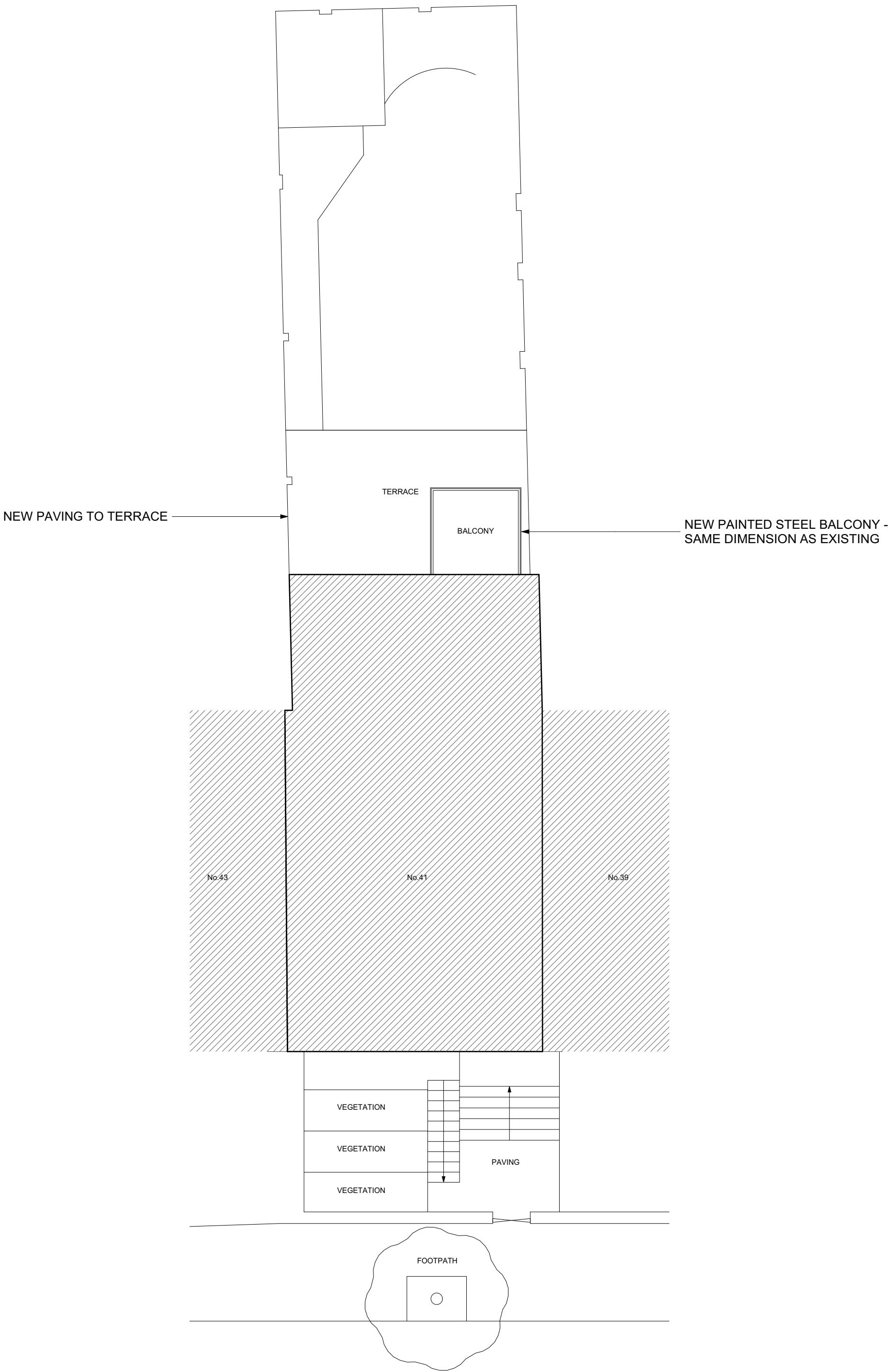

PROPOSED

DISCLAIMER:
DO NOT SCALE FROM THESE DRAWINGS. FOR ACCURACY, ALL DIMENSIONS AND SPECIFICATIONS MUST BE CONFIRMED AT THE SITE AND WITH RELEVANT TECHNICAL DRAWINGS.
TO BE READ IN CONJUNCTION WITH STRUCTURAL ENGINEER'S DRAWINGS AND SPECIFICATIONS.
TO BE READ IN CONJUNCTION WITH SERVICE ENGINEER'S DRAWINGS AND SPECIFICATIONS.
ANY DISCREPANCY BETWEEN DRAWINGS AND DIMENSION ON SITE ARE TO BE BROUGHT TO THE ATTENTION OF THE ARCHITECT PRIOR TO CONSTRUCTION.

© 2021 © CHARLES TASHIMA ARCHITECTURE. ALL RIGHTS RESERVED. NO INFORMATION OR DESIGNS CONTAINED WITHIN THIS DOCUMENT SHOULD BE COPIED OR REPRODUCED WITHOUT THE CONSENT OF CHARLES TASHIMA ARCHITECTURE.

KEY
TO BE REMOVED - SECTION
TO BE REMOVED - VIEW

DRAFT

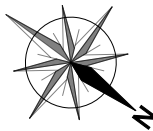

PLANNING

PROJECT: 41 DARTMOUTH PARK ROAD LONDON NW5 1SU	
PROJECT NUMBER:	1095
PROJECT STAGE:	PLANNING
ISSUE DATE:	FEBRUARY 2021
SCALE:	1:100 @ A1 1:200 @ A3
DOCUMENT NUMBER:	002
REVISION:	
SUBJECT: EXISTING & PROPOSED GARDEN PLAN	
CLIENT:	TALIA & JAMES BARRY
CHARLES TASHIMA ARCHITECTURE 12A Blackstock Mews London N4 2BT Landline: +44(0)20 7281 2351 Email: info@ct-arch.co.uk Website: www.ct-arch.co.uk	