

South Elevation (Drummond St)

Submission B

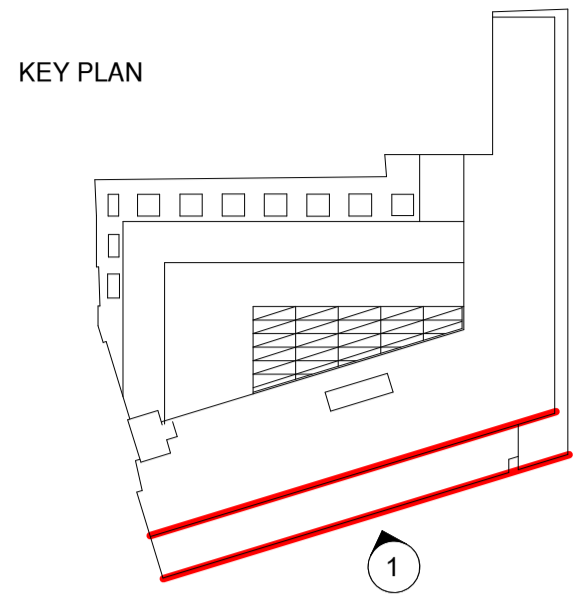

Sim
2
A-0314



NOTES FOR ALL DRAWINGS:
This drawing is to be read in conjunction with the contract documents and all other consultants' drawings, specifications and schedules, including but not limited to the structural engineer's drawings, specifications and schedules for all structural design, sizes and performance criteria. This drawing shows the design intent only. This is not a fabrication drawing. Do not scale from this drawing. All dimensions, including setting out dimensions, and all levels shown are to be checked and verified by the contractor on site and are subject to a site survey. Any discrepancies found in this drawing, or between what is shown on the drawings and conditions found after opening up of the existing works, are to be reported to the Architect immediately, and in accordance with the provisions of the building contract. Any modifications to these drawings necessary to meet the performance criteria of the specifications, or due to unforeseen conditions related to the existing structure or fabric, shall be agreed in writing with the Architect and issued for approval in accordance with the provisions of the building contract.
Marks Barfield Architects has prepared this drawing using information derived from a survey prepared by Lane & Frankham dated 04 July 2019 & 1 August 2019, and S&S re-verification information received 9 December 2019, upon which it is entitled to rely. Marks Barfield Architects accepts no liability for the survey information nor does it warrant that information shown on the drawing related to the existing structure and fabric is either accurate or complete.
© Marks Barfield Architects 2020

Rev	Date	by	Description
B	12/02/21	NP	More callouts added for the discharge of planning conditions. Key added to show the locations of enamel back painted glass.

Key	Description
GREY HATCH	ENAMEL BACK PAINTED ON FACE 4 OPAQUE GLASS. RAL1035

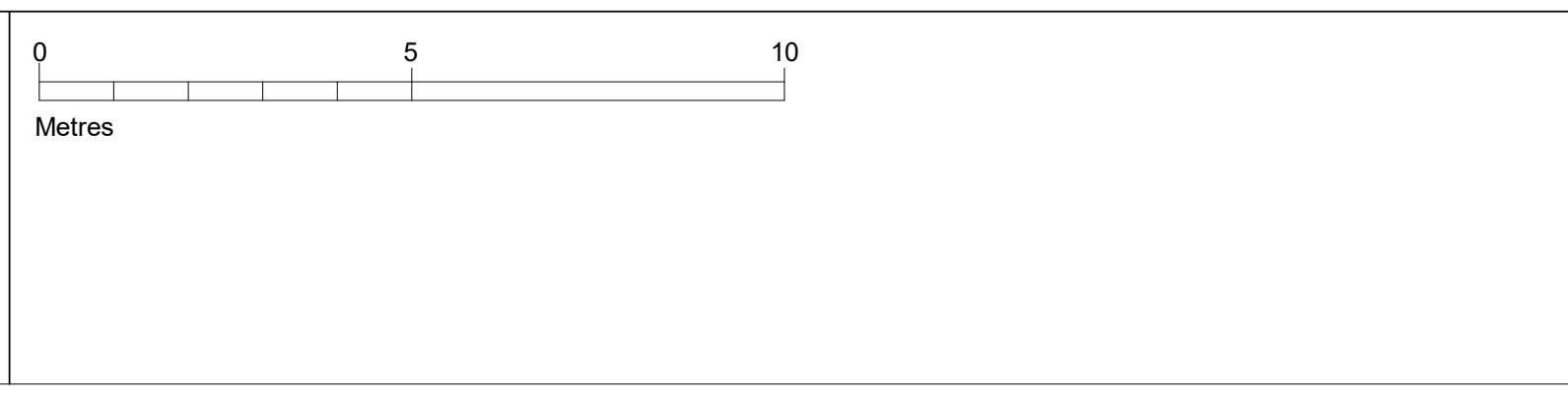

Client
Lazari Properties 8 Limited

Greater London House
Hampstead Road
London NW1 7QX
United Kingdom
Tel +44 20 7388 5444
Fax +44 20 7388 6557

Architect
marks barfield architects

50 Bromells Road
London SW4 0BG
United Kingdom
Tel +44 20 7501 0180

Stephenson House, 75 Hampstead Road, London, NW1 2PL				
Drawing Title Proposed South Elevation (Drummond Street)				
Job no 601	Scale (@ A1) As indicated	Drawing No A-0311-PL	Revision B	Status Information
Date 02/01/20	Checked IR			