

Copyright: All rights reserved. This drawing must not be reproduced without permission.

Only the original drawing should be relied upon. Contractors, subcontractors and suppliers must verify all dimensions on site before commencing any work or making any shop drawings.

All shop drawings to be submitted to the architect for comment prior to fabrication.

This drawing is to be read in conjunction with the Architect's specification, bills of quantities / schedules, structural, mechanical & electrical drawings and all discrepancies are to be reported to the architect.

Do not scale from this drawing. Dimensions are in millimetres unless otherwise stated.

revision / date / amendments	
- / 26/01/18 /	- First Issue
A / 01/03/18 /	- Indicative sump pump / chamber shown
B / 23/03/18 /	- 1. Tender Addendum (1). Indication of 4 post truss fixed at stage level for integrated automatic retractable acoustic baffles and integrated lighting fig.
	2. Tender Addendum (2). New AHU + Attenuator over stage to be hung to existing relocated secondary beams in Flytower.
C / 01/03/18 /	- Door numbers updated
D / 01/06/18 /	- Listed Building Application
	1. Indication of 4 post truss fixed at stage level for integrated automatic retractable acoustic baffles and integrated lighting fig.
	2. New AHU + Attenuator over stage to be hung to existing relocated secondary beams in Flytower.

**LEGEND**

- Proposed Works
- Existing Building Fabric KOKO née Camden Palace Theatre (1900)
- Existing Building Fabric Hope & Anchor (approx. 1850)
- Existing Building Fabric Bayham Place (from 1875)
- Existing Modern Building Fabric Bayham Place (from 2006)
- Building Fabric to be demolished
- Demolition of Flooring / Elevation / Wall
- Proposed Excavation
- Remove and retain in alternate location
- Retain and protect existing
- Retain, make good, ease and adjusted
- Means of escape Route
- Private Members Route
- Koko Customer Route
- Public Route
- Artist Route
- Proposed Riser
- Proposed Risers Above
- RM.4-06 Room Number
- D4-02 Door Number
- W4-05 Window Number
- Hope & Anchor Demise
- Koko Demise
- 1 Bayham Street & 65 Bayham Place Demise

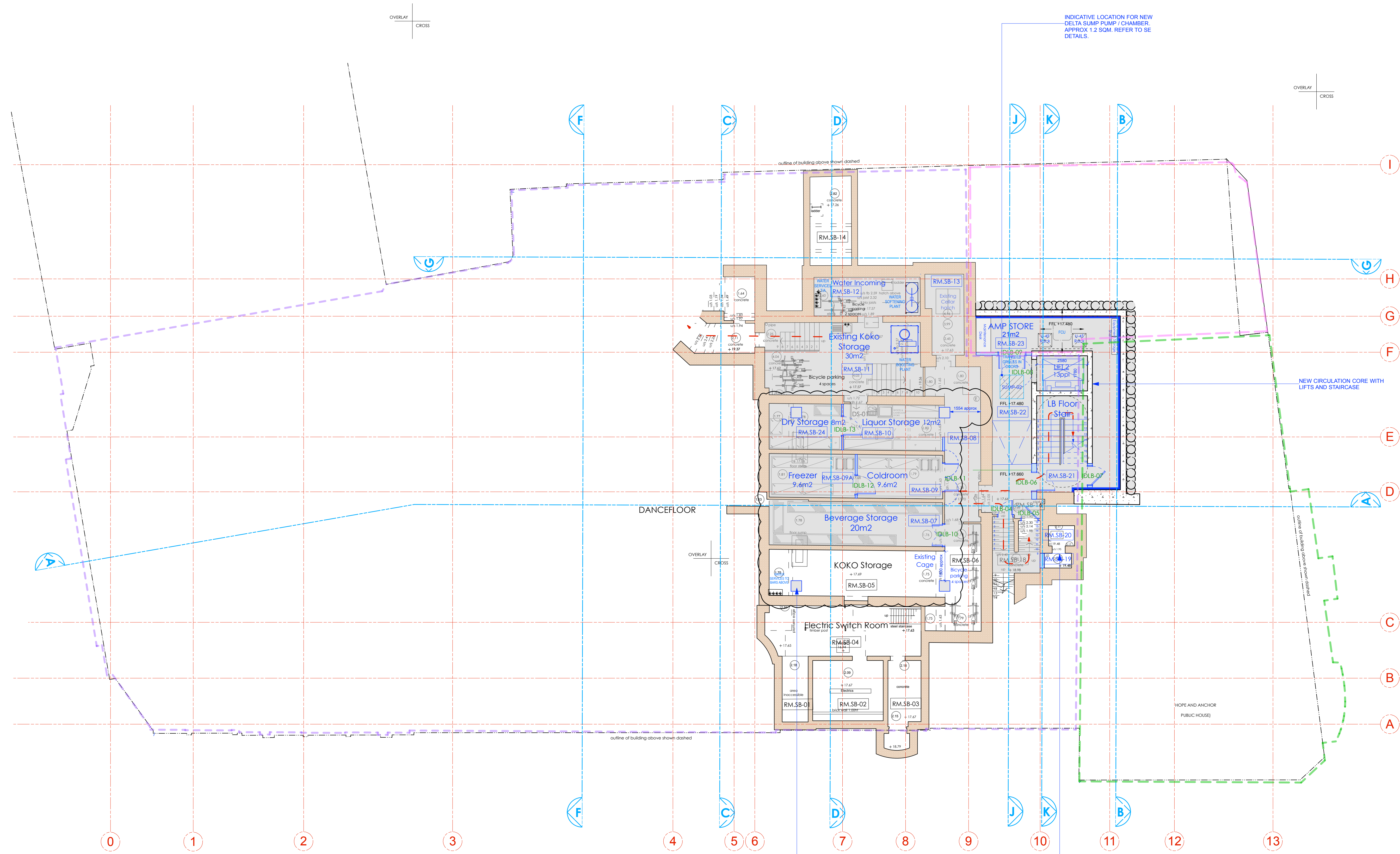

INDICATIVE LOCATION FOR NEW DELTA SUMP PUMP / CHAMBER, APPROX 1.2 SOM. REFER TO SEE DETAILS.

OVERLAY CROSS

OVERLAY CROSS

outline of building above shown dashed

NEW CIRCULATION CORE WITH LIFTS AND STAIRCASE

HOPES AND ANCHOR PUBLIC HOUSE

PROPOSED 4NO BRICK PIERS PROVIDING STRUCTURAL SUPPORT FOR NEW 4 POST TRUSS AT STAGE LEVEL. REFER TO STRUCTURAL ENGINEER'S FOR FOOTING DETAILS.

THIS SPACE WILL NO LONGER BE USABLE DUE TO REDUCED HEAD HEIGHTS

01.06.18

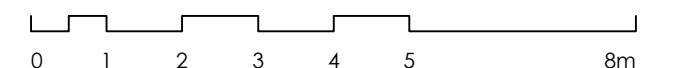
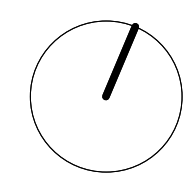

**STAGE 4**

Archer Humphries Architects

Basement  
Central House  
142 Central Street  
London, United Kingdom  
EC1V 8AR  
T: +44 (0) 20 7251 8555

project title	
KOKO + Hope & Anchor + Bayham Place Camden, London	
drawing title	scale   date
Proposed Sub Basement Plan	1:100 A1   13.04.17
drawing number	drawn   checked
AHA/KKG/GA/098	FR/PC   DA
	revision
	D

OVERLAY CROSS