

Copyright: All rights reserved. This drawing must not be reproduced without permission.

Only the original drawing should be relied upon. Contractors, subcontractors and suppliers must verify all dimensions on site before commencing any work or making any shop drawings.

All shop drawings to be submitted to the architect for comment prior to fabrication.

This drawing is to be read in conjunction with the Architect's specification, bills of quantities / schedules, structural, mechanical & electrical drawings and all discrepancies are to be reported to the architect.

Do not scale from this drawing. Dimensions are in millimetres unless otherwise stated.

revision / date / amendments  
 A / 12/04/18 / - Window and door numbers updated

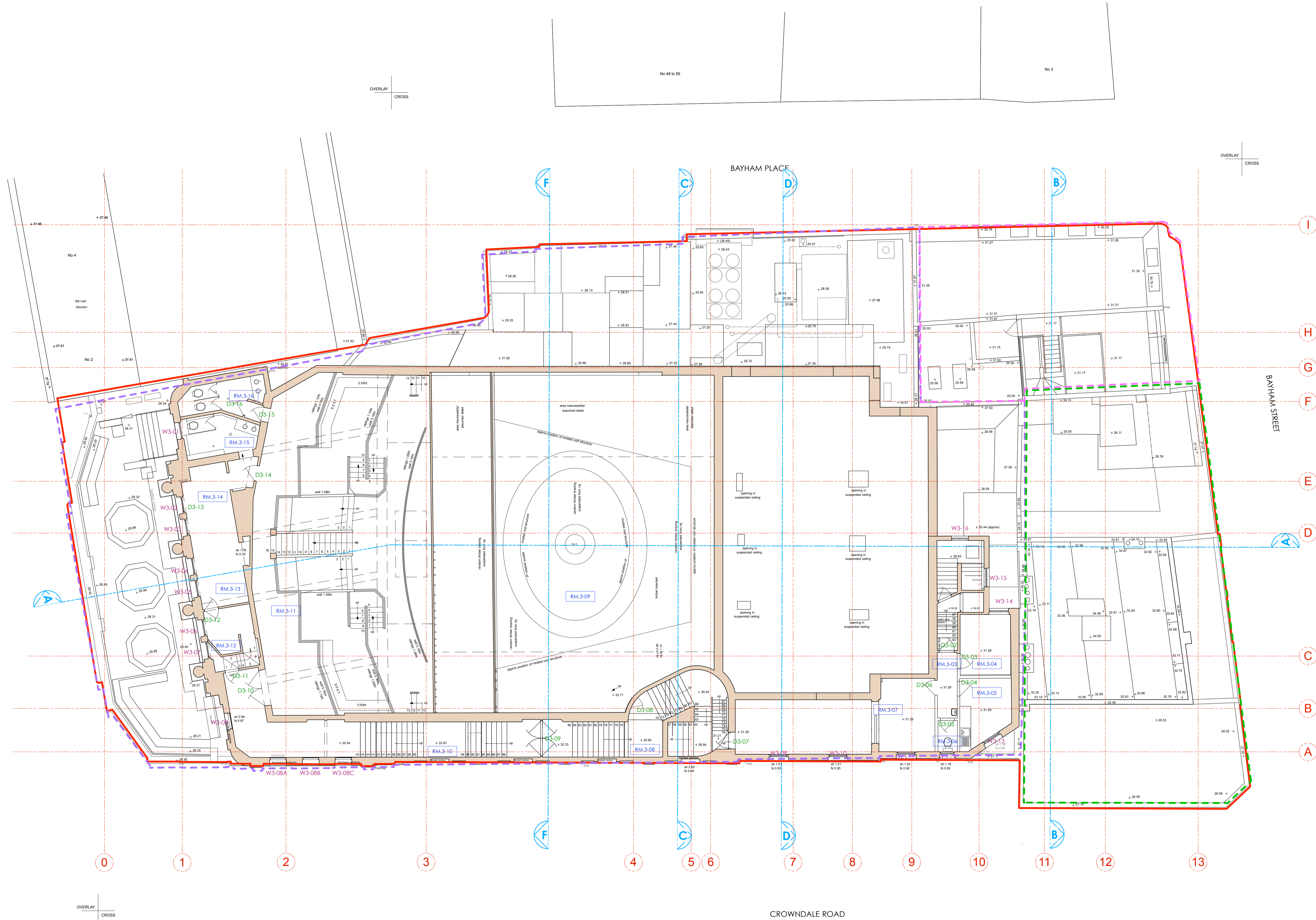

- LEGEND**
- Existing Building Fabric KOKO née Camden Palace Theatre (1900)
  - Existing Building Fabric Hope & Anchor (approx. 1850)
  - Existing Building Fabric Bayham Place (from 1875)
  - Existing Modern Building Fabric Bayham Place (from 2006)

- RM.4-06 Room Number
- D3-02 Door Number
- W3-05 Window Number
- Hope & Anchor Demise
- Koko Demise
- 1 Bayham Street & 65 Bayham Place Demise

05.12.17

**STAGE 4**  
 Archer Humphryes Architects

Basement  
 Central House  
 142 Central Street  
 London, United Kingdom  
 EC1V 8AR  
 T: +44 (0) 20 7251 8555

project title	
KOKO + Hope & Anchor + Bayham Place Camden, London	
drawing title	scale / date
Existing Third Floor Plan	1:100 BA1 / 28.11.18
drawing number	drawn / checked
AHA/KKC/GA/103	FR/PC / DA
revision	revision
	A