

NOTE
This drawing is prepared solely for design and planning submission purposes. It is not intended or suitable for either Building Regulations or Construction purposes and should not be used for such.

FOR ELECTRONIC DATA USE
Electronic data/drawings are issued as "read only" and should not be interrogated for measurement. All dimensions and levels should be read only from those values stated in text, on the drawing.

AREA MEASUREMENT
The areas are approximate and can only be verified by a detailed dimensional survey of the completed building. Any decisions to be made on the basis of these predictions whether as to project viability, pre-letting, lease agreements or the like should include due allowance for the increases and decreases inherent in the design development and building processes. Figures relate to the likely areas of the building at the current state of the design and using Gross External Area (GEA), Gross Internal Area (GIA) and Net Internal Area (NIA) method of measurement from the Code of Measuring Practice, 5th edition (RICS code of practice). All areas are subject to Town Planning and Conservation Area Consent, and detailed Rights to Light analysis.

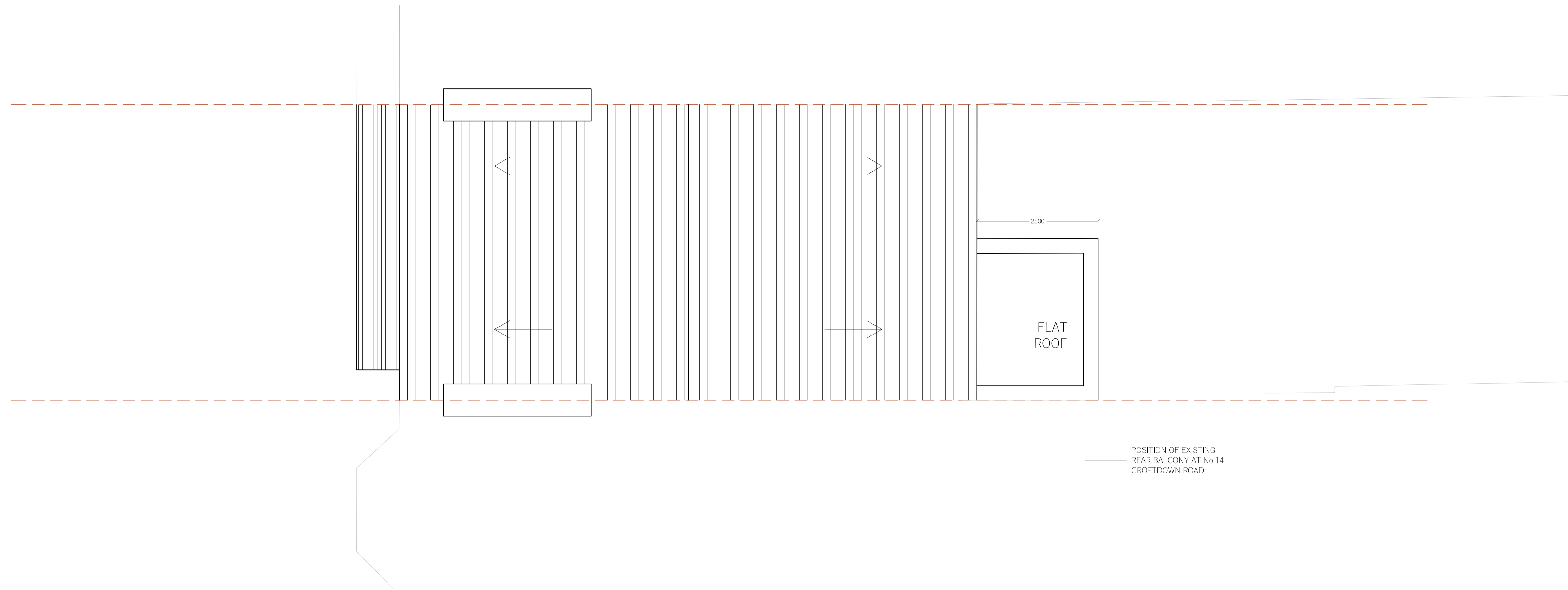

01
ROOF PLAN

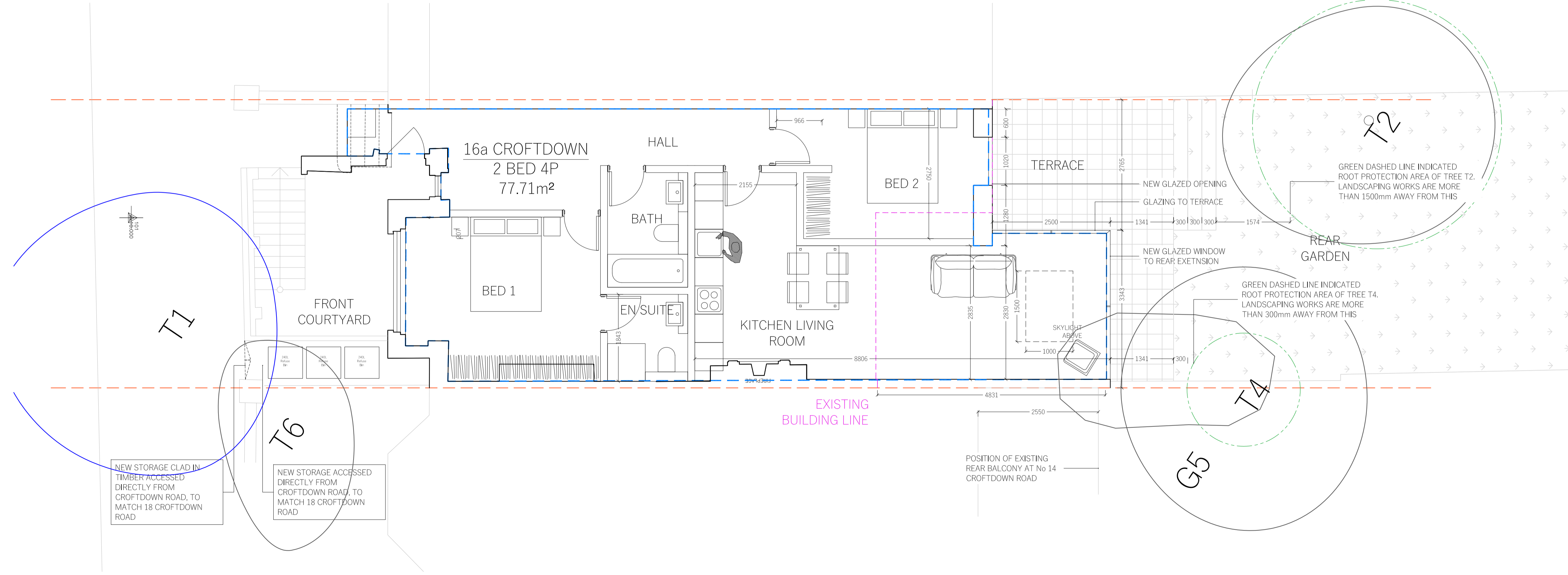

02
LOWER GROUND FLOOR PLAN

REVISION	DATE	COMMENT

PROJECT:
16a CROFTDOWN ROAD
NW5 1EH

CLIENT:
STEFAN NEOPHYTOU

DRAWING:
PROPOSED PLANS

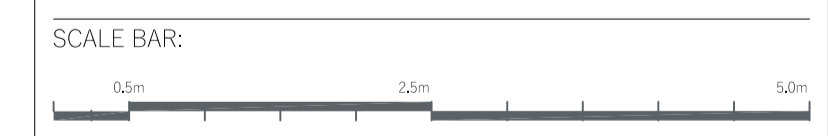

DATE: 23.02.21 | SCALE: 1:50 @ A1 | DRAWN: DW | CHECK: DG

REASON FOR ISSUE: PLANNING | NORTH: [North arrow symbol]

DRAWING NO: 0124_PL_003 | REV: 2

THE DHAUS COMPANY LIMITED
UNIT 13, OLD DAIRY COURT
17 CROUCH HILL
LONDON N4 4AP
thedhaus.com