

Existing Site Plan

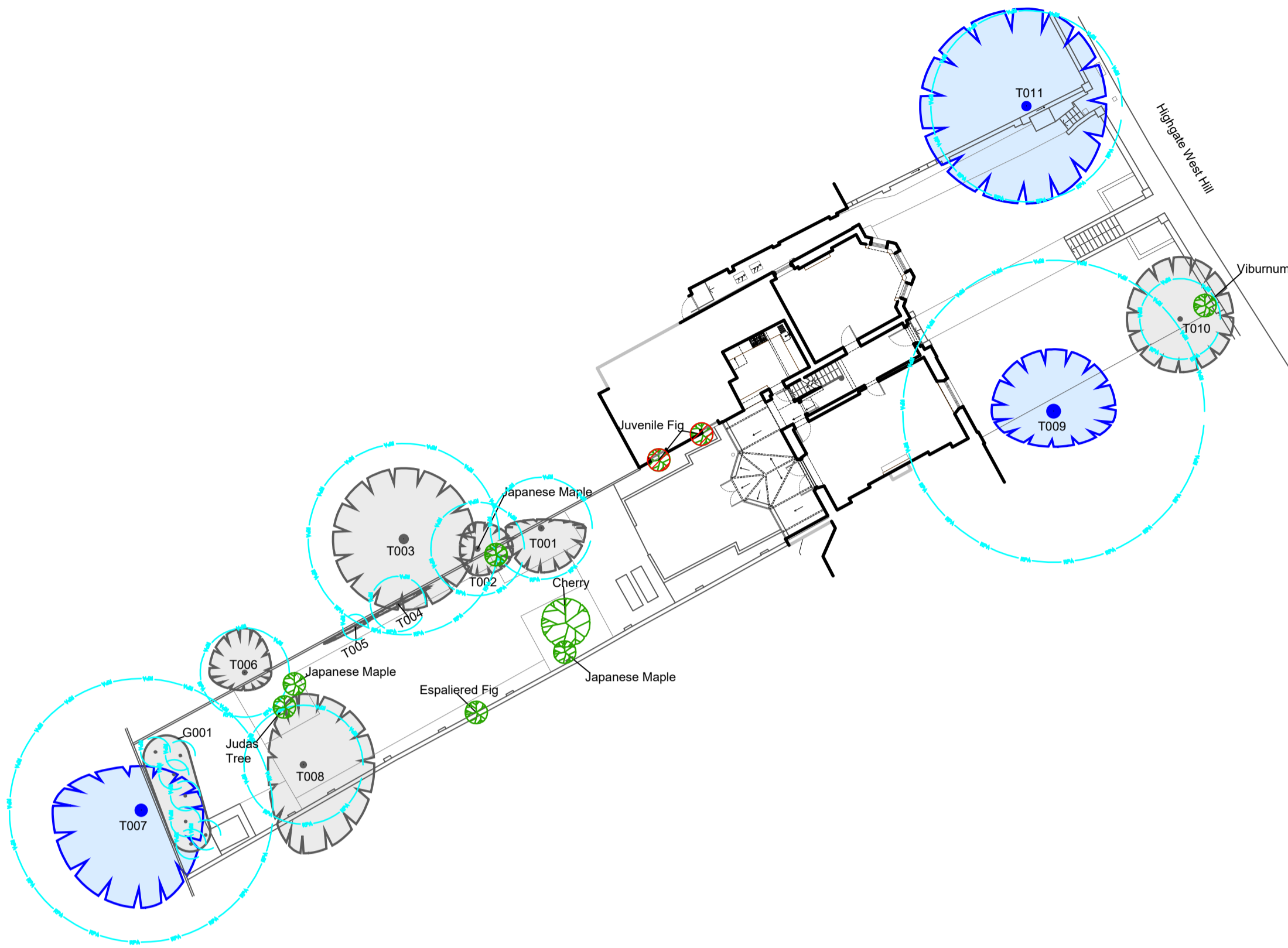

Proposed Site Plan

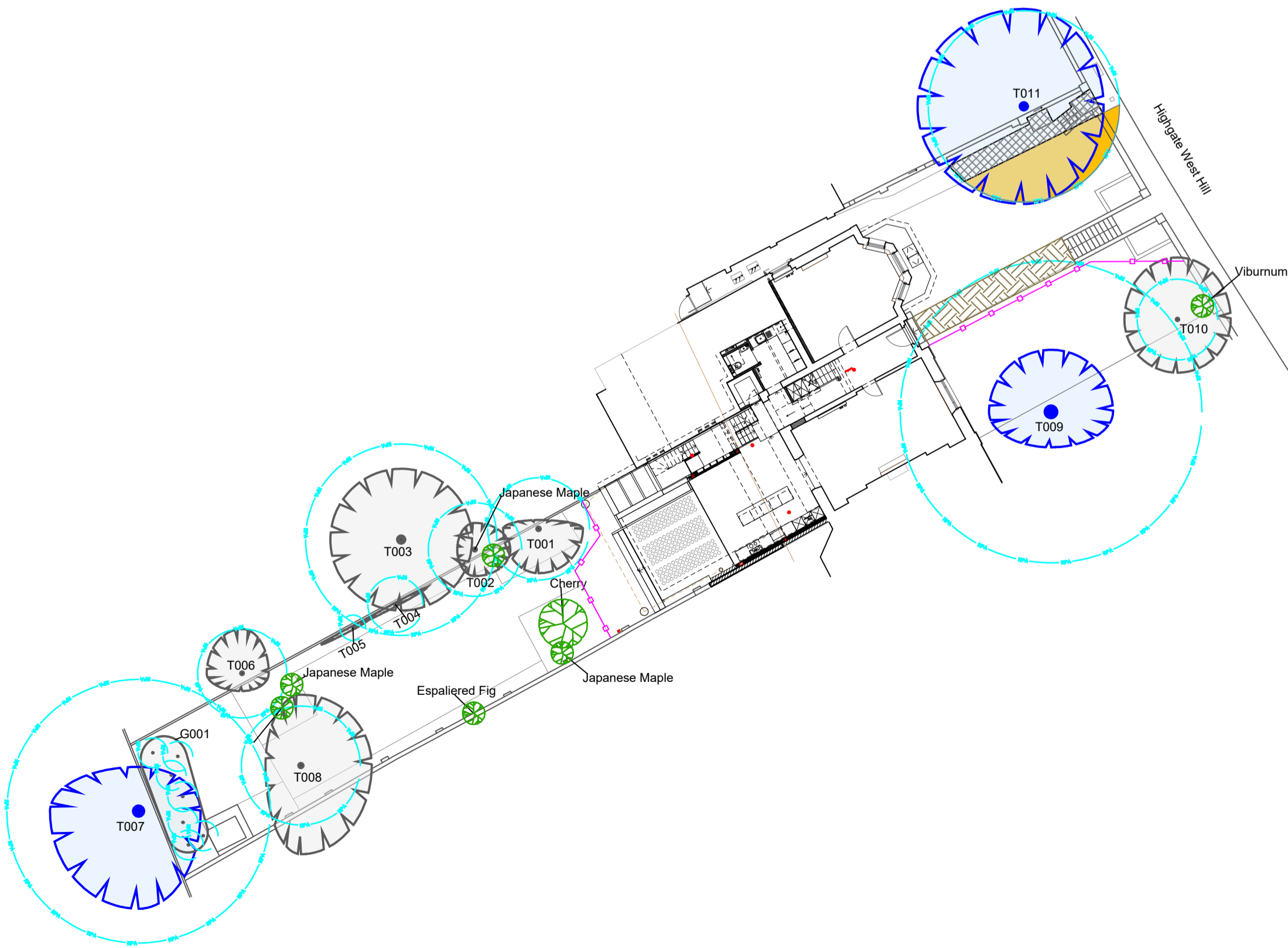

CATEGORY AND DEFINITION

Trees unsuitable for retention	
Category U	Those in such condition that they cannot realistically be retained as living trees in the current land use for longer than 10 years
Trees to be considered for retention	
Category A	Trees of high quality with an estimated remaining life expectancy of at least 40 years
Category B	Trees of moderate quality with an estimated remaining life expectancy of at least 20 years
Category C	Trees of low quality with an estimated remaining life expectancy of at least 10 years, or young trees with a stem diameter below 150mm

NOTE:

Hayden's Arboricultural Consultants were provided with a Topographical Survey but these do not always show the positions of all the trees/features on site. The locations of any additional features have been fixed using GPS. As such the position of the trees/landscape features should not be taken as exact but gives a fair distribution of their locations on site.

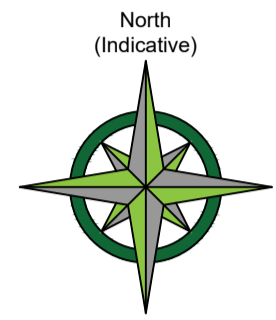

LEGEND

	Existing Tree/Feature BS 5837:2012 Category B
	Existing Tree/Feature BS 5837:2012 Category C
	Line of Root Protection Area (RPA) - calculated following guidelines set in BS 5837:2012
	Additional feature which doesn't meet BS 5837: 2012 categorisation but is included for reference
	Additional feature which doesn't meet BS 5837: 2012 categorisation to be removed for development
	Existing hard surfacing to be retained as a precaution and act as ground protection throughout construction
	Existing footpath set at 1m below base of stem no root extension to the south and within the existing area of lawn on site is therefore considered likely
	Line of proposed temporary protective barrier
	Area of temporary Ground Protection

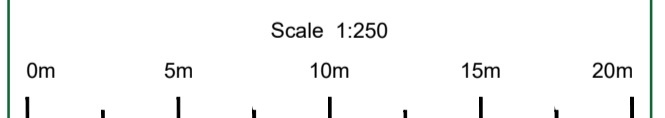

-	05/02/21	DH	Based on topographical survey ref. EX4, EXISTING: GROUND FLOOR PLAN WITH SITE PLAN, and proposed site plan ref. 2005 D.01 Proposed Garden Site Plan
Rev:	Date:	By:	Revision:

The position, condition, and dimensions of the trees are based on a site survey undertaken on 27/01/21

"The original of this drawing was produced in colour - a monochrome copy should not be relied upon"



© HAYDEN'S 2021
 5 Moseleys Farm Business Centre
 Fornham All Saints,
 Bury St Edmunds
 Suffolk IP28 6JY
 Head Office: 01284 765391
 Southern Office: 01722 657423
 Email: info@treesurveys.co.uk
 www.treesurveys.co.uk

Client:	Proctor and Shaw	Drawing Title:	AIA
Site:	11 Highgate West Hill, Highgate, N6 6JR		

Date:	05/02/21	Drawn By:	DH	Cad File Ref:	C:\Pro\8619-D-AIA-11 Highgate West Hill
-------	----------	-----------	----	---------------	---

Scale:	1:250 (A2)	Checked By:	LB	Drawing No:	8619-D-AIA	Rev:	-
--------	------------	-------------	----	-------------	------------	------	---